



Employment Land Call for Sites 2021 Site Questionnaire

Hertsmere Borough Council is currently identifying land available for potential future economic development over the next 15 years to inform the preparation of its new Local Plan.

To assist the Council in determining whether additional sites are potentially available, suitable, or achievable for economic development, please complete and return this questionnaire. All sites should be at least 0.25ha in size or capable of accommodating 500m² of floorspace and be for uses that support economic development, in the form of offices, industrial, storage and distribution and other employment activities which are currently defined in [Policy CS10 of our Core Strategy](#).

Completed questionnaires should be returned by email to local.plan@hertsmere.gov.uk. If you are sending large attachments, please either send the information in separate emails which do not exceed 10mb in size or if this is not possible, you should use our secure file transfer site. Details of this are available on request.

Please use a separate form for (1) each site submitted and (2) each land use or proposal. You should also include a plan clearly identifying the site boundary in red. Further information is available in our FAQs.

Please note that information on sites considered through the land availability assessment process will be openly available to the public and the information submitted will NOT be treated as confidential.

Inclusion in and assessment through this process, including through any update of the Housing and Economic Land Availability Assessment (HELAA) does not guarantee planning permission for nor imply the designation or allocation of any site for development.

1. CONTACT DETAILS

Owners Details (required):

Name:

[REDACTED]

Address:

[REDACTED]

Postcode:

[REDACTED]

Tel No:

[REDACTED]

Email Address:

[REDACTED]

Agent's Details: (if applicable)

Name:

[REDACTED]

Address:

[REDACTED]

Postcode:

[REDACTED]

Tel No:

[REDACTED]

Email Address:

[REDACTED]

2. SITE DETAILS

Please include a plan clearly showing the exact location, and boundaries (marked in red) of the site. Forms submitted without a site plan will not be considered.

Site Address including postcode:

Land to west of Hillfield Lane, Aldenham

OS Grid Reference (if known):

TQ1497SW

Site Area (Hectares):

1.1

Land ownership (if you are not the owner):

[Click here to enter text.](#)

3. CURRENT AND POTENTIAL USE

a) *What is the site currently used for?*

Vacant Land

b) *When did this use commence?*

N/A

c) *Please describe the extent of any existing buildings on the site*

Used in conjunction with Patchetts Equestrian Centre

d) *What was the site used for prior to the current use?*

N/A

e) *If the site is currently occupied by another individual or organisation, please describe their status (e.g. tenant, leaseholder) and the expected duration of this arrangement.*

N/A

f) *Please describe the overall level of occupancy:*

None

g) *What is the proposed use(s) of the site?*

Charity and medical/education uses

h) Should the site be allocated as employment land in the Local Plan, what is the name of the business(es) or organisation(s) which would occupy the premises which are subsequently built?

N/A

i) Does the site currently have planning permission and if so, would this form the basis of what you intend to deliver on the site?

NONE

j) If the site has a recently lapsed planning permission

(i) please clarify why the permission has been allowed to lapse

N/A

and

(ii) do you intend to reapply for a similar scheme which delivers the same amount of development?

N/A

4. TIMESCALE

When do you consider the site will be available for development?

Within 5 years

On what grounds is this assessment based?

Vacant surplus land

5. ECONOMIC VIABILITY

a) Has there been interest in the site from any other developer and/or site occupier?

Yes

No

If Yes, please provide additional details:

[Click here to enter text.](#)

b) Has a developer or you already taken steps toward bringing forward the site for economic development? (If yes, please give details)

Yes

Initial exploration under way

No

c) How many permanent jobs might be created as a result of development of the site

Potentially 30

6. SITE CONSTRAINTS (Please give as much detail as possible if any of the following affect the site)

<i>a) Contamination/pollution issues (previous hazardous land uses)</i> Click here to enter text.	Yes <input type="checkbox"/> No <input checked="" type="checkbox"/>
<i>b) Environmental issues (e.g. Tree Preservation Orders, SSSIs)</i> No TPO's, but is within a conservation area.	Yes <input type="checkbox"/> No <input checked="" type="checkbox"/>
<i>c) Flood Risk</i> Click here to enter text.	Yes <input type="checkbox"/> No <input checked="" type="checkbox"/>
<i>d) Topography affecting site (land levels, slopes, ground conditions)</i> Click here to enter text.	Yes <input type="checkbox"/> No <input checked="" type="checkbox"/>
<i>e) Utility Services (access to mains electricity, gas, water, drainage etc)</i> All services from Hillfield Lane	Yes <input type="checkbox"/> No <input type="checkbox"/>
<i>f) Legal issues (For example, restrictive covenants or multiple ownership/titles affecting the site)</i> Click here to enter text.	Yes <input type="checkbox"/> No <input checked="" type="checkbox"/>

<p><i>g) Access. Is the site accessible from a public highway without the need to cross land in a different ownership to the site?</i> Click here to enter text.</p> <p><i>If no please provide details of how the site could be accessed. (Without this information the site will not be considered to be deliverable).</i> Click here to enter text.</p>	Yes <input checked="" type="checkbox"/> No <input type="checkbox"/>
<p><i>h) Any other constraints affecting the site</i> Click here to enter text.</p>	Yes <input type="checkbox"/> No <input checked="" type="checkbox"/>

7. ADDITIONAL INFORMATION

a) What planning reports and other technical information is currently available to support your promotion of the site? (please attach all reports and surveys which are available)

To follow

b) Is there any other information regarding the site that we should be aware of? (if yes, please provide details)

Yes

Site was previously subject to a pre-app for medical use

No

If you require any further assistance completing this form please contact the Planning Strategy Team at local.plan@hertsmere.gov.uk.

HM Land Registry
Current title plan

Title number **HD551570**
Ordnance Survey map reference **TQ1497SW**
Scale **1:2500**
Administrative area **Hertfordshire :**
Hertsmere

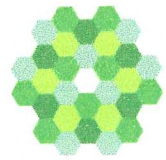

© Crown copyright and database rights 2016 Ordnance Survey 100026316. You are not permitted to copy, sub-license, distribute or sell any of this data to third parties in any form.

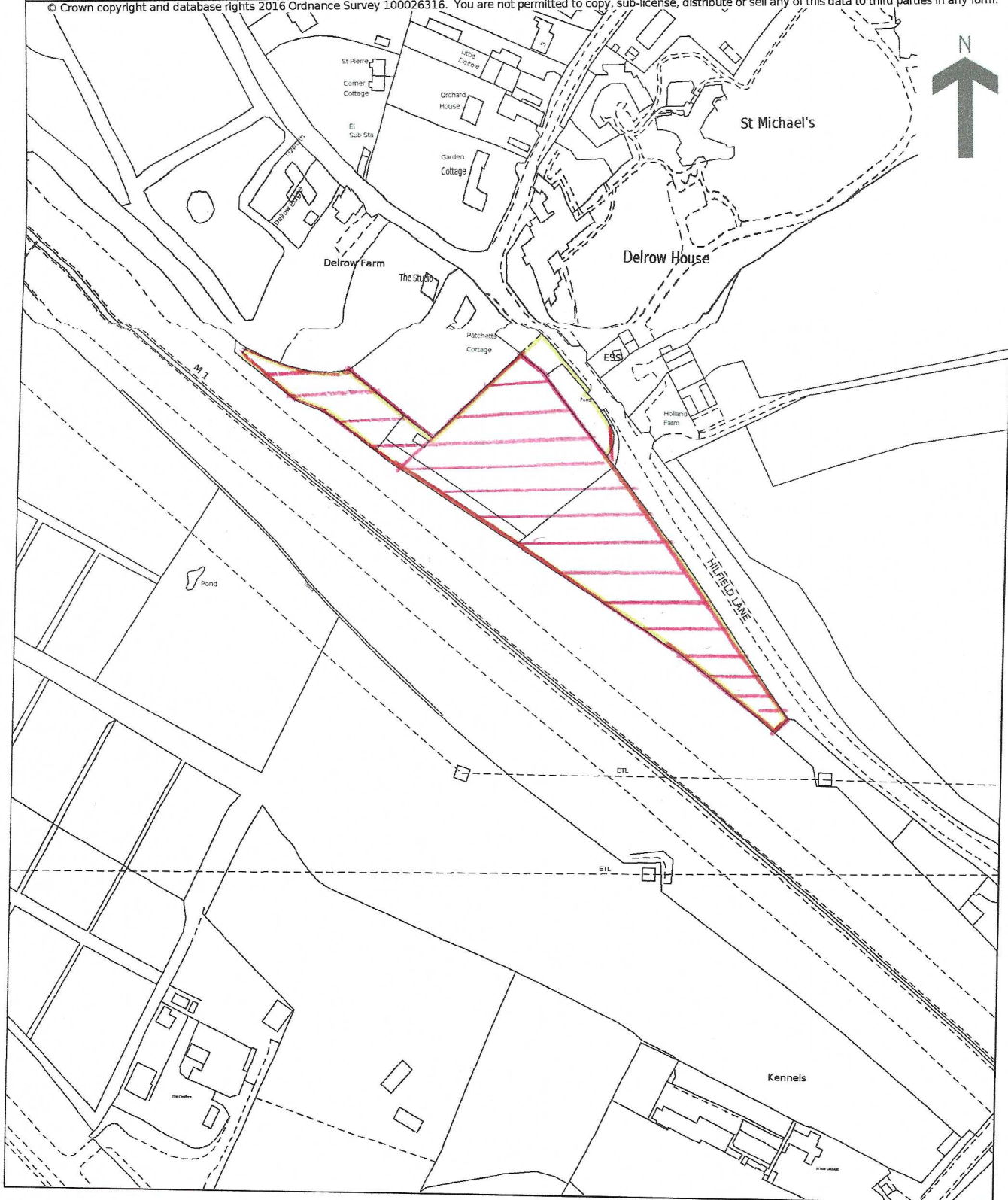

This is a print of the view of the title plan obtained from HM Land Registry showing the state of the title plan on 11 March 2021 at 19:23:19. This title plan shows the general position, not the exact line, of the boundaries. It may be subject to distortions in scale. Measurements scaled from this plan may not match measurements between the same points on the ground.

This title is dealt with by HM Land Registry, Leicester Office.

