

'HERTSMERE BOROUGH COUNCIL

ROAD TRAFFIC REGULATION ACT 1984

Date of Order: 18th March 2015

Order No.: 285

**THE BOROUGH OF HERTSMERE
(VARIOUS ROADS, POTTERS BAR) (DISABLED PERSONS PARKING PLACES)
(No.6) ORDER 2015**

Hertsmere Borough Council (hereinafter referred to as "the Council") pursuant to arrangements made under Section 19 of the Local Government Act 2000 with the County Council of Hertfordshire in exercise of the powers of the said County Council under Sections 32 and 35 of the Road Traffic Regulation Act 1984 (hereinafter referred to as "the Act of 1984"), Part IV of Schedule 9 of the Act of 1984 and of all other enabling powers and after consultation with the Chief Officer of Police in accordance with Part III of Schedule 9 to the 1984 Act, hereby make the following Order:-

1. This Order may be cited as "The Borough of Hertsmere (Various Roads, Potters Bar) (Disabled Persons Parking Places) (No.6) Order 2015" and shall come into operation on 18th March 2015
2. Save as provided in Articles 3 and 4 of this Order, those lengths of road specified in the Schedule to this Order are designated for use as parking places at any time for disabled persons vehicles, which display in the relevant position a disabled person's badge.
3. Save as provided in Article 4 of this Order, where in Article 2 of this Order a parking place is described as designated for use as a parking place at any time for disabled persons vehicles, the driver of a vehicle shall not permit the vehicle to wait in that parking place unless it is:
 - (a) a disabled persons vehicle on which is displayed in the relevant position a disabled persons badge; and
 - (b) wholly parked within the limits of the parking bay.
4. (1) Nothing in Articles 2 or 3 of this Order applies to the lengths of road restricted by those Articles (which said lengths of road are referred to in this Article as "the restricted area") in relation to –
 - (a) a vehicle being used for Fire and Rescue, Ambulance or Police purposes.
 - (b) anything done with the permission of or at the direction of a police constable in uniform; or with the permission of a Civil Enforcement Officer as defined by the Traffic Management Act 2004 and appointed by Hertsmere Borough Council;
 - (c) a vehicle which is prevented from proceeding by circumstances beyond the drivers control or which has stopped in order to avoid injury or damage to persons or property or when required to do so by law;
 - (d) a vehicle which is stationary in order that it may be used for one or more of the purposes specified in sub-Article 2 of this Article and which cannot reasonably be used for such a purpose without stopping in the restricted area;

The borough of Hertsmere (Various Roads, Potters Bar) (Disabled Persons Parking Places)
(No.6) (Order 2015)

- (e) a marked vehicle which, whilst used by a universal service provider in the course of the provision of a universal postal service, is stationary only for so long as may be reasonably necessary for postal packets to be delivered or collected;

In this Article-

The expressions “universal service provider” “provision of a universal postal service” and “postal package” shall bear the same meanings as in the Postal Services Act 2000.

(2) The “purposes” referred to in sub-Article (1)(d) of this Article are –

- (a) any operation involving building, demolition or excavation;
- (b) the removal of any obstruction to traffic;
- (c) the maintenance, improvement or reconstruction of a road;
- (d) constructing, improving, maintaining or cleaning of any street furniture; or
- (e) the laying, erection, alteration, repair or cleaning of any sewer or of any main pipe or apparatus for the supply of gas, water or electricity, or of any telecommunications apparatus kept or installed for the purposes of a telecommunications code system or of any other telecommunications apparatus lawfully kept installed in any position.

5. In this Order –

“disabled person’s vehicle” has the same meaning as in Section 142 (1) of the Act of 1984;

“disabled person’s badge” has the same meaning as given in Regulation 3(1) of The Local Authorities’ Traffic Orders (Exemptions for Disabled Persons) (England) Regulations 2000

“parking disc” has the same meaning as given in Regulation 8(5) of The Local Authorities’ Traffic Orders (Exemptions for Disabled Persons) (England) Regulations 2000; and

“relevant position” has the same meaning as given in Regulation 4 of The Local Authorities’ Traffic Orders (Exemptions for Disabled Persons) (England) Regulations 2000

- 6. The provisions of The Borough of Hertsmere (Control of Parking) (Consolidation) Order 2012, are hereby revoked but only in so far as they are affected by the provisions and restrictions imposed by this Order and specified in Schedules 1 and 2 to this Order.
- 7. A breach of any of the requirements or restrictions set out in the provisions of this Order shall be a contravention within the meaning of Traffic Management Act 2004 Part 6 and Schedule 7, Part 1, Article 4.
- 8. The Interpretation Act 1978 shall apply for the interpretation of this Order as it applies for the interpretation of an Act of Parliament.

9. The restrictions imposed by this Order shall be in addition to and not in derogation from any restriction or requirement imposed by any other regulations made or having effect as if made under the Act of 1984 or by or under any other enactment

SCHEDULE 1

Disabled persons parking places (Potters Bar)

Ashwood Road (East side)	From a point approximately 2metres south of the boundary between property numbers 84 and 86 southwards for a distance of approximately 6.6m.
Carpenter Way (West Side)	From a point in line with the boundary between property numbers 31 and 35 North eastwards for a distance of approximately 6.6m.
High Street (East Side)	From a point approximately 6.6metres south of the southern kerbline of Oakmere Lane southwards for a distance of approximately 5.5metres.
Princes Parade (West Side)	From a point approximately 1.5metres south of the boundary between property numbers 1a and 2a Princess Parade northwards for a distance of approximately 6.6metres.

SCHEDULE 2

Disabled persons parking places (Potters Bar) to be revoked

Mutton Lane	From a point in line with the western boundary of 32 Mutton eastwards for a distance of approximately 7metres
-------------	---

IN WITNESS whereof the Common Seal of the Hertsmere Borough Council was hereunto affixed this 18th day of March 2015.

The Common Seal of the Hertsmere Borough Council was hereunto affixed in the presence of :-



Director of Resources *ENVIRONMENT* *gmv*

6463

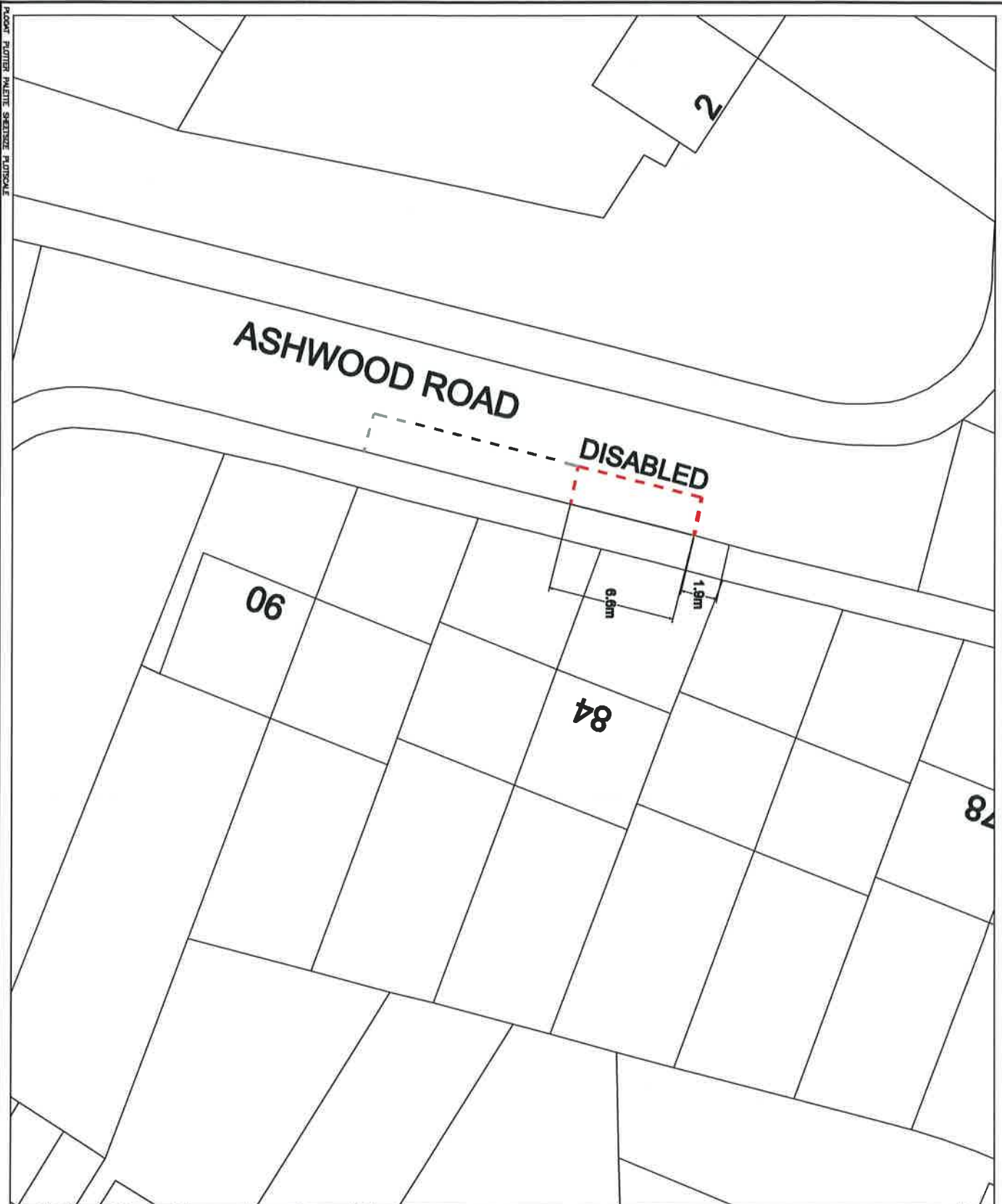

PLOTTER PLOTTE SIZEZ PLOTSCALE

Models rendered in this drawing are hypothetical. Users of Survey Maps will be responsible for the accuracy of the model's content. Users will not be liable for any errors or omissions in this drawing. © 2024 HERTSMERE BOROUGH COUNCIL

KEY	
	Existing parking
	Proposed Disabled parking bay
	Existing disabled bay to be made accessible
	Existing post and sign
	Proposed post and sign

Date	Rev.	Comments



Project Title
DISABLED PARKING PLACES

Drawing Title
 TRO DRAWING (ASHWOOD ROAD, POTTERS BAR)

Scale
 1:250

Date NOV 2014

Drawn JYEBQAH

Eng.

Checked

Drawing No. HBC/TTROZ88/1/1

Path

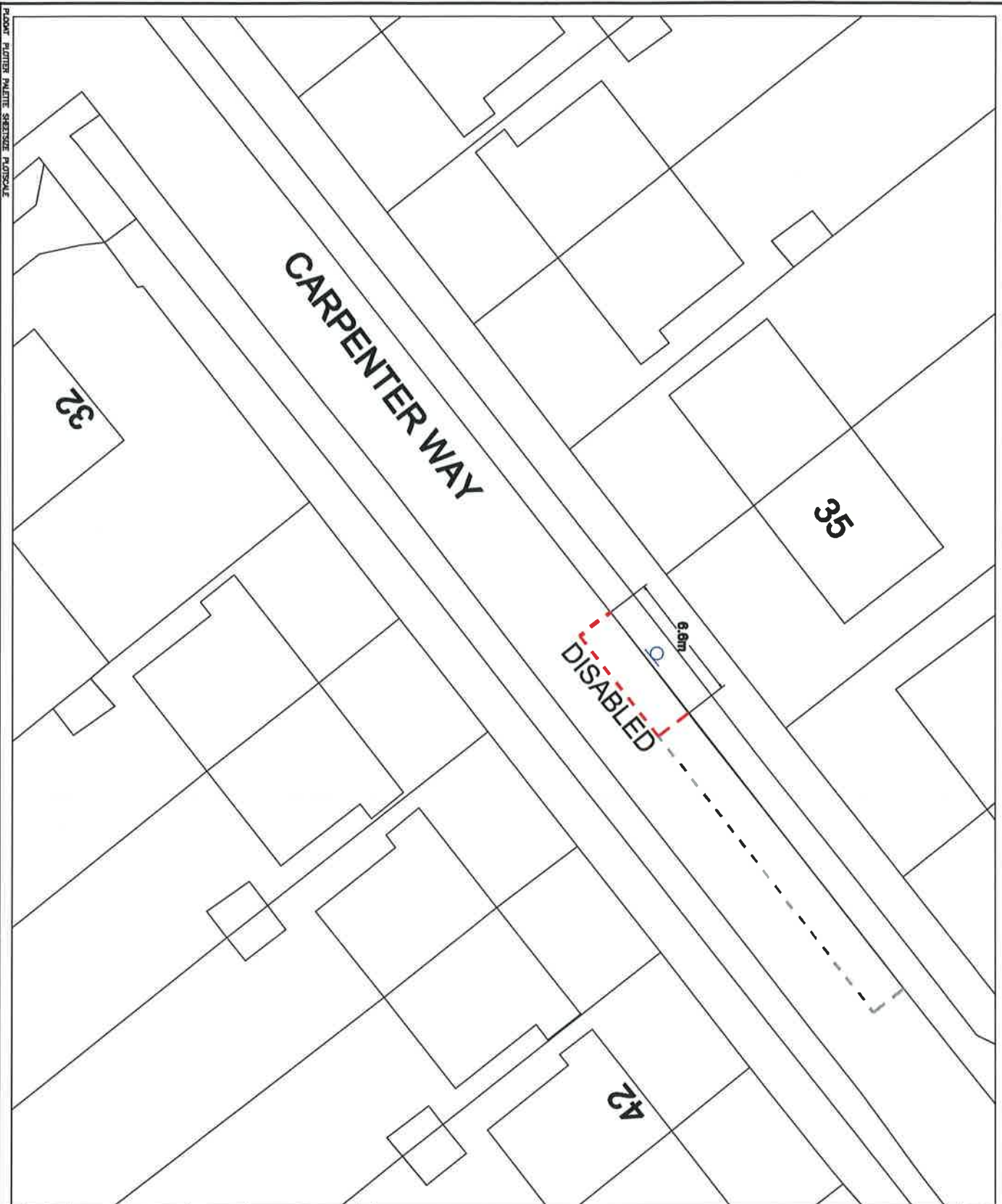

FLOOR PLANNER PALETTE SHEETSIZE: A3/SCALED

Notes: notated to be taken in accordance with OS Survey Map and
 Other Original Plans by LINDA BISHOP

KEY	
	Existing parking
	Proposed Disabled parking
	Proposed Disabled parking
	Existing disabled bays to be made accessible
	Existing gate and
	Proposed gate and

Date	Rev.	Comments



Project Title
 DISABLED PARKING PLACES

Drawing Title
 TPO DRAWING(CARPENTER WAY, POTTERS BAR)

Scale
 1:250

Date
 NOV 2014

Drawn
 J YEOAH

Checked
 HBC/ROZ/SJ/Y02

Appr.
 Rev.

Multiple copies of this drawing are available from OS. Single copy will be provided to the Council at the Mayor's Surgery Office. Other copyright, license or similar notices apply.

KEY	
	Existing parking bay
	Proposed Disabled parking bay
	Existing disabled bay
	Proposed disabled bay to be removed
	Proposed foot and cycle lane
	Existing disabled bay to be removed

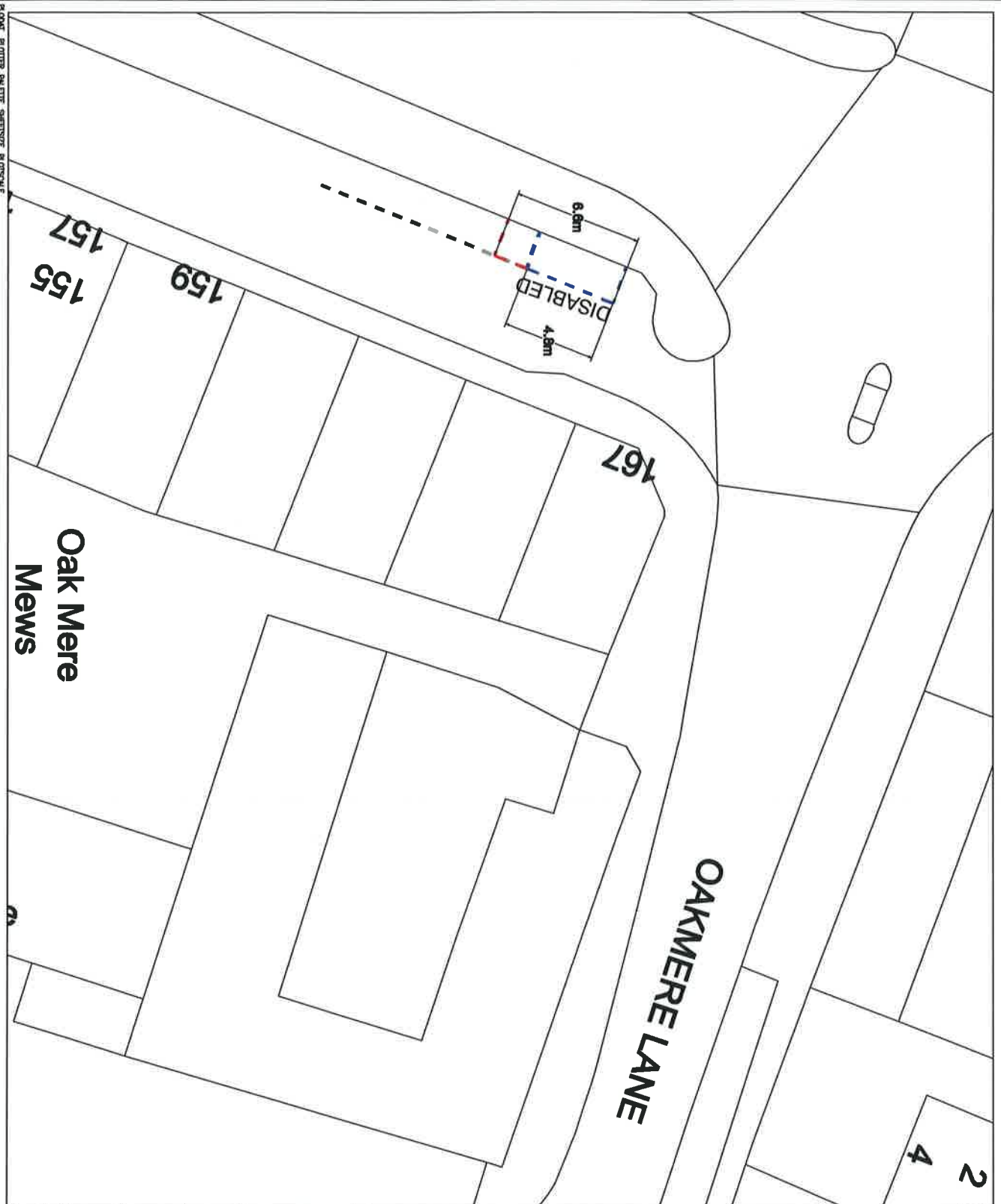

HERTSMERE BOROUGH COUNCIL

Project Title
DISABLED PARKING PLACES

Drawing Title
TRO DRAWING (HIGH STREET, POTTERS BAR)

Scale
 1:250
Date NOV 2014
Drawn J YEOHAI
Eng.
Checked
Appr.

Drawing No. HBC/TROZEBUY/03
Rev.
Path

ROAD POTTERS PALLET SHEDSIZZ POTTSOLE

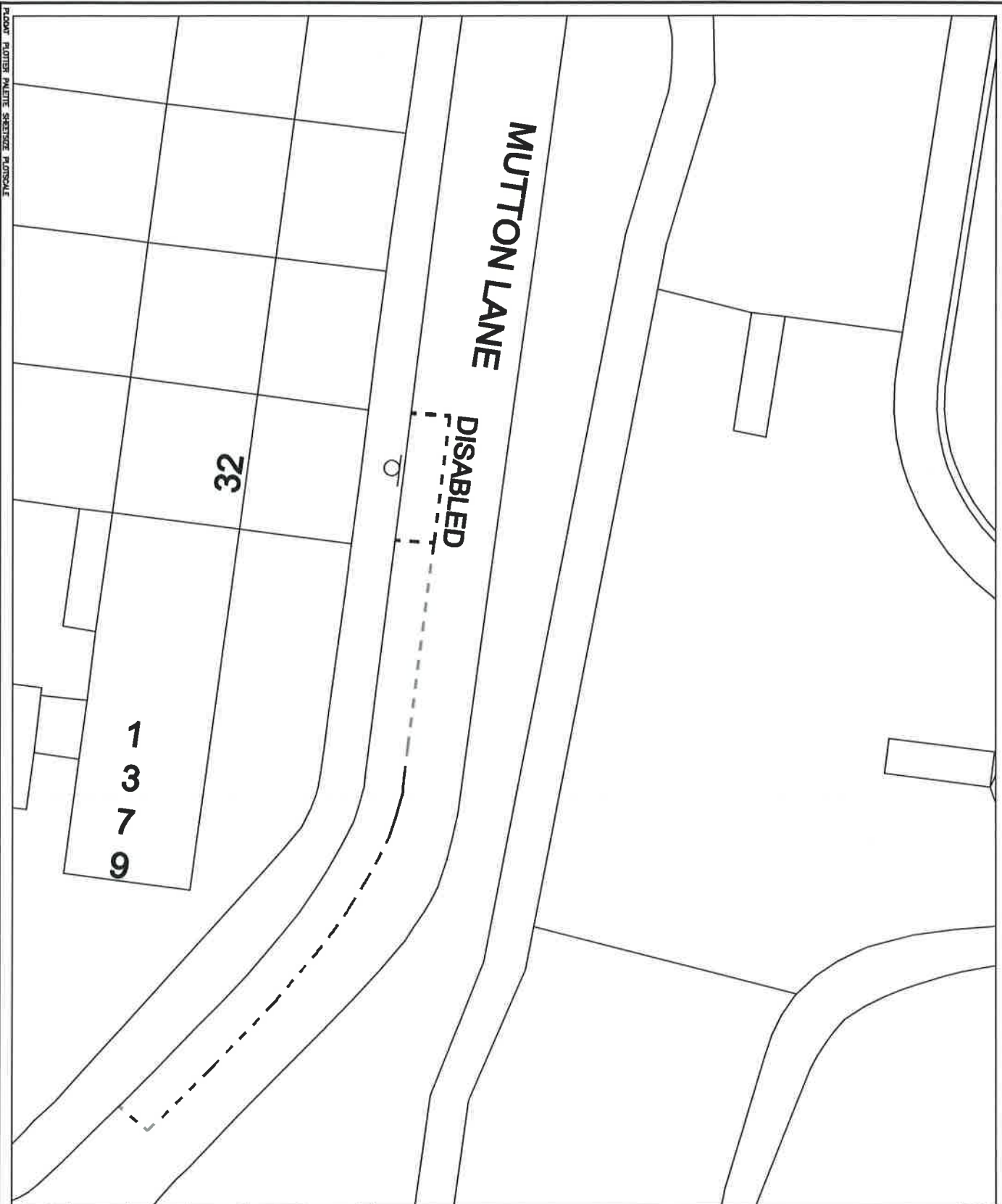

FLOOR POTTERS PALLET STORAGE MANSOLE

Notes enclosed in this drawing are reproduced from OS Survey Maps and other original sources in printed form. All other notes are the property of the author.

KEY	
	Existing parking bay
	Proposed Disabled parking bay
	Existing disabled bays to be made enforceable
	Existing gate and alarm
	Proposed gate and alarm
	Existing disabled bays to be removed

Date	Rev.	Comments



Project Title
DISABLED PARKING PLACES

Drawing Title
TRO DRAWING (MUTTON LANE, POTTERS BAR)

Scale
Date NOV 2014
Drawn J YERDAH
Eng. Appr. Rev.

Checked
Drawing No. HBC/TRO/2014/001
Path

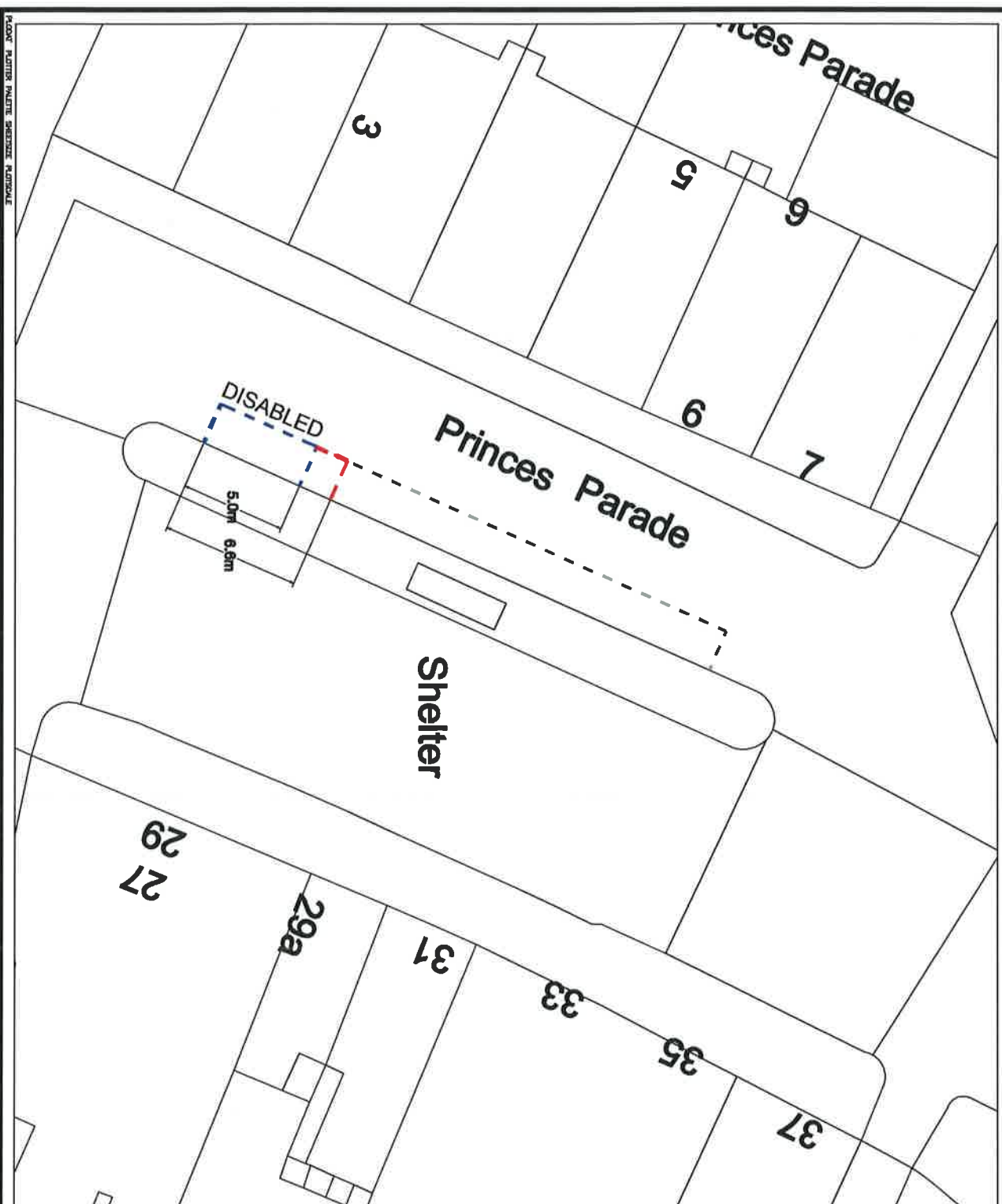

KEY	
	Existing parking
	Proposed Disabled
	Existing way
	Proposed disabled bays
	Proposed foot wall
	Proposed post and rail
	Existing dashed bays to be removed.

Notes: 1. All lines are marked 'As of' date of the drawing. 2. The location of the shelter is shown in the drawing. 3. The location of the shelter is shown in the drawing. 4. The location of the shelter is shown in the drawing.

Date	Rev.	Comments

HERTSMERE BOROUGH COUNCIL

DISABLED PARKING PLACES

Project Title
DISABLED PARKING PLACES

Drawing Title
TRO DRAWING (PRINCESS PARADE, POTTERS BAR)

Scale
 1:250

Date
 NOV 2014

Drawn
 J YERDAH

Eng.
 Aprt.

Checked
 HBC/TT0282/JVM

Rev. 1
 Path