

**Hertsmere Borough Council
Strategic Housing Land Availability Assessment**

Part Two - Section 1

**BOREHAMWOOD
LOCATION PLANS**

IMPORTANT INFORMATION – PLEASE READ

Development Status

This document contains details of land and sites identified to the Council as available for development. It is part of a technical study to assess future housing land supply. The Council is not at this stage proposing these sites as development land. Inclusion in the study does not oblige or imply that the Council will grant planning permission for residential development. Any planning application that comes forward will continue to be considered against current policies in national guidance, the Hertsmere Local Plan (Adopted 2003) and emerging Core Strategy.

Sites on Green Belt Land

The SHLAA study considers urban sites as well as greenfield and Green Belt land. This does not mean the Council have accepted the principle of the release any land from the Green Belt. The assessment made in the study that a site has potential does not amount to 'special circumstances' for development or alter its Green Belt status. The Council will continue to resist speculative applications for housing development on Green Belt land until changes are agreed in an adopted development plan. The Council's future approach to the Green Belt will be set out in its Core Strategy document which will be subject to full public consultation.

Consultation on sites

The SHLAA is a necessary technical exercise produced in consultation with local development stakeholders. The purpose of the study is to assess the amount of land with **potential** for housing and not to test whether each individual site is acceptable. Sites identified have not been subject to neighbour or wider public consultation as there is no certainty they will be allocated for development. If a planning application is received, then local consultation will take place in accordance with planning regulations. Following the adoption of a Core Strategy, the Council will publish preferred options for specific development sites which will be subject to extensive public consultation.

Limitations of site and Assessment Information

Details of site constraints and boundaries are based on the information provided from agents and landowners. The SHLAA does not limit an extension or contraction of these boundaries for the purpose of a planning application. Other constraints may exist which have not been identified.

Ownership

The majority of sites assessed are in private ownership. The inclusion of a site owned by the Council or County Council does not mean a formal decision has been made to sell, develop or dispose of it.

S2 Land north of Barnet Lane



DISCLAIMER

The SHLAA is a technical study to help inform the Council's Local Development Framework. It does not indicate where land will be allocated for housing or granted permission. The site boundary reflects land promoted/assessed in the study and is indicative.

Reproduced from the Ordnance Survey mapping with the permission of the controller of Her Majesty's Stationery Office. Crown copyright. Unauthorised reproduction infringes Crown copyright and may lead to prosecution or civil proceedings. Hertsmere Borough Council Licence 10017428.;



NOT TO SCALE

S5 Instalcom site, Manor Way

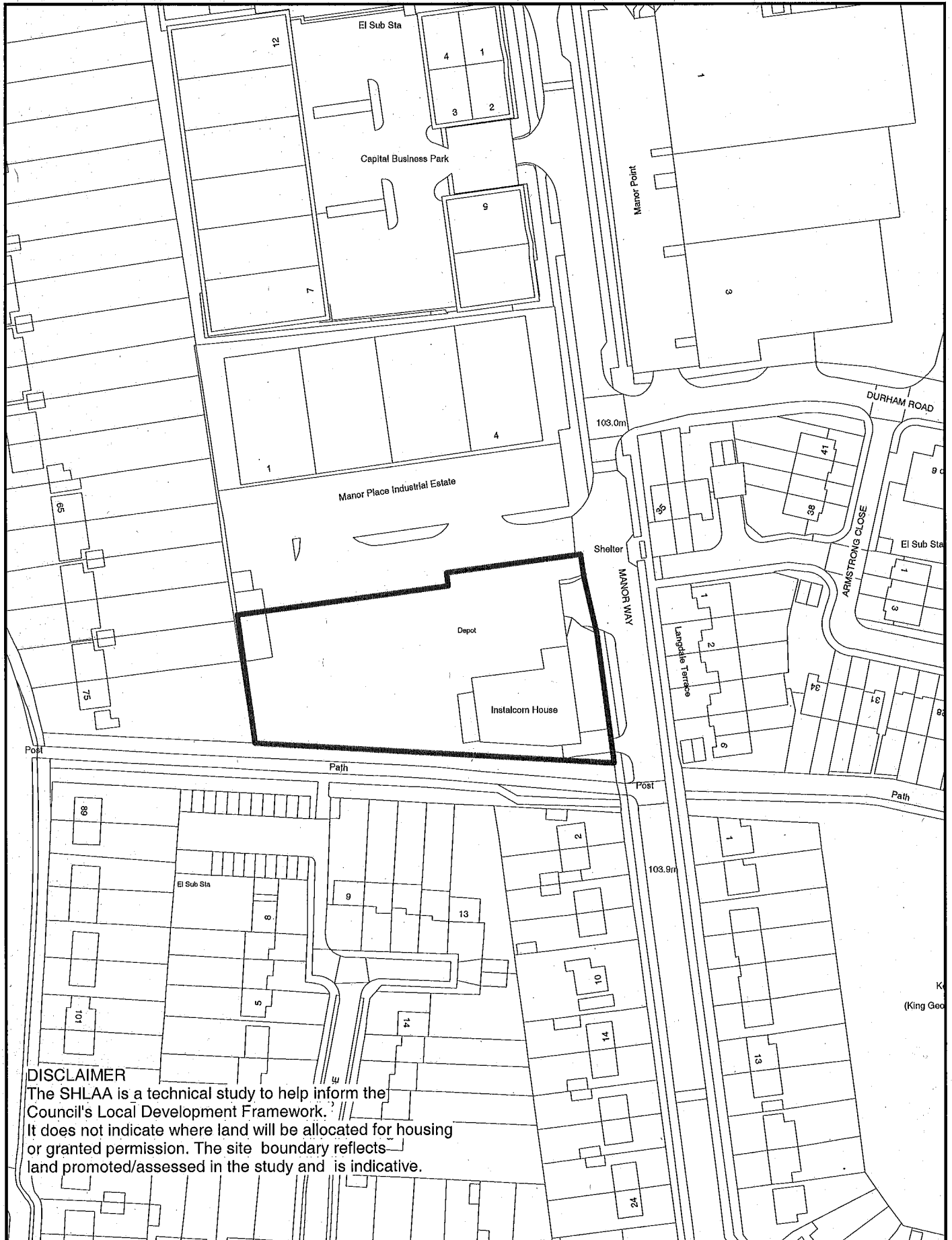

DISCLAIMER

The SHLAA is a technical study to help inform the Council's Local Development Framework. It does not indicate where land will be allocated for housing or granted permission. The site boundary reflects land promoted/assessed in the study and is indicative.

Reproduced from the Ordnance Survey mapping with the permission of the controller of Her Majesty's Stationery Office. Crown copyright. Unauthorised reproduction infringes Crown copyright and may lead to prosecution or civil proceedings. Hertsmere Borough Council Licence 10017428.;



NOT TO SCALE

S8 Land off east side of Theobald Street

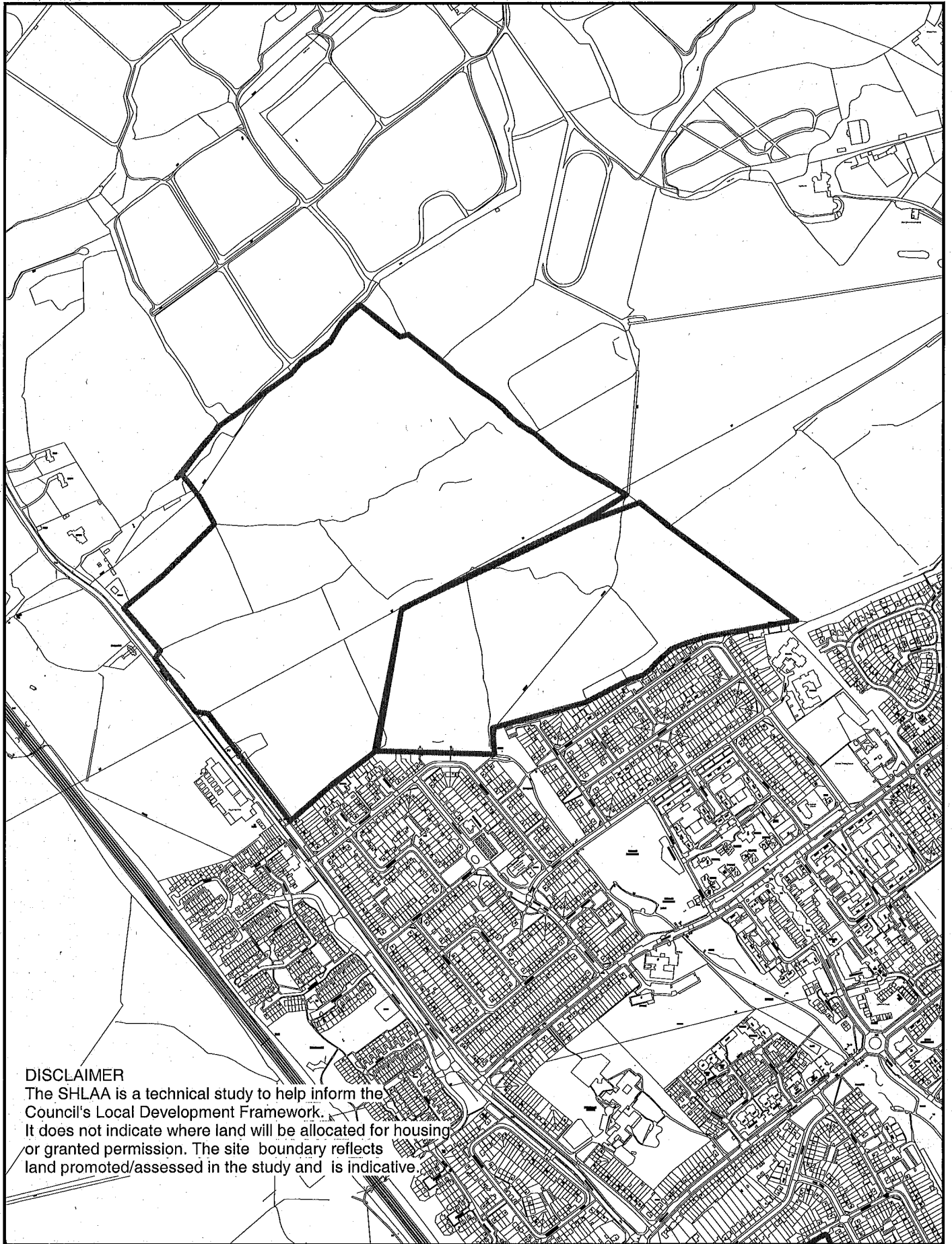

Reproduced from the Ordnance Survey mapping with the permission of the controller of Her Majesty's Stationery Office. Crown copyright. Unauthorised reproduction infringes Crown copyright and may lead to prosecution or civil proceedings. Hertsmere Borough Council Licence 10017428.;



NOT TO SCALE

S14 Fire and Ambulance Station, Elstree Way

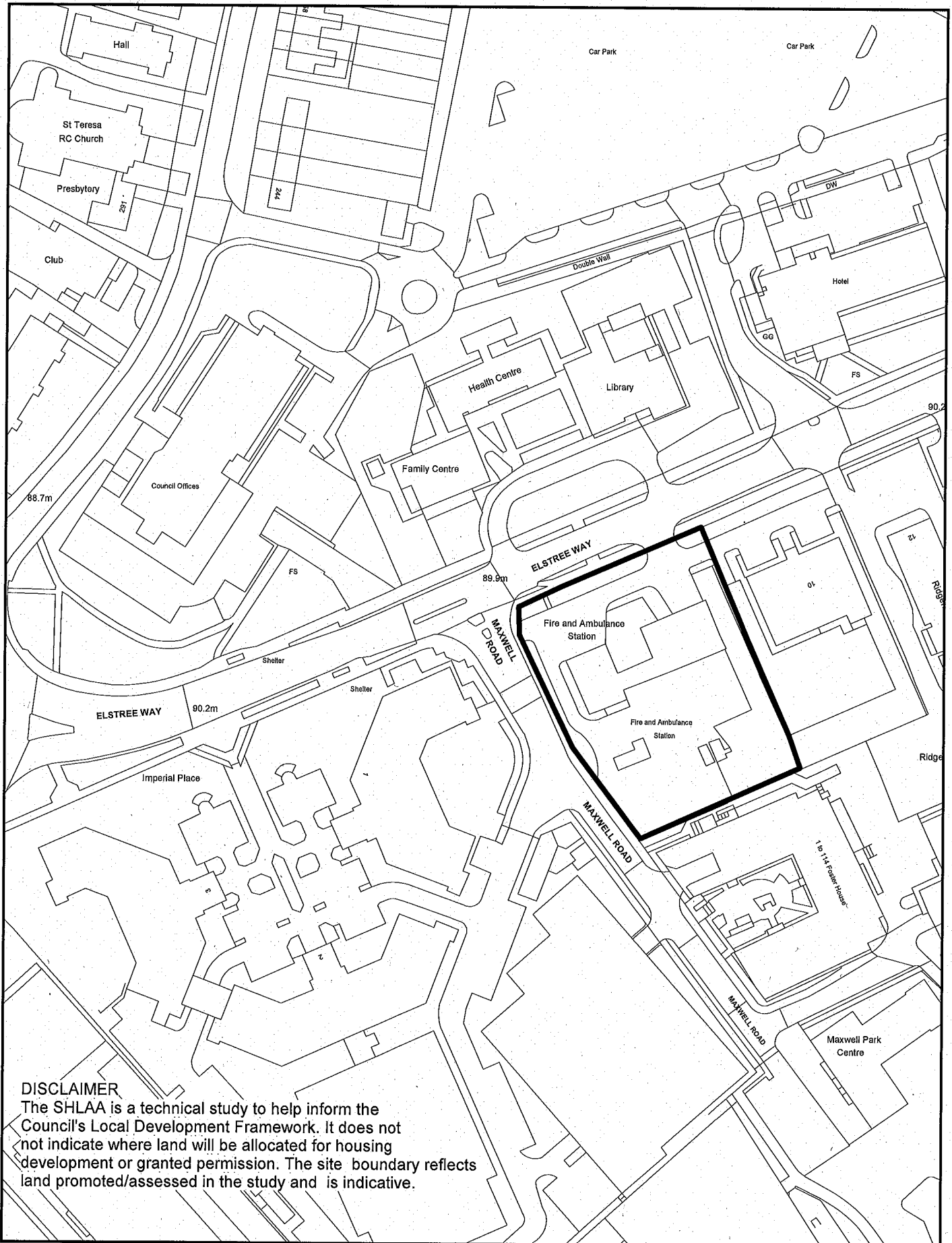

Reproduced from the Ordnance Survey mapping with the permission of the controller of Her Majesty's Stationery Office. Crown copyright. Unauthorised reproduction infringes Crown copyright and may lead to prosecution or civil proceedings. Hertsmere Borough Council Licence 10017428.;



NOT TO SCALE

S15 Borehamwood Library, Elstree Way

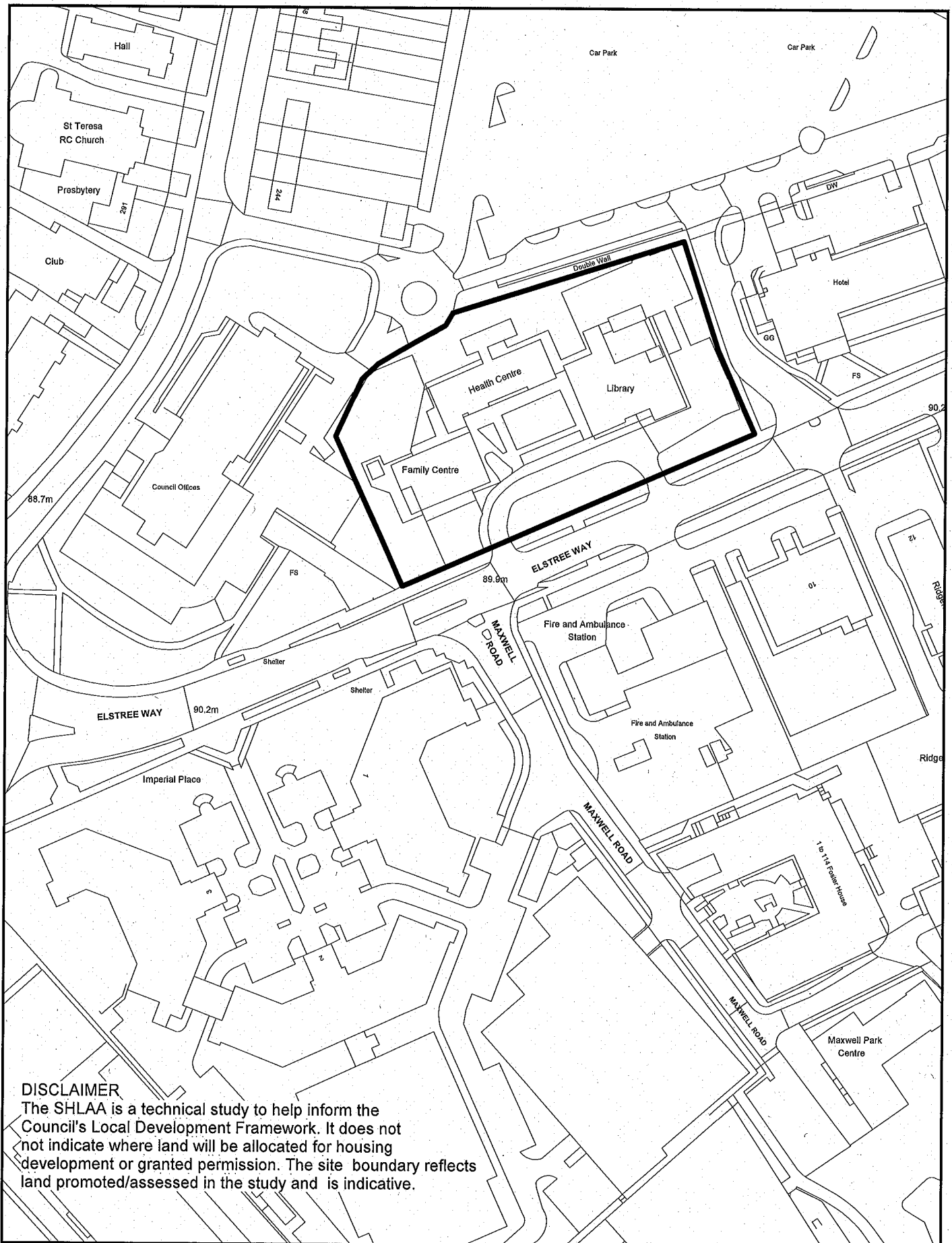

Reproduced from the Ordnance Survey mapping with the permission of the controller of Her Majesty's Stationery Office. Crown copyright. Unauthorised reproduction infringes Crown copyright and may lead to prosecution or civil proceedings. Hertsmere Borough Council Licence 10017428.;



NOT TO SCALE

S16 Oaklands College Site, Elstree Way, Borehamwood

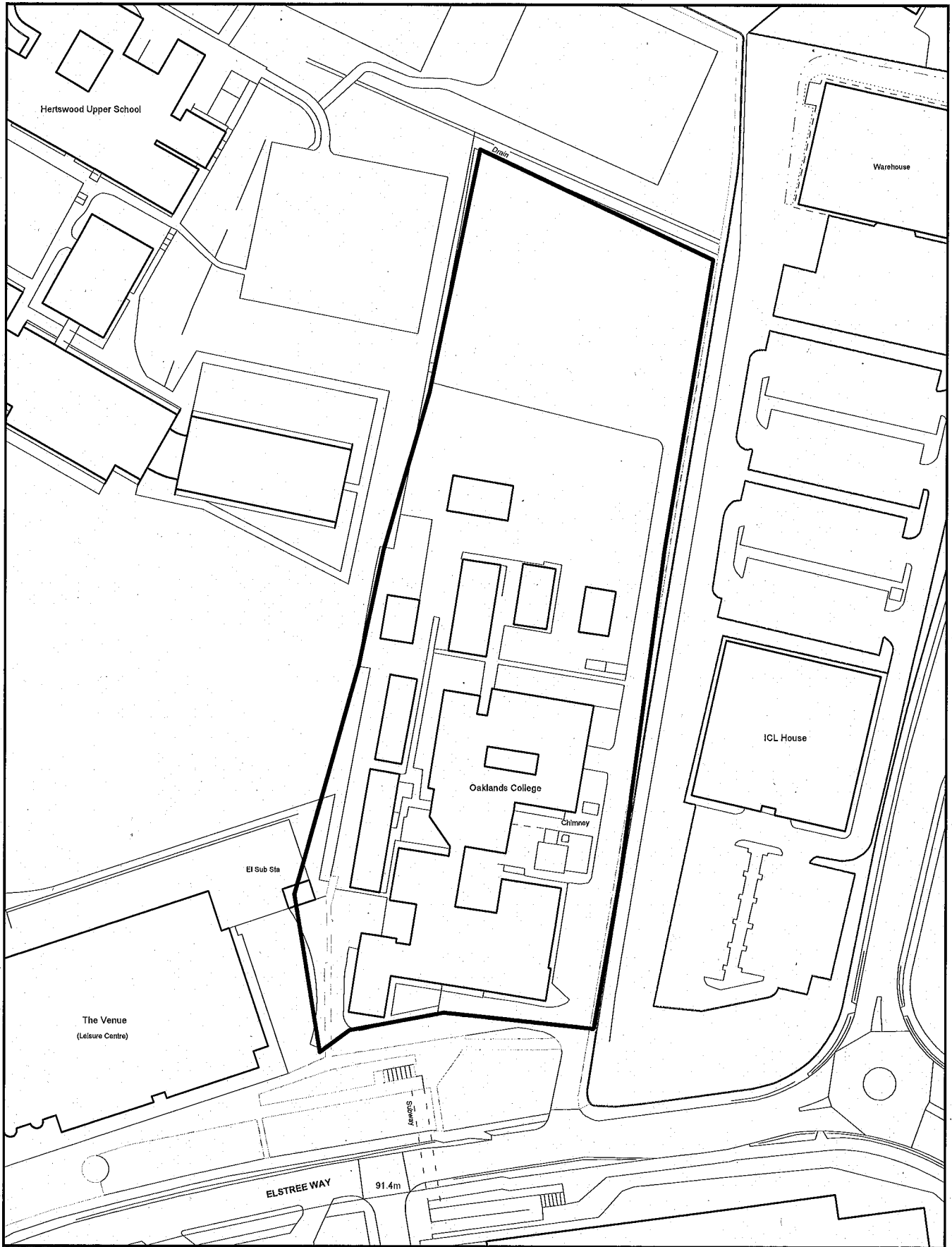

Reproduced from the Ordnance Survey mapping with the permission of the controller of Her Majesty's Stationery Office. Crown copyright. Unauthorised reproduction infringes Crown copyright and may lead to prosecution or civil proceedings.

Hertsmere Borough Council. Licence No:10017428



Scale: 1:1250

Date: 28 October 2009

S27 Elstree Distribution Centre, Elstree Way, Borehamwood



Scale: 1:2500
Date: 28 October 2009

Reproduced from the Ordnance Survey mapping with the permission of the controller of Her Majesty's Stationery Office. Crown copyright. Unauthorised reproduction infringes Crown copyright and may lead to prosecution or civil proceedings.

Hertsmere Borough Council. Licence No.10017428

S28 Former Sports Ground, Rowley Lane, Borehamwood

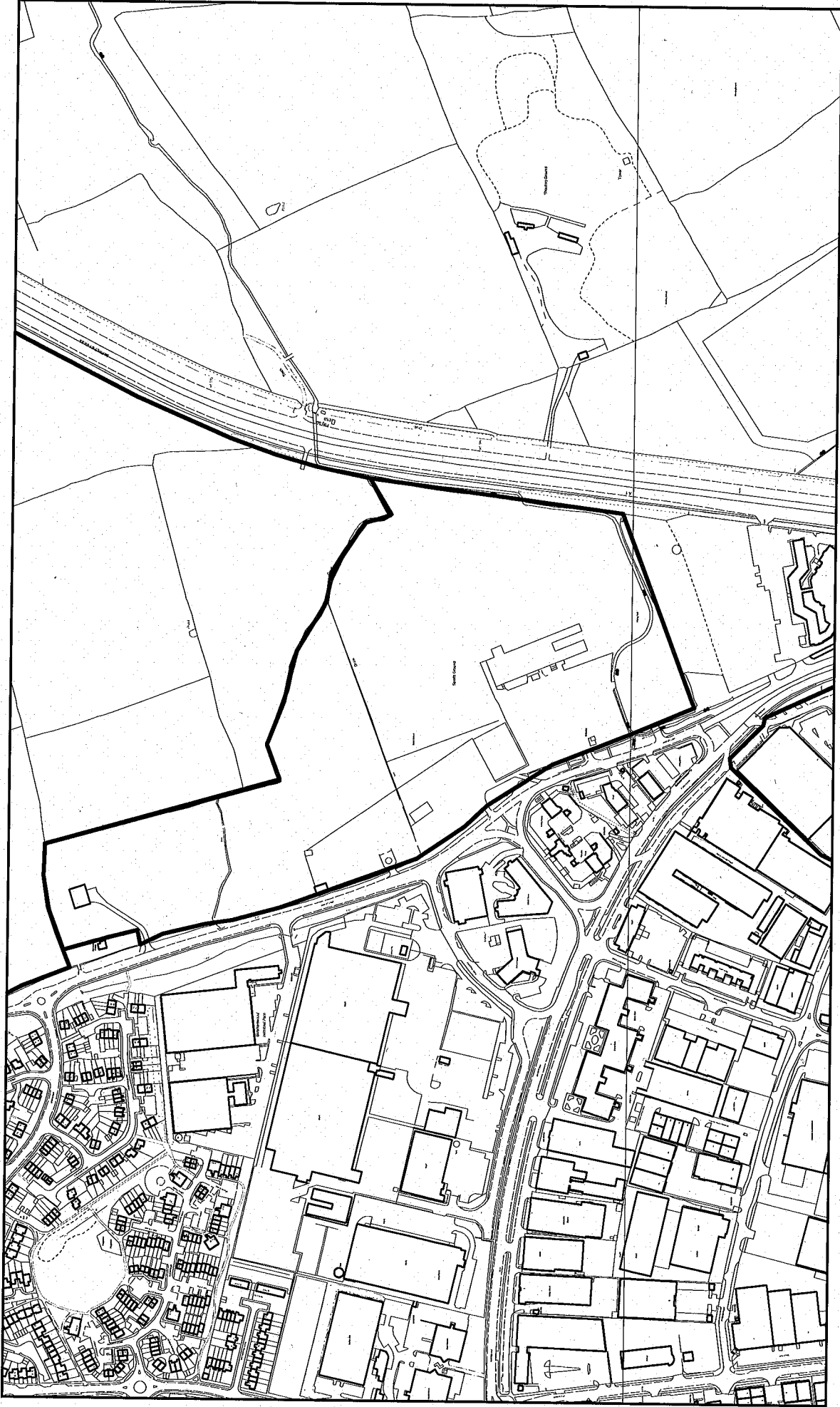

Date: 28 October 2009
Scale: 1:1250

Reproduced from the Ordnance Survey mapping with the permission of the controller of Her Majesty's Stationery Office. Crown copyright. Unauthorised reproduction infringes Crown copyright and may lead to prosecution or civil proceedings.

Hertsmere Borough Council. Licence No:10017428

S32 Land Rear of Hartfield Avenue, Borehamwood

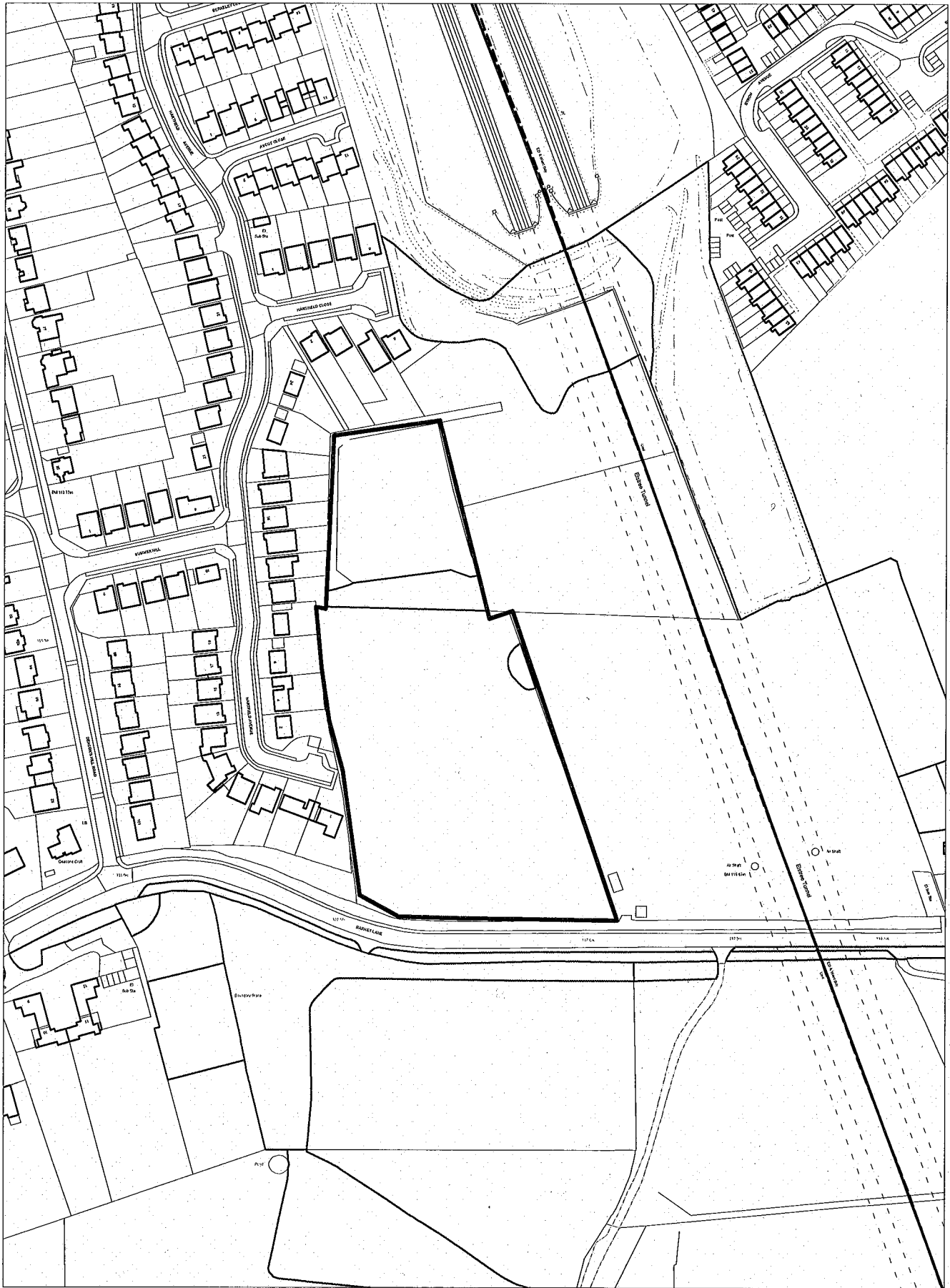

Reproduced from the Ordnance Survey mapping with the permission of the controller of Her Majesty's Stationery Office. Crown copyright. Unauthorised reproduction infringes Crown copyright and may lead to prosecution or civil proceedings.

Hertsmere Borough Council. Licence No:10017428



Date: 28 October 2009
Scale: 1:2500

S52 Land to Northeast of Borehamwood (Site A)

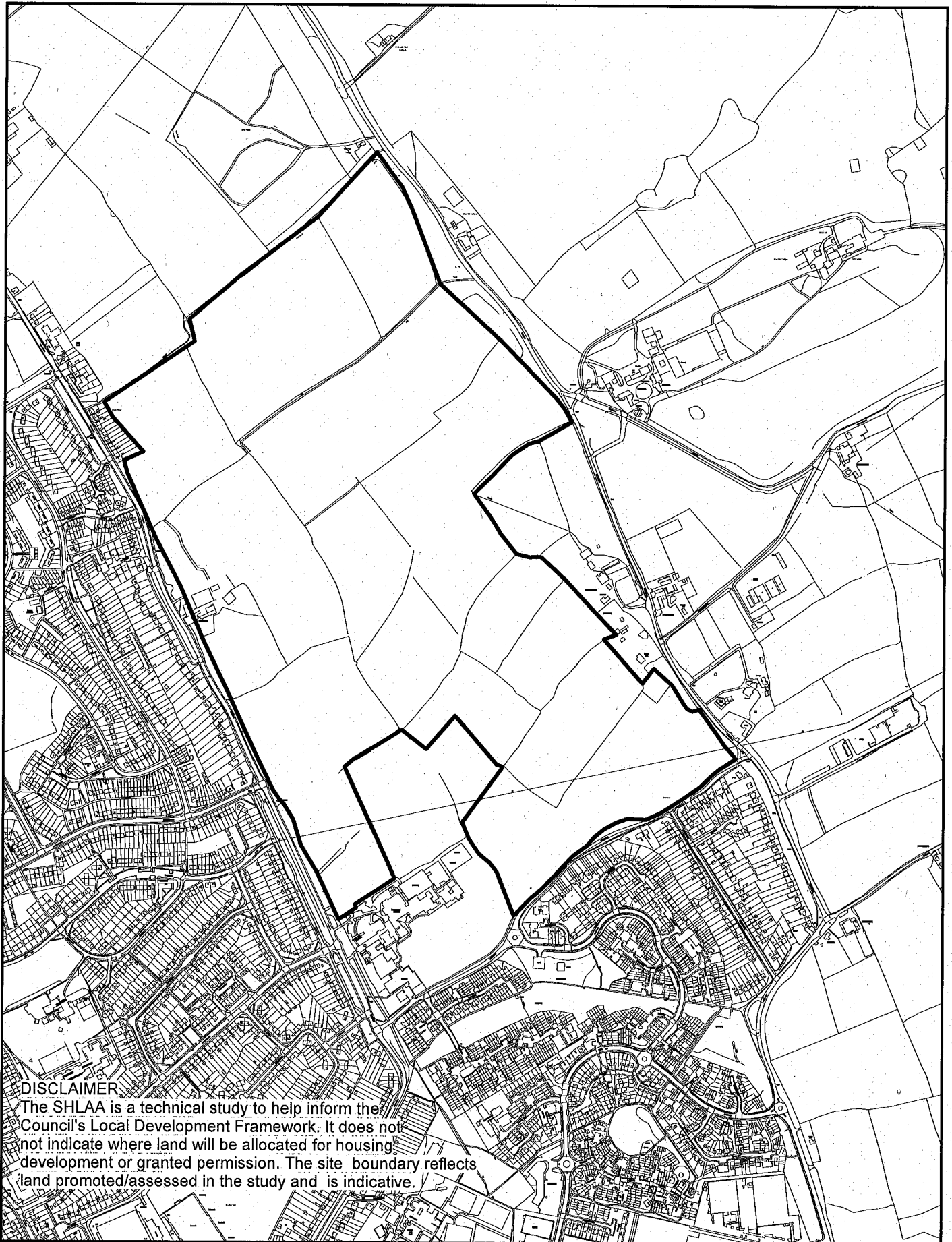

Reproduced from the Ordnance Survey mapping with the permission of the controller of Her Majesty's Stationery Office. Crown copyright. Unauthorised reproduction infringes Crown copyright and may lead to prosecution or civil proceedings. Hertsmere Borough Council Licence 10017428.;

S53 Land to Northeast of Borehamwood (Site B)

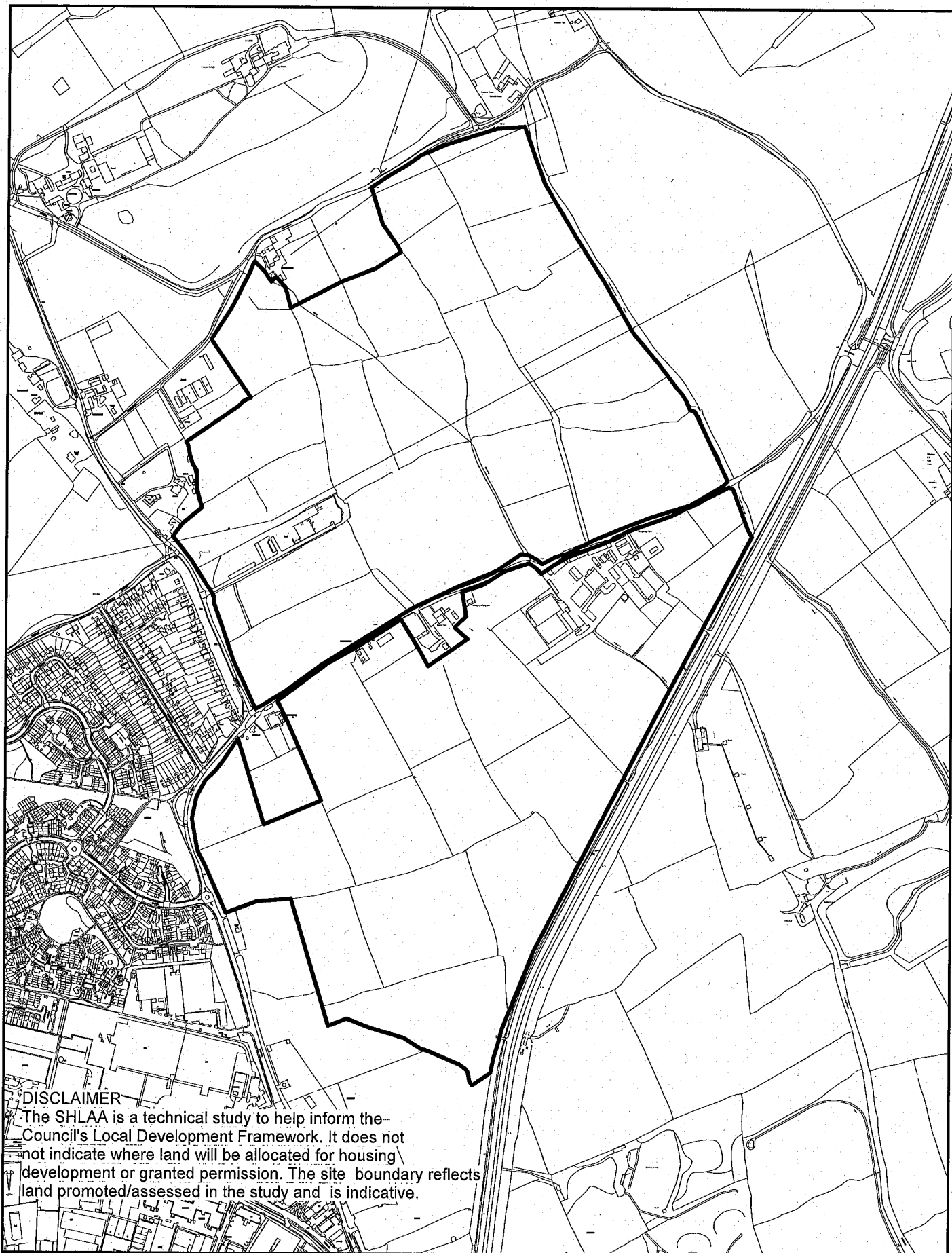

Reproduced from the Ordnance Survey mapping with the permission of the controller of Her Majesty's Stationery Office. Crown copyright. Unauthorised reproduction infringes Crown copyright and may lead to prosecution or civil proceedings. Hertsmere Borough Council Licence 10017428.;



NOT TO SCALE

S59 Vacant land to south of Borehamwood/Elstree Rail Station,

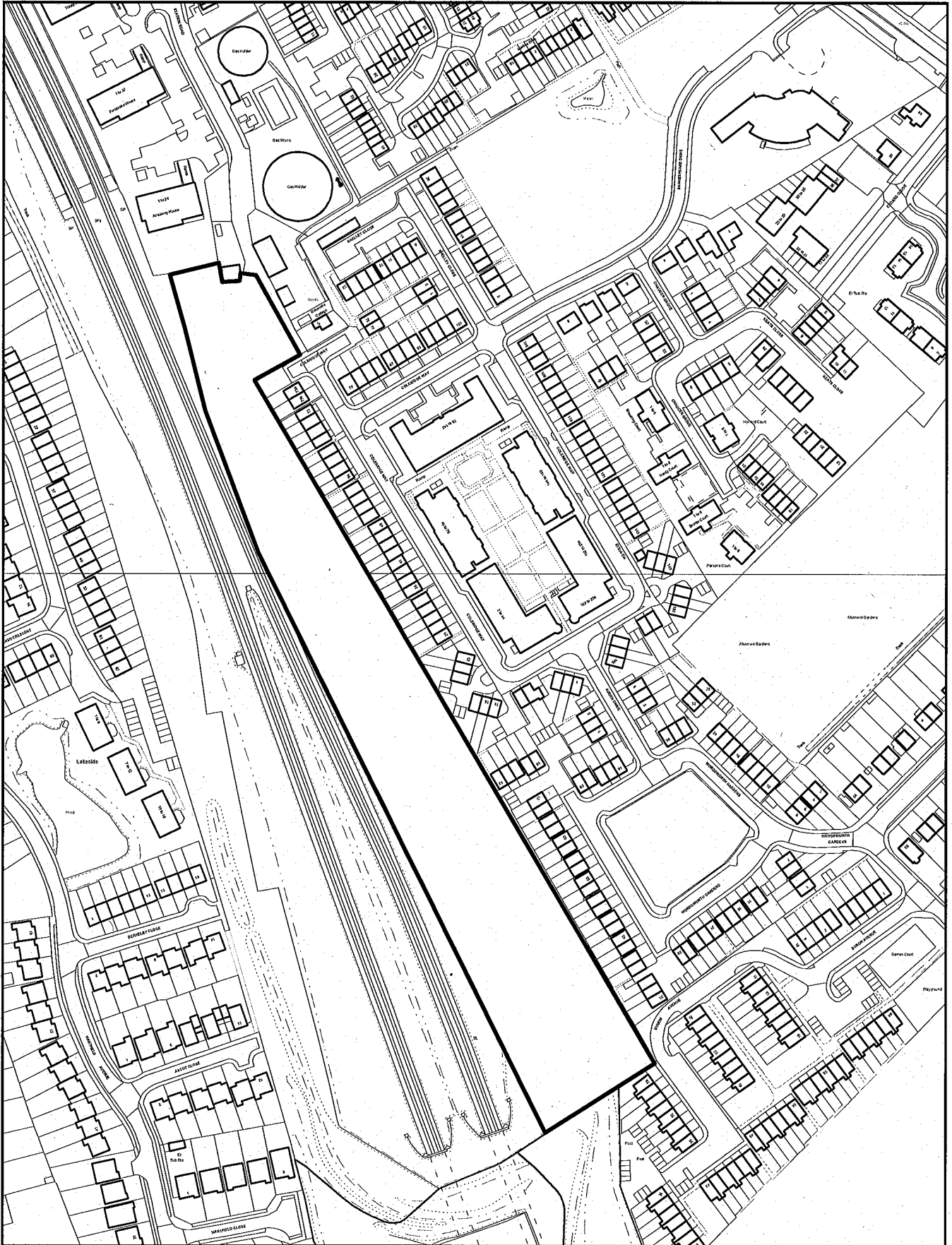

Reproduced from the Ordnance Survey mapping with the permission of the controller of Her Majesty's Stationery Office. Crown copyright. Unauthorised reproduction infringes Crown copyright and may lead to prosecution or civil proceedings.



Hertsmere Borough Council. Licence No:10017428

S61 57-59 Oakwood Avenue, Borehamwood

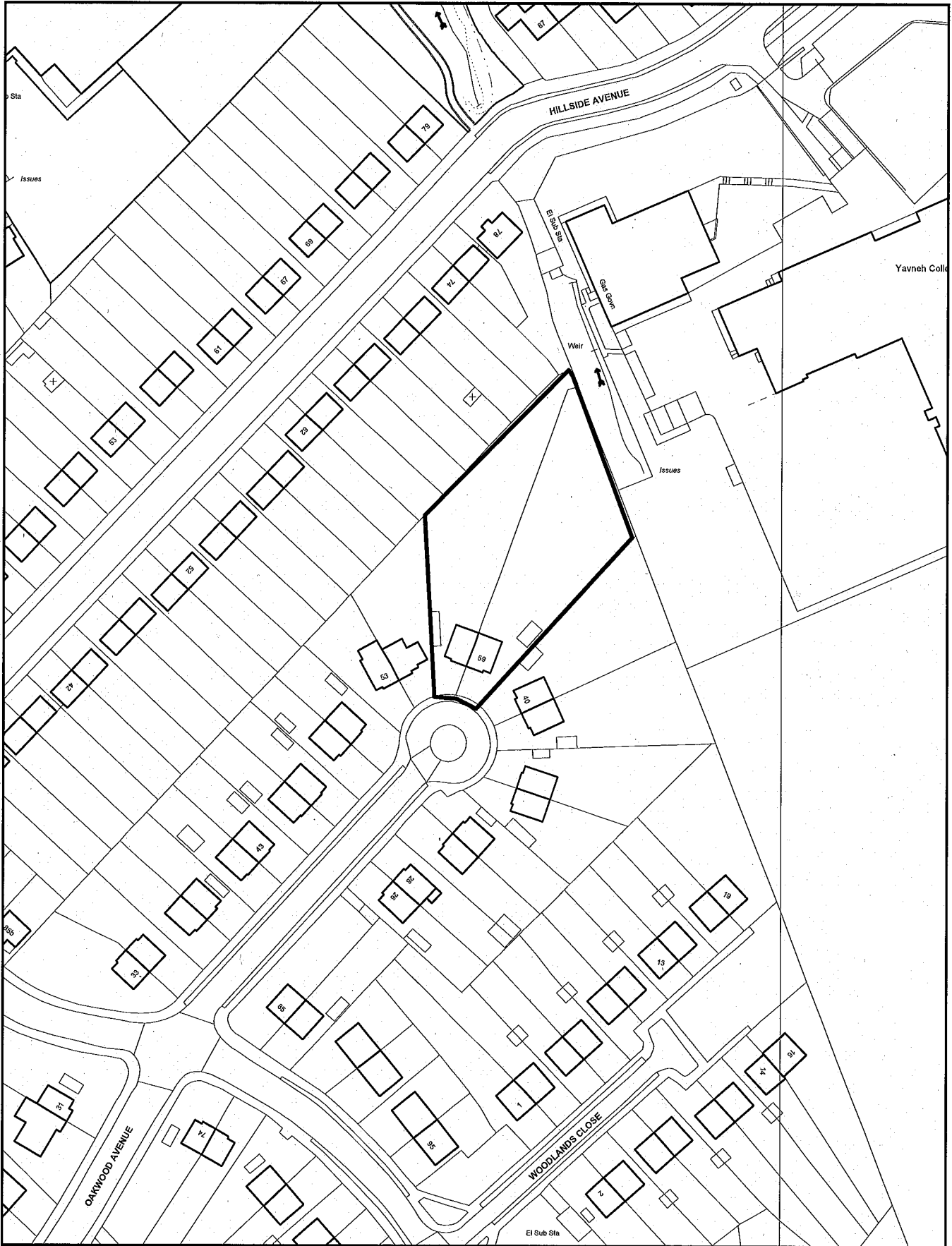

Reproduced from the Ordnance Survey mapping with the permission of the controller of Her Majesty's Stationery Office. Crown copyright. Unauthorised reproduction infringes Crown copyright and may lead to prosecution or civil proceedings.

Hertsmere Borough Council. Licence No:10017428



Scale: 1:1250
Date: 28 October 2009

S64 Oakleigh and Arden, Mildred Avenue Borehamwwod

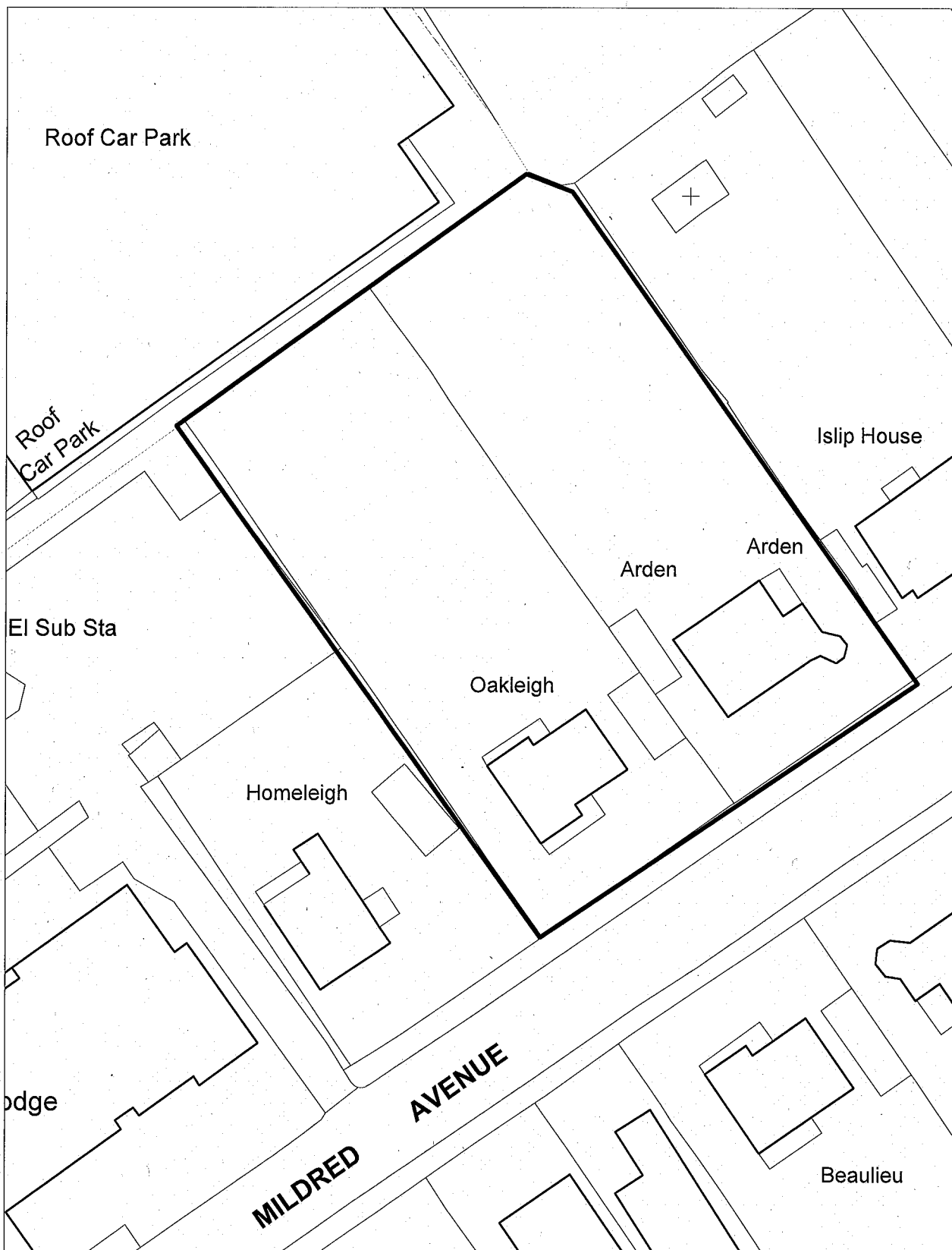

This copy has been produced specifically for Land and Property Search purposes only. No further copies may be made. Reproduced from the Ordnance Survey mapping with the permission of the controller of Her Majesty's Stationery Office. Crown copyright. Unauthorised reproduction infringes Crown copyright and may lead to prosecution or civil proceedings. Hertsmere Borough Council. Licence No:10017428



Scale 1:500
Date: 28 October 2009

S76 Suffolk Punch Howard Drive, Borehamwood



Reproduced from the Ordnance Survey mapping with the permission of the controller of Her Majesty's Stationery Office. Crown copyright. Unauthorised reproduction infringes Crown copyright and may lead to prosecution or civil proceedings.

Hertsmere Borough Council. Licence No:10017428

Scale: 1:500
Date: 28 October 2009



S129 Station Road Gas Holders, Borehamwood



Reproduced from the Ordnance Survey mapping with the permission of the controller of Her Majesty's Stationery Office. Crown copyright. Unauthorised reproduction infringes Crown copyright and may lead to prosecution or civil proceedings.

Hertsmere Borough Council. Licence No:10017428



Scale: 1:1250

Date: 28 October 2009

S131 Studio Plaza, Elstree Way, Borehamwood

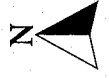

Scale: 1:2500
Date: 28 October 2009

Reproduced from the Ordnance Survey mapping with the permission of the controller of Her Majesty's Stationery Office. Crown copyright. Unauthorised reproduction infringes Crown copyright and may lead to prosecution or civil proceedings.

Hertsmere Borough Council. Licence No: 10017428

S132 East side of Glenhaven Avenue, Borehamwood

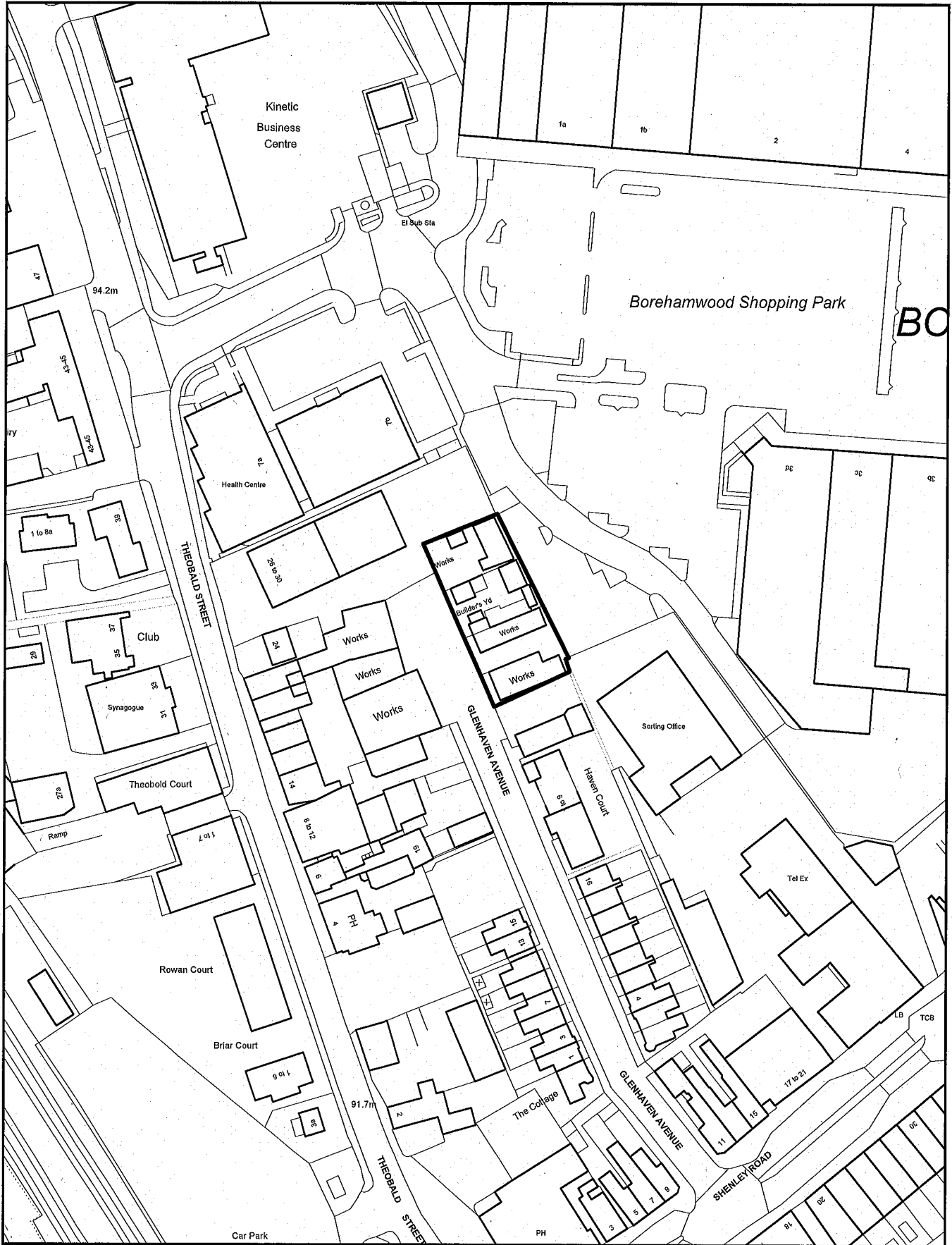

Reproduced from the Ordnance Survey mapping with the permission of the controller of Her Majesty's Stationery Office. Crown copyright. Unauthorised reproduction infringes Crown copyright and may lead to prosecution or civil proceedings.

Hertsmere Borough Council. Licence No:10017428



Scale: 1:1250
Date: 28 October 2009

133 43-47 Theobald Street, Borehamwood



Reproduced from the Ordnance Survey mapping with the permission of the controller of Her Majesty's Stationery Office. Crown copyright. Unauthorised reproduction infringes Crown copyright and may lead to prosecution or civil proceedings.

Hertsmere Borough Council. Licence No:10017428



Scale: 1:1250

Date: 28 October 2009

S137 Land rear of Crown Road Borehamwood

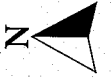

Scale: 1:1250
Date: 28 October 2009

Reproduced from the Ordnance Survey mapping with the permission of the controller of Her Majesty's Stationery Office. Crown copyright. Unauthorised reproduction infringes Crown copyright and may lead to prosecution or civil proceedings.

Hertsmere Borough Council. Licence No:10017428

S139 Undeveloped Land off Maxwell Road

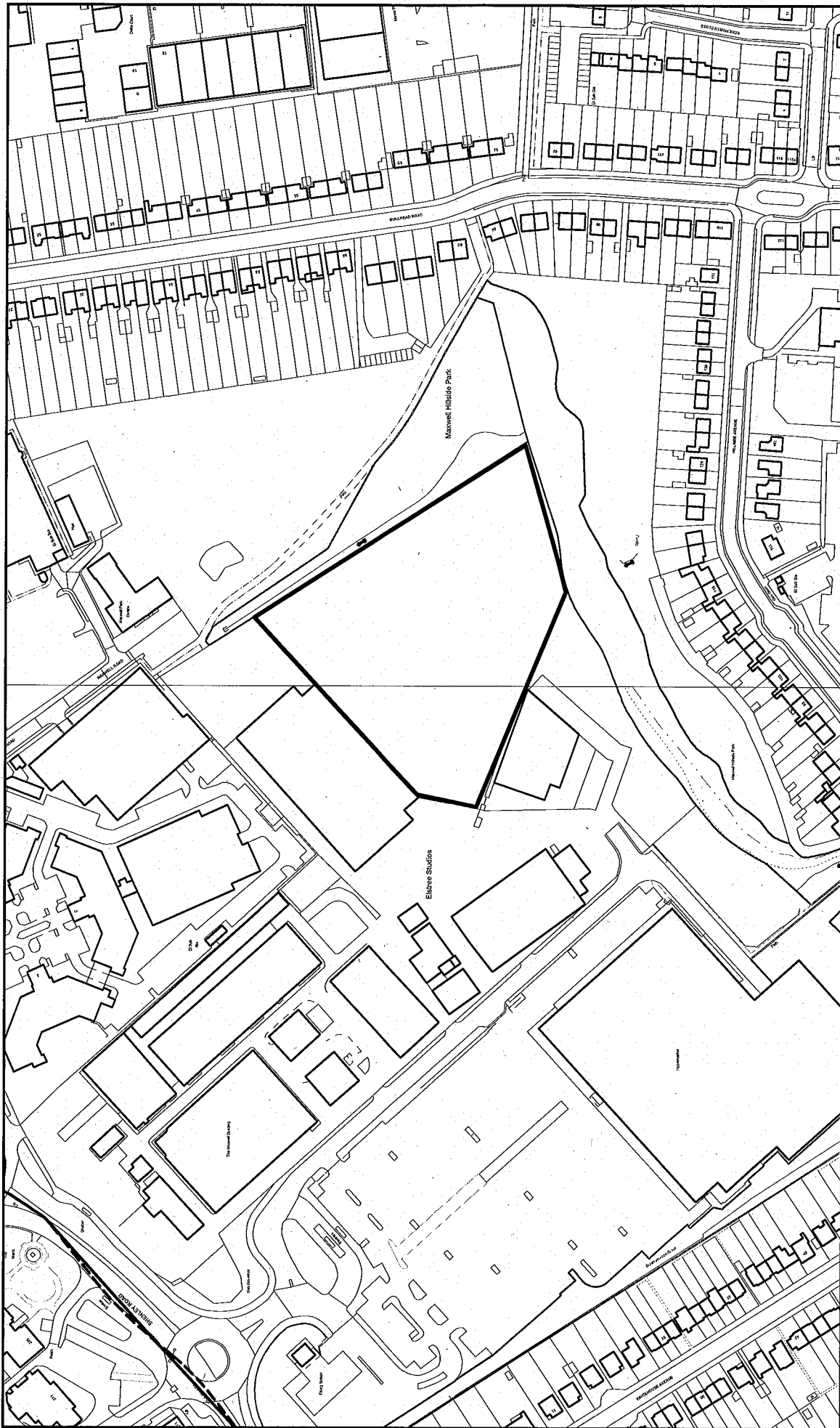

Scale: 1:2500
Date: 28 October 2009

Reproduced from the Ordnance Survey mapping with the permission of the controller of Her Majesty's Stationery Office. Crown copyright. Unauthorised reproduction infringes Crown copyright and may lead to prosecution or civil proceedings.

Hertsmere Borough Council. Licence No: 10017428

S142 Garages off Grove Road Borehamwood

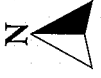
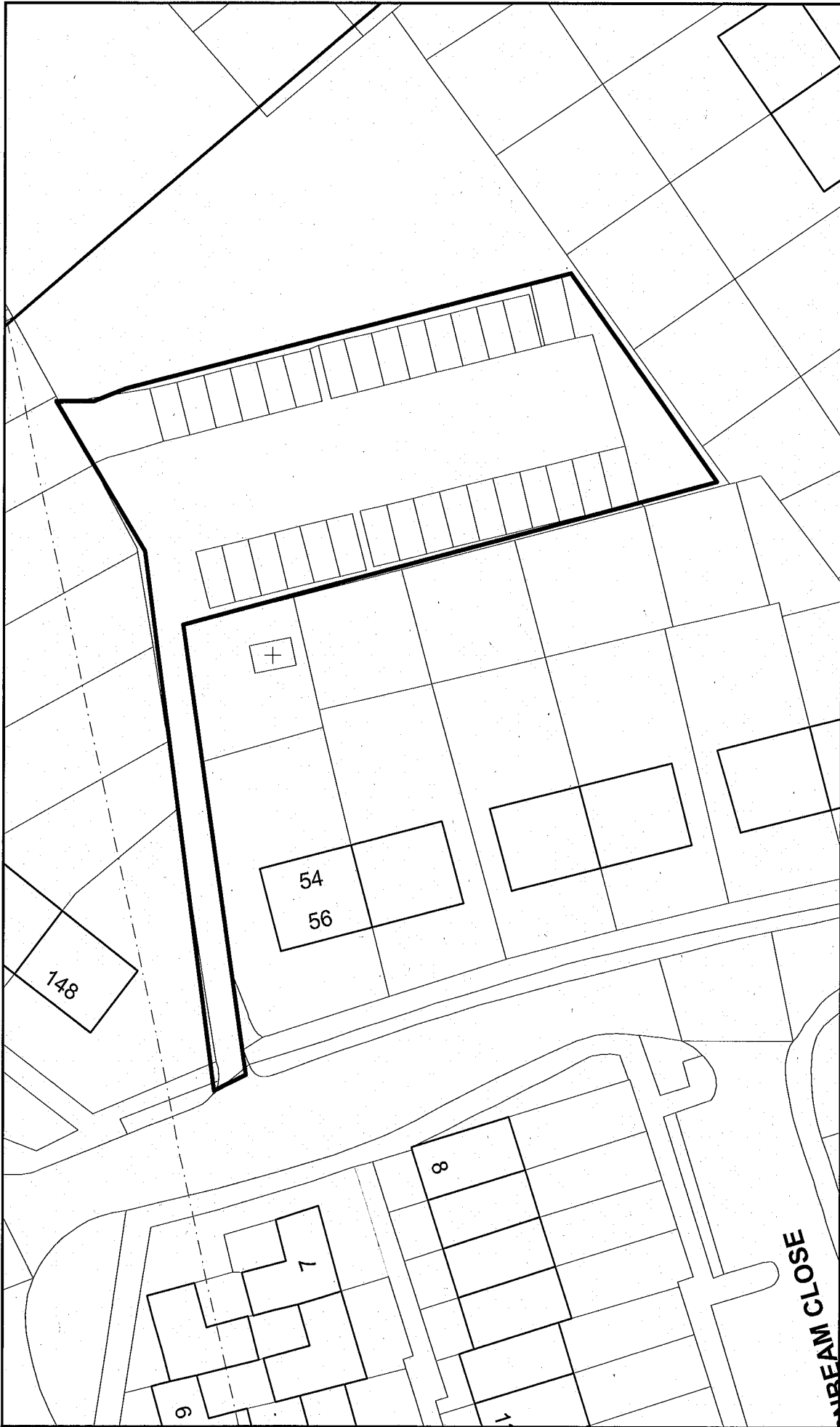

Scale: 1:500
Date: 28 October 2009

Reproduced from the Ordnance Survey mapping with the permission of the controller of Her Majesty's Stationery Office. Crown copyright. Unauthorised reproduction infringes Crown copyright and may lead to prosecution or civil proceedings.

Hertsmere Borough Council. Licence No:10017428

S143 Garage Courts, Masefield Avenue Borehamwood

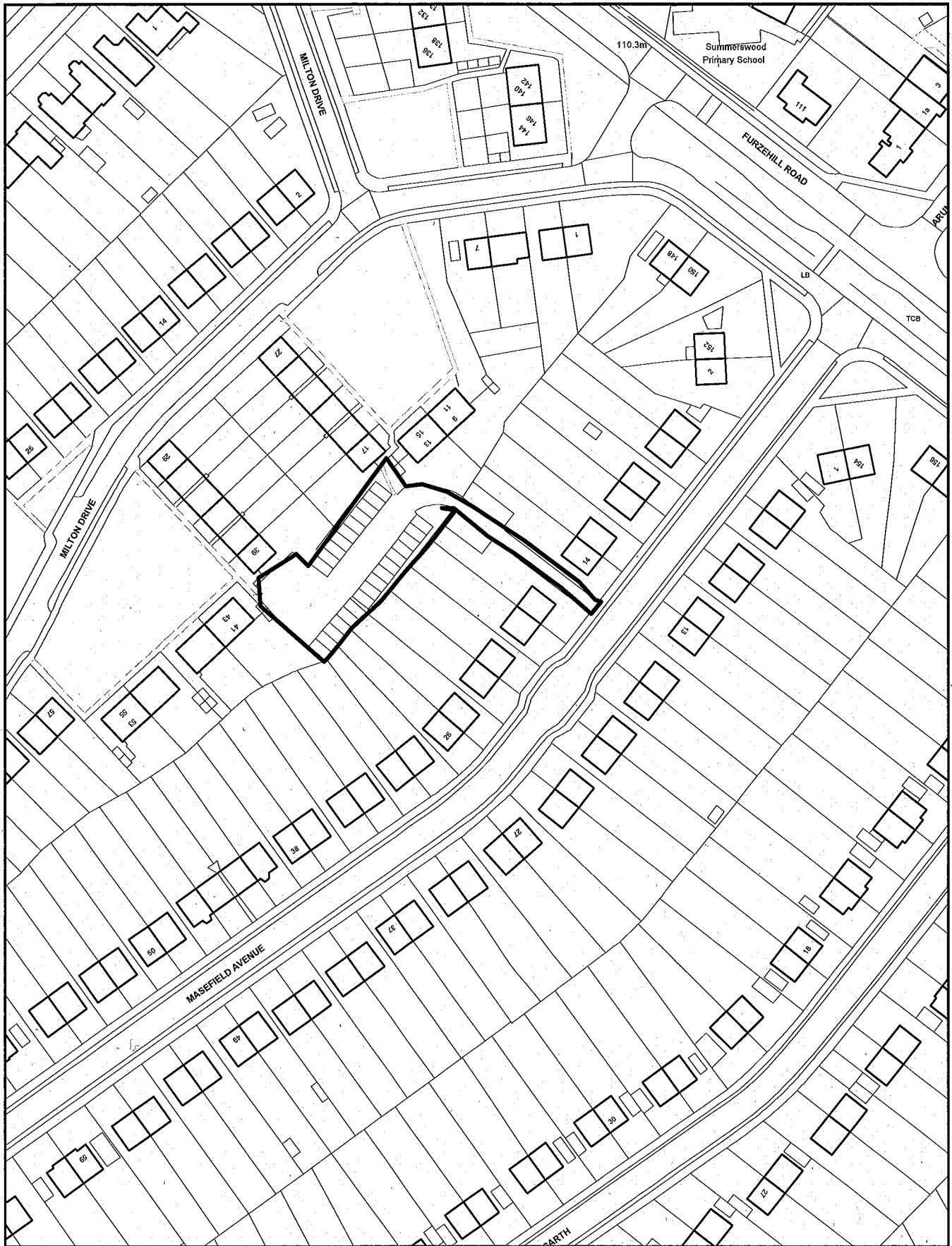

Reproduced from the Ordnance Survey mapping with the permission of the controller of Her Majesty's Stationery Office. Crown copyright. Unauthorised reproduction infringes Crown copyright and may lead to prosecution or civil proceedings.

Hertsmere Borough Council. Licence No:10017428



Scale: 1:1250
Date: 28 October 2009

S144 Garage Courts rear of 13-21 Hartforde Rd, Borehamwood

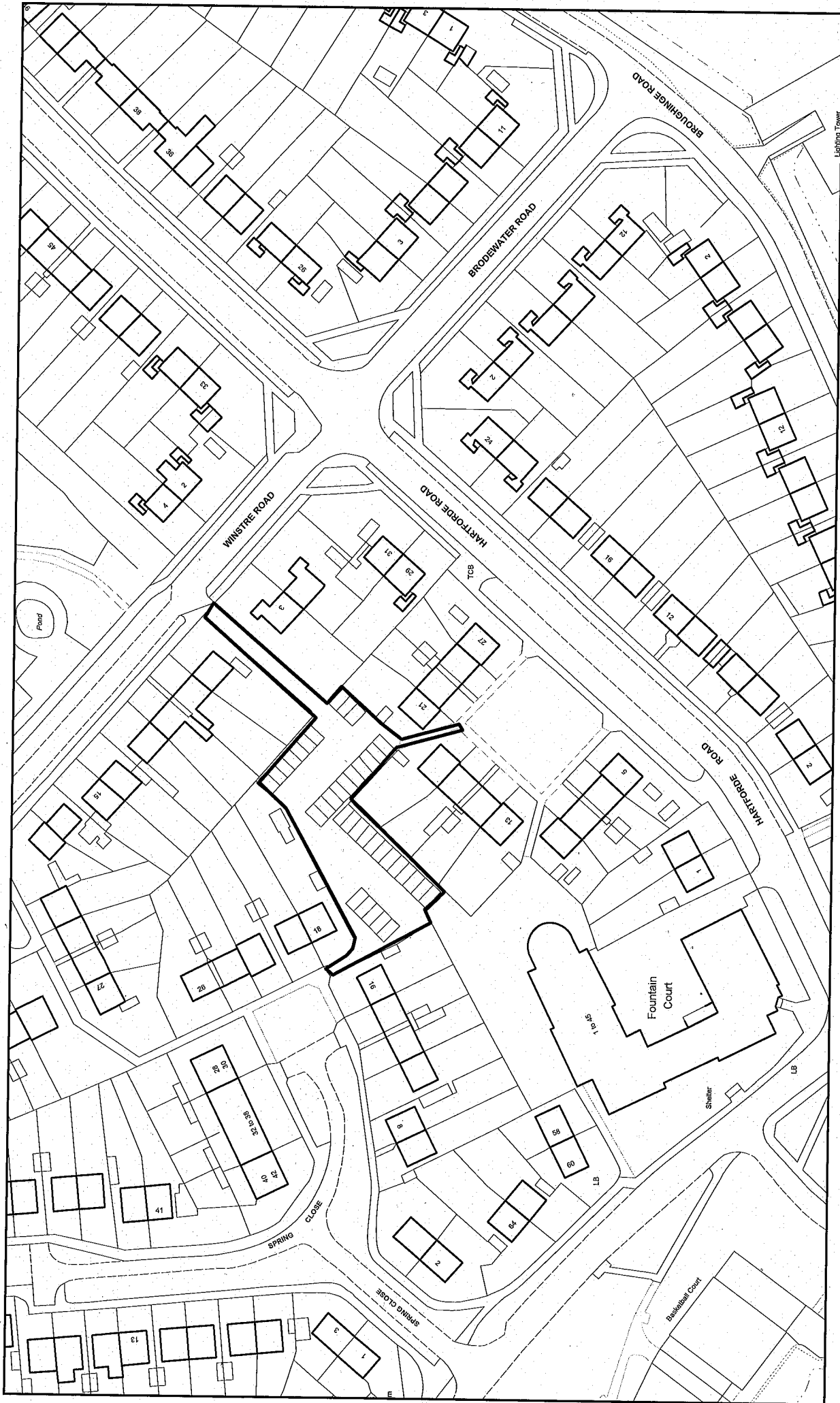

Reproduced from the Ordnance Survey mapping with the permission of the controller of Her Majesty's Stationery Office. Crown copyright. Unauthorised reproduction infringes Crown copyright and may lead to prosecution or civil proceedings.

Hertsmere Borough Council. Licence No:10017428

Scale: 1:1250
Date: 28 October 2009



S148 'JUNCTION ELSTREE WAY MANOR WAY BULLHEAD ROAD

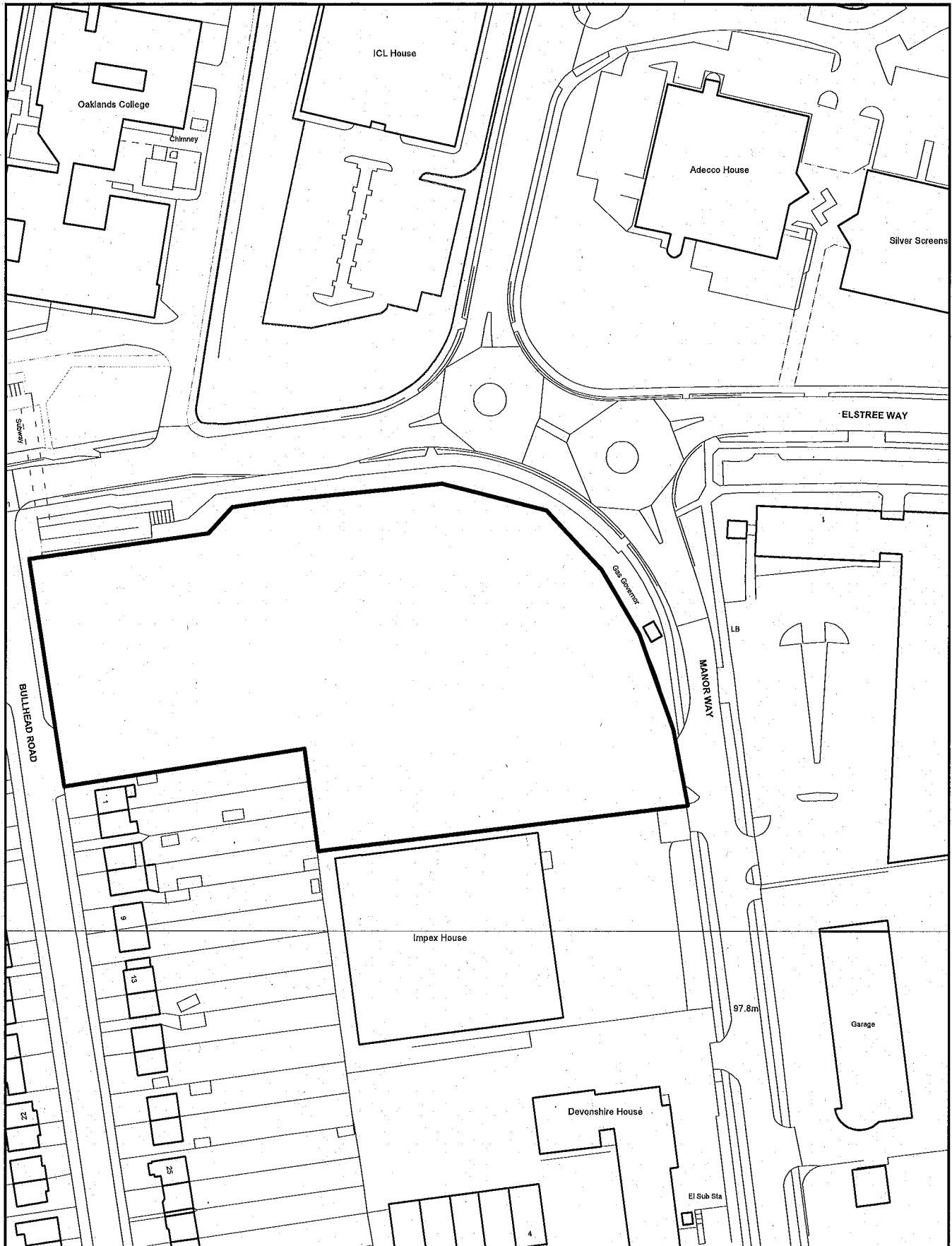

Reproduced from the Ordnance Survey mapping with the permission of the controller of Her Majesty's Stationery Office. Crown copyright. Unauthorised reproduction infringes Crown copyright and may lead to prosecution or civil proceedings.

Hertsmere Borough Council. Licence No:10017428



S150 Borehamwood Civic Car Park, Elstree Way Borehamwood

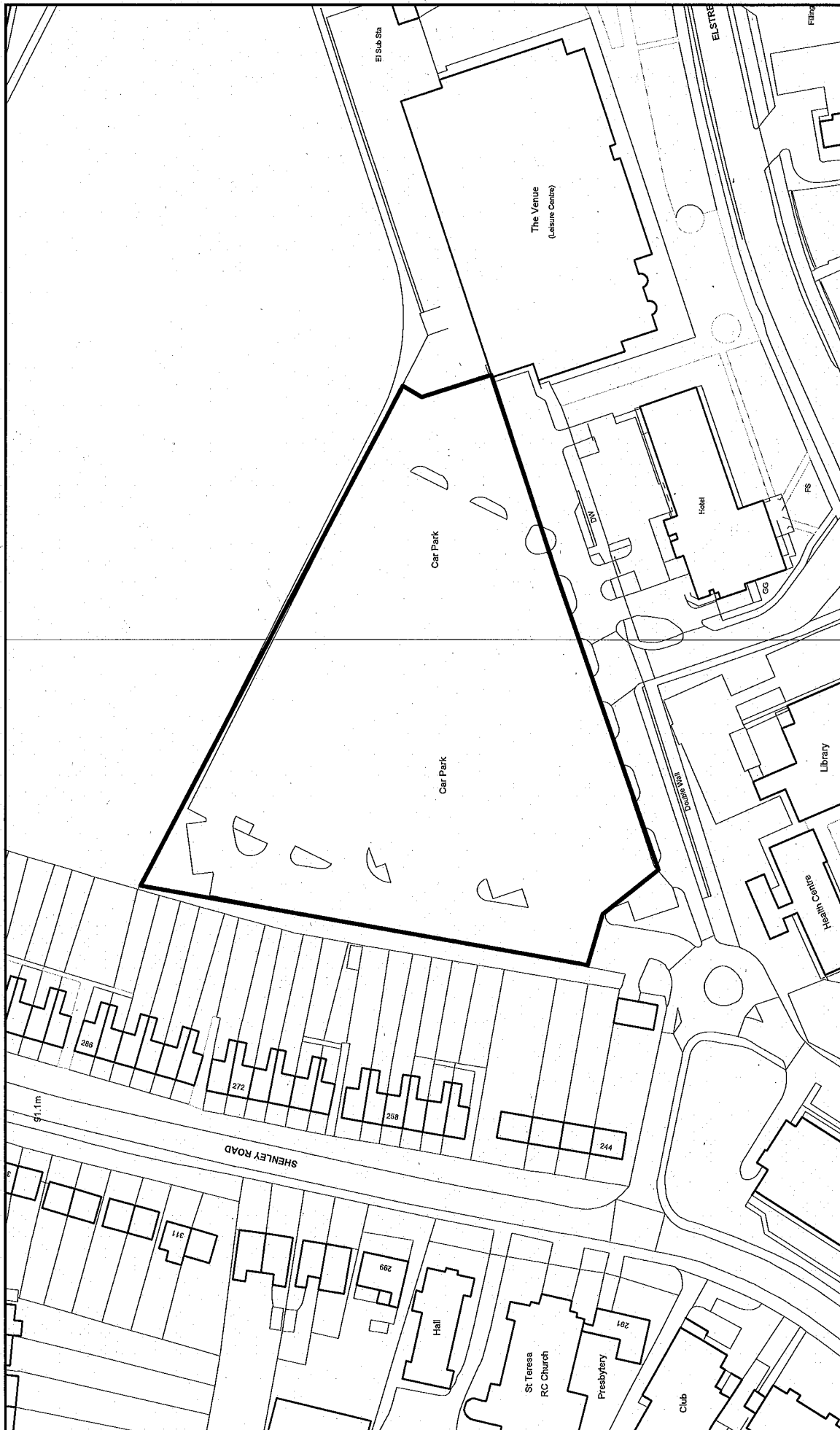

Scale: 1:1250
Date: 28 October 2009

Reproduced from the Ordnance Survey mapping with the permission of the controller of Her Majesty's Stationery Office. Crown copyright. Unauthorised reproduction infringes Crown copyright and may lead to prosecution or civil proceedings.

Hertsmere Borough Council. Licence No:10017428

S155 Job Centre Plus Elstree Way, Borehamwood

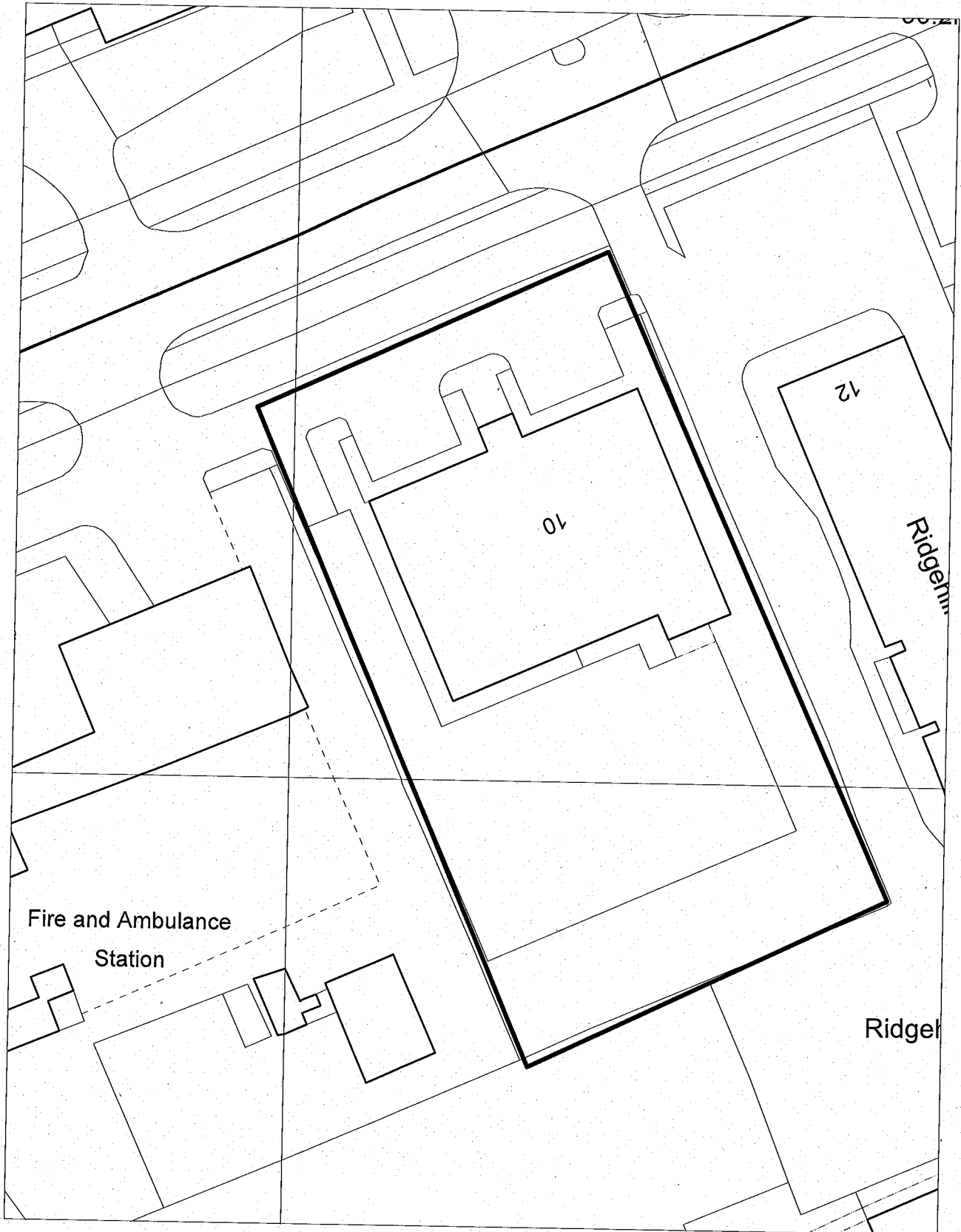

This copy has been produced specifically for Land and Property Search purposes only. No further copies may be made. Reproduced from the Ordnance Survey mapping with the permission of the controller of Her Majesty's Stationery Office. Crown copyright. Unauthorised reproduction infringes Crown copyright and may lead to prosecution or civil proceedings. Hertsmere Borough Council. Licence No:10017428



Scale 1:500
Date: 28 October 2009

S163 Land South of Borehamwood, above Rail Tunnels & North of Barnet Lane

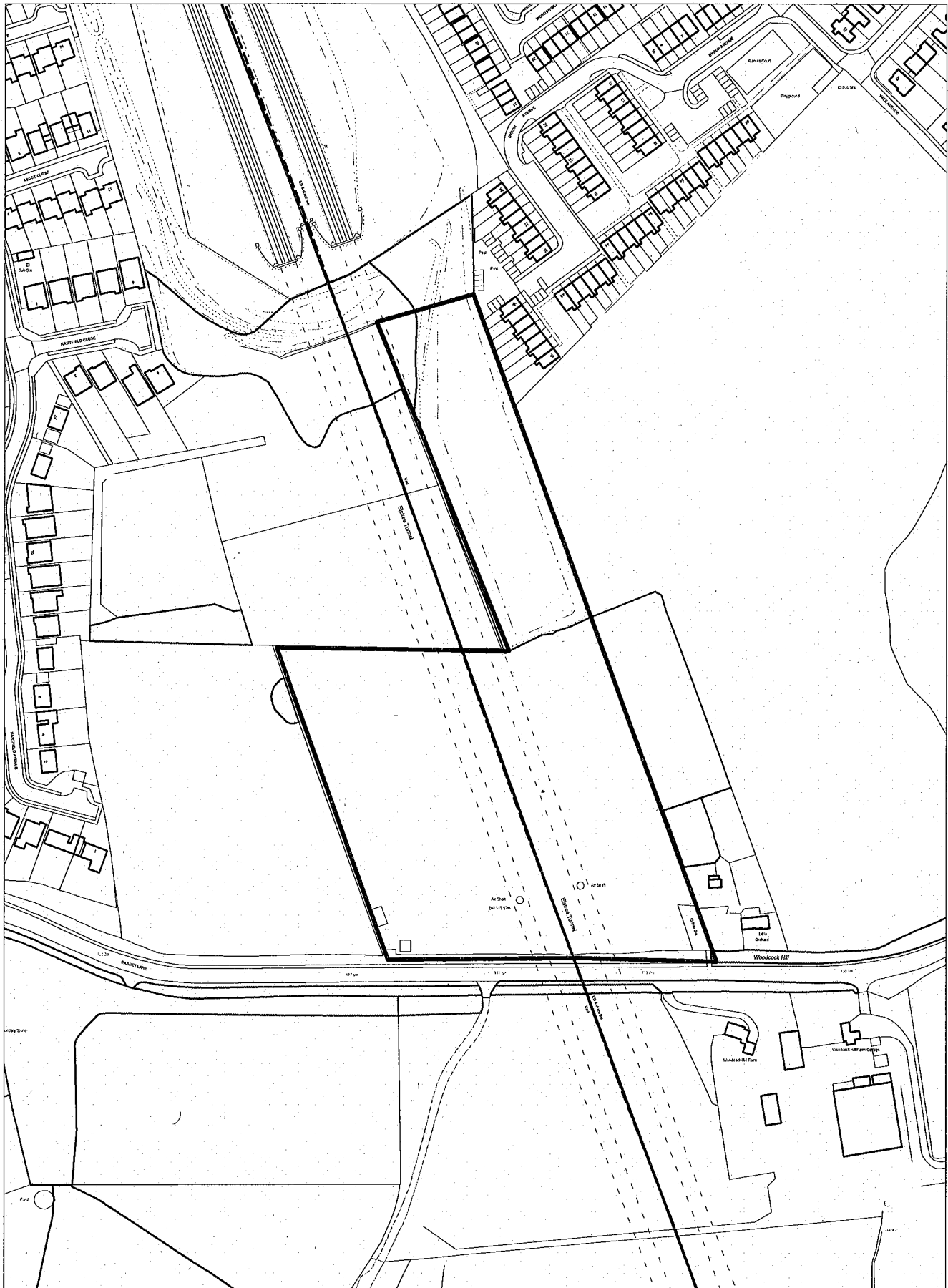

Reproduced from the Ordnance Survey mapping with the permission of the controller of Her Majesty's Stationery Office. Crown copyright. Unauthorised reproduction infringes Crown copyright and may lead to prosecution or civil proceedings.

Hertsmere Borough Council. Licence No:10017428



Date: 28 October 2009
Scale: 1:2500

S199 Land at Allum Lane (next to Borehamwood Station)



Reproduced from the Ordnance Survey mapping with the permission of the controller of Her Majesty's Stationery Office. Crown copyright. Unauthorised reproduction infringes Crown copyright and may lead to prosecution or civil proceedings.

Hertsmere Borough Council. Licence No:10017428



Scale: 1:1250
Date: 20100108

S40J Elstree Way Corridor Masterplan Area.

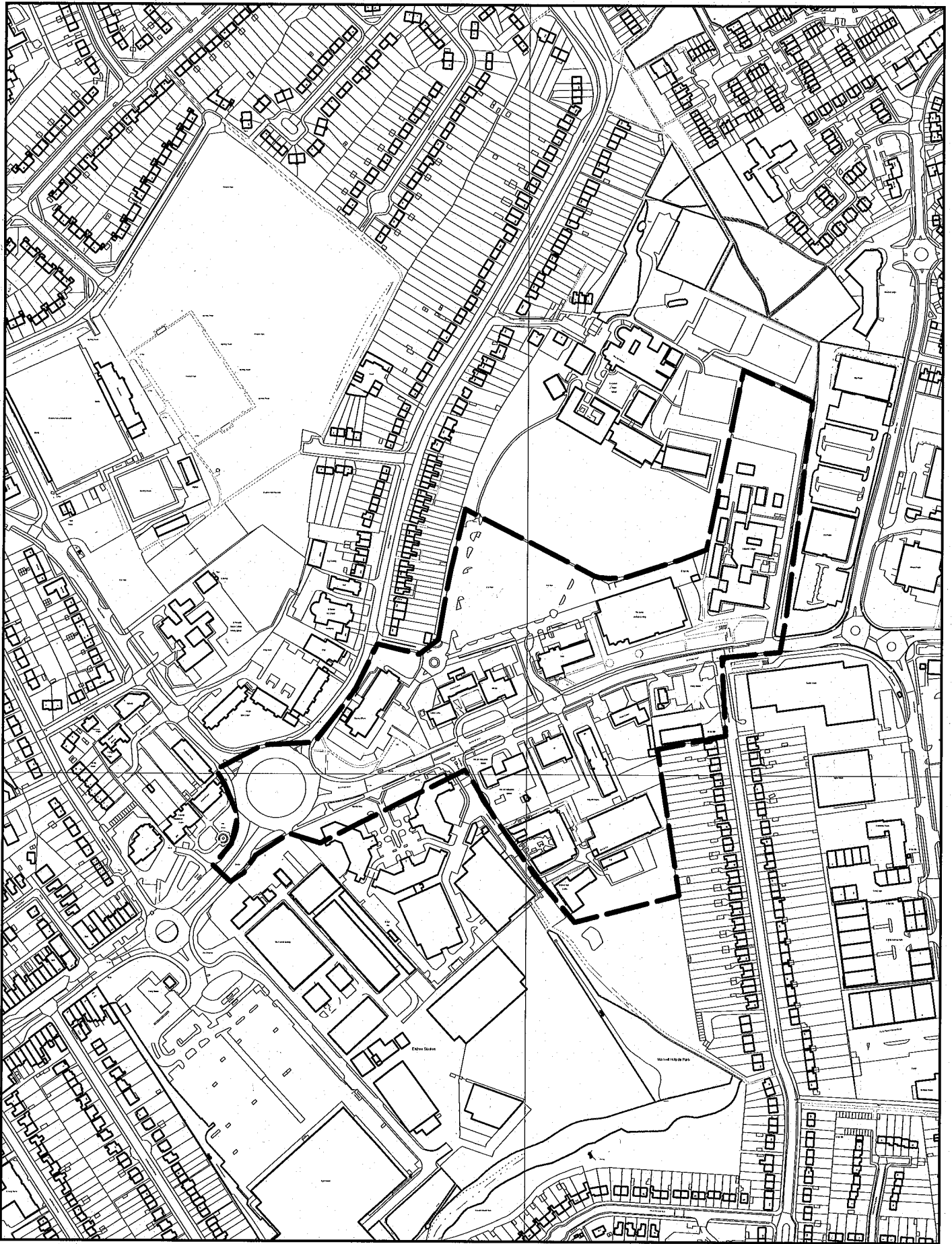

Reproduced from the Ordnance Survey mapping with the permission of the controller of Her Majesty's Stationery Office. Crown copyright. Unauthorised reproduction infringes Crown copyright and may lead to prosecution or civil proceedings.

Hertsmere Borough Council. Licence No:10017428



Scale: NOT TO SCALE

Date: August 2010