

**Hertsmere Borough Council  
Strategic Housing Land Availability Assessment**

**Part Two - Section 1**

**BOREHAMWOOD  
LOCATION PLANS**

## **IMPORTANT INFORMATION – PLEASE READ**

### **Development Status**

This document contains details of land and sites identified to the Council as available for development. It is part of a technical study to assess future housing land supply. The Council is not at this stage proposing these sites as development land. Inclusion in the study does not oblige or imply that the Council will grant planning permission for residential development. Any planning application that comes forward will continue to be considered against current policies in national guidance, the Hertsmere Local Plan (Adopted 2003) and emerging Core Strategy.

### **Sites on Green Belt Land**

The SHLAA study considers urban sites as well as greenfield and Green Belt land. This does not mean the Council have accepted the principle of the release any land from the Green Belt. The assessment made in the study that a site has potential does not amount to 'special circumstances' for development or alter its Green Belt status. The Council will continue to resist speculative applications for housing development on Green Belt land until changes are agreed in an adopted development plan. The Council's future approach to the Green Belt will be set out in its Core Strategy document which will be subject to full public consultation.

### **Consultation on sites**

The SHLAA is a necessary technical exercise produced in consultation with local development stakeholders. The purpose of the study is to assess the amount of land with **potential** for housing and not to test whether each individual site is acceptable. Sites identified have not been subject to neighbour or wider public consultation as there is no certainty they will be allocated for development. If a planning application is received, then local consultation will take place in accordance with planning regulations. Following the adoption of a Core Strategy, the Council will publish preferred options for specific development sites which will be subject to extensive public consultation.

### **Limitations of site and Assessment Information**

Details of site constraints and boundaries are based on the information provided from agents and landowners. The SHLAA does not limit an extension or contraction of these boundaries for the purpose of a planning application. Other constraints may exist which have not been identified.

### **Ownership**

The majority of sites assessed are in private ownership. The inclusion of a site owned by the Council or County Council does not mean a formal decision has been made to sell, develop or dispose of it.

## S2 Land north of Barnet Lane



### DISCLAIMER

The SHLAA is a technical study to help inform the Council's Local Development Framework. It does not indicate where land will be allocated for housing or granted permission. The site boundary reflects land promoted/assessed in the study and is indicative.

Reproduced from the Ordnance Survey mapping with the permission of the controller of Her Majesty's Stationery Office. Crown copyright. Unauthorised reproduction infringes Crown copyright and may lead to prosecution or civil proceedings. Hertsmere Borough Council Licence 10017428.;



NOT TO SCALE

# S5 Instalcom site, Manor Way

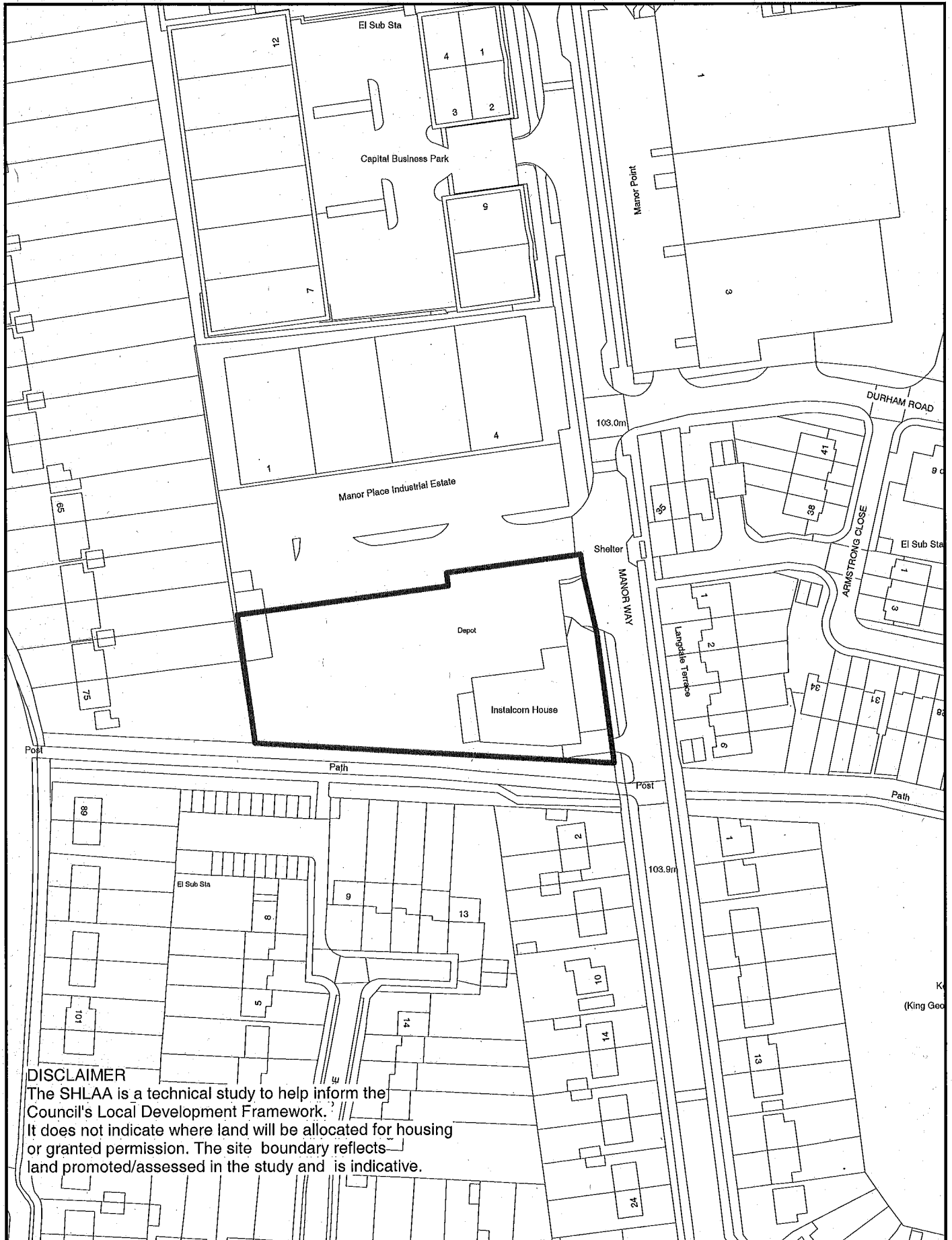

**DISCLAIMER**

The SHLAA is a technical study to help inform the Council's Local Development Framework. It does not indicate where land will be allocated for housing or granted permission. The site boundary reflects land promoted/assessed in the study and is indicative.

Reproduced from the Ordnance Survey mapping with the permission of the controller of Her Majesty's Stationery Office. Crown copyright. Unauthorised reproduction infringes Crown copyright and may lead to prosecution or civil proceedings. Hertsmere Borough Council Licence 10017428.;



**NOT TO SCALE**

## S8 Land off east side of Theobald Street

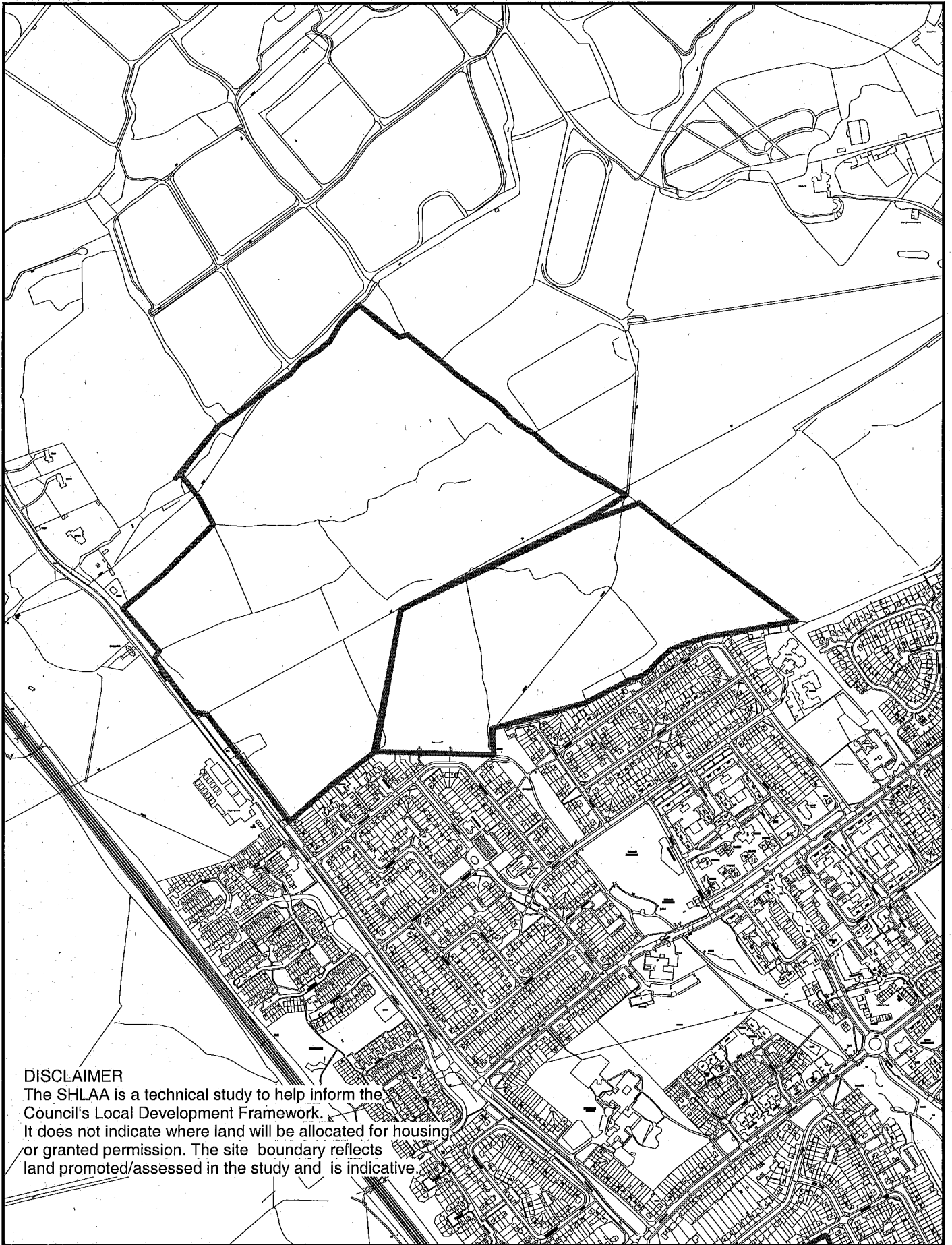

### DISCLAIMER

The SHLAA is a technical study to help inform the Council's Local Development Framework. It does not indicate where land will be allocated for housing or granted permission. The site boundary reflects land promoted/assessed in the study and is indicative.

Reproduced from the Ordnance Survey mapping with the permission of the controller of Her Majesty's Stationery Office. Crown copyright. Unauthorised reproduction infringes Crown copyright and may lead to prosecution or civil proceedings. Hertsmere Borough Council Licence 10017428.;



NOT TO SCALE

# S14 Fire and Ambulance Station, Elstree Way

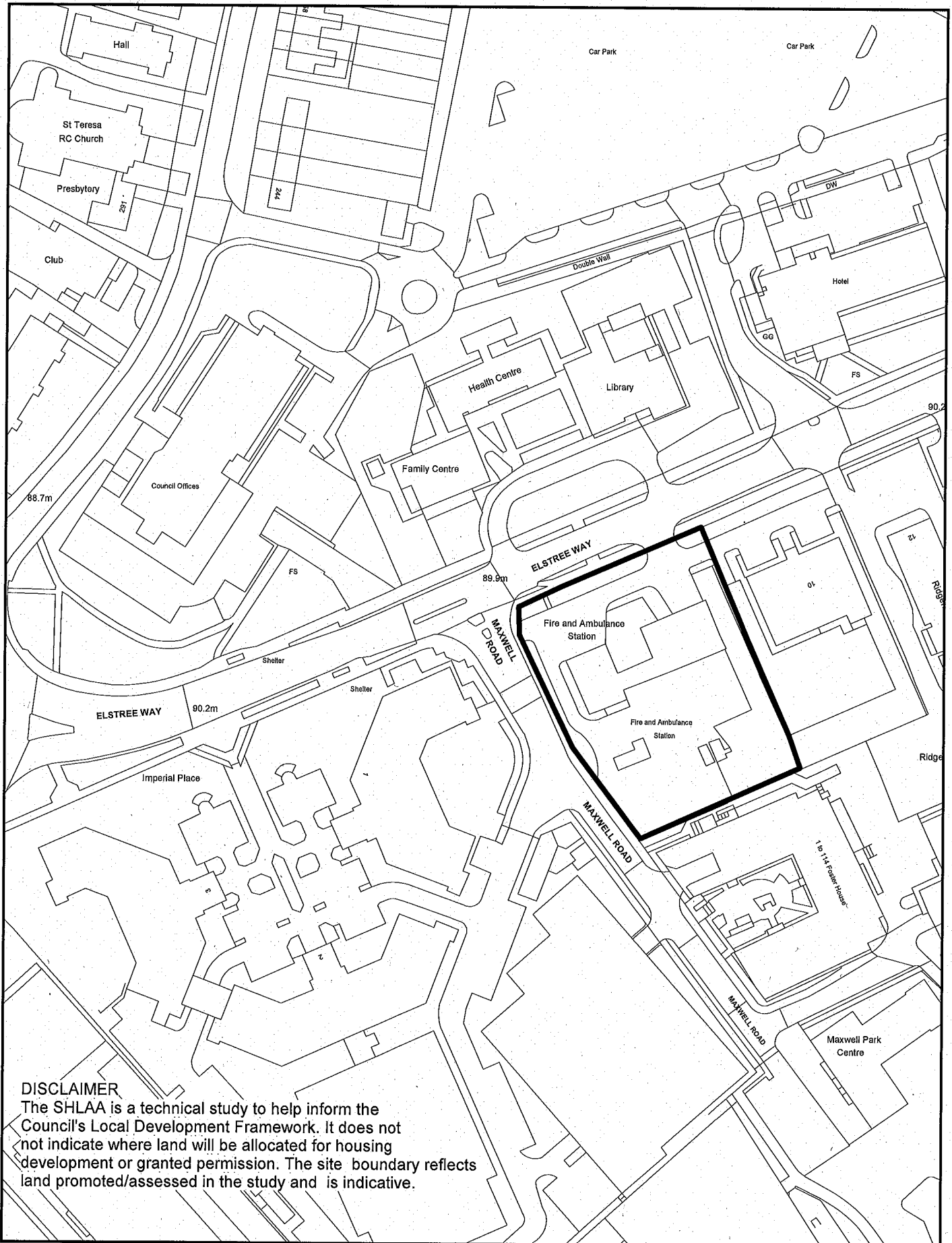

Reproduced from the Ordnance Survey mapping with the permission of the controller of Her Majesty's Stationery Office. Crown copyright. Unauthorised reproduction infringes Crown copyright and may lead to prosecution or civil proceedings. Hertsmere Borough Council Licence 10017428.;



NOT TO SCALE

# S15 Borehamwood Library, Elstree Way

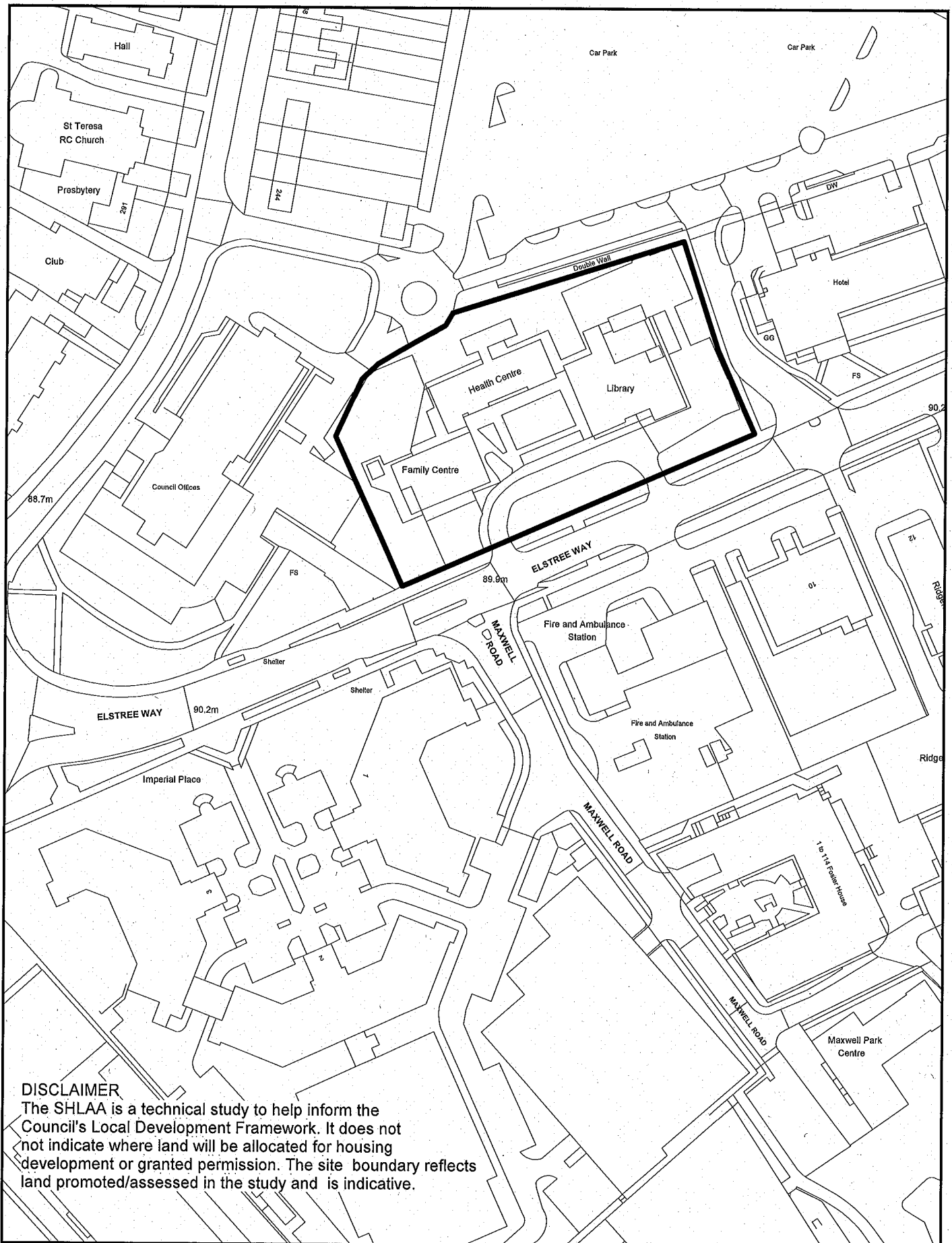

Reproduced from the Ordnance Survey mapping with the permission of the controller of Her Majesty's Stationery Office. Crown copyright. Unauthorised reproduction infringes Crown copyright and may lead to prosecution or civil proceedings. Hertsmere Borough Council Licence 10017428.;



**NOT TO SCALE**

# S16 Oaklands College Site, Elstree Way, Borehamwood

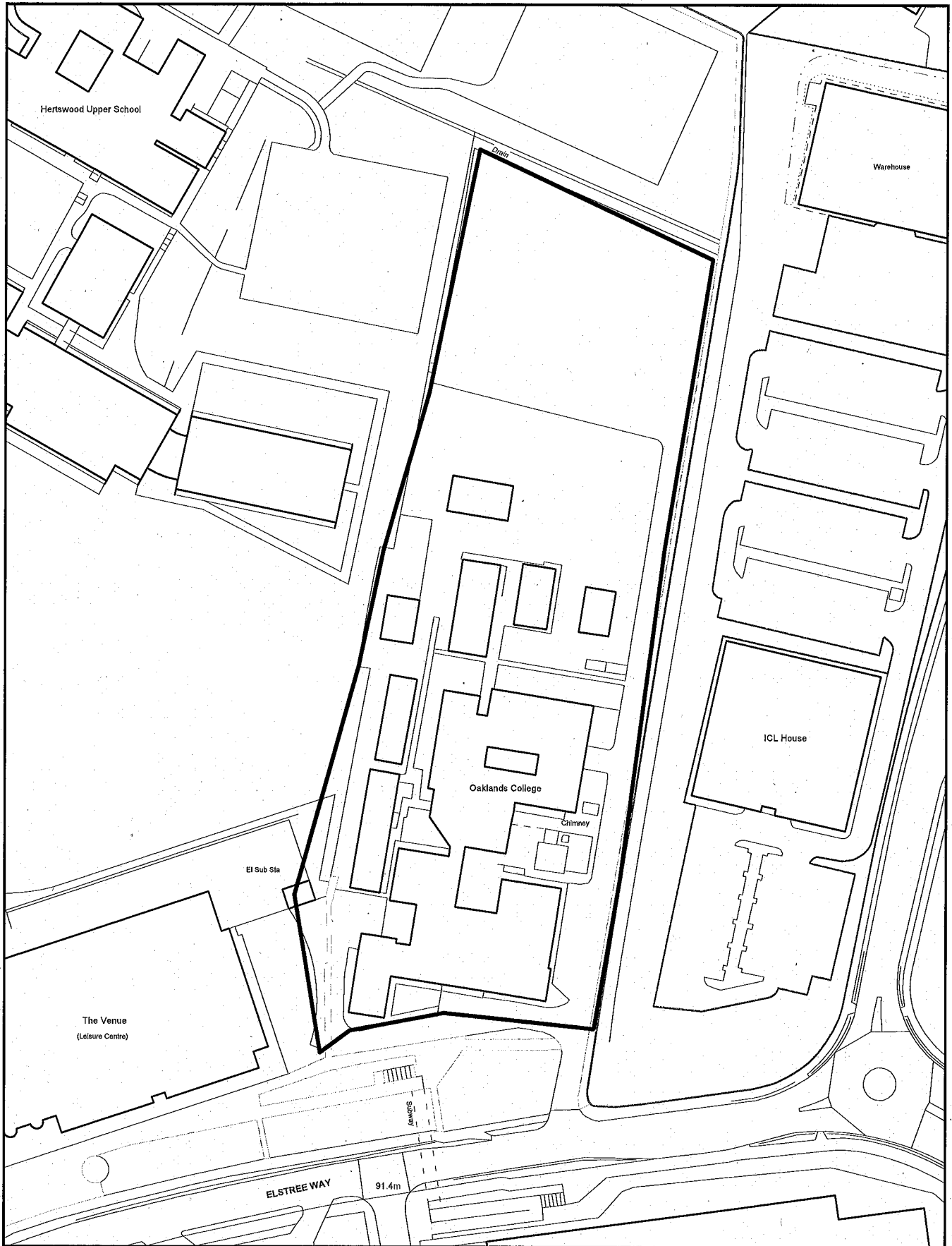

Reproduced from the Ordnance Survey mapping with the permission of the controller of Her Majesty's Stationery Office. Crown copyright. Unauthorised reproduction infringes Crown copyright and may lead to prosecution or civil proceedings.

Hertsmere Borough Council. Licence No:10017428



Scale: 1:1250

Date: 28 October 2009



**S27 Elstree Distribution Centre, Elstree Way, Borehamwood**



**Scale: 1:2500**  
**Date: 28 October 2009**

Reproduced from the Ordnance Survey mapping with the permission of the controller of Her Majesty's Stationery Office. Crown copyright. Unauthorised reproduction infringes Crown copyright and may lead to prosecution or civil proceedings.

Hertsmere Borough Council. Licence No.10017428

**S28 Former Sports Ground, Rowley Lane, Borehamwood**

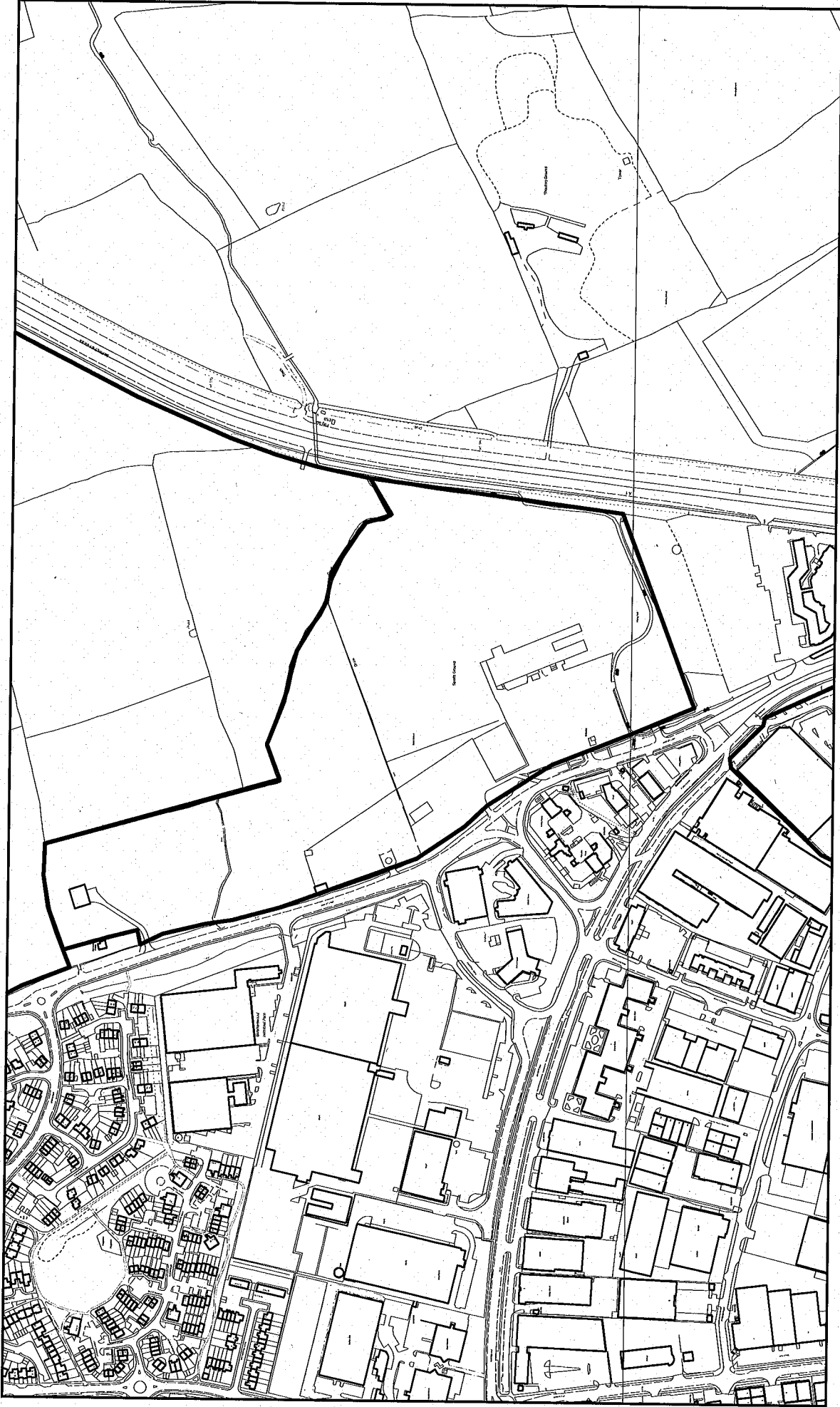

Reproduced from the Ordnance Survey mapping with the permission of the controller of Her Majesty's Stationery Office. Crown copyright. Unauthorised reproduction infringes Crown copyright and may lead to prosecution or civil proceedings.

Date: 28 October 2009  
Scale: 1:1250



# S32 Land Rear of Hartfield Avenue, Borehamwood

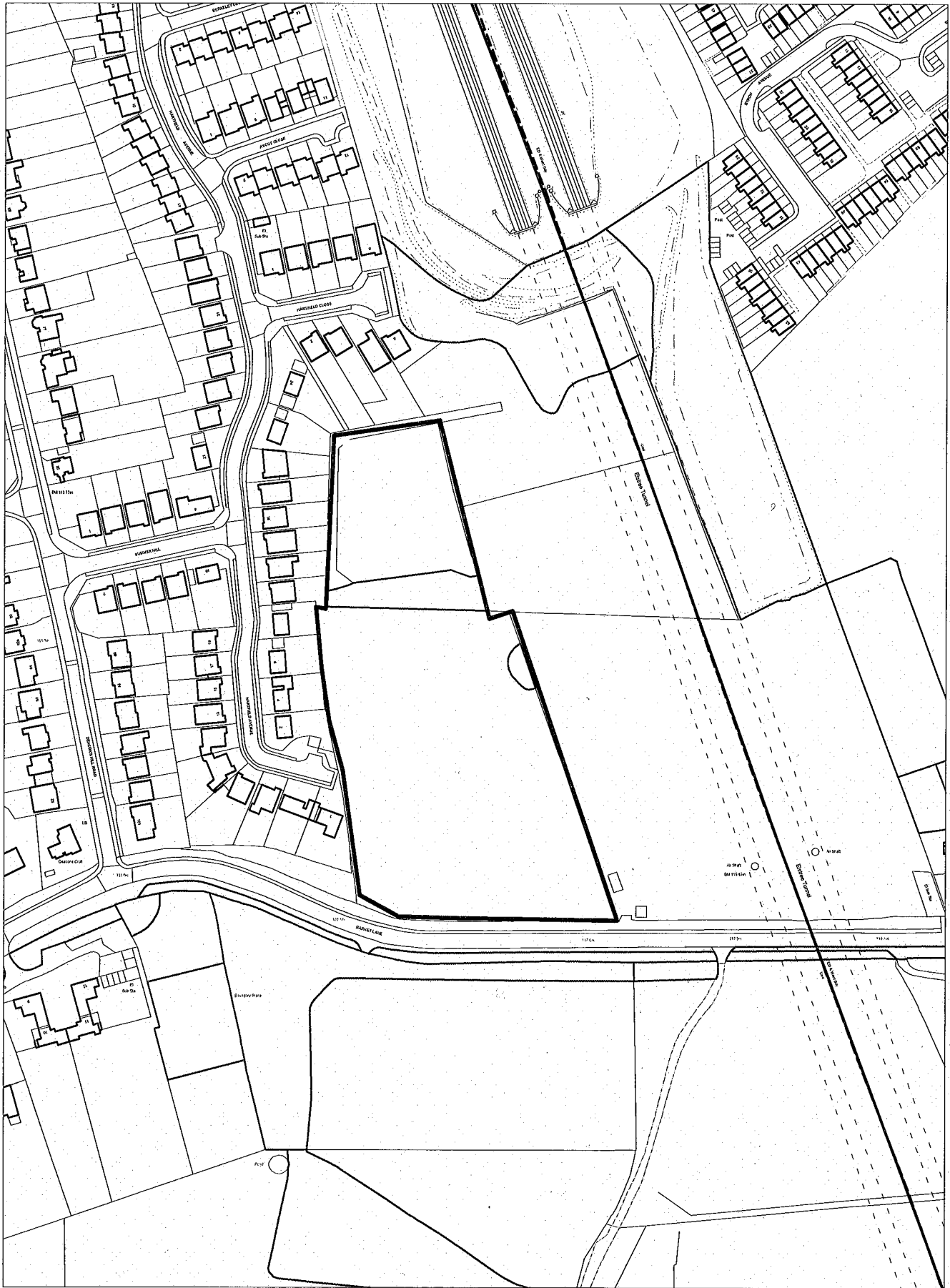

Reproduced from the Ordnance Survey mapping with the permission of the controller of Her Majesty's Stationery Office. Crown copyright. Unauthorised reproduction infringes Crown copyright and may lead to prosecution or civil proceedings.

Hertsmere Borough Council. Licence No:10017428



Date: 28 October 2009  
Scale: 1:2500

# S37 Old Haberdashers' Association, Croxdale Road, Borehamwood

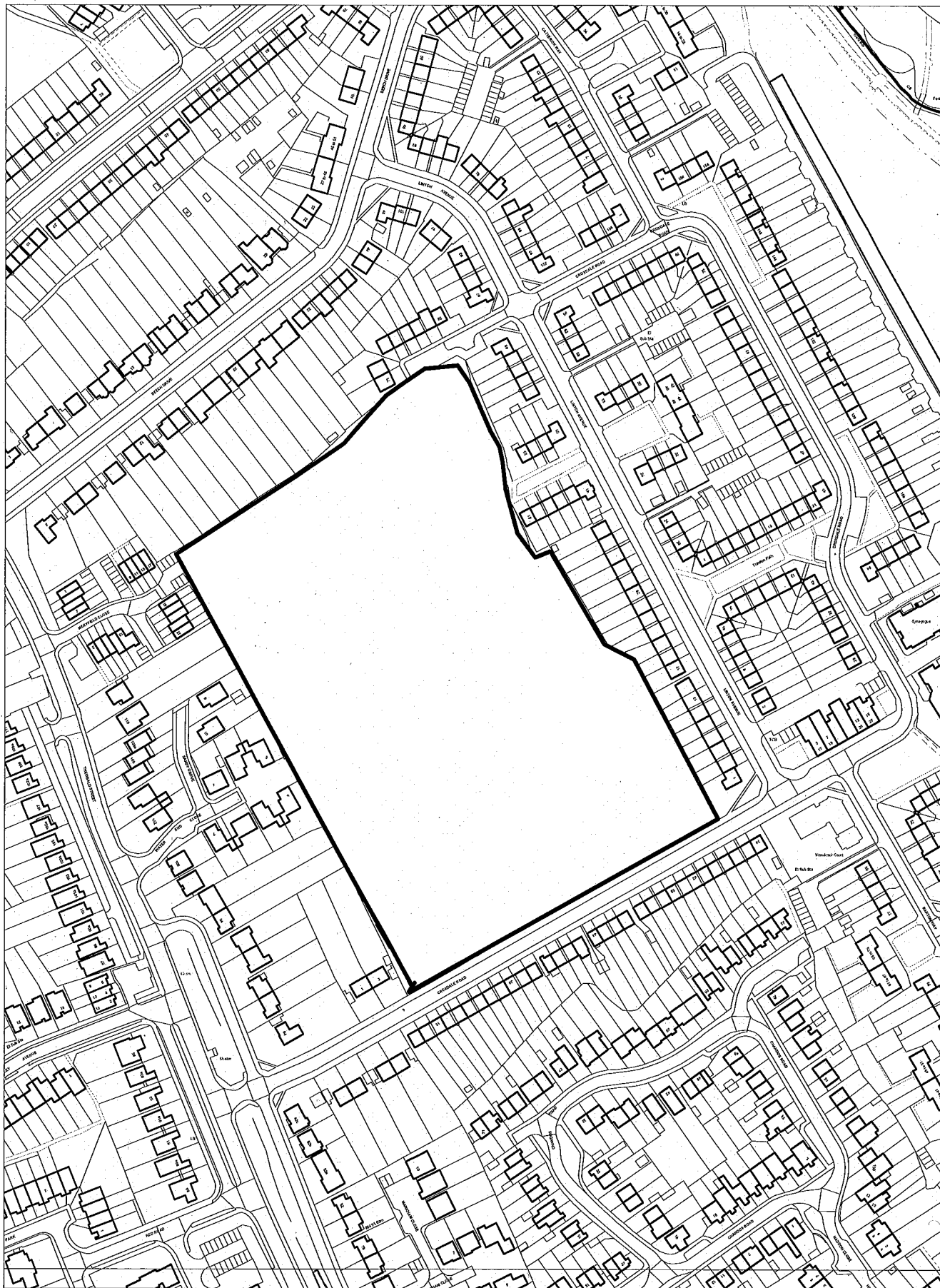

Reproduced from the Ordnance Survey mapping with the permission of the controller of Her Majesty's Stationery Office. Crown copyright. Unauthorised reproduction infringes Crown copyright and may lead to prosecution or civil proceedings.

Hertsmere Borough Council. Licence No:10017428



Scale: 1:2500  
Date: 28 October 2009



# S52 Land to Northeast of Borehamwood (Site A)

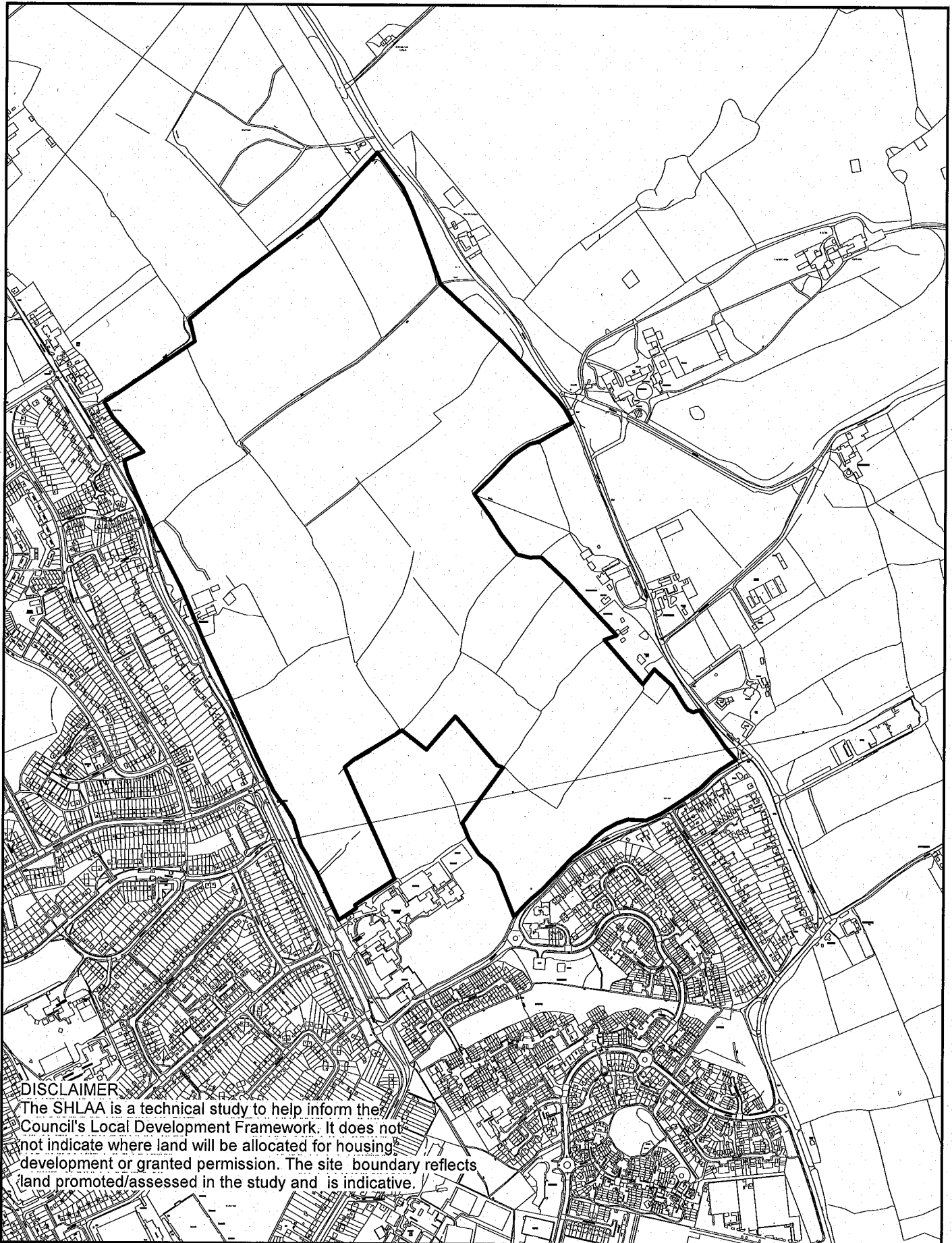

## DISCLAIMER

The SHLAA is a technical study to help inform the Council's Local Development Framework. It does not indicate where land will be allocated for housing development or granted permission. The site boundary reflects land promoted/assessed in the study and is indicative.

Reproduced from the Ordnance Survey mapping with the permission of the controller of Her Majesty's Stationery Office. Crown copyright. Unauthorised reproduction infringes Crown copyright and may lead to prosecution or civil proceedings. Hertsmere Borough Council Licence 10017428.;



NOT TO SCALE

## S53 Land to Northeast of Borehamwood (Site B)

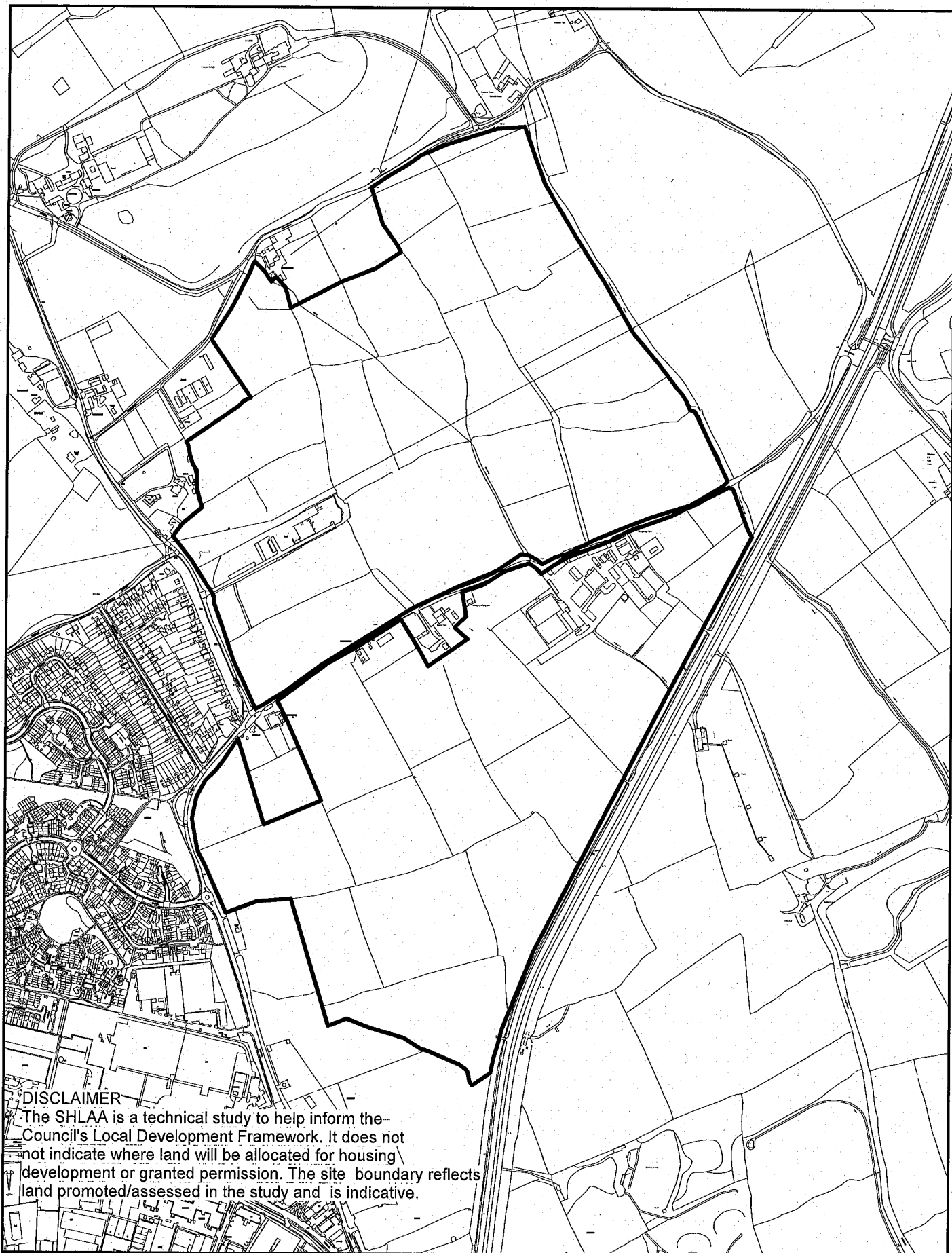

Reproduced from the Ordnance Survey mapping with the permission of the controller of Her Majesty's Stationery Office. Crown copyright. Unauthorised reproduction infringes Crown copyright and may lead to prosecution or civil proceedings. Hertsmere Borough Council Licence 10017428.;



NOT TO SCALE

# S59 Vacant land to south of Borehamwood/Elstree Rail Station,

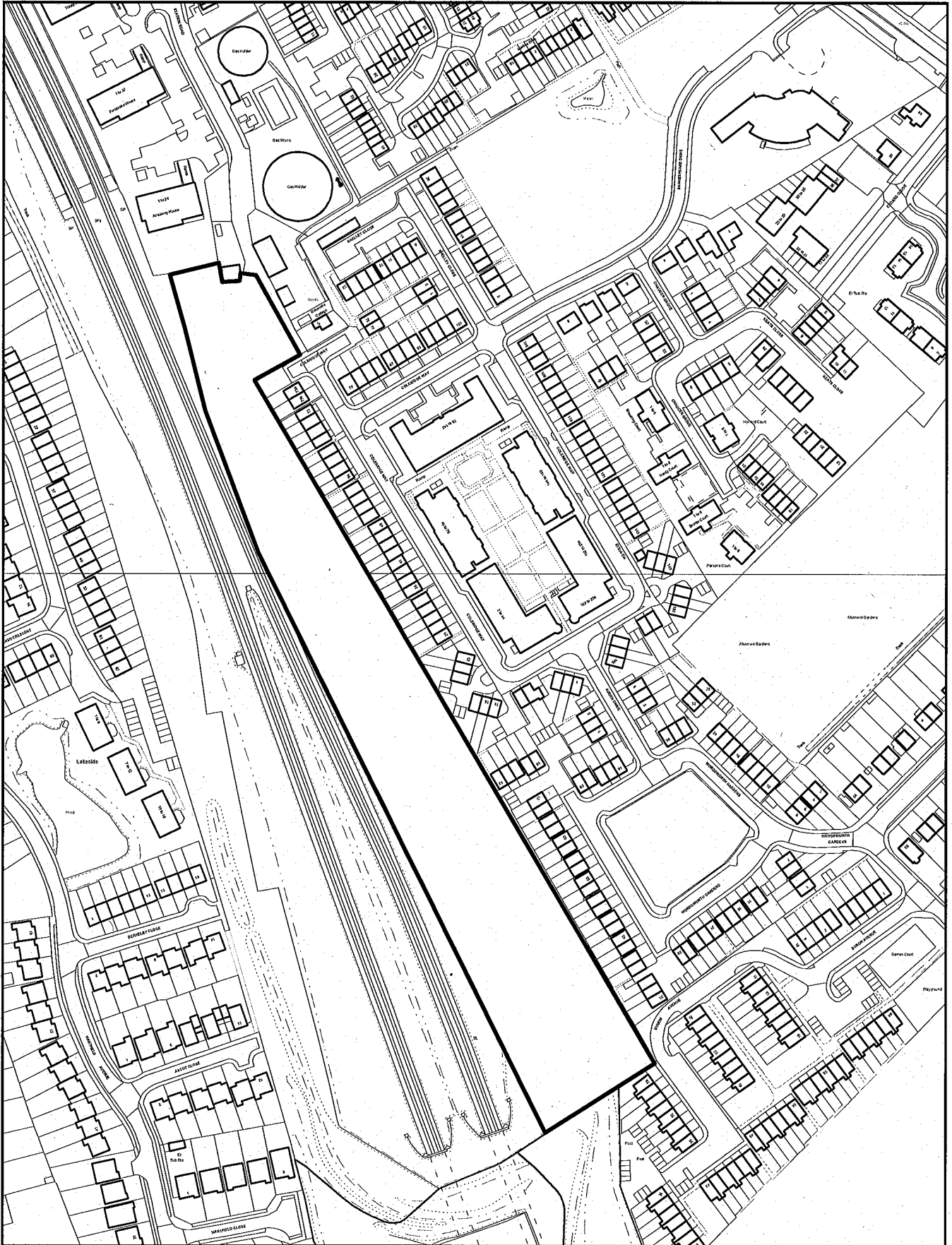

Reproduced from the Ordnance Survey mapping with the permission of the controller of Her Majesty's Stationery Office. Crown copyright. Unauthorised reproduction infringes Crown copyright and may lead to prosecution or civil proceedings.

Hertsmere Borough Council. Licence No:10017428





# S61 57-59 Oakwood Avenue, Borehamwood

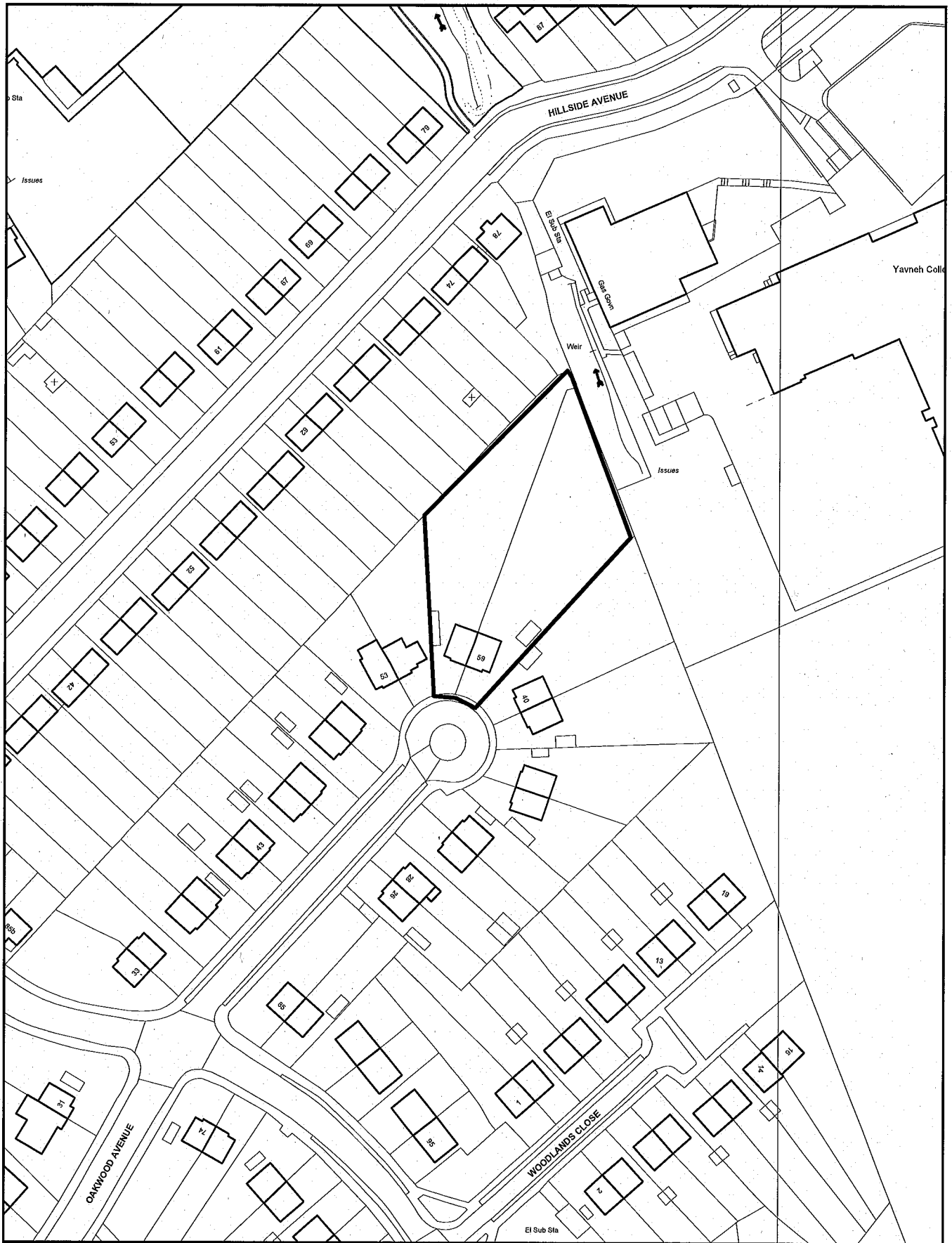

Reproduced from the Ordnance Survey mapping with the permission of the controller of Her Majesty's Stationery Office. Crown copyright. Unauthorised reproduction infringes Crown copyright and may lead to prosecution or civil proceedings.

Hertsmere Borough Council. Licence No:10017428



Scale: 1:1250  
Date: 28 October 2009

# S64 Oakleigh and Arden, Mildred Avenue Borehamwwod



This copy has been produced specifically for Land and Property Search purposes only. No further copies may be made. Reproduced from the Ordnance Survey mapping with the permission of the controller of Her Majesty's Stationery Office. Crown copyright. Unauthorised reproduction infringes Crown copyright and may lead to prosecution or civil proceedings. Hertsmere Borough Council. Licence No:10017428



Scale 1:500  
Date: 28 October 2009

**S76 Suffolk Punch Howard Drive, Borehamwood**



**Scale: 1:500**  
**Date: 28 October 2009**

Reproduced from the Ordnance Survey mapping with the permission of the controller of Her Majesty's Stationery Office. Crown copyright. Unauthorised reproduction infringes Crown copyright and may lead to prosecution or civil proceedings.  
Hertsmere Borough Council. Licence No:10017428

# S129 Station Road Gas Holders, Borehamwood



Reproduced from the Ordnance Survey mapping with the permission of the controller of Her Majesty's Stationery Office. Crown copyright. Unauthorised reproduction infringes Crown copyright and may lead to prosecution or civil proceedings.

Hertsmere Borough Council. Licence No:10017428



Scale: 1:1250

Date: 28 October 2009

**S131 Studio Plaza, Elstree Way, Borehamwood**



**Scale: 1:2500**  
**Date: 28 October 2009**

Reproduced from the Ordnance Survey mapping with the permission of the controller of Her Majesty's Stationery Office. Crown copyright. Unauthorised reproduction infringes Crown copyright and may lead to prosecution or civil proceedings.

Hertsmere Borough Council. Licence No: 10017428

**S132 East side of Glenhaven Avenue, Borehamwood**

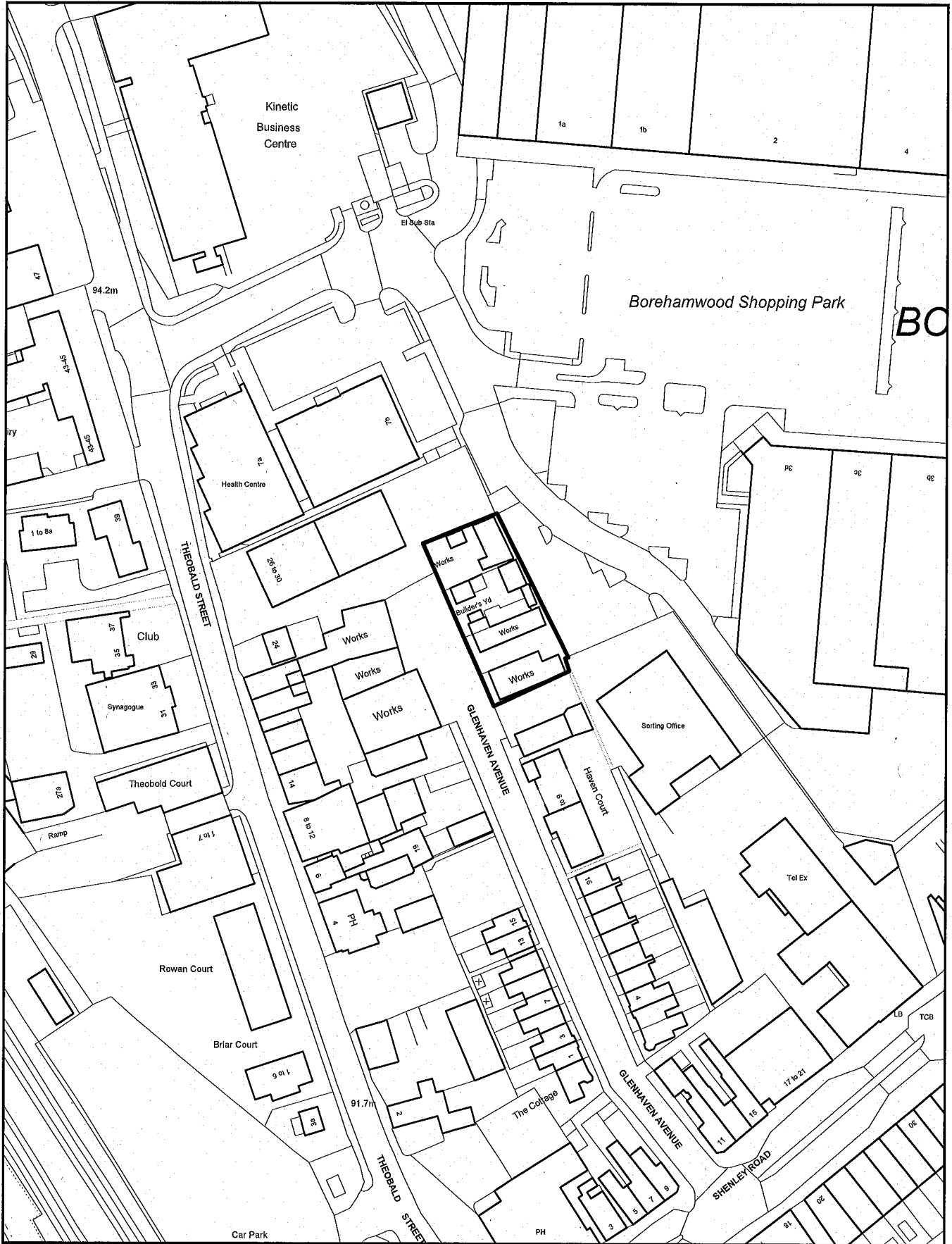

Reproduced from the Ordnance Survey mapping with the permission of the controller of Her Majesty's Stationery Office. Crown copyright. Unauthorised reproduction infringes Crown copyright and may lead to prosecution or civil proceedings.

Hertsmere Borough Council. Licence No:10017428



Scale: 1:1250  
Date: 28 October 2009

# 133 43-47 Theobald Street, Borehamwood



Reproduced from the Ordnance Survey mapping with the permission of the controller of Her Majesty's Stationery Office. Crown copyright. Unauthorised reproduction infringes Crown copyright and may lead to prosecution or civil proceedings.

Hertsmere Borough Council. Licence No:10017428



Scale: 1:1250  
Date: 28 October 2009

# S137 Land rear of Crown Road Borehamwood

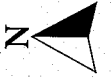

Scale: 1:1250  
Date: 28 October 2009

Reproduced from the Ordnance Survey mapping with the permission of the controller of Her Majesty's Stationery Office. Crown copyright. Unauthorised reproduction infringes Crown copyright and may lead to prosecution or civil proceedings.  
Hertsmere Borough Council. Licence No:10017428



**S139 Undeveloped Land off Maxwell Road**

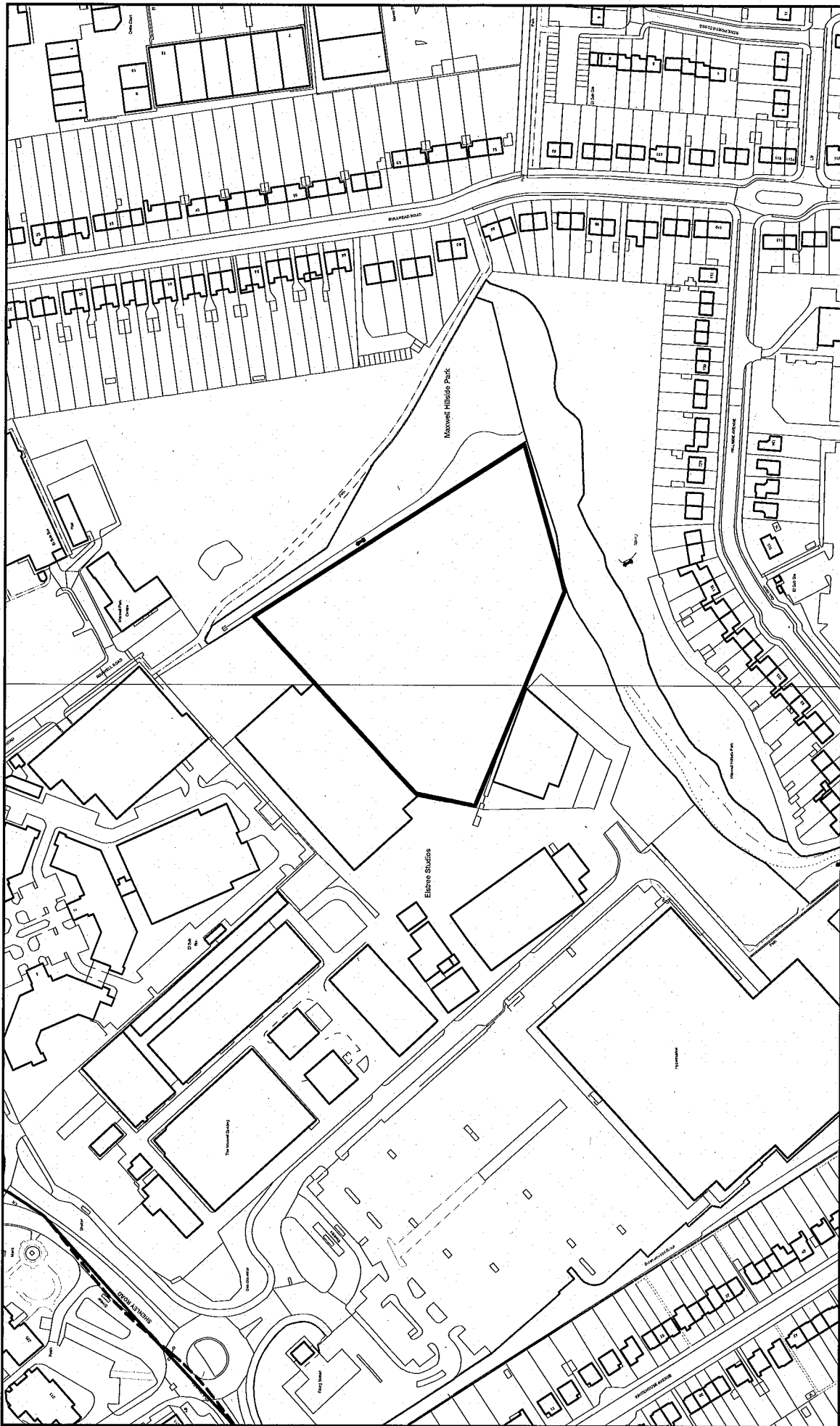

**Scale: 1:2500**  
**Date: 28 October 2009**

Reproduced from the Ordnance Survey mapping with the permission of the controller of Her Majesty's Stationery Office. Crown copyright. Unauthorised reproduction infringes Crown copyright and may lead to prosecution or civil proceedings.

Hertsmere Borough Council. Licence No: 10017428

**S142 Garages off Grove Road Borehamwood**



**Scale: 1:500**  
**Date: 28 October 2009**

Reproduced from the Ordnance Survey mapping with the permission of the controller of Her Majesty's Stationery Office. Crown copyright. Unauthorised reproduction infringes Crown copyright and may lead to prosecution or civil proceedings.

Hertsmere Borough Council. Licence No:10017428

# S143 Garage Courts, Masefield Avenue Borehamwood

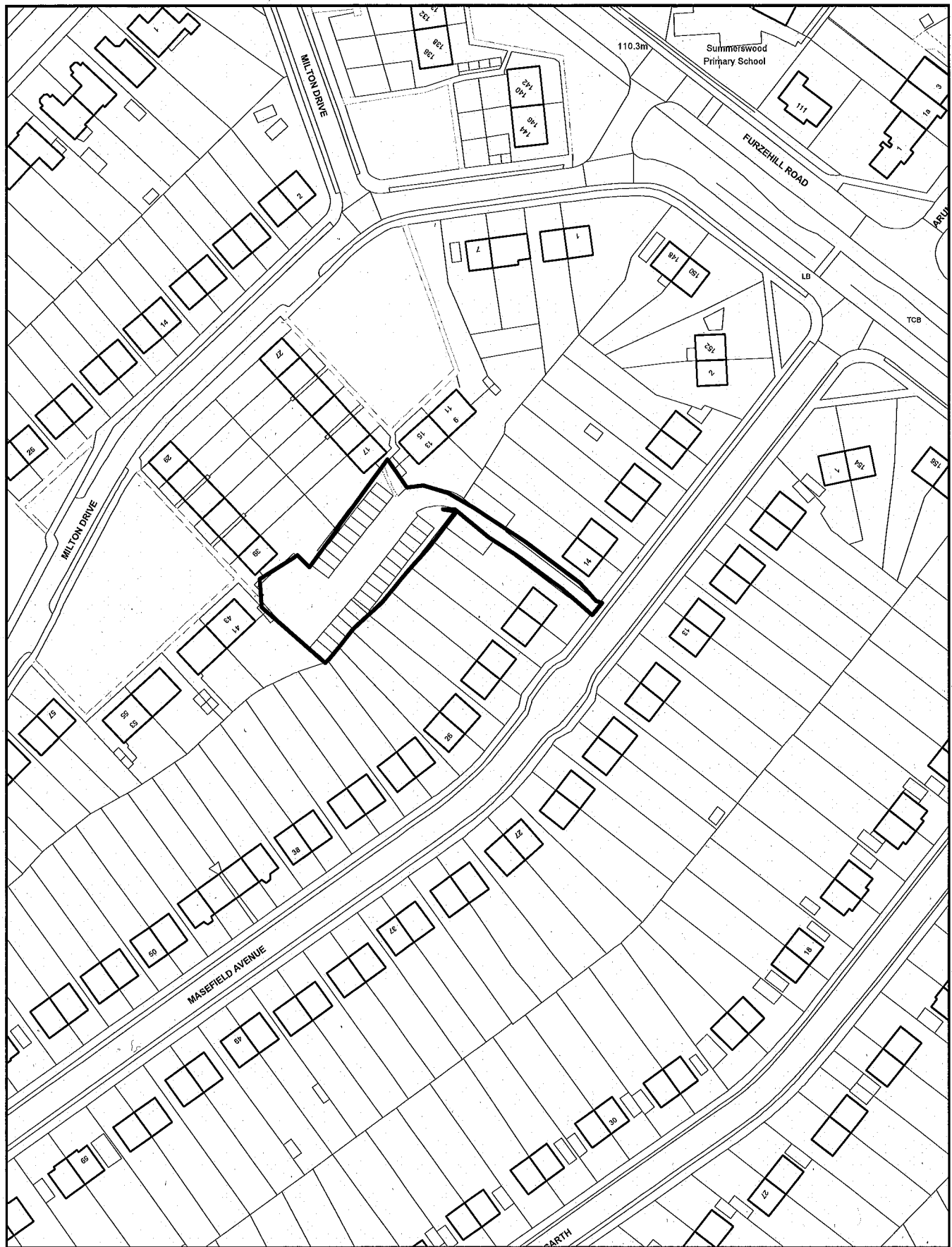

Reproduced from the Ordnance Survey mapping with the permission of the controller of Her Majesty's Stationery Office. Crown copyright. Unauthorised reproduction infringes Crown copyright and may lead to prosecution or civil proceedings.

Hertsmere Borough Council. Licence No:10017428



Scale: 1:1250  
Date: 28 October 2009

**S144 Garage Courts rear of 13-21 Hartforde Rd, Borehamwood**

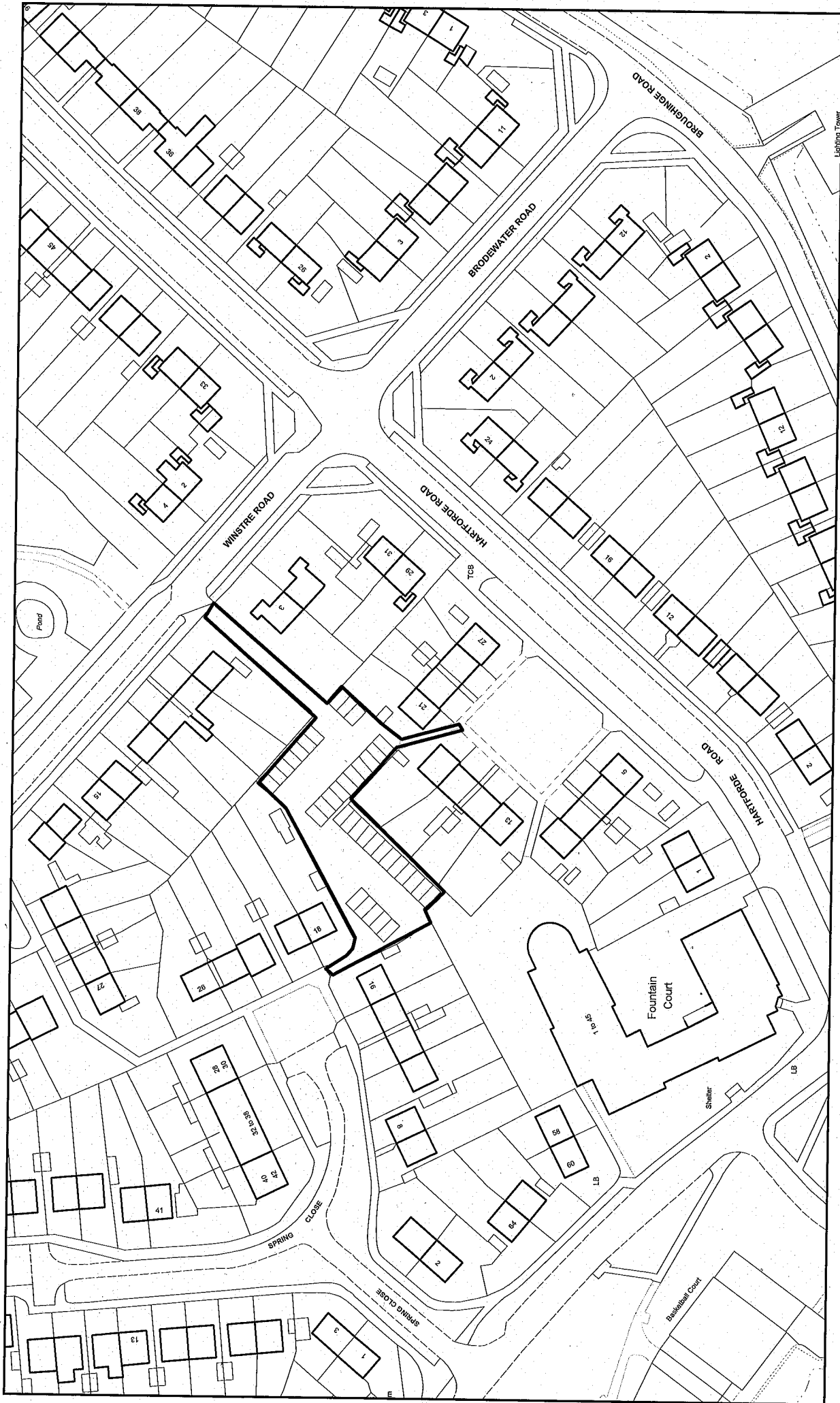

Reproduced from the Ordnance Survey mapping with the permission of the controller of Her Majesty's Stationery Office. Crown copyright. Unauthorised reproduction infringes Crown copyright and may lead to prosecution or civil proceedings.

Hertsmere Borough Council. Licence No:10017428

Scale: 1:1250  
Date: 28 October 2009



# S148 'JUNCTION ELSTREE WAY MANOR WAY BULLHEAD ROAD

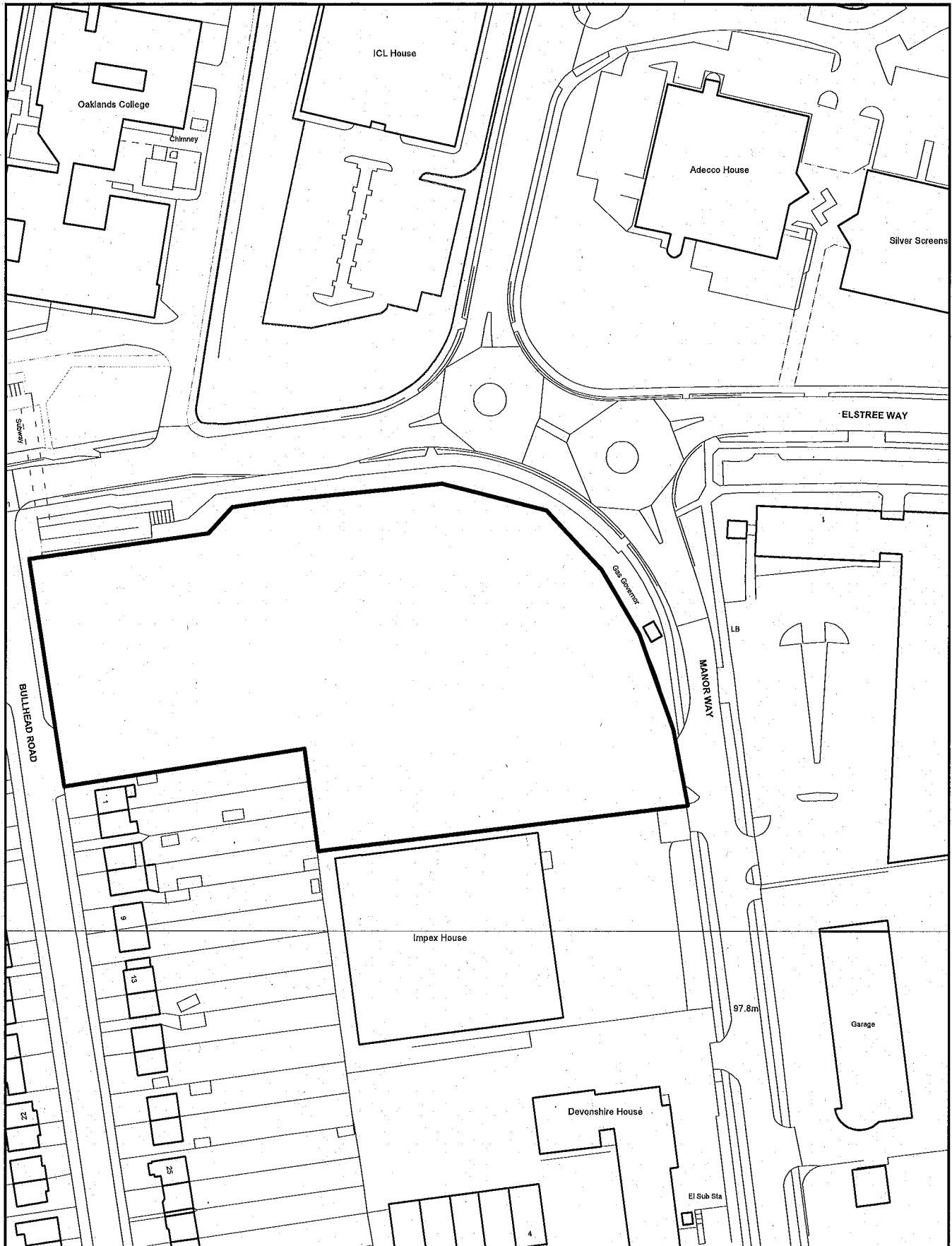

Reproduced from the Ordnance Survey mapping with the permission of the controller of Her Majesty's Stationery Office. Crown copyright. Unauthorised reproduction infringes Crown copyright and may lead to prosecution or civil proceedings.



**S149 Stratfield Road Estate, Borehamwood**

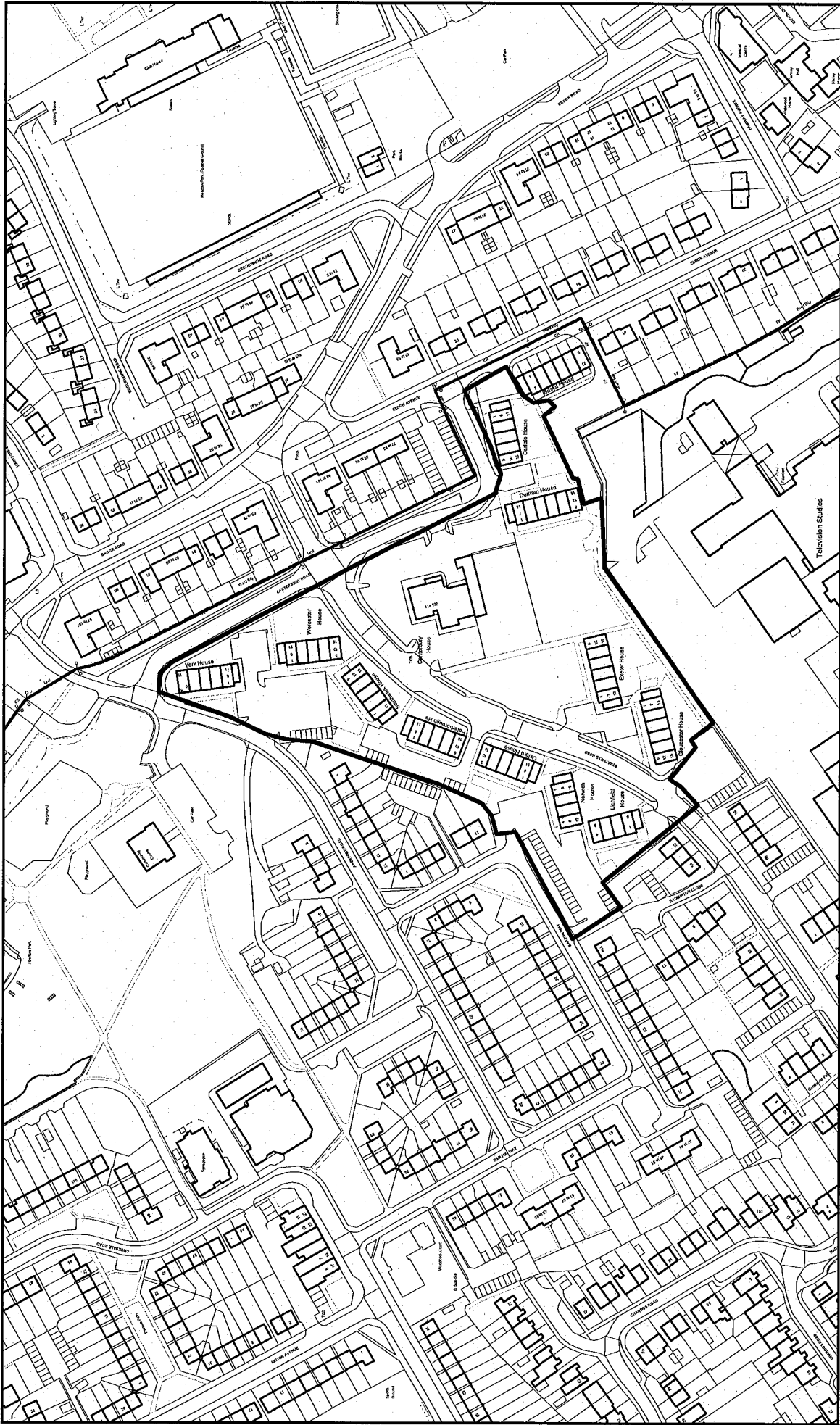

Scale: 1:2500

Date: 28 October 2009

Reproduced from the Ordnance Survey mapping with the permission of the controller of Her Majesty's Stationery Office. Crown copyright. Unauthorised reproduction infringes Crown copyright and may lead to prosecution or civil proceedings.

Hertsmere Borough Council. Licence No:10017428

# S150 Borehamwood Civic Car Park, Elstree Way Borehamwood

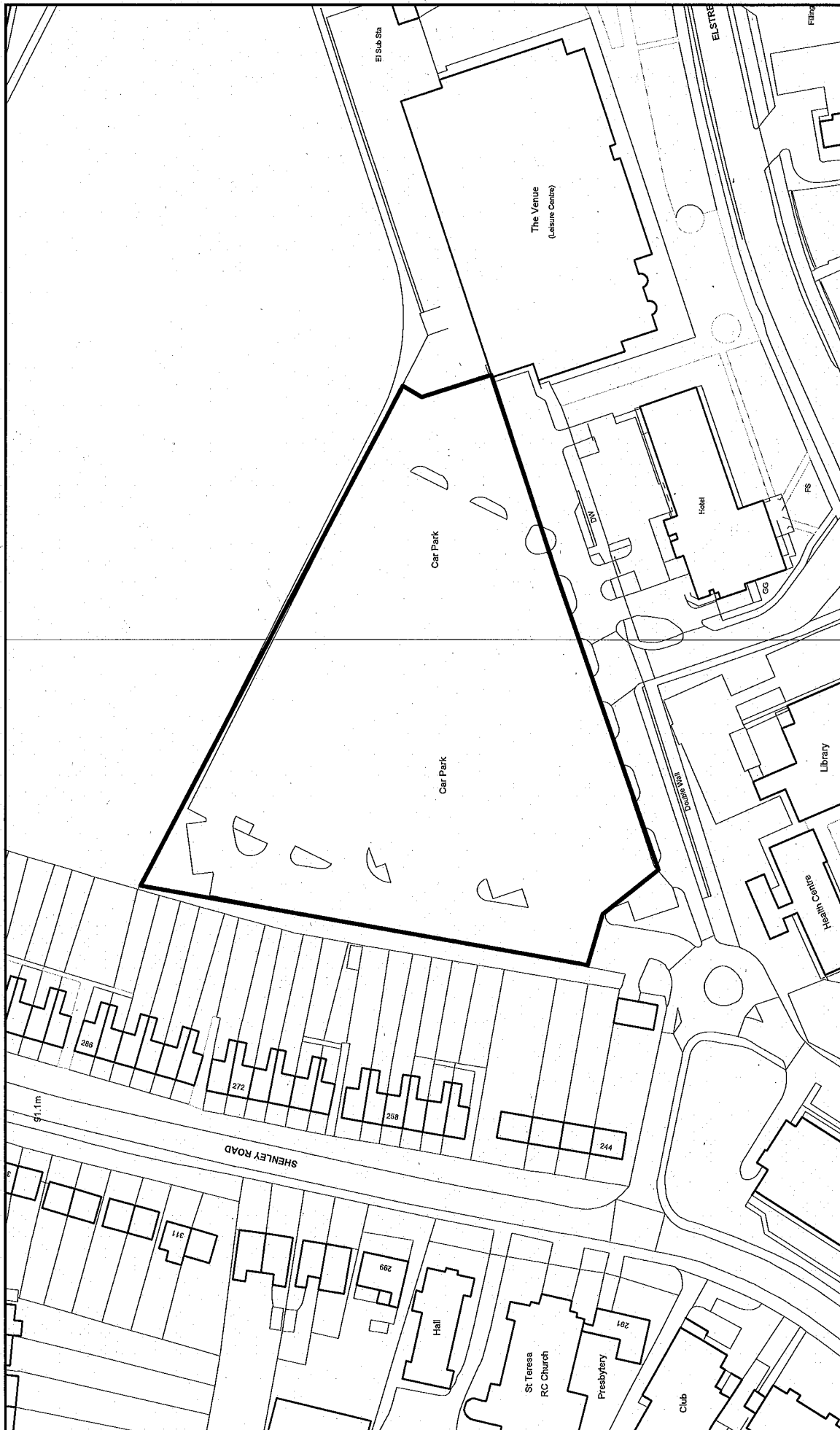

Scale: 1:1250  
Date: 28 October 2009

Reproduced from the Ordnance Survey mapping with the permission of the controller of Her Majesty's Stationery Office. Crown copyright. Unauthorised reproduction infringes Crown copyright and may lead to prosecution or civil proceedings.

Hertsmere Borough Council. Licence No:10017428

# S155 Job Centre Plus Elstree Way, Borehamwood

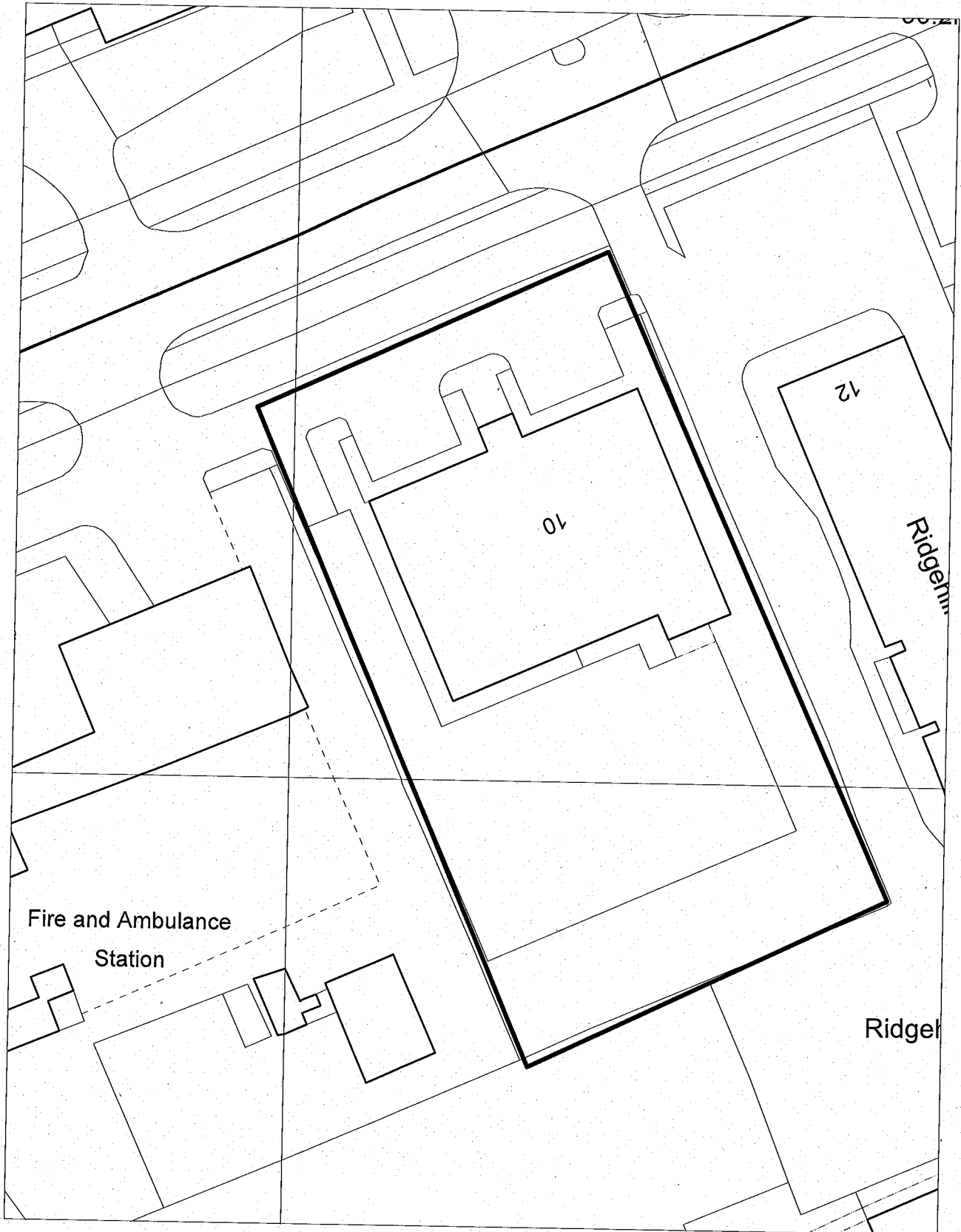

This copy has been produced specifically for Land and Property Search purposes only. No further copies may be made. Reproduced from the Ordnance Survey mapping with the permission of the controller of Her Majesty's Stationery Office. Crown copyright. Unauthorised reproduction infringes Crown copyright and may lead to prosecution or civil proceedings. Hertsmere Borough Council. Licence No:10017428



**Scale 1:500**  
**Date: 28 October 2009**



# S163 Land South of Borehamwood, above Rail Tunnels & North of Barnet Lane

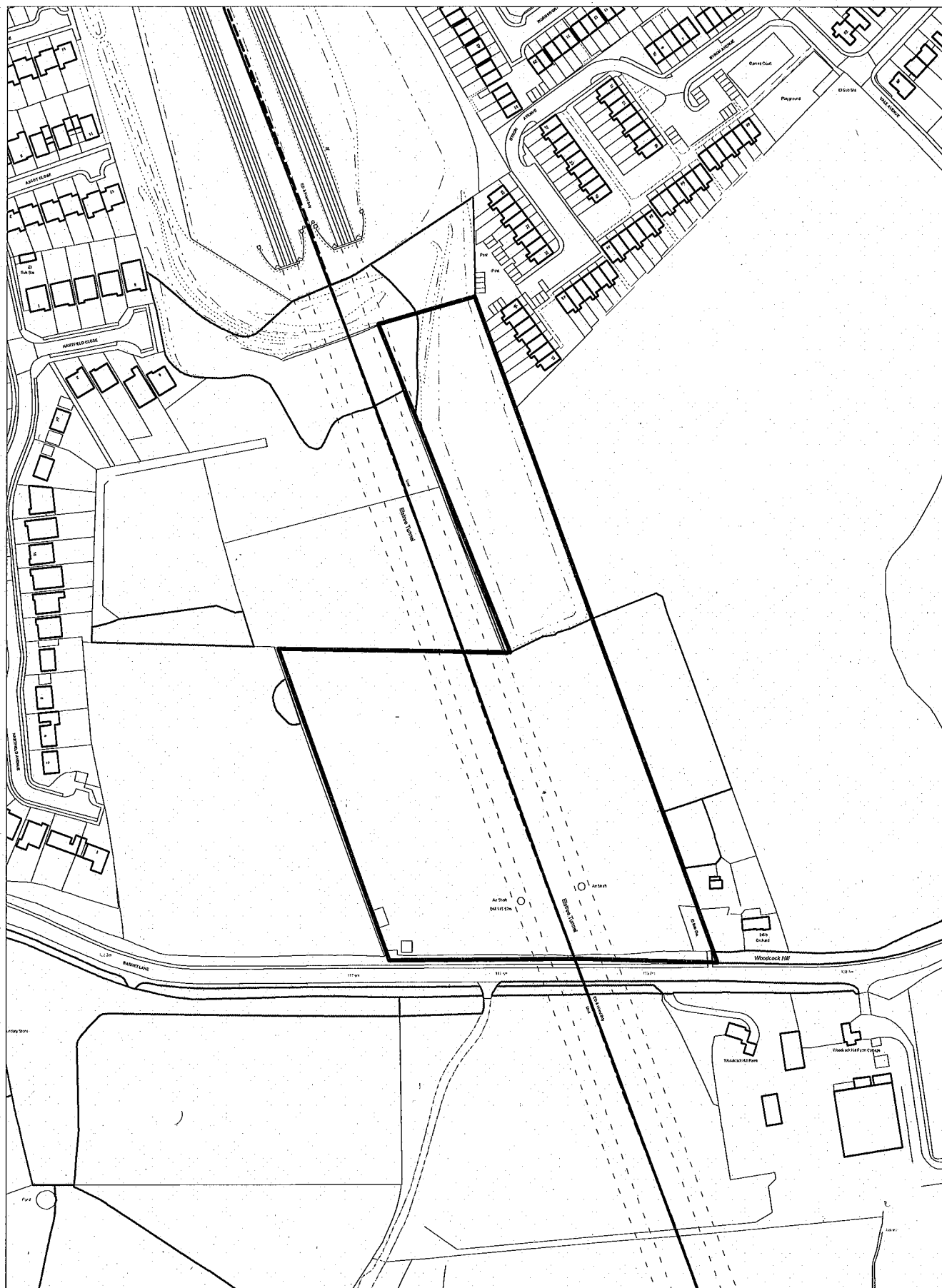

Reproduced from the Ordnance Survey mapping with the permission of the controller of Her Majesty's Stationery Office. Crown copyright. Unauthorised reproduction infringes Crown copyright and may lead to prosecution or civil proceedings.

Hertsmere Borough Council. Licence No:10017428



Date: 28 October 2009  
Scale: 1:2500

# S199 Land at Allum Lane (next to Borehamwood Station)



Reproduced from the Ordnance Survey mapping with the permission of the controller of Her Majesty's Stationery Office. Crown copyright. Unauthorised reproduction infringes Crown copyright and may lead to prosecution or civil proceedings.

Hertsmere Borough Council. Licence No:10017428



Scale: 1:1250  
Date: 20100108

# S40J Elstree Way Corridor Masterplan Area.

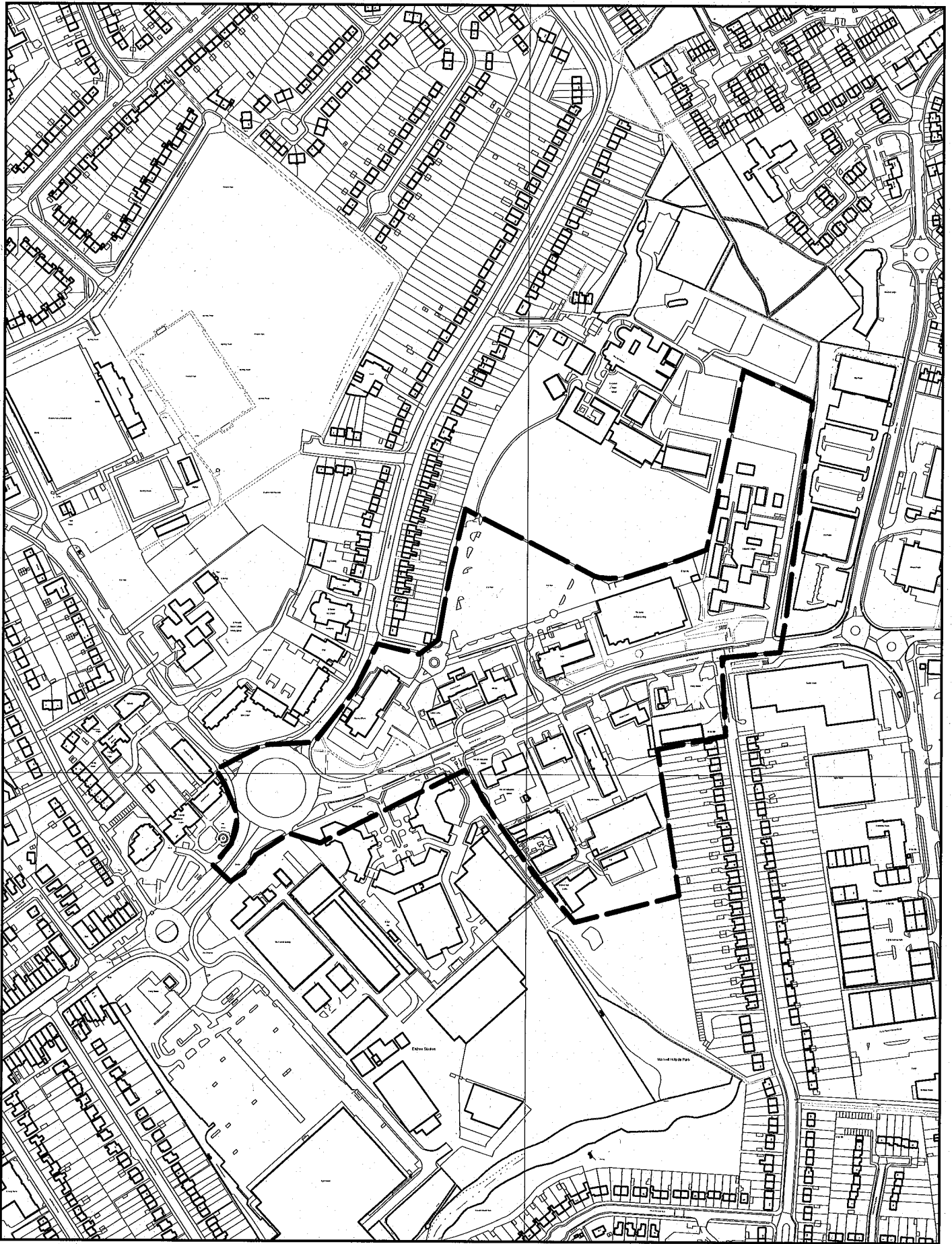

Reproduced from the Ordnance Survey mapping with the permission of the controller of Her Majesty's Stationery Office. Crown copyright. Unauthorised reproduction infringes Crown copyright and may lead to prosecution or civil proceedings.

Hertsmere Borough Council. Licence No:10017428



Scale: NOT TO SCALE

Date: August 2010