

**TOWN AND COUNTRY PLANNING  
(GENERAL PERMITTED DEVELOPMENT) ORDER 2015, AS AMENDED  
DIRECTION MADE UNDER ARTICLE 4(1)**

**HERTSMERE BOROUGH COUNCIL**

**WHEREAS** Hertsmere Borough Council (“the Council”) being the appropriate local planning authority within the meaning of article 4(5) of the Town and Country Planning (General Permitted Development) Order 2015 (“the Order”), as amended, are satisfied that it is expedient that development of the description(s) set out in the Schedule below should not be carried out on the land shown edged/coloured in red on the attached plans unless planning permission is granted on an application made under Part III of the Town and Country Planning Act 1990, as amended.

**NOW THEREFORE** the said Council in pursuance of the power conferred on them by Article 4(1) of the Order, **HEREBY DIRECT** that the permission granted by Class O of Part 3, Schedule 2 of the said Order shall not apply to the land described in the Schedule below.

**THIS DIRECTION** is made under Article 4(1) of the said Order and, in accordance with paragraph 1 of Schedule 3 of the Order shall come into force on 27 April 2020.

**SCHEDULE**

(the Permitted Development excluded by this Direction)

1. Development consisting of a change use of a building and any land within its curtilage from a use falling within Class B1(a) (offices) of the Schedule to the Town and Country Planning (Use Classes) Order 1987 (as amended), to a use falling within Class C3 (dwellinghouses) of that Schedule being development comprised within Class O of Part 3 of Schedule 2 to the Order and not being development comprised within any other Class within the identified locations listed below and as indicated in the attached plans.
  - Employment Areas – (1) Elstree Way and (2) Stirling Way, Borehamwood; (3) Cranborne Road and (4) Station Close, Potters Bar; and (5) Otterspool Way, Bushey;
  - Key Employment Site – (1) Centennial Park, Elstree; and
  - Locally Significant Employment Sites – (1) Wrotham Business Park; (2) Borehamwood Enterprise Centre and (3) Theobald Court, Borehamwood; (4) Lismirrane Industrial Park, Elstree; (5) Hollies Way, Potters Bar; (6) Beaumont Gate, Radlett; (7) Farm Close, Shenley.

Made under the Common Seal of  
Hertsmere Borough Council

this 26<sup>th</sup> day of April 2019  
The Common Seal of Hertsmere Borough Council  
was affixed to this Direction in the presence of

  
.....  
Duly Authorised Officer



Confirmed under the Common Seal of  
Hertsmere Borough Council

this 22 day of April 2020  
The Common Seal of Hertsmere Borough Council  
was affixed to this Direction in the presence of

  
.....  
Duly Authorised Officer



**THIS DIRECTION COMES INTO FORCE ON 27 APRIL 2020 IF CONFIRMED**



694

*[Signature]*

Duty Authorised Officer

This is the plan referred to under the Article 4(1) Direction made by Hertsmere Borough Council

this ... 26<sup>th</sup> ... day of ... April, 2019

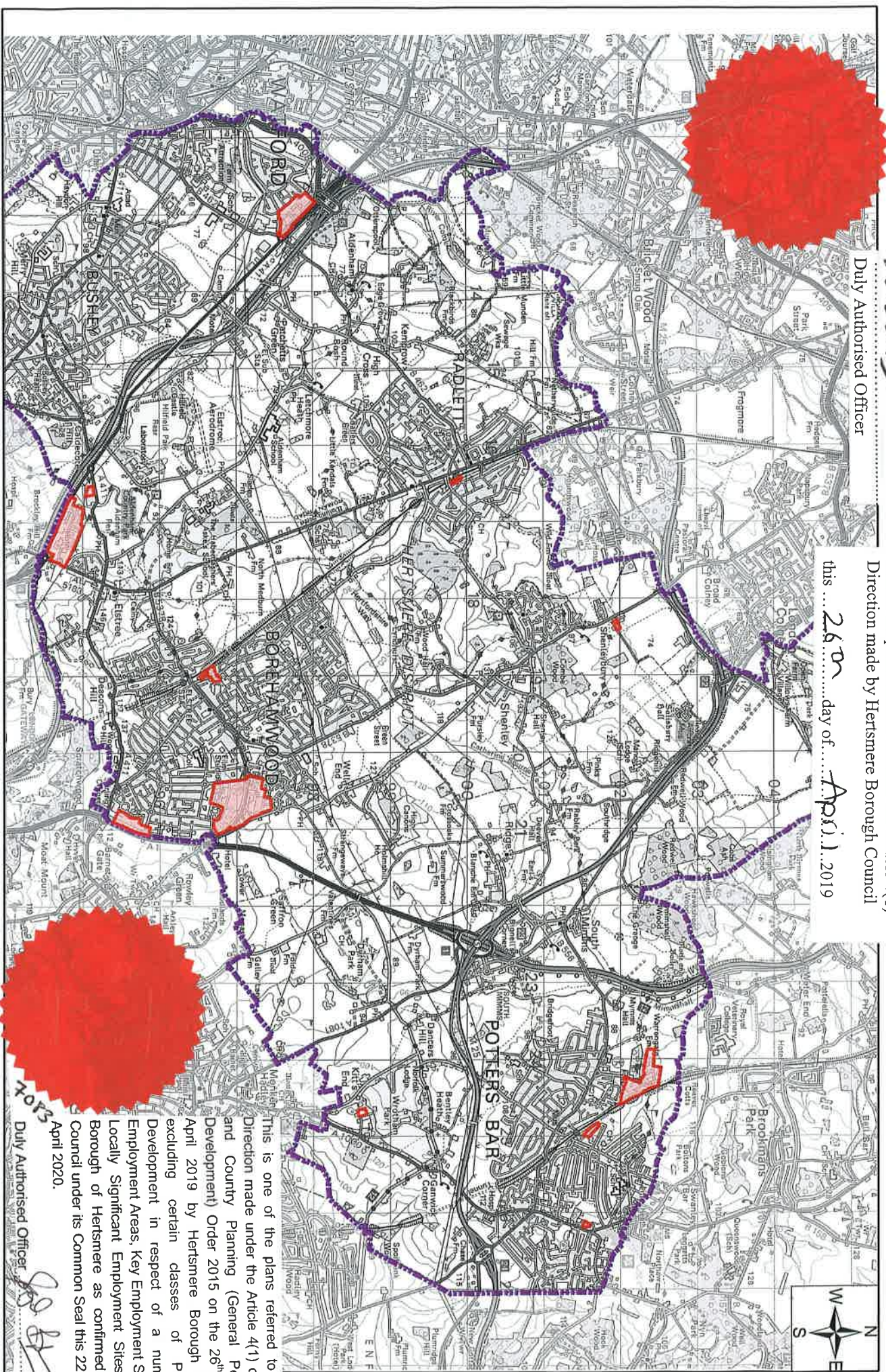

This is one of the plans referred to in the Direction made under the Article 4(1) of Town and Country Planning (General Permitted Development) Order 2015 on the 26<sup>th</sup> day of April 2019 by Hertsmere Borough Council excluding certain classes of Permitted Development in respect of a number of Employment Areas, Key Employment Sites and Locally Significant Employment Sites in the Borough of Hertsmere as confirmed by the Council under its Common Seal this 22<sup>nd</sup> day of April 2020.

Duty Authorised Officer *[Signature]*

### Legend

 Area to which Article 4 direction applies

 Hertsmere Borough Council Boundary

### Map of Hertsmere showing all areas where Article 4 directions apply

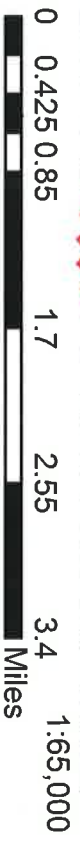

Hertsmere Borough Council Boundary

You are permitted to use this data solely to enable you to respond to, or interact with, the organisation that provided you with the data.

You are not permitted to copy, sub-licence, distribute or sell any of this data to third parties in any form.

© Crown copyright and database rights 2016 OS EUL 100017428



This is the plan referred to under the Article 4(1) Direction made by Hertsmere Borough Council

this ... 26<sup>th</sup> ... day of ... April ... 2019

By the Affixing of its Common Seal to this Direction in the presence of

*[Signature]*  
Duly Authorised Officer

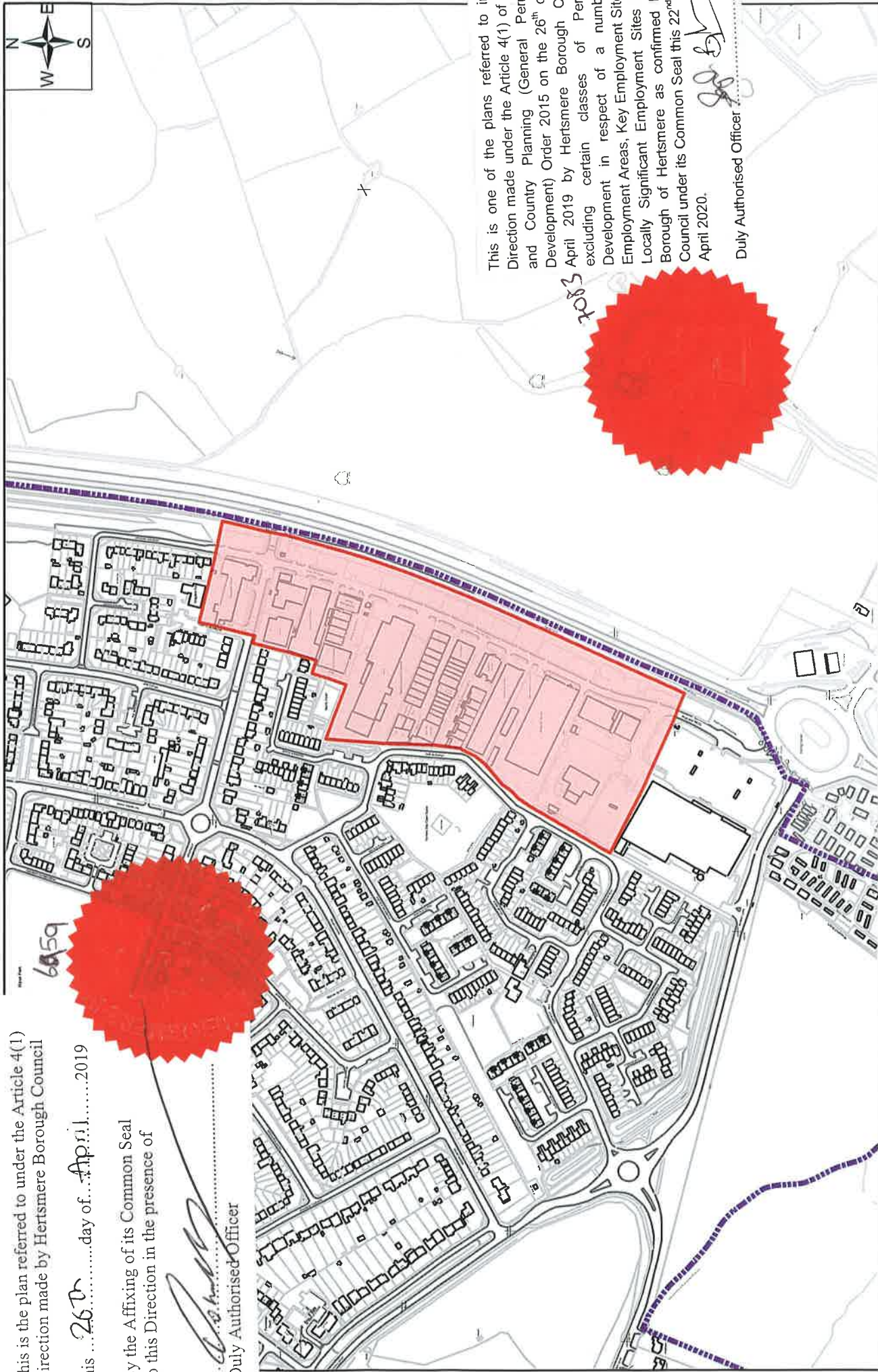

This is one of the plans referred to in the Direction made under the Article 4(1) of Town and Country Planning (General Permitted Development) Order 2015 on the 26<sup>th</sup> day of April 2019 by Hertsmere Borough Council excluding certain classes of Permitted Development in respect of a number of Employment Areas, Key Employment Sites and Locally Significant Employment Sites in the Borough of Hertsmere as confirmed by the Council under its Common Seal this 22<sup>nd</sup> day of April 2020.

*[Signature]*  
Duly Authorised Officer



**Legend**



Area to which Article 4 direction applies



Hertsmere Borough Council Boundary

**Stirling Way**



© Crown copyright and database rights 2016 OS EUL 100017428  
You are not permitted to copy, sub-licence, distribute or sell any of this data to third parties in any form.  
You are permitted to use this data solely to enable you to respond to, or interact with, the organisation that provided you with the data.

This is the plan referred to under the Article 4(1) Direction made by Hertsmere Borough Council

this ~~16~~ 26<sup>th</sup> day of April 2019

By the Affixing of its Common Seal to this Direction in the presence of

*[Signature]*  
Duly Authorised Officer

This is one of the plans referred to in the Direction made under the Article 4(1) of Town and Country Planning (General Permitted Development) Order 2015 on the 26<sup>th</sup> day of April 2019 by Hertsmere Borough Council excluding certain classes of Permitted Development in respect of a number of Employment Areas, Key Employment Sites and Locally Significant Employment Sites in the Borough of Hertsmere as confirmed by the Council under its Common Seal this 22<sup>nd</sup> day of April 2020.

Duly Authorised Officer *[Signature]*

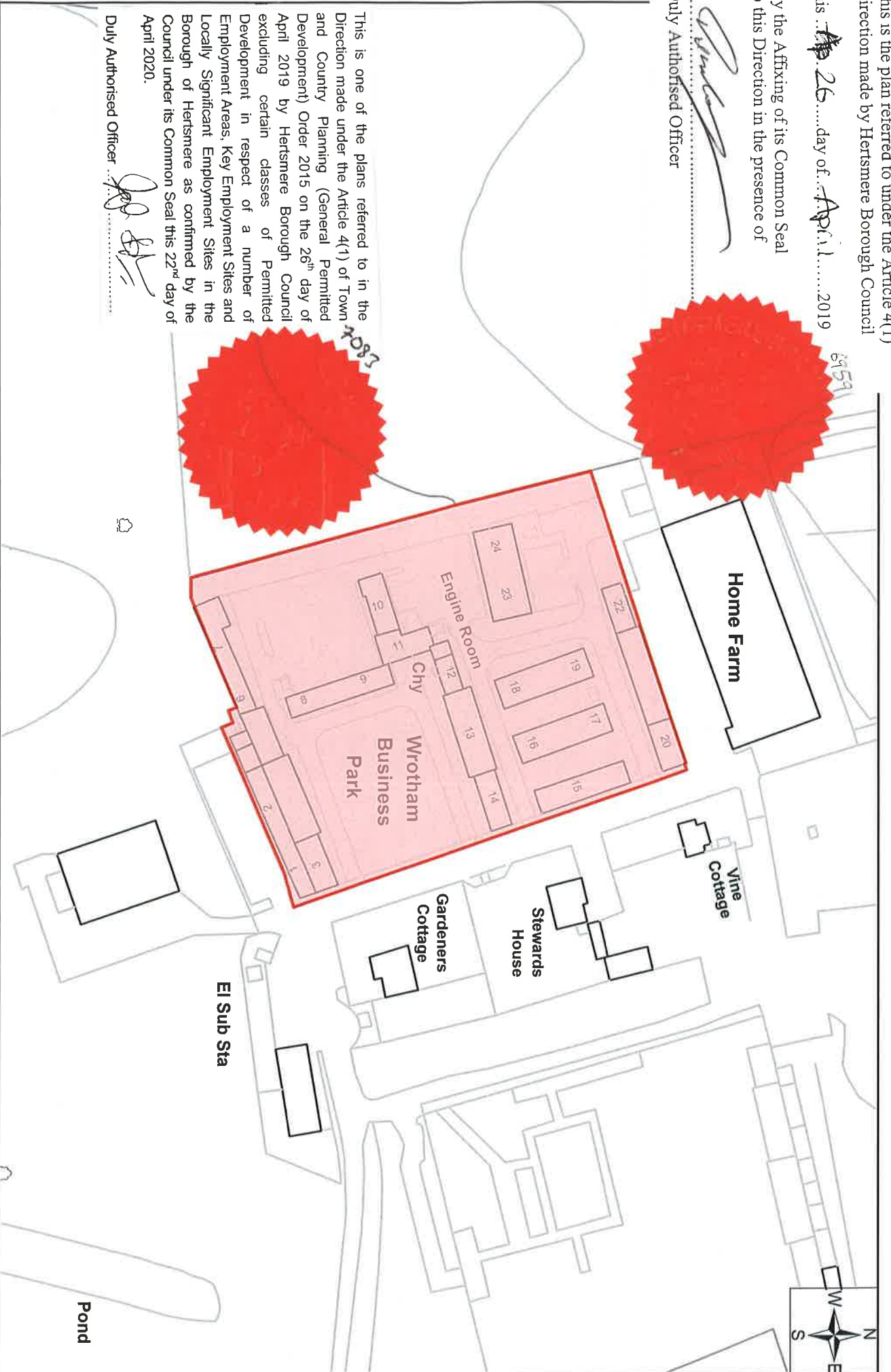

**Legend**

Area to which Article 4 direction applies

Hertsmere Borough Council Boundary

**Wrotham Business Park**



1:1,250

You are not permitted to copy, sub-licence, distribute or sell any of this data to third parties in any form. You are permitted to use this data solely to enable you to respond to, or interact with, the organisation that provided you with the data.



Hertsmere Borough Council Boundary

You are permitted to use this data solely to enable you to respond to, or interact with, the organisation that provided you with the data.

© Crown copyright and database rights 2016 OS EUL 100017428



This is the plan referred to under the Article 4(1) Direction made by Hertsmere Borough Council

this ... 26<sup>th</sup> ... day of April ... 2019

By the Affixing of its Common Seal to this Direction in the presence of

Duly Authorised Officer

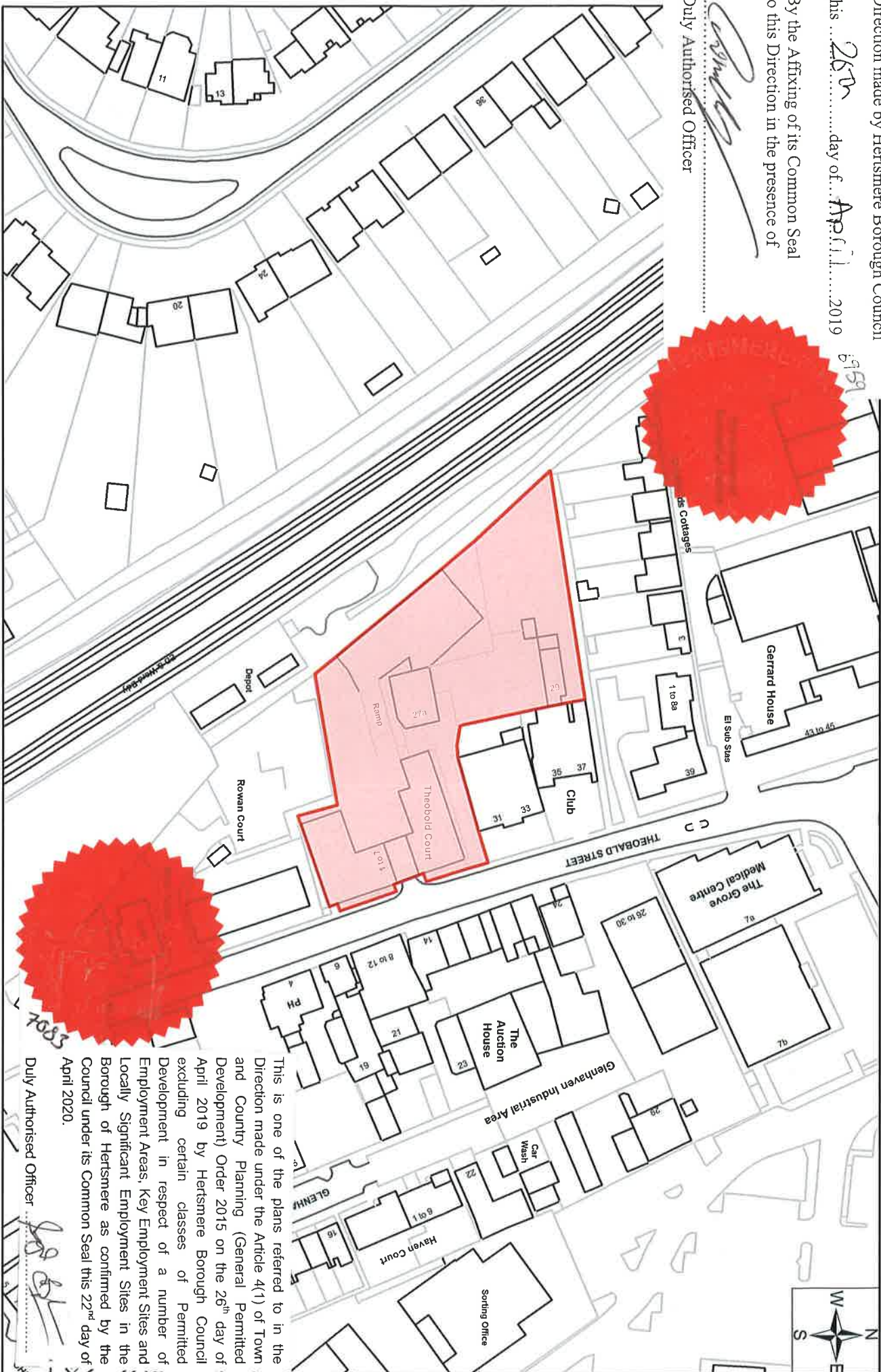

This is one of the plans referred to in the Direction made under the Article 4(1) of Town and Country Planning (General Permitted Development) Order 2015 on the 26<sup>th</sup> day of April 2019 by Hertsmere Borough Council excluding certain classes of Permitted Development in respect of a number of Employment Areas, Key Employment Sites and Locally Significant Employment Sites in the Borough of Hertsmere as confirmed by the Council under its Common Seal this 22<sup>nd</sup> day of April 2020.

Duly Authorised Officer

*[Signature]*

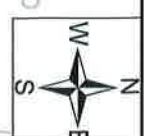

### Legend

 Area to which Article 4 direction applies

 Hertsmere Borough Council Boundary

### Theobald Court

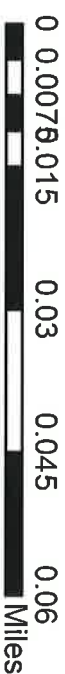

1:1,250



Hertsmere Borough Council Boundary

You are permitted to use this data solely to enable you to respond to, or interact with, the organisation that provided you with the data.

You are not permitted to copy, sub-licence, distribute or sell any of this data to third parties in any form.

© Crown copyright and database rights 2016 OS EUL 100017428



This is the plan referred to under the Article 4(1) Direction made by Hertsmere Borough Council

this ... 25th ... day of ... April ... 2019

By the Affixing of its Common Seal to this Direction in the presence of

*[Signature]*  
Duly Authorised Officer

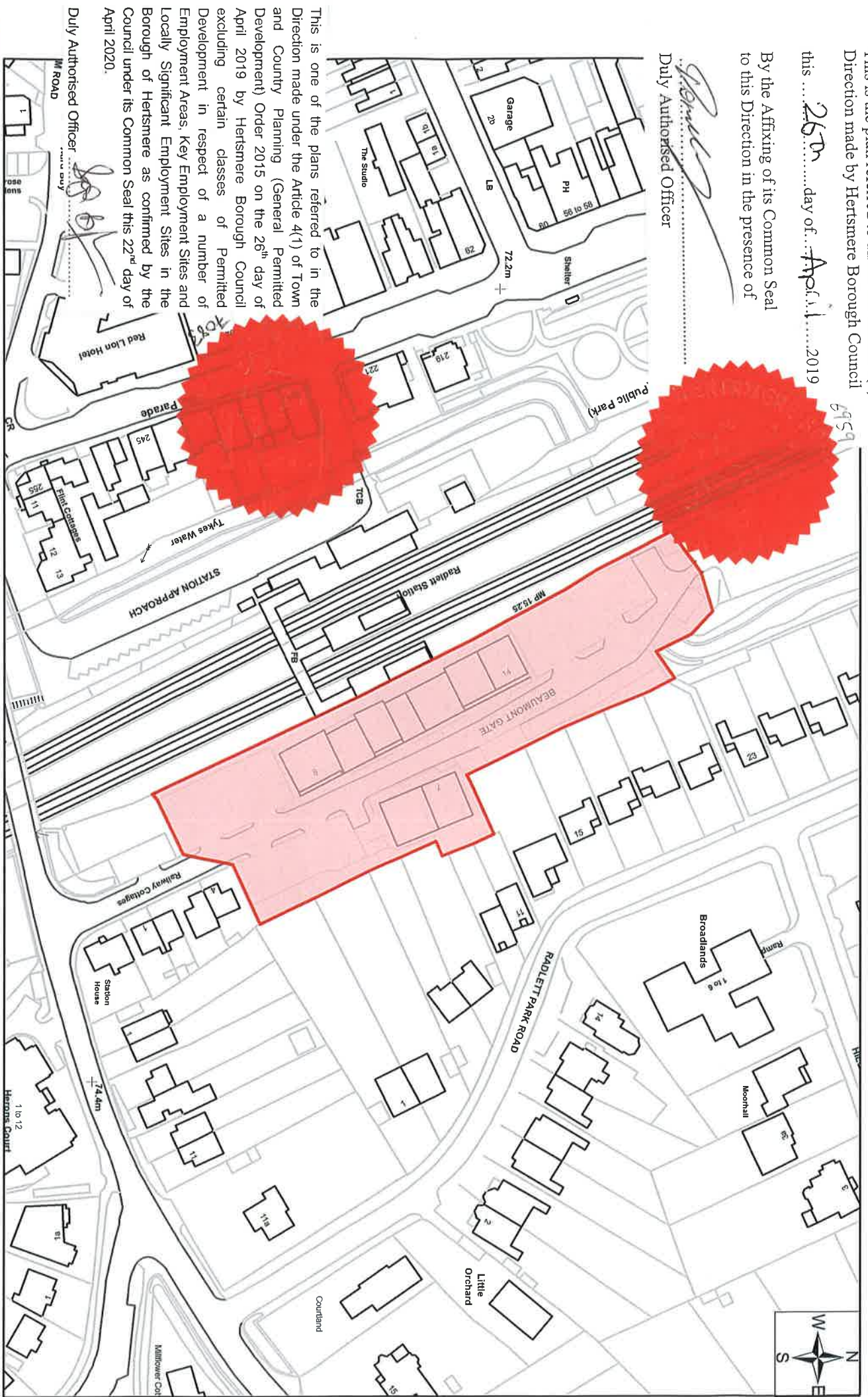

This is one of the plans referred to in the Direction made under the Article 4(1) of Town and Country Planning (General Permitted Development) Order 2015 on the 26th day of April 2019 by Hertsmere Borough Council excluding certain classes of Permitted Development in respect of a number of Employment Areas, Key Employment Sites and Locally Significant Employment Sites in the Borough of Hertsmere as confirmed by the Council under its Common Seal this 22nd day of April 2020.

Duly Authorised Officer  
*[Signature]*

### Legend

 Area to which Article 4 direction applies

 Hertsmere Borough Council Boundary

### Beaumont Gate



You are not permitted to copy, sub-licence, distribute or sell any of this data to third parties in any form. You are permitted to use this data solely to enable you to respond to, or interact with, the organisation that provided you with the data.





This is the plan referred to under the Article 4(1) Direction made by Hertsmere Borough Council

this 26<sup>th</sup> day of April 2019

By the Affixing of its Common Seal to this Direction in the presence of

*[Signature]*  
Duly Authorised Officer

This is one of the plans referred to in the Direction made under the Article 4(1) of Town and Country Planning (General Permitted Development) Order 2015 on the 26<sup>th</sup> day of April 2019 by Hertsmere Borough Council excluding certain classes of Permitted Development in respect of a number of Employment Areas, Key Employment Sites and Locally Significant Employment Sites in the Borough of Hertsmere as confirmed by the Council under its Common Seal this 22<sup>nd</sup> day of April 2020.

Duly Authorised Officer



**Legend**

Area to which Article 4 direction applies

Hertsmere Borough Council Boundary

**Borehamwood Enterprise Centre**



© Crown copyright and database rights 2016 OS EUL 100017428  
You are not permitted to copy, sub-licence, distribute or sell any of this data to third parties in any form.  
You are permitted to use this data solely to enable you to respond to, or interact with, the organisation that provided you with the data.





This is the plan referred to under the Article 4(1) Direction made by Hertsmere Borough Council

this 26<sup>th</sup> day of April 2019

By the Affixing of its Common Seal to this Direction in the presence of

*[Signature]*  
Duly Authorised Officer

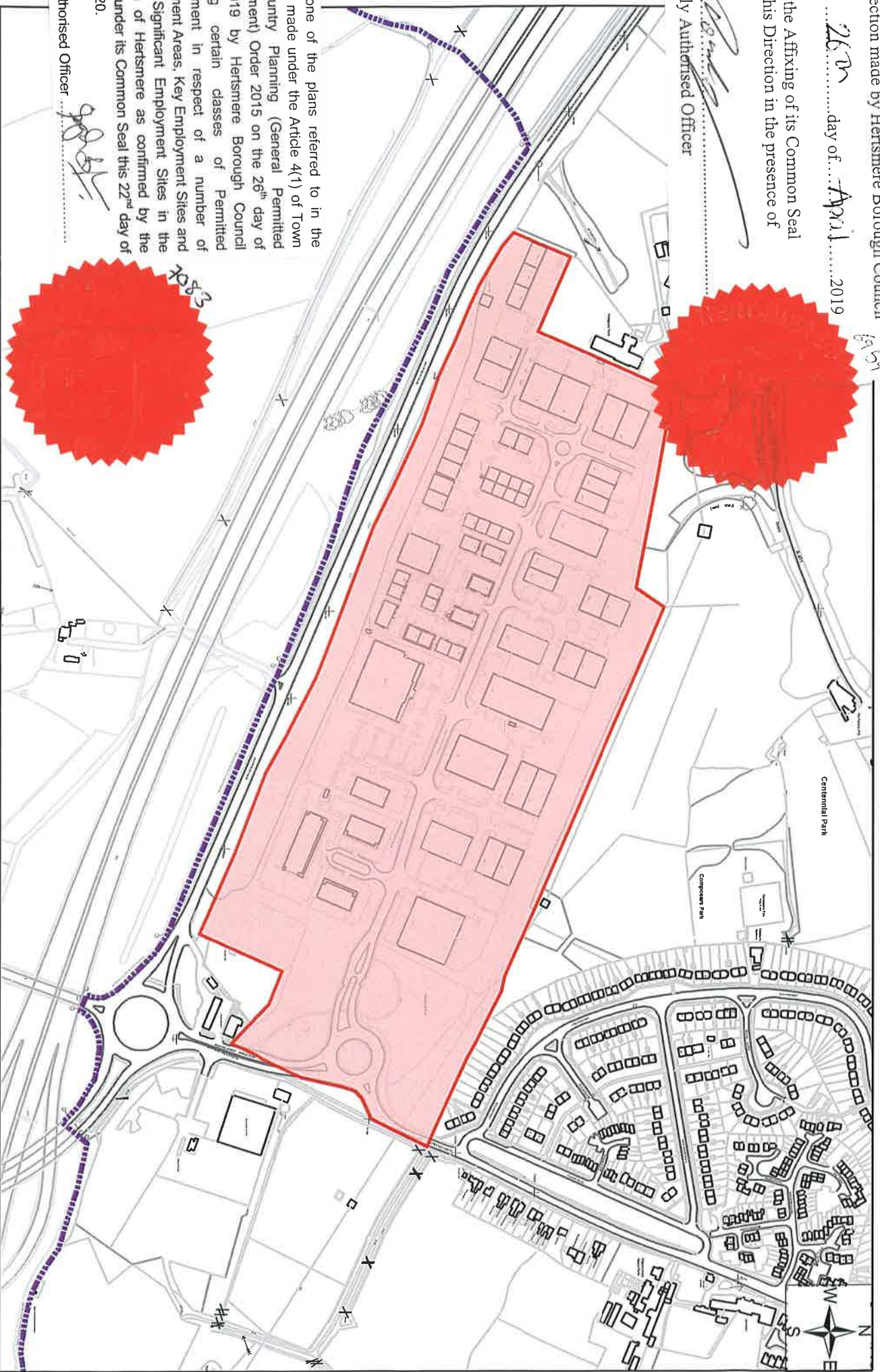

This is one of the plans referred to in the Direction made under the Article 4(1) of Town and Country Planning (General Permitted Development) Order 2015 on the 26<sup>th</sup> day of April 2019 by Hertsmere Borough Council excluding certain classes of Permitted Development in respect of a number of Employment Areas, Key Employment Sites and Locally Significant Employment Sites in the Borough of Hertsmere as confirmed by the Council under its Common Seal this 22<sup>nd</sup> day of April 2020.

Duly Authorised Officer *[Signature]*

### Legend

 Area to which Article 4 direction applies

 Hertsmere Borough Council Boundary

### Centennial Park

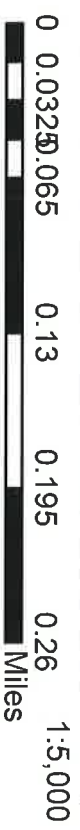

Hertsmere Borough Council Boundary



This is the plan referred to under the Article 4(1) Direction made by Hertsmeire Borough Council

this 26<sup>th</sup> day of April 2019

By the Affixing of its Common Seal to this Direction in the presence of

*[Signature]*  
Duly Authorised Officer

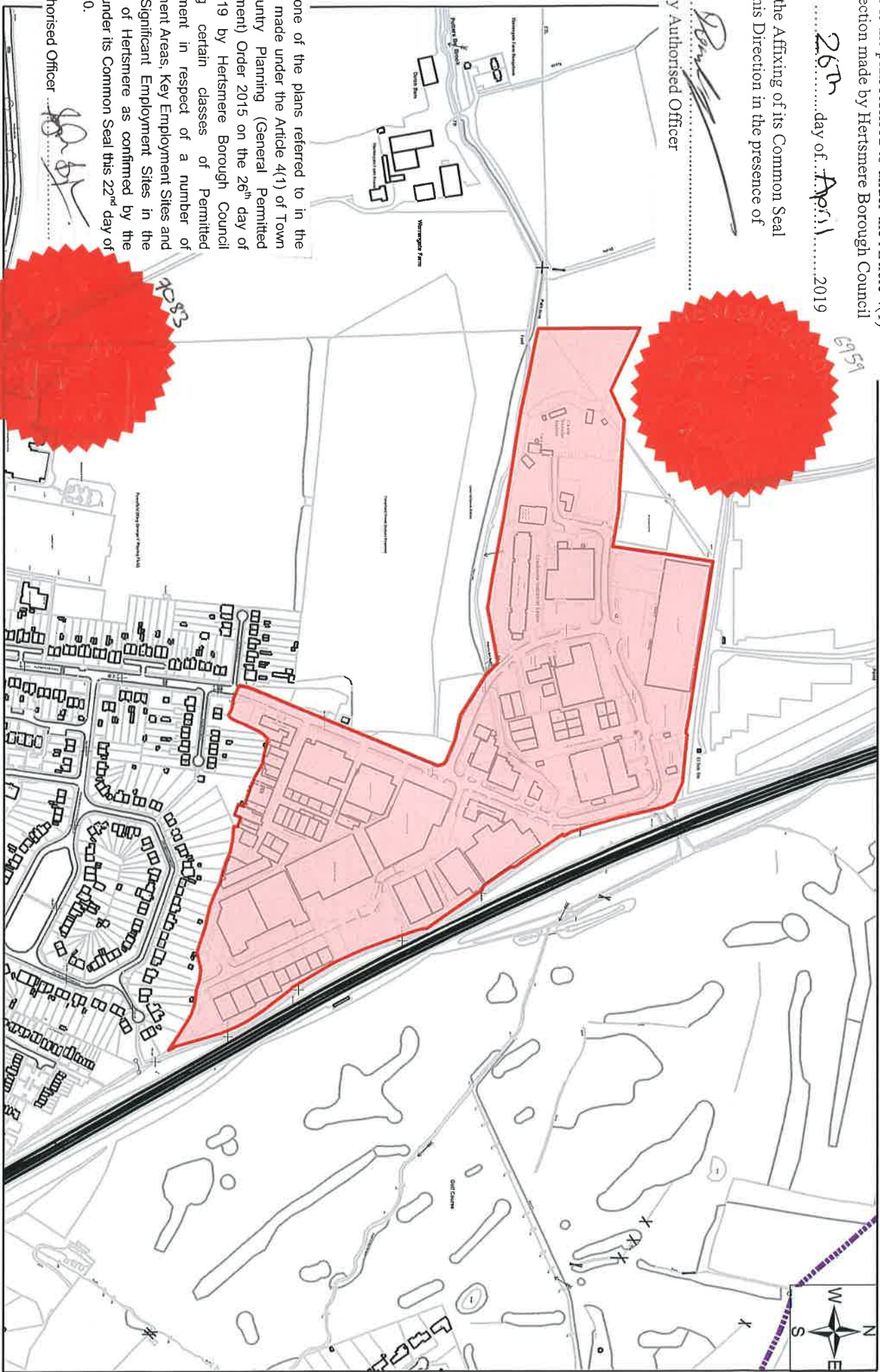

This is one of the plans referred to in the Direction made under the Article 4(1) of Town and Country Planning (General Permitted Development) Order 2015 on the 26<sup>th</sup> day of April 2019 by Hertsmeire Borough Council excluding certain classes of Permitted Development in respect of a number of Employment Areas, Key Employment Sites and Locally Significant Employment Sites in the Borough of Hertsmeire as confirmed by the Council under its Common Seal this 22<sup>nd</sup> day of April 2020.

Duly Authorised Officer

*[Signature]*

### Legend

 Area to which Article 4 direction applies

 Hertsmeire Borough Council Boundary

### Cranbourne Road



© Crown copyright and database rights 2016 OS EUL 100017428  
You are not permitted to copy, sub-licence, distribute or sell any of this data to third parties in any form. You are permitted to use this data solely to enable you to respond to, or interact with, the organisation that provided you with the data.





This is the plan referred to under the Article 4(1) Direction made by Hertsmere Borough Council

this 25th day of April 2019

By the Affixing of its Common Seal to this Direction in the presence of

Duly Authorised Officer

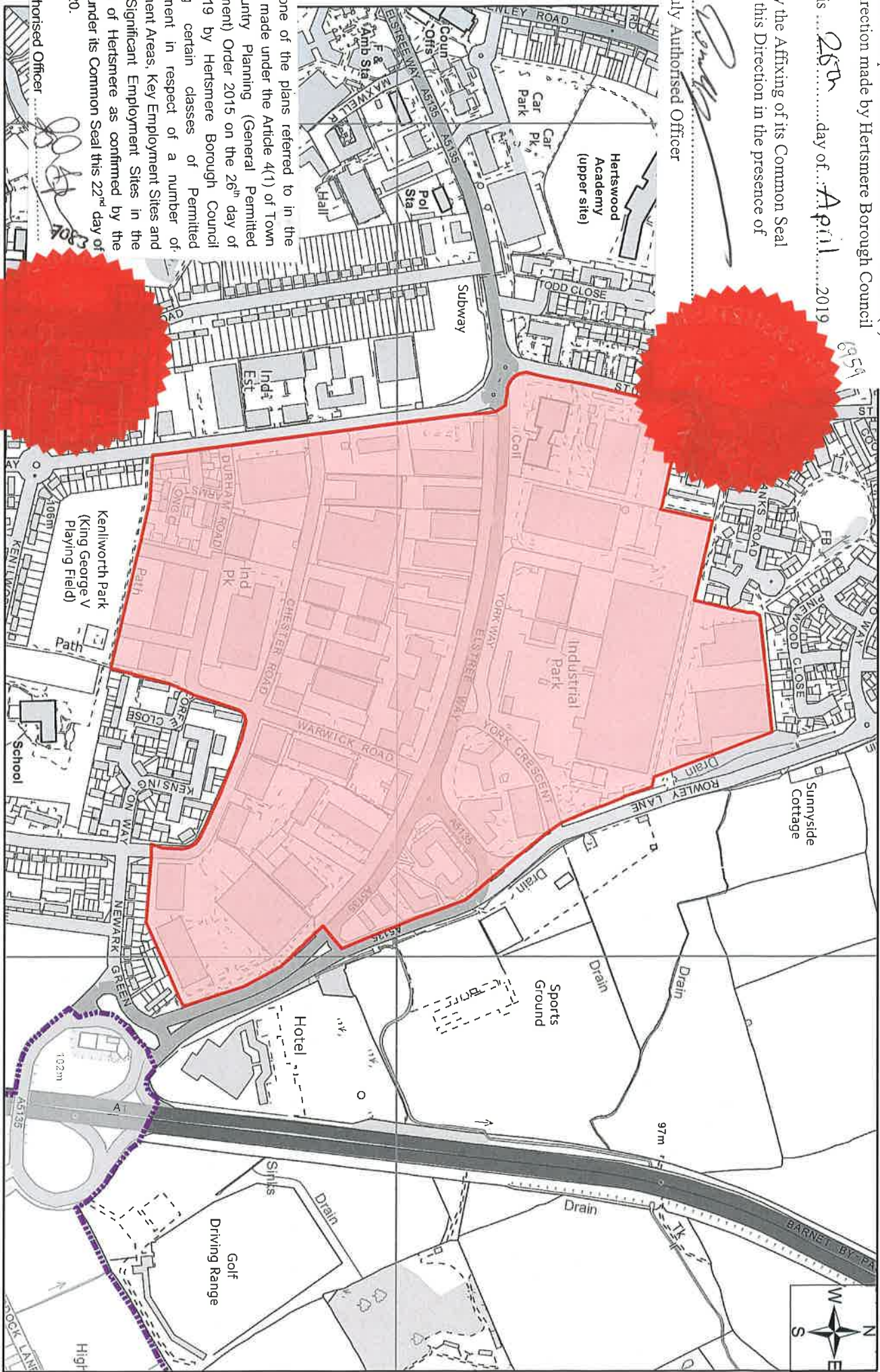

This is one of the plans referred to in the Direction made under the Article 4(1) of Town and Country Planning (General Permitted Development) Order 2015 on the 26th day of April 2019 by Hertsmere Borough Council excluding certain classes of Permitted Development in respect of a number of Employment Areas, Key Employment Sites and Locally Significant Employment Sites in the Borough of Hertsmere as confirmed by the Council under its Common Seal this 22nd day of April 2020.

Duly Authorised Officer

### Legend

Area to which Article 4 direction applies

Hertsmere Borough Council Boundary

### Elstree Way

You are permitted to use this data solely to enable you to respond to, or interact with, the organisation that provided you with the data.





This is the plan referred to under the Article 4(1) Direction made by Hertsmere Borough Council

this ... 26<sup>th</sup> ... day of ... April ... 2019

By the Affixing of its Common Seal to this Direction in the presence of

Duly Authorised Officer

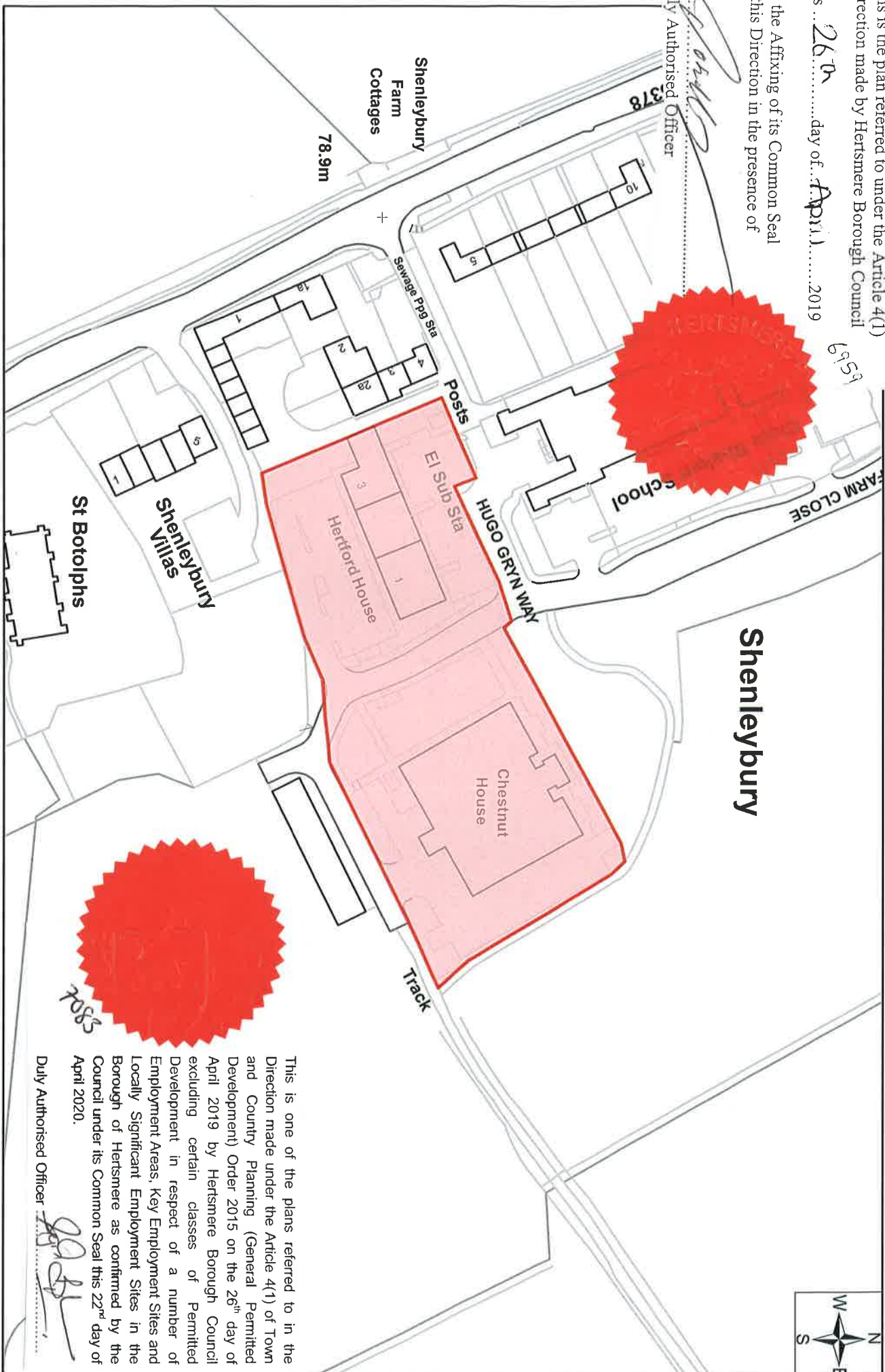

Shenleybury

**Legend**



Area to which Article 4 direction applies



Hertsmere Borough Council Boundary

**Farm Close**

You are permitted to use this data solely to enable you to respond to, or interact with, the organisation that provided you with the data.



1:1,250

This is one of the plans referred to in the Direction made under the Article 4(1) of Town and Country Planning (General Permitted Development) Order 2015 on the 26<sup>th</sup> day of April 2019 by Hertsmere Borough Council excluding certain classes of Permitted Development in respect of a number of Employment Areas, Key Employment Sites and Locally Significant Employment Sites in the Borough of Hertsmere as confirmed by the Council under its Common Seal this 22<sup>nd</sup> day of April 2020.

Duly Authorised Officer

*[Signature]*



Area to which Article 4 direction applies

Hertsmere Borough Council Boundary

You are not permitted to copy, sub-licence, distribute or sell any of this data to third parties in any form.

© Crown copyright and database rights 2016 OS EUL 100017428



This is the plan referred to under the Article 4(1) Direction made by Hertsmere Borough Council

this ... 25<sup>th</sup> ... day of ... April ... 2019

By the Affixing of its Common Seal to this Direction in the presence of

*[Signature]*  
Duly Authorised Officer

This is one of the plans referred to in the Direction made under the Article 4(1) of Town and County Planning (General Permitted Development) Order 2015 on the 26<sup>th</sup> day of April 2019 by Hertsmere Borough Council excluding certain classes of Permitted Development in respect of a number of Employment Areas, Key Employment Sites and Locally Significant Employment Sites in the Borough under its Common Seal this 22<sup>nd</sup> day of April 2020.

Duly Authorised Officer



**Legend**

Area to which Article 4 direction applies

Hertsmere Borough Council Boundary

**Hollies Way Business Park**



You are not permitted to copy, sub-licence, distribute or sell any of this data to third parties in any form. You are permitted to use this data solely to enable you to respond to, or interact with, the organisation that provided you with the data.





This is the plan referred to under the Article 4(1) Direction made by Hertsmere Borough Council

this ..... 26<sup>th</sup> ..... day of ... April ..... 2019

By the Affixing of its Common Seal to this Direction in the presence of

*[Signature]*  
Duly Authorised Officer

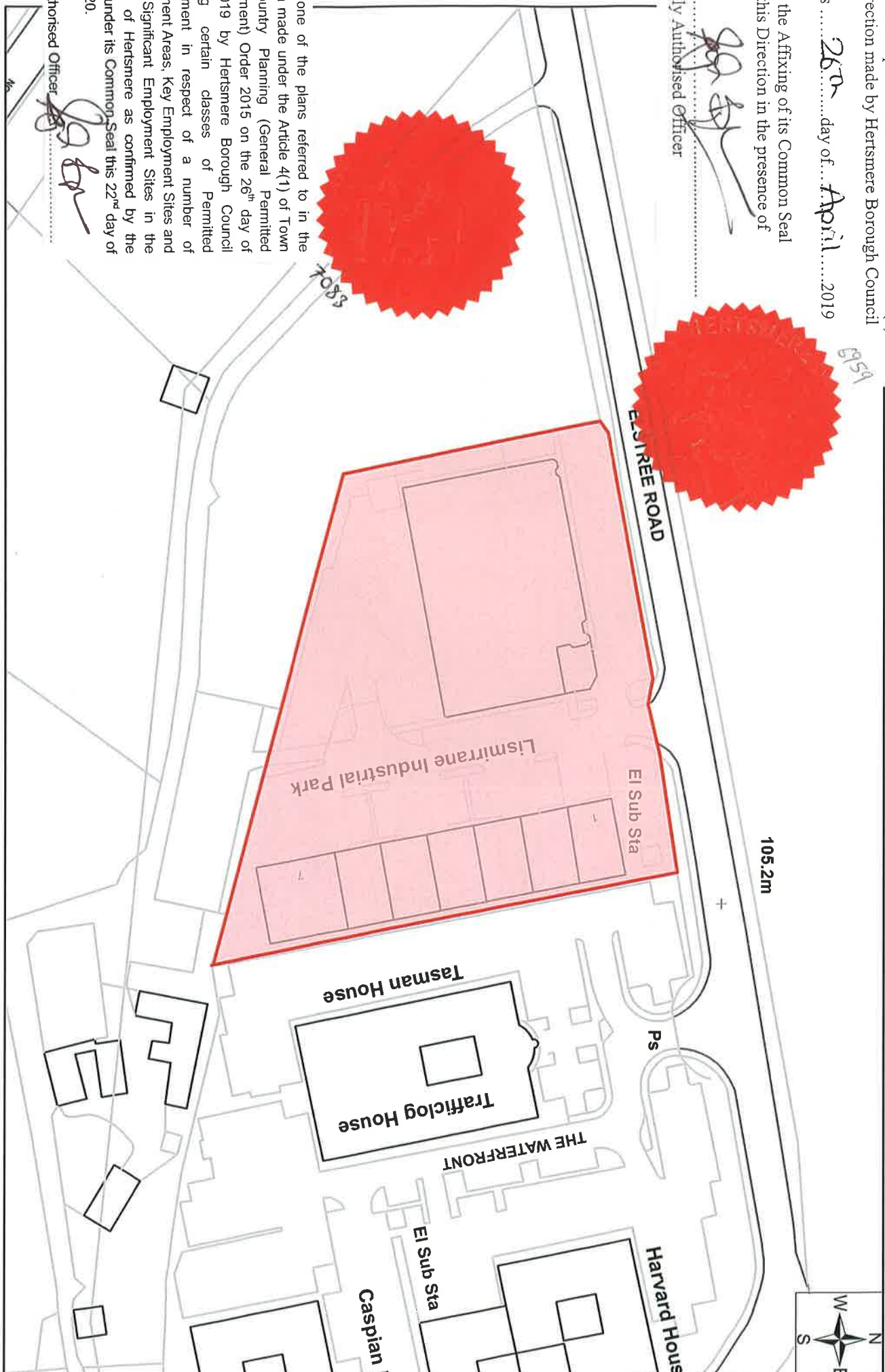

This is one of the plans referred to in the Direction made under the Article 4(1) of Town and Country Planning (General Permitted Development) Order 2015 on the 26<sup>th</sup> day of April 2019 by Hertsmere Borough Council excluding certain classes of Permitted Development in respect of a number of Employment Areas, Key Employment Sites and Locally Significant Employment Sites in the Borough of Hertsmere as confirmed by the Council under its Common Seal this 22<sup>nd</sup> day of April 2020.

Duly Authorised Officer *[Signature]*



**Legend**

- Area to which Article 4 direction applies
- Hertsmere Borough Council Boundary

**Lismirrane Industrial Park**

0 0.0075 0.015 0.03 0.045 0.06 1:1,250

Miles

You are not permitted to copy, sub-licence, distribute or sell any of this data to third parties in any form. You are permitted to use this data solely to enable you to respond to, or interact with, the organisation that provided you with the data.

© Crown copyright and database rights 2016 OS EUL 100017428



This is the plan referred to under the Article 4(1) Direction made by Hertsmere Borough Council

this 26<sup>th</sup> day of April 2019

By the Affixing of its Common Seal to this Direction in the presence of

Duly Authorised Officer

*[Signature]*



This is one of the plans referred to in the Direction made under the Article 4(1) of Town and Country Planning (General Permitted Development) Order 2015 on the 26<sup>th</sup> day of April 2019 by Hertsmere Borough Council excluding certain classes of Permitted Development in respect of a number of Employment Areas, Key Employment Sites and Locally Significant Employment Sites in the Borough of Hertsmere as confirmed by the Council under its Common Seal this 22<sup>nd</sup> day of April 2020.

Duly Authorised Officer

*[Signature]*

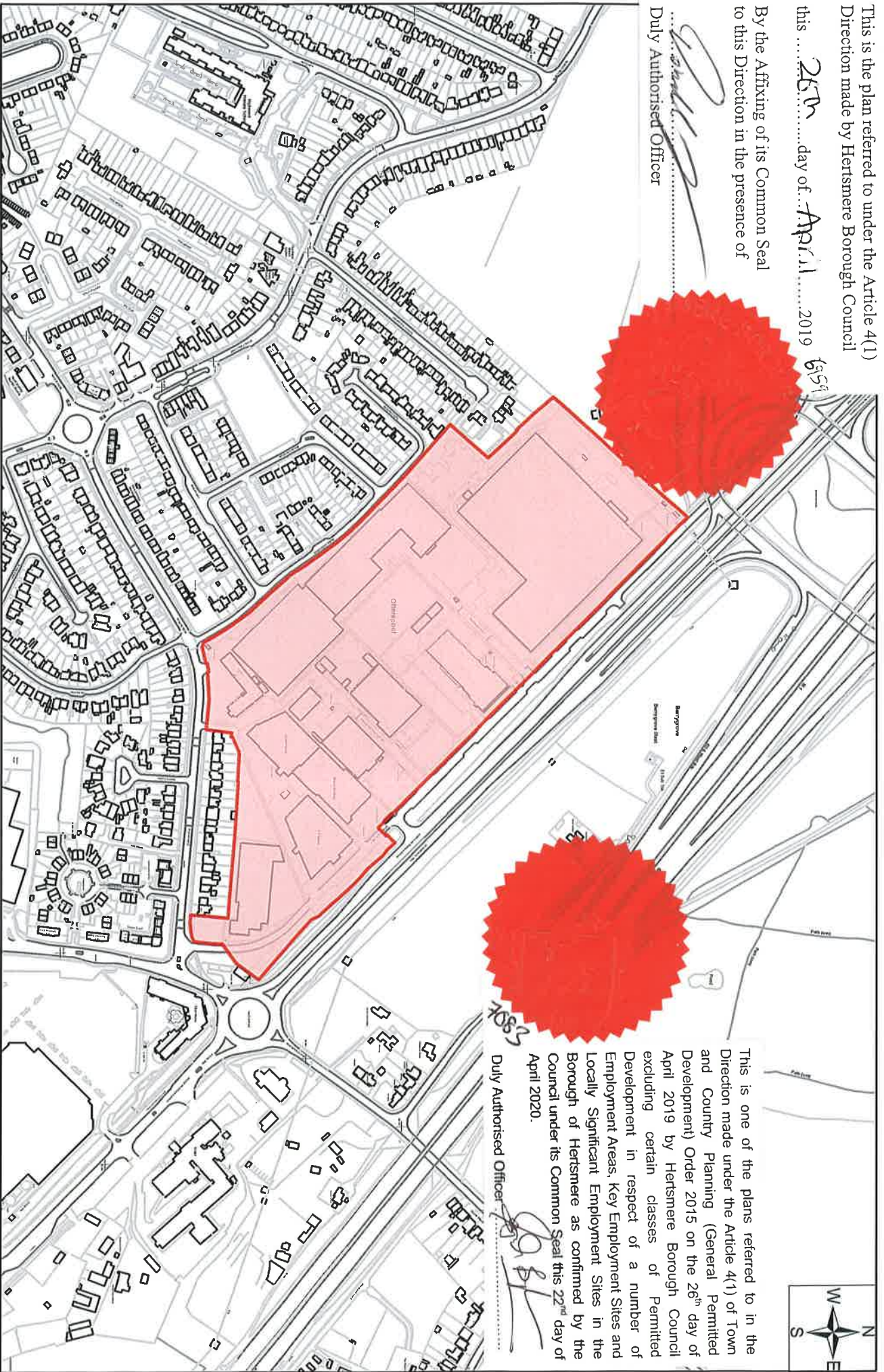

**Legend**

Area to which Article 4 direction applies



Hertsmere Borough Council Boundary

**Otterspool way**



You are not permitted to copy, sub-licence, distribute or sell any of this data to third parties in any form. You are permitted to use this data solely to enable you to respond to, or interact with, the organisation that provided you with the data.



HERTSMERE



This is the plan referred to under the Article 4(1) Direction made by Hertsmeire Borough Council

this ... 26<sup>th</sup> ... day of ... April ... 2019

By the Affixing of its Common Seal to this Direction in the presence of

Duly Authorised Officer

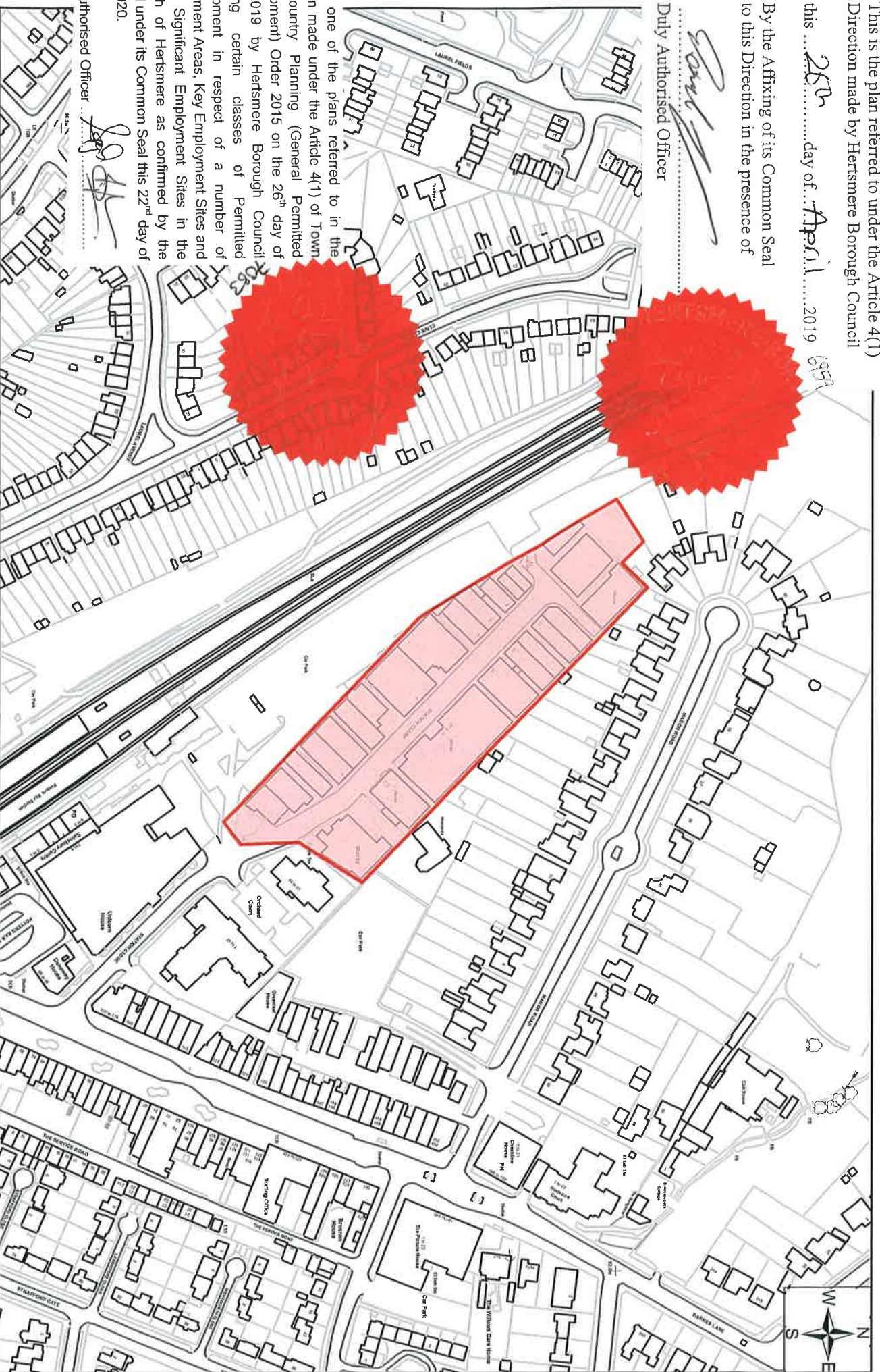

This is one of the plans referred to in the Direction made under the Article 4(1) of Town and Country Planning (General Permitted Development) Order 2015 on the 26<sup>th</sup> day of April 2019 by Hertsmeire Borough Council excluding certain classes of Permitted Development in respect of a number of Employment Areas, Key Employment Sites and Locally Significant Employment Sites in the Borough of Hertsmeire as confirmed by the Council under its Common Seal this 22<sup>nd</sup> day of April 2020.

Duly Authorised Officer

[Signature]

**Legend**

Area to which Article 4 direction applies

Hertsmeire Borough Council Boundary

**Station Close**

