

**TOWN AND COUNTRY PLANNING
(GENERAL PERMITTED DEVELOPMENT) ORDER 2015, AS AMENDED
DIRECTION MADE UNDER ARTICLE 4(1)**

HERTSMERE BOROUGH COUNCIL

WHEREAS Hertsmere Borough Council (“the Council”) being the appropriate local planning authority within the meaning of article 4(5) of the Town and Country Planning (General Permitted Development) Order 2015 (“the Order”), as amended, are satisfied that it is expedient that development of the description(s) set out in the Schedule below should not be carried out on the land shown edged/coloured in red on the attached plans unless planning permission is granted on an application made under Part III of the Town and Country Planning Act 1990, as amended.

NOW THEREFORE the said Council in pursuance of the power conferred on them by Article 4(1) of the Order, **HEREBY DIRECT** that the permission granted by Class O of Part 3, Schedule 2 of the said Order shall not apply to the land described in the Schedule below.

THIS DIRECTION is made under Article 4(1) of the said Order and, in accordance with paragraph 1 of Schedule 3 of the Order shall come into force on 27 April 2020.

SCHEDULE

(the Permitted Development excluded by this Direction)

1. Development consisting of a change use of a building and any land within its curtilage from a use falling within Class B1(a) (offices) of the Schedule to the Town and Country Planning (Use Classes) Order 1987 (as amended), to a use falling within Class C3 (dwellinghouses) of that Schedule being development comprised within Class O of Part 3 of Schedule 2 to the Order and not being development comprised within any other Class within the identified locations listed below and as indicated in the attached plans.
 - Employment Areas – (1) Elstree Way and (2) Stirling Way, Borehamwood; (3) Cranborne Road and (4) Station Close, Potters Bar; and (5) Otterspool Way, Bushey;
 - Key Employment Site – (1) Centennial Park, Elstree; and
 - Locally Significant Employment Sites – (1) Wrotham Business Park; (2) Borehamwood Enterprise Centre and (3) Theobald Court, Borehamwood; (4) Lismirrane Industrial Park, Elstree; (5) Hollies Way, Potters Bar; (6) Beaumont Gate, Radlett; (7) Farm Close, Shenley.

Made under the Common Seal of
Hertsmere Borough Council

this ⁶⁹⁵⁹ 26thday of....April.....2019
The Common Seal of Hertsmere Borough Council
was affixed to this Direction in the presence of

.....
Duly Authorised Officer



Confirmed under the Common Seal of
Hertsmere Borough Council

thisday of.....
The Common Seal of Hertsmere Borough Council
was affixed to this Direction in the presence of

.....
Duly Authorised Officer

THIS DIRECTION COMES INTO FORCE ON 27 APRIL 2020 IF CONFIRMED

69A

Duly Authorised Officer

This is the plan referred to under the Article 4(1)
Direction made by Hertsmere Borough Council

this ... 26th day of ... April, 2019

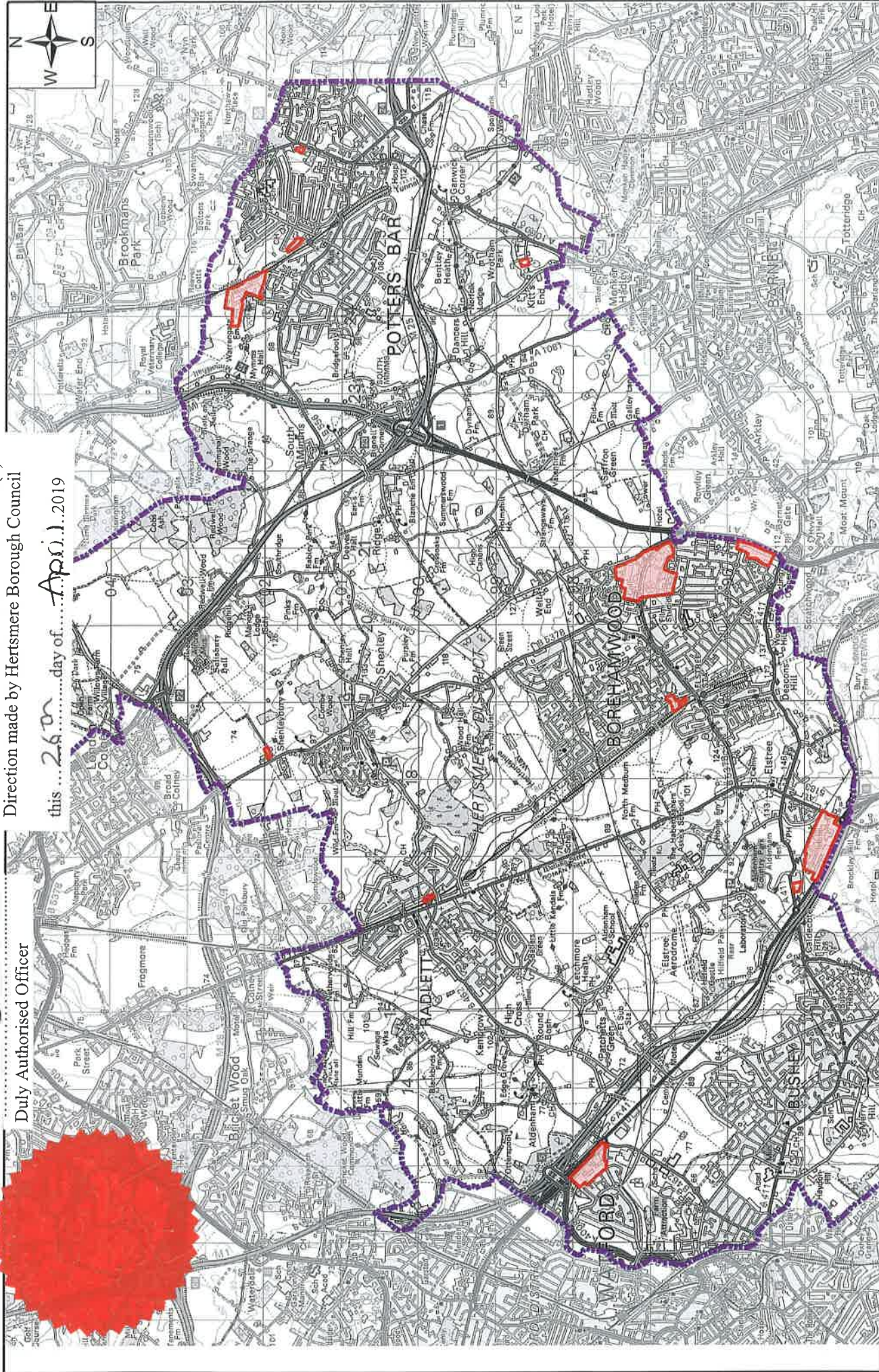

Legend



Area to which Article 4 direction applies



Hertsmere Borough Council Boundary

Map of Hertsmere showing all areas 0 where Article 4 directions apply

0 0.425 0.85 1.7 2.55 3.4 1:65,000

Miles

© Crown copyright and database rights 2016 OS EUL 100017428
You are not permitted to copy, sub-licence, distribute or sell any of this data to third parties in any form.
You are permitted to use this data solely to enable you to respond to, or interact with, the organisation that provided you with the data.

This is the plan referred to under the Article 4(1) Direction made by Hertsmere Borough Council

this 26th day of April 2019

By the Affixing of its Common Seal to this Direction in the presence of

[Signature]
Duly Authorised Officer

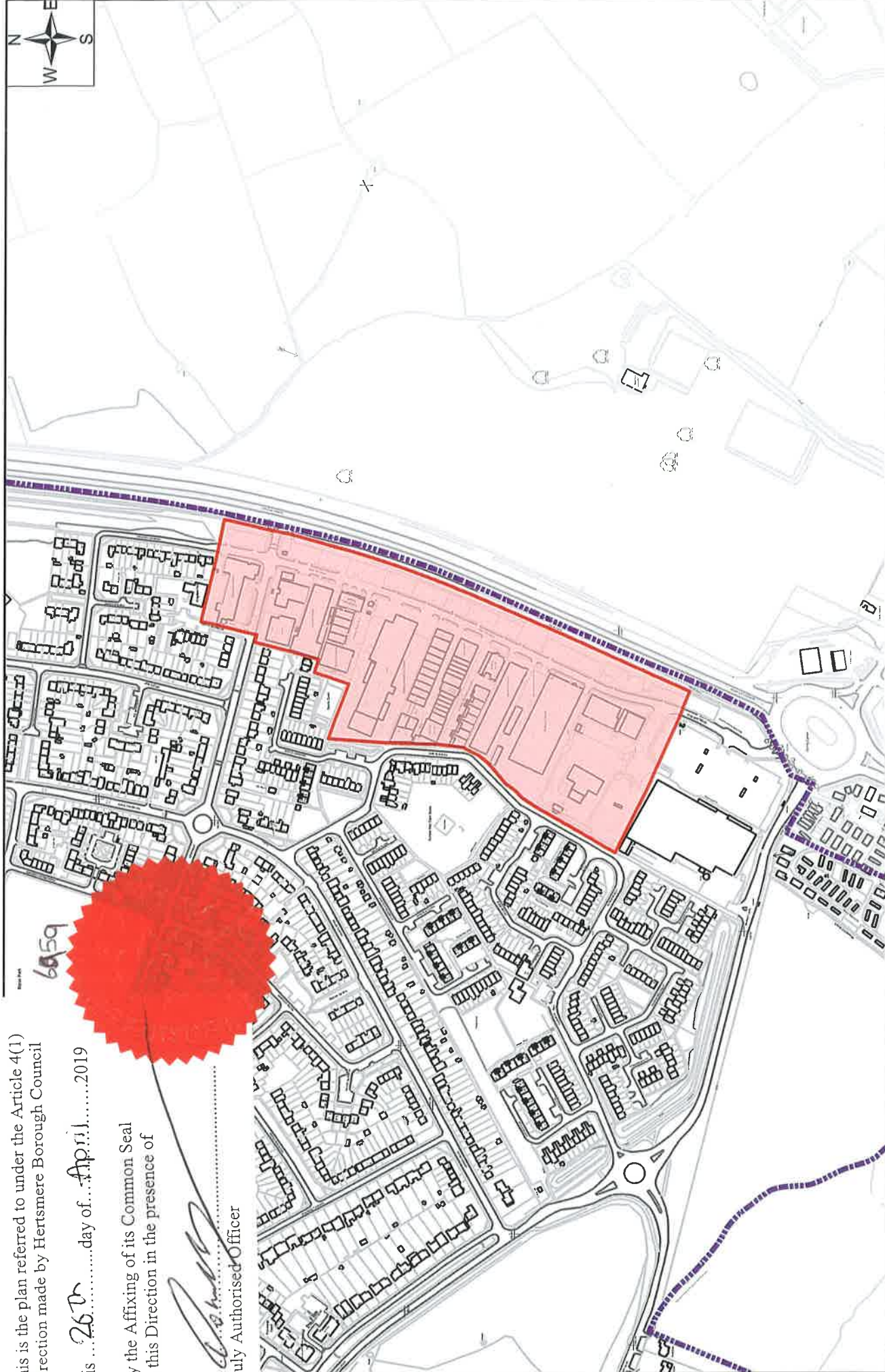

6059



Legend

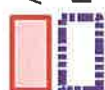

Area to which Article 4 direction applies
Hertsmere Borough Council Boundary

Stirling Way



© Crown copyright and database rights 2016 OS EUL 100017428
You are not permitted to copy, sub-licence, distribute or sell any of this data to third parties in any form.
You are permitted to use this data solely to enable you to respond to, or interact with, the organisation that provided you with the data.

This is the plan referred to under the Article 4(1) Direction made by Hertsmere Borough Council

this 26th day of April 2019

By the Affixing of its Common Seal to this Direction in the presence of

Duly Authorised Officer

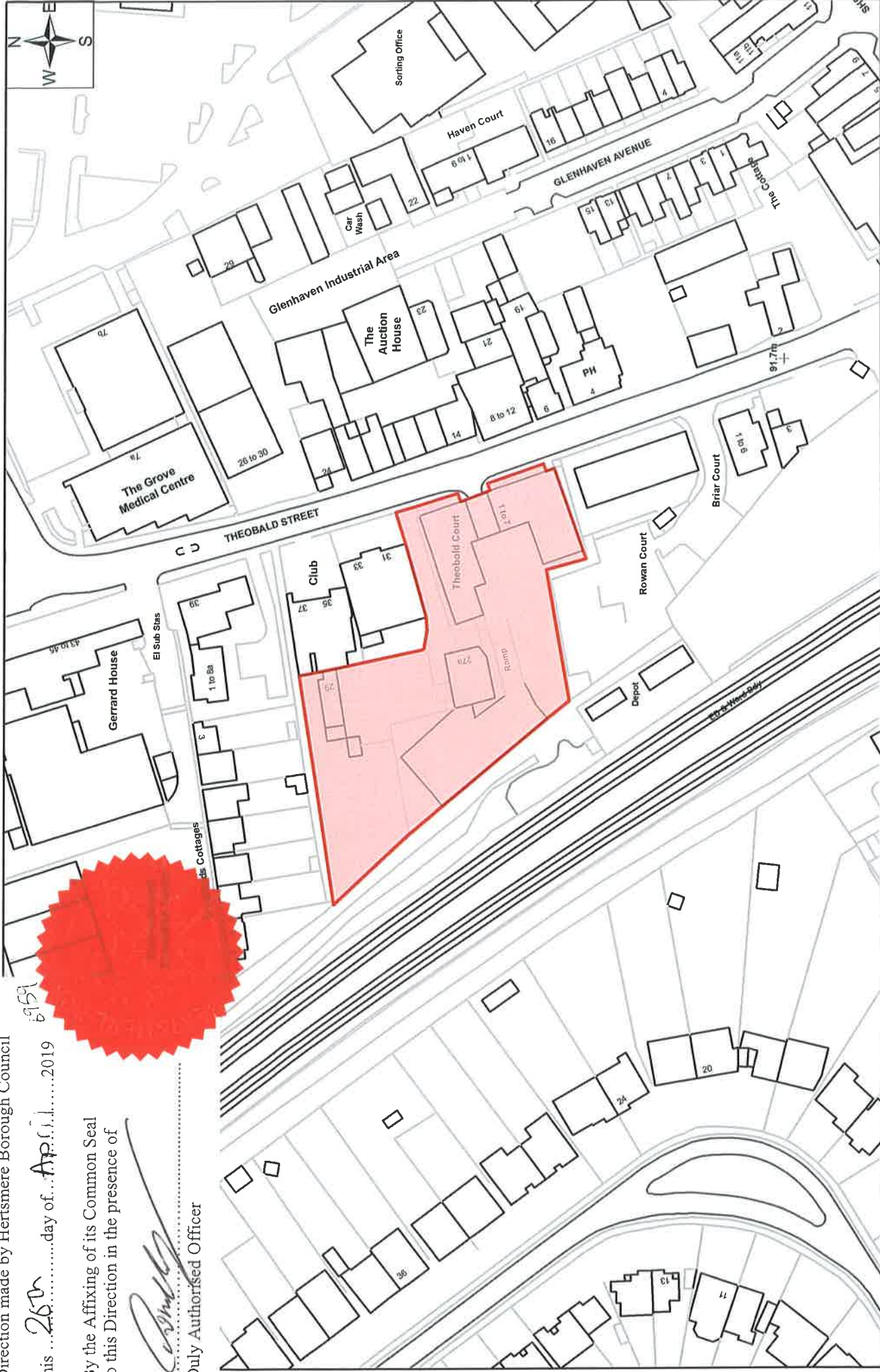

Legend

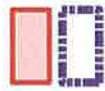

Area to which Article 4 direction applies

Hertsmere Borough Council Boundary

Theobald Court

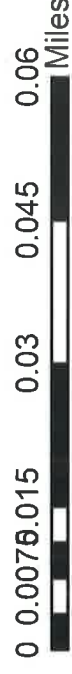

© Crown copyright and database rights 2016 OS EUL 100017428
You are not permitted to copy, sub-licence, distribute or sell any of this data to third parties in any form.
You are permitted to use this data solely to enable you to respond to, or interact with, the organisation that provided you with the data.

This is the plan referred to under the Article 4(1) Direction made by Hertsmere Borough Council

this 26 day of April 2019

By the Affixing of its Common Seal to this Direction in the presence of

[Signature]
Duly Authorised Officer

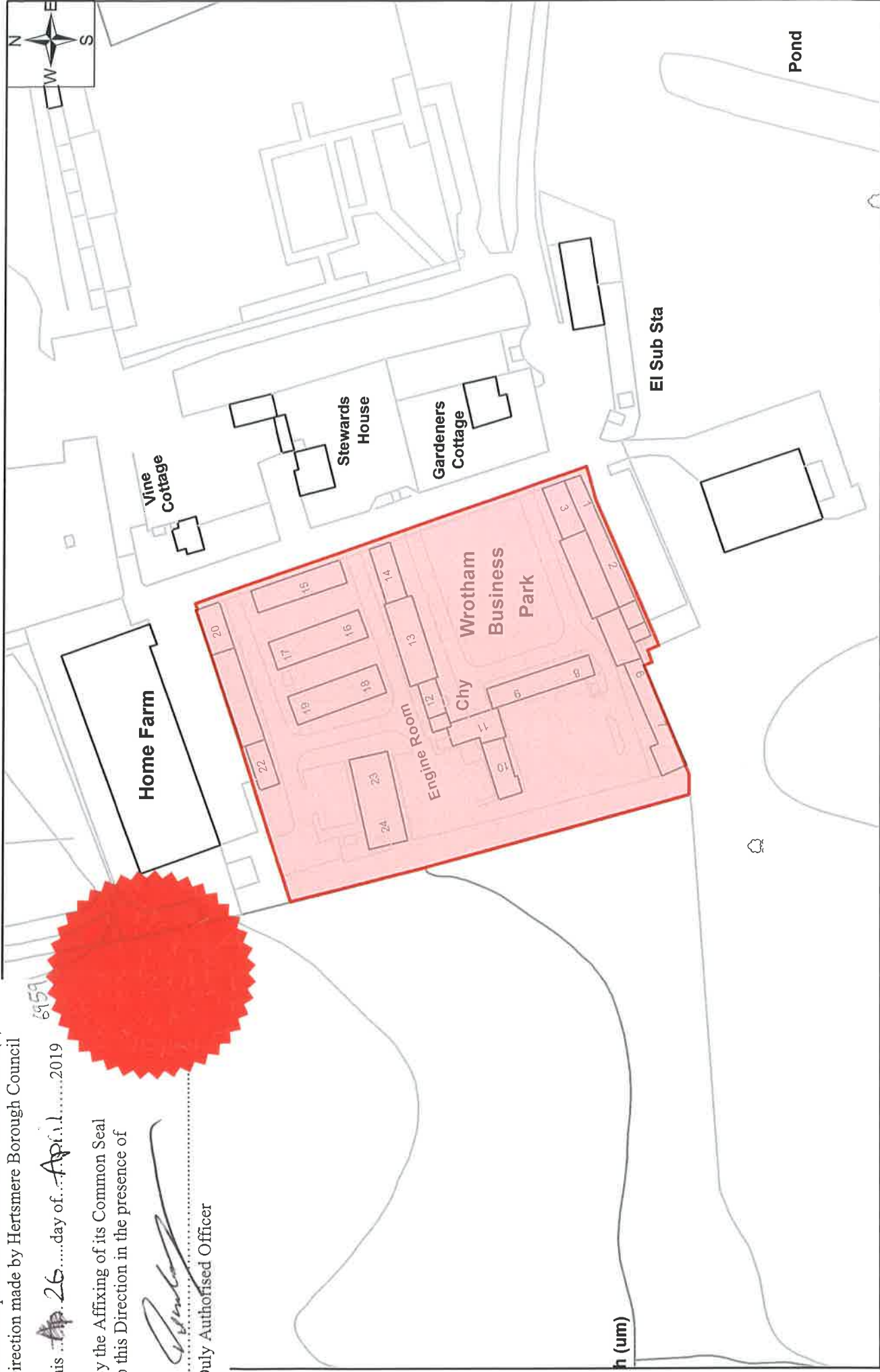

Legend



Area to which Article 4 direction applies
Hertsmere Borough Council Boundary

Wrotham Business Park



1:1,250

© Crown copyright and database rights 2016 OS EUL 100017428
You are not permitted to copy, sub-licence, distribute or sell any of this data to third parties in any form.
You are permitted to use this data solely to enable you to respond to, or interact with, the organisation that provided you with the data.

This is the plan referred to under the Article 4(1) Direction made by Hertsmere Borough Council

this 26th day of April 2019

By the Affixing of its Common Seal to this Direction in the presence of

[Signature]
Duly Authorised Officer

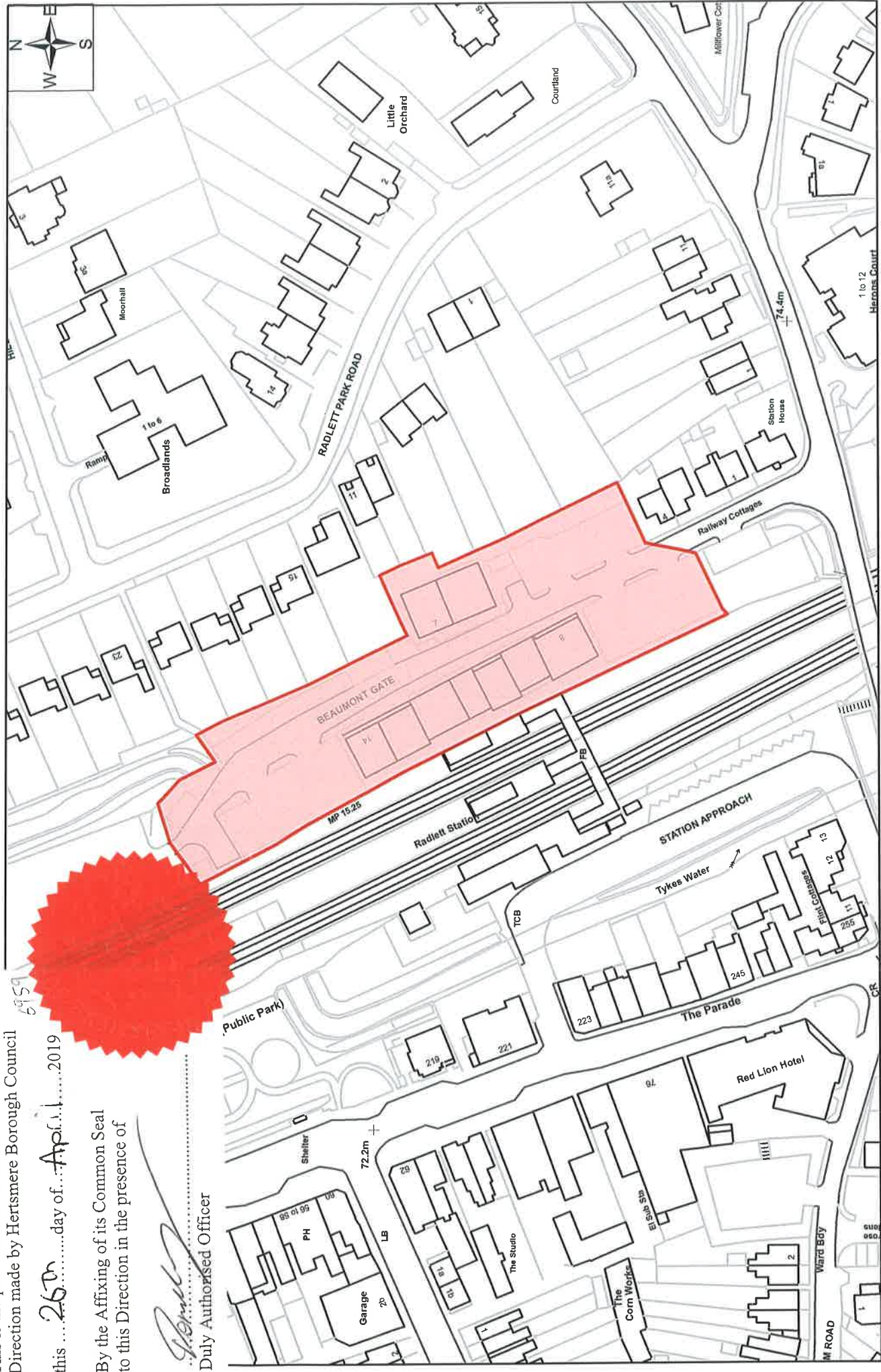

Legend

- Area to which Article 4 direction applies
- Hertsmere Borough Council Boundary

Beaumont Gate



© Crown copyright and database rights 2016 OS EUL 100017428
 You are not permitted to copy, sub-licence, distribute or sell any of this data to third parties in any form.
 You are permitted to use this data solely to enable you to respond to, or interact with, the organisation that provided you with the data.

This is the plan referred to under the Article 4(1) Direction made by Hertsmere Borough Council

this ... 26th ... day of April ... 2019

By the Affixing of its Common Seal to this Direction in the presence of

[Signature]
Duly Authorised Officer

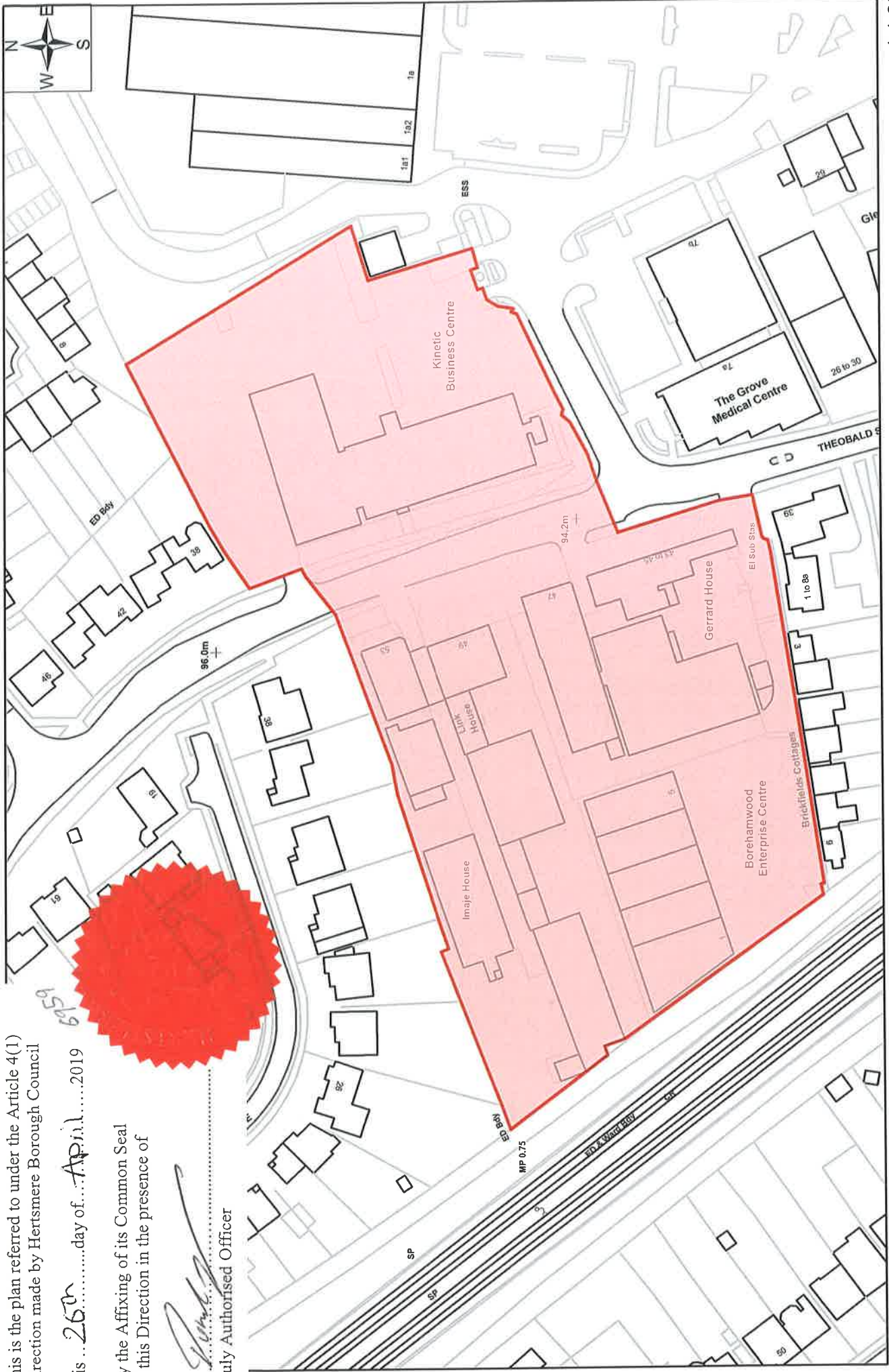

1:1,250
0 0.0078.015 0.03 0.045 0.06 Miles

Legend

-  Area to which Article 4 direction applies
-  Hertsmere Borough Council Boundary



© Crown copyright and database rights 2016 OS EUL 100017428
You are not permitted to copy, sub-licence, distribute or sell any of this data to third parties in any form.
You are permitted to use this data solely to enable you to respond to, or interact with, the organisation that provided you with the data.

This is the plan referred to under the Article 4(1) Direction made by Hertsmere Borough Council

this 26th day of April 2019

By the Affixing of its Common Seal to this Direction in the presence of

[Signature]
Duly Authorised Officer

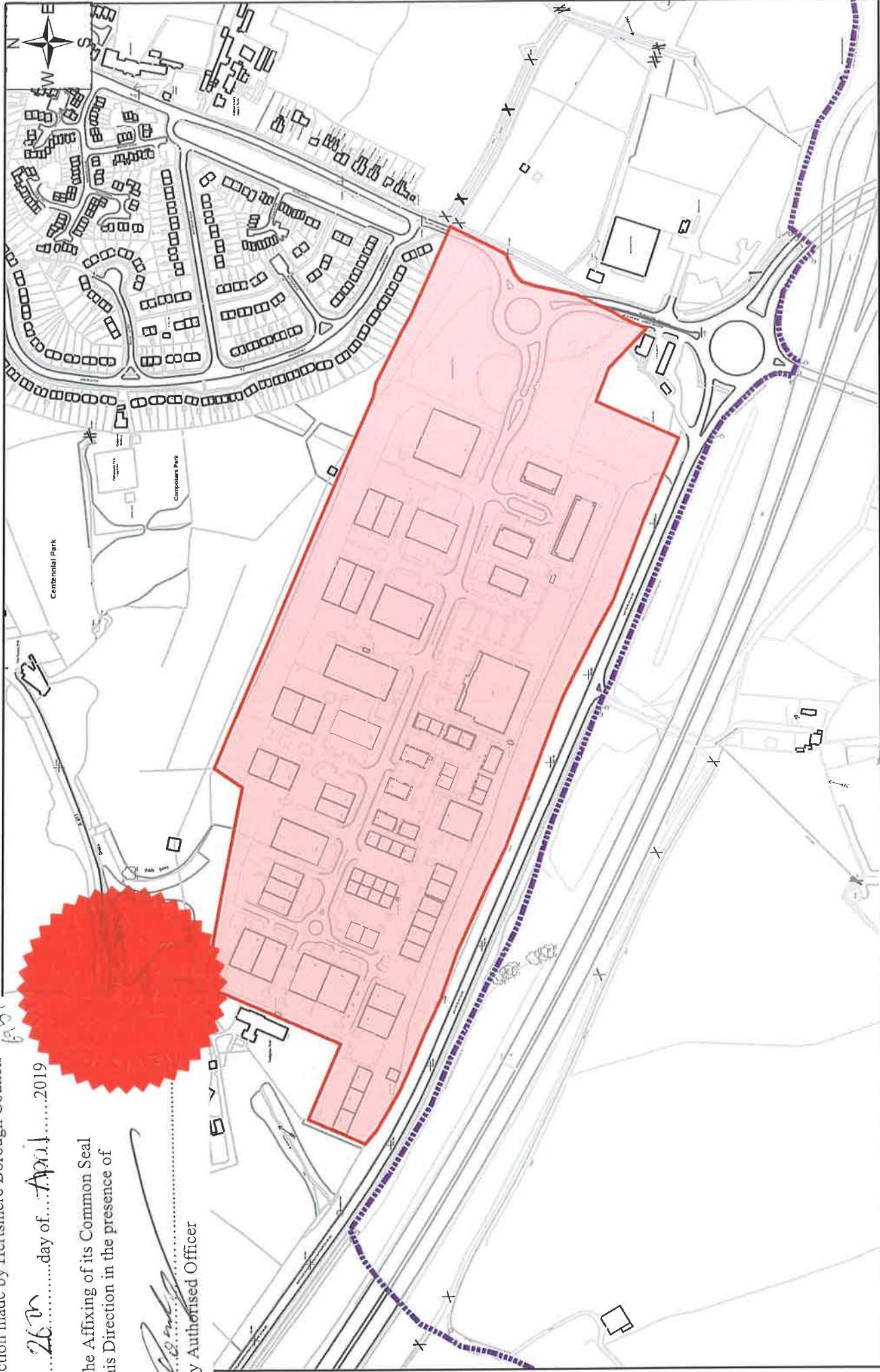

Legend

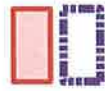

Area to which Article 4 direction applies
Hertsmere Borough Council Boundary

Centennial Park



© Crown copyright and database rights 2016 OS EUL 100017428
You are not permitted to copy, sub-licence, distribute or sell any of this data to third parties in any form.
You are permitted to use this data solely to enable you to respond to, or interact with, the organisation that provided you with the data.

This is the plan referred to under the Article 4(1) Direction made by Hertsmere Borough Council

this 26th day of April 2019

By the Affixing of its Common Seal to this Direction in the presence of

[Signature]
Duly Authorised Officer



Legend



Area to which Article 4 direction applies
Hertsmere Borough Council Boundary

Cranbourne Road



© Crown copyright and database rights 2016 OS EUL 100017428
You are not permitted to copy, sub-licence, distribute or sell any of this data to third parties in any form.
You are permitted to use this data solely to enable you to respond to, or interact with, the organisation that provided you with the data.

This is the plan referred to under the Article 4(1) Direction made by Hertsmere Borough Council

this 25th day of April 2019

By the Affixing of its Common Seal to this Direction in the presence of

[Signature]
Duly Authorised Officer

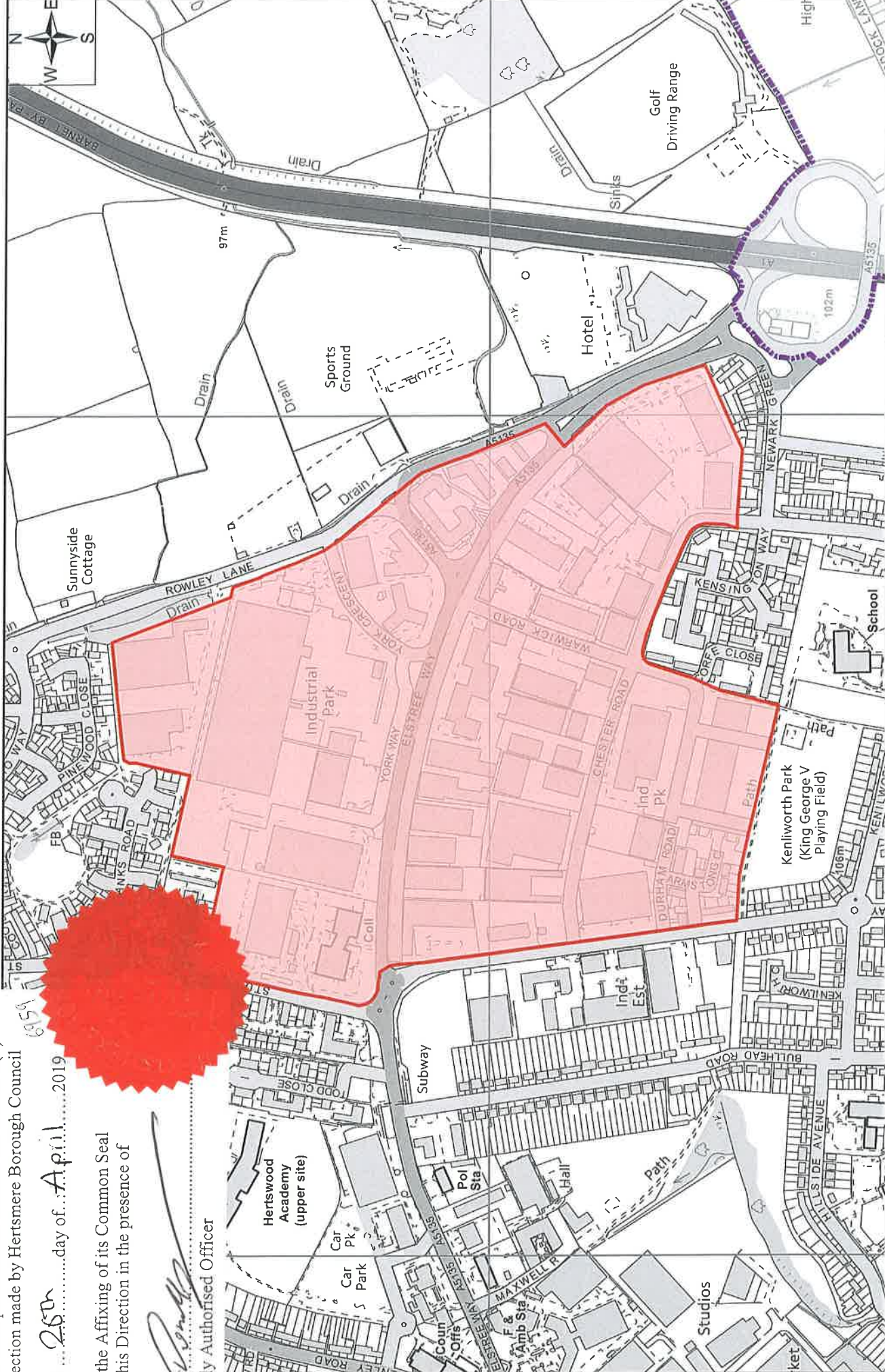

Legend



Area to which Article 4 direction applies



Hertsmere Borough Council Boundary

Elstree Way



© Crown copyright and database rights 2016 OS EUL 100017428
You are not permitted to copy, sub-licence, distribute or sell any of this data to third parties in any form.
You are permitted to use this data solely to enable you to respond to, or interact with, the organisation that provided you with the data.

This is the plan referred to under the Article 4(1)
Direction made by Hertsmere Borough Council

this 26th day of April 2019

By the Affixing of its Common Seal
to this Direction in the presence of

Duly Authorised Officer

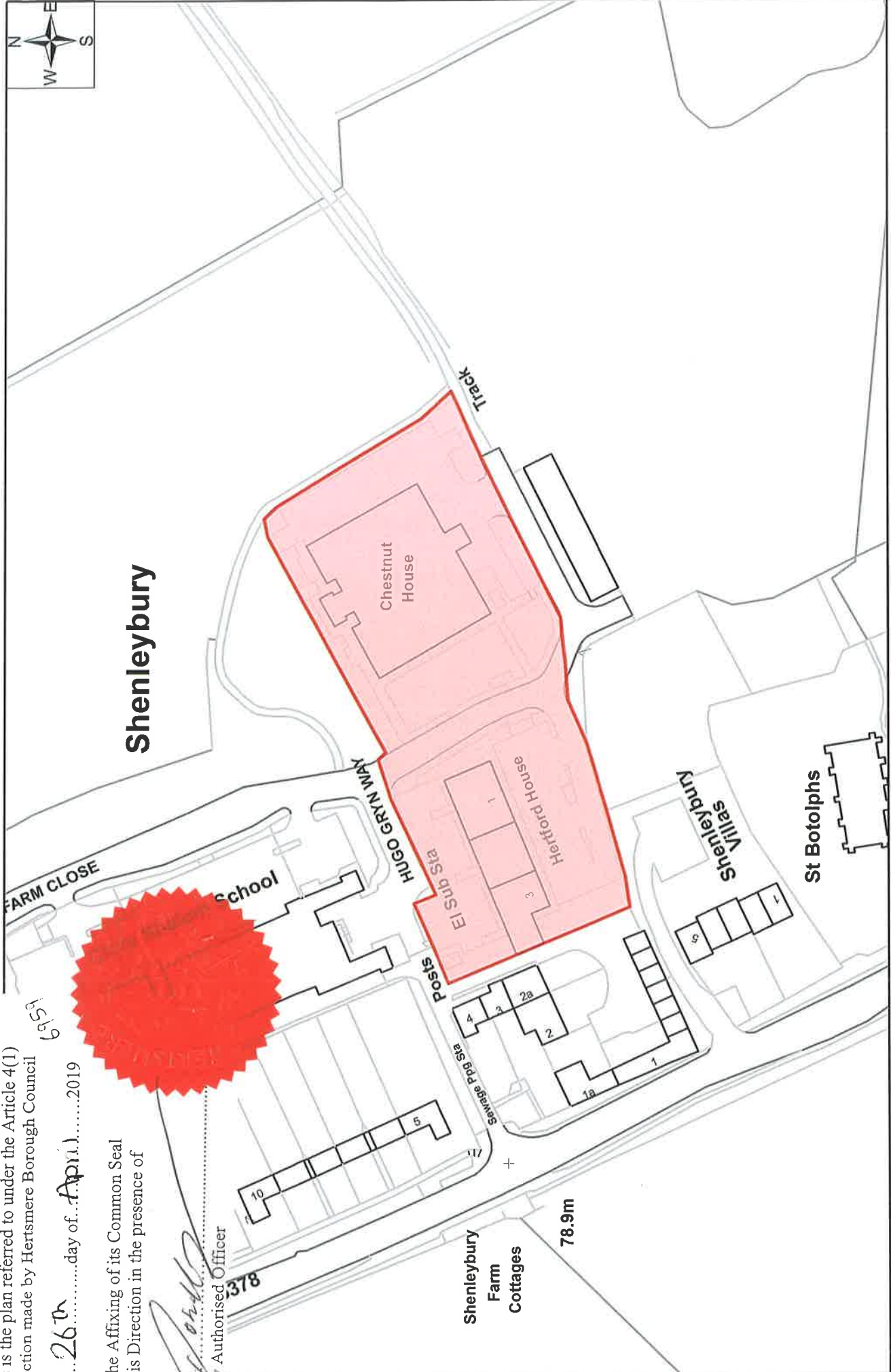

Legend



Area to which Article 4 direction applies
Hertsmere Borough Council Boundary

Farm Close



© Crown copyright and database rights 2016 OS EUL 100017428
You are not permitted to copy, sub-licence, distribute or sell any of this data to third parties in any form.
You are permitted to use this data solely to enable you to respond to, or interact with, the organisation that provided you with the data.

This is the plan referred to under the Article 4(1) Direction made by Hertsmere Borough Council

this ... 25th ... day of ... April ... 2019

By the Affixing of its Common Seal to this Direction in the presence of

[Signature]
Duly Authorised Officer

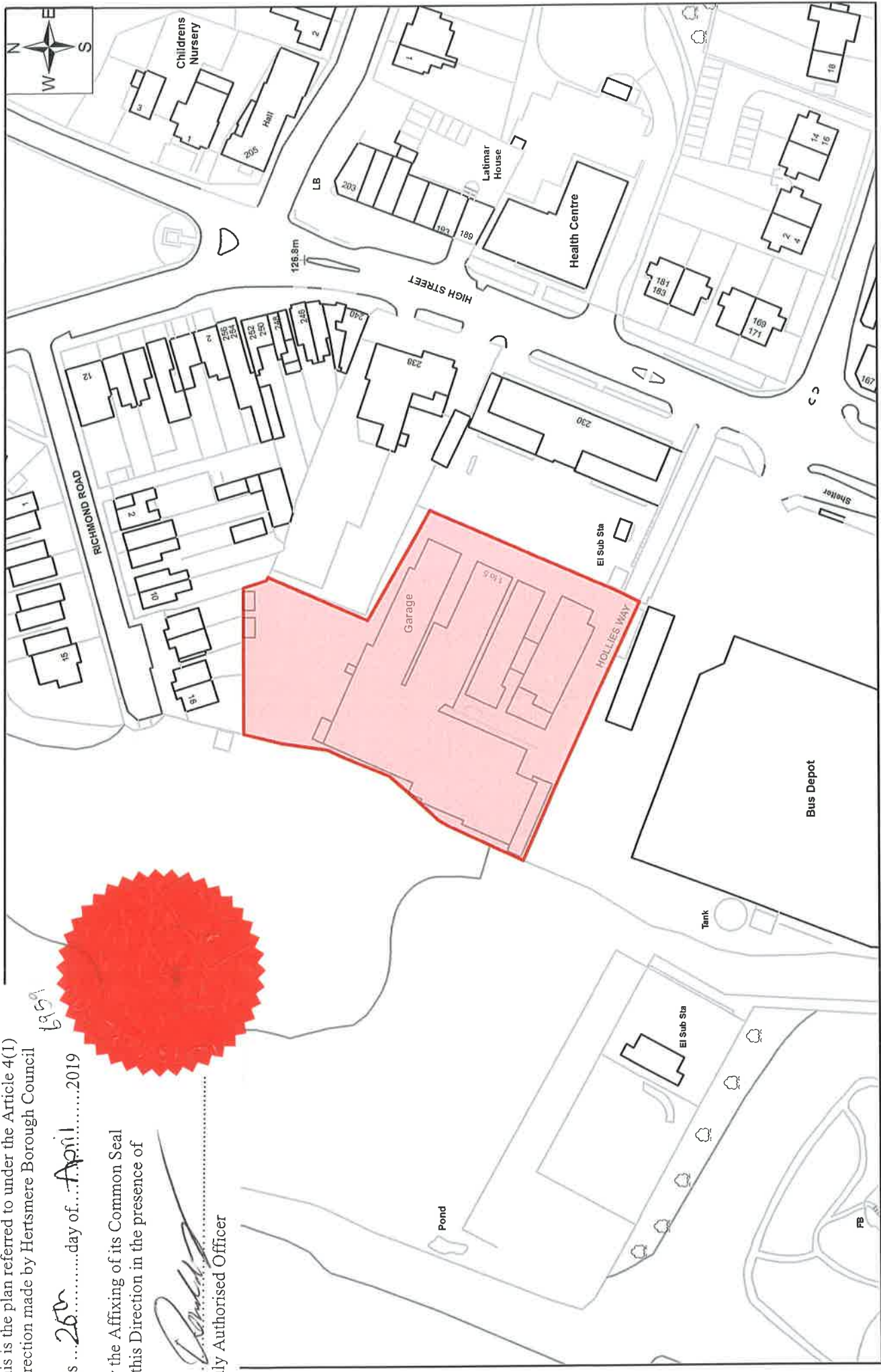

Legend

- Area to which Article 4 direction applies
- Hertsmere Borough Council Boundary

Hollies Way Business Park



1:1,250

© Crown copyright and database rights 2016 OS EUL 100017428
You are not permitted to copy, sub-licence, distribute or sell any of this data to third parties in any form.
You are permitted to use this data solely to enable you to respond to, or interact with, the organisation that provided you with the data.

This is the plan referred to under the Article 4(1)
Direction made by Hertsmere Borough Council

thisday of... April.....2019

By the Affixing of its Common Seal
to this Direction in the presence of

.....
Duly Authorised Officer

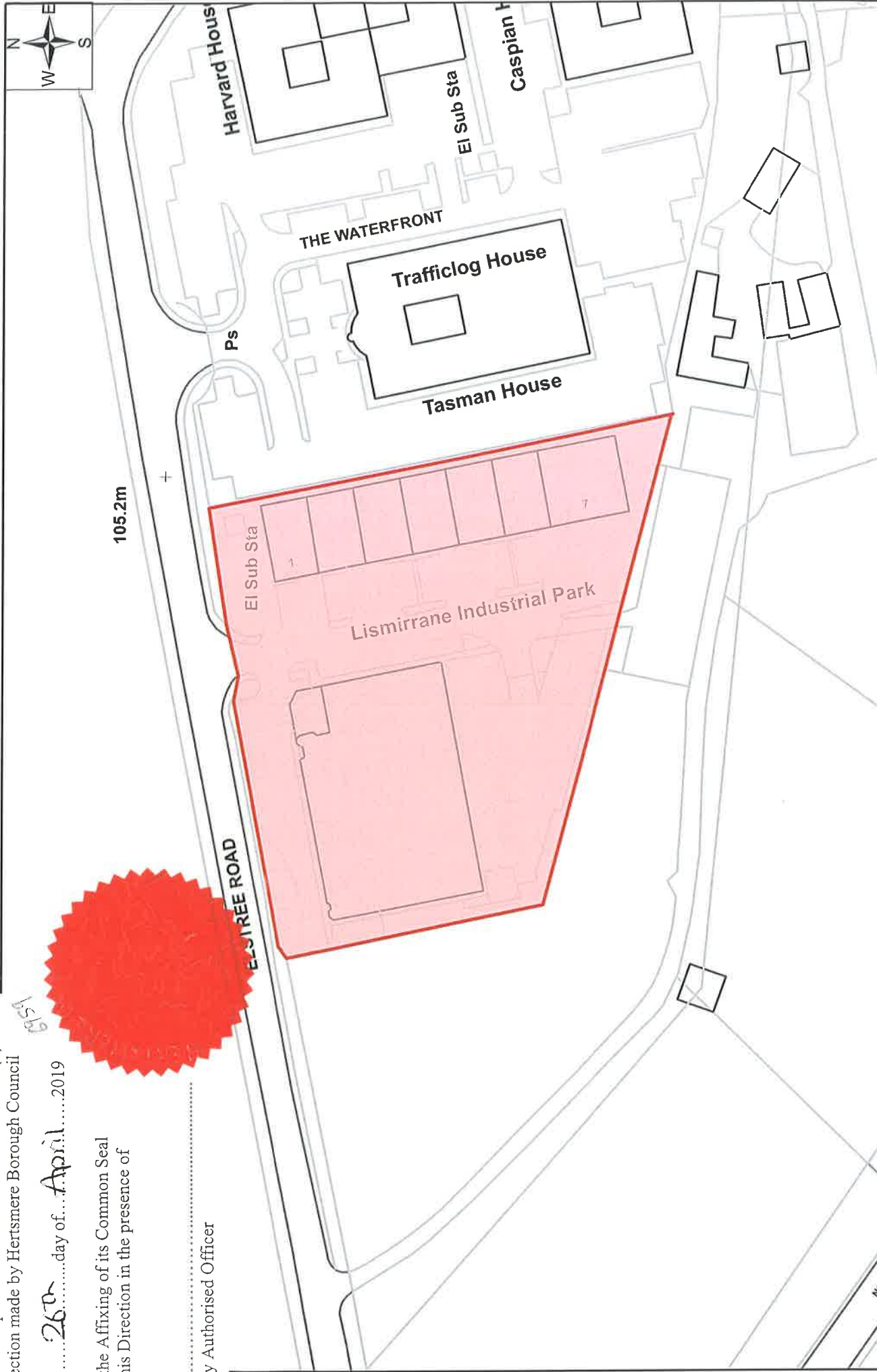

Legend



Area to which Article 4 direction applies

Hertsmere Borough Council Boundary

Lismirrane Industrial Park



1:1,250

© Crown copyright and database rights 2016 OS EUL 100017428
You are not permitted to copy, sub-licence, distribute or sell any of this data to third parties in any form.
You are permitted to use this data solely to enable you to respond to, or interact with, the organisation that provided you with the data.

This is the plan referred to under the Article 4(1) Direction made by Hertsmere Borough Council

thisday of...*April*.....2019 *6⁵⁹*

By the Affixing of its Common Seal to this Direction in the presence of

Duly Authorised Officer

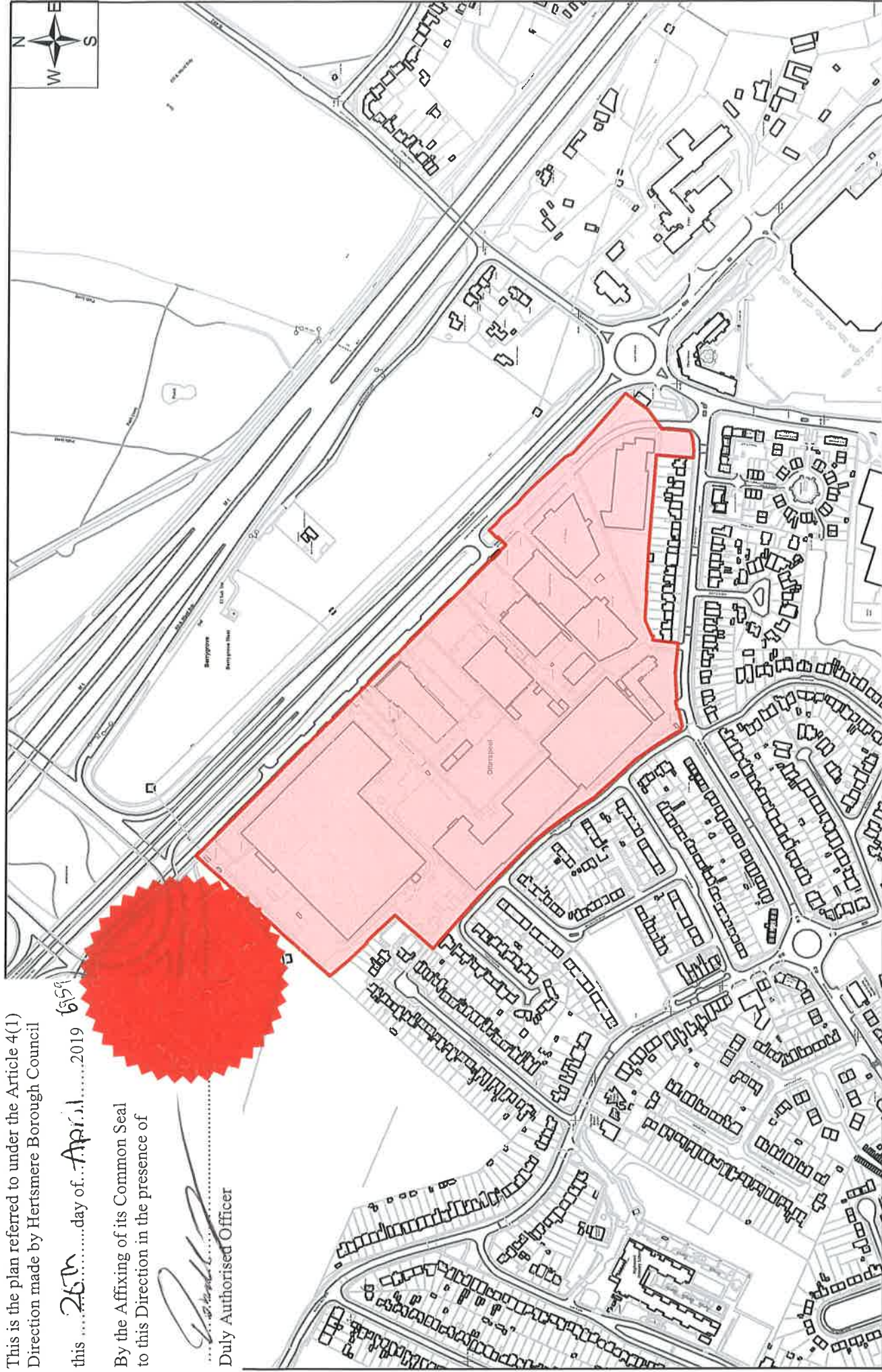
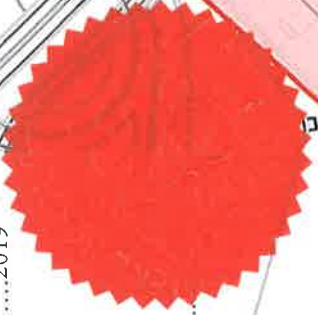

Legend



Area to which Article 4 direction applies
Hertsmere Borough Council Boundary

Otterspool way

0 0.032 0.065 0.13 0.195 0.26 1:5,000 Miles

