

TOWN AND COUNTRY PLANNING (TREES) REGULATIONS 1999

Plan referred to in THE HERTSMERE TREE PRESERVATION ORDER (Bayshill Cottage, Bayshill House and Scratchwood House, Barnet Lane, Elstree, Herts) No 39/2007

This Order was confirmed by the
Hertsmere Borough Council
without modification
on the TWENTY NINTH day
of AUGUST in the year 2007

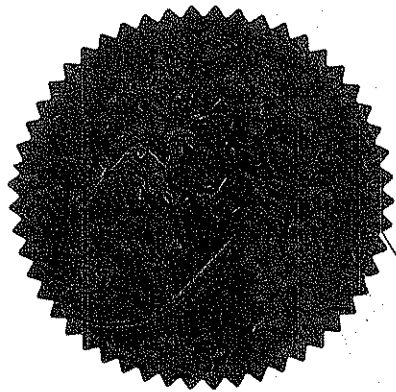

THE COMMON SEAL OF HERTSMERE BOROUGH COUNCIL
WAS HEREUNTO AFFIXED THIS Twenty Seventh day of June
2007

IN THE PRESENCE OF: .

(Signed) Interim Head of Legal Services

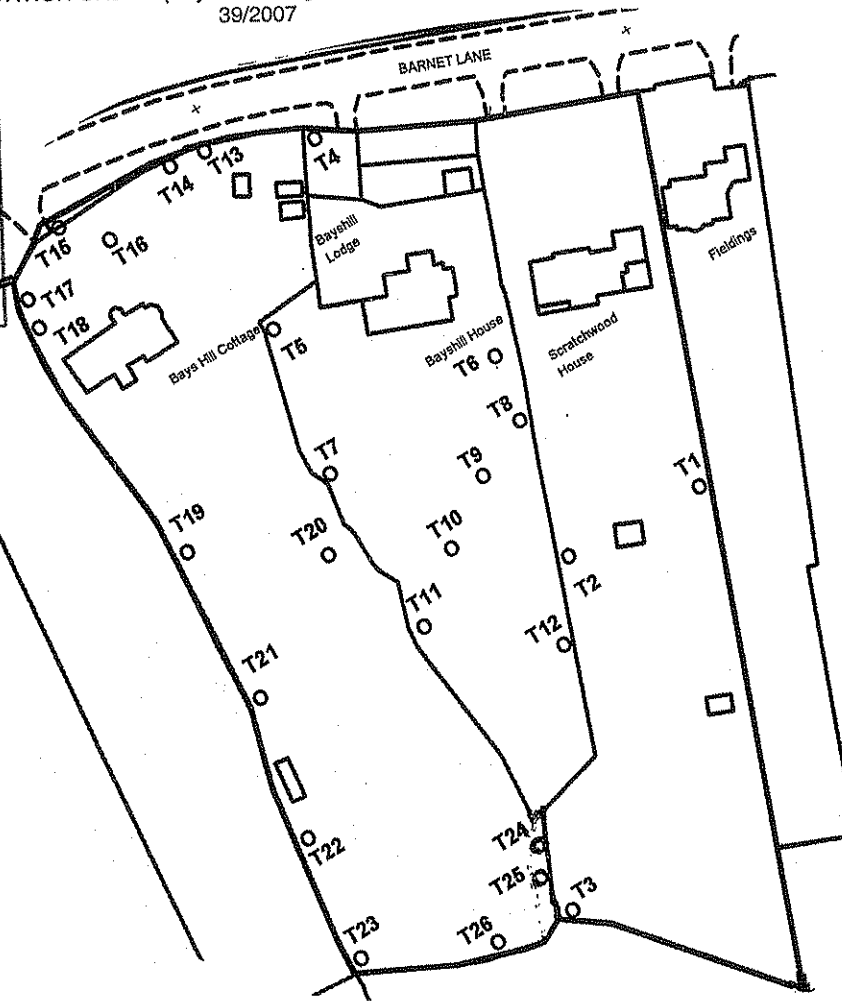

SCHEDULE OF TREES

No	Type
T1	Ash
T2	Ash
T3	Oak
T4	Yew
T5	Ash
T6	Tulip Tree
T7	Horse Chestnut
T8	Oak
T9	Silver Birch
T10	Willow
T11	Oak
T12	Ash
T13	Oak
T14	Oak
T15	Oak
T16	Oak
T17	Oak
T18	Ash
T19	Oak
T20	Cherry
T21	Oak
T22	Oak
T23	Oak
T24	Ash
T25	Ash
T26	Ash

Map Ref: TQ 2019,9541

Hertsmere Borough Council
Civic Offices
Borehamwood
Herts WD6 1WA

SCALE: 1:1250 DATE: 27/06/2007

DRAWN BY: SW CHECKED MS

DRAWING NUMBER: 39/2007

Reproduced from the Ordnance Survey mapping with the permission of the Controller of Her Majesty's Stationary Office.
© Crown Copyright reserved. Unauthorised reproduction infringes Crown copyright and may lead to prosecution or civil proceedings.
Licence Number LA078239 Hertsmere. 2001.