

TOWN AND COUNTRY PLANNING (TREES) REGULATIONS 1999

Plan referred to in THE HERTSMERE TREE PRESERVATION ORDER (Land between 29 and 39 Prowse Avenue, Bushey Heath, Bushey, Herts) No 22/2007

SCHEDULE OF TR

No	Type
W1	All trees w area mark

This Order was confirmed by t
Hertsmere Borough Council
without modification
on the THIED da
of JULY in the ye

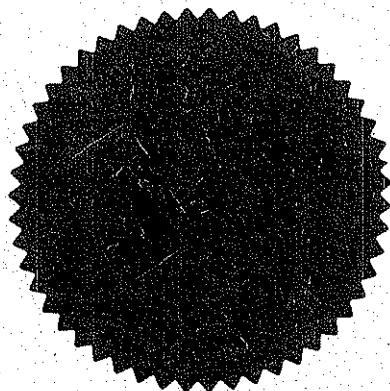
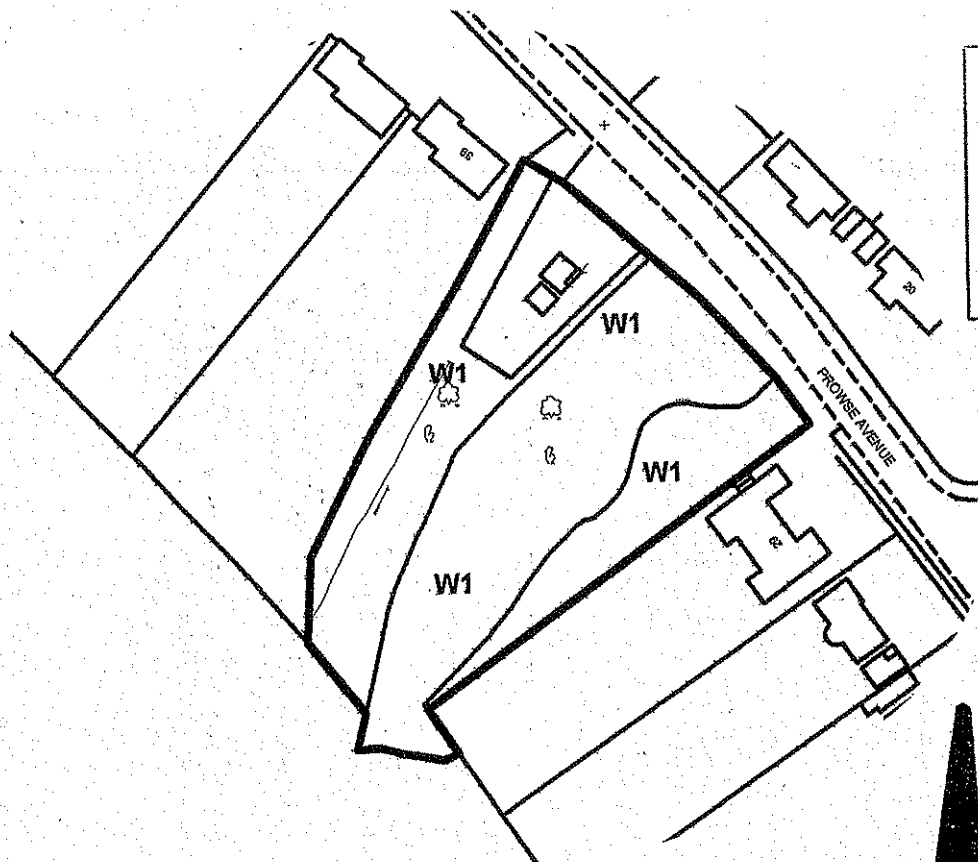

THE COMMON SEAL OF HERTSMERE BOROUGH COUNCIL
WAS HEREUNTO AFFIXED THIS Thirtieth day of April 2007

IN THE PRESENCE OF:

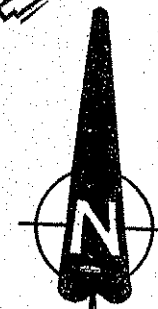

Map Ref: TQ 1422,938

Hertsmere Borough
Civic Office
Borehamwo
Herts WD6 1

SCALE: 1:1250