

TOWN AND COUNTRY PLANNING (TREES) REGULATIONS 1999

Plan referred to in THE HERTSMERE TREE PRESERVATION ORDER (Newberries JMI School, 46, 58, 64, 66, 68 & 72 Newberries Avenue and 23, 47 & 49 Craigweil Avenue, Radlett, Herts) No 10/2006

This Order was confirmed by the Hertsmere Borough Council without modification on the 21st day of September in the year 2006

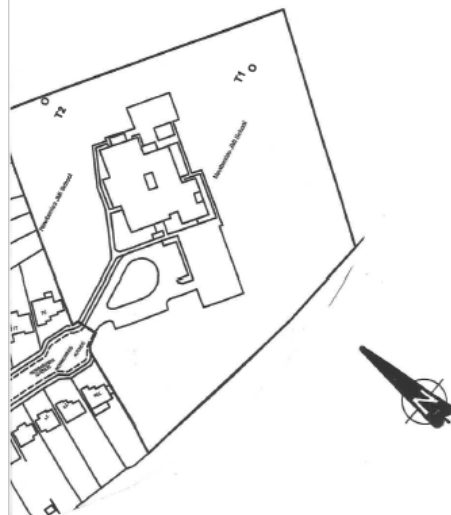

THE COMMON SEAL OF HERTSMERE BOROUGH COUNCIL WAS
HEREUNTO AFFIXED THIS Twenty Second day of March 2006

IN THE PRESENCE OF:

[Signature]

(Signed) Authorised Officer



Reproduced from the Ordnance Survey mapping with the permission of the Controller of Her Majesty's Stationery Office. Production infringes Crown copyright and may lead to prosecution or civil proceedings. Licence Number LA078239 Hertsmere, 2001.

SCHEDULE OF TREES

No	Type
T1	Oak
T2	Horse Chestnut
T3	Oak
T4	Silver Birch
T5	Atlantic Cedar
T6	Lime
T7	Scots Pine
T8	Scots Pine
T9	Scots Pine
T10	Scots Pine
T11	Scots Pine
T12	Monkey Puzzle
T13	Cedar of Lebanon
T14	Cedar of Lebanon
T15	Cedar of Lebanon
T16	Scots Pine
T17	Purple Beech
G1	1 no. Purple Beech, 1 no. Scots Pine, 1 no. Tulip Tree
G2	3 no. Silver Birch

Map Ref: TQ 1702,9972

Hertsmere Borough Council
Civic Offices
Borehamwood
Herts WD6 1WA

SCALE: 1:1250 DATE: 22/03/2006

DRAWN BY: SW CHECKED: MS

DRAWING NUMBER: 10/2006