

TOWN AND COUNTRY PLANNING ACT 1990

Plan referred to in
THE HERTSMERE BOROUGH COUNCIL
(20A ALEXANDRA ROAD, WELL END, BOREHAMWOOD, HERTS)
TREE PRESERVATION ORDER No. 400./ 1998..

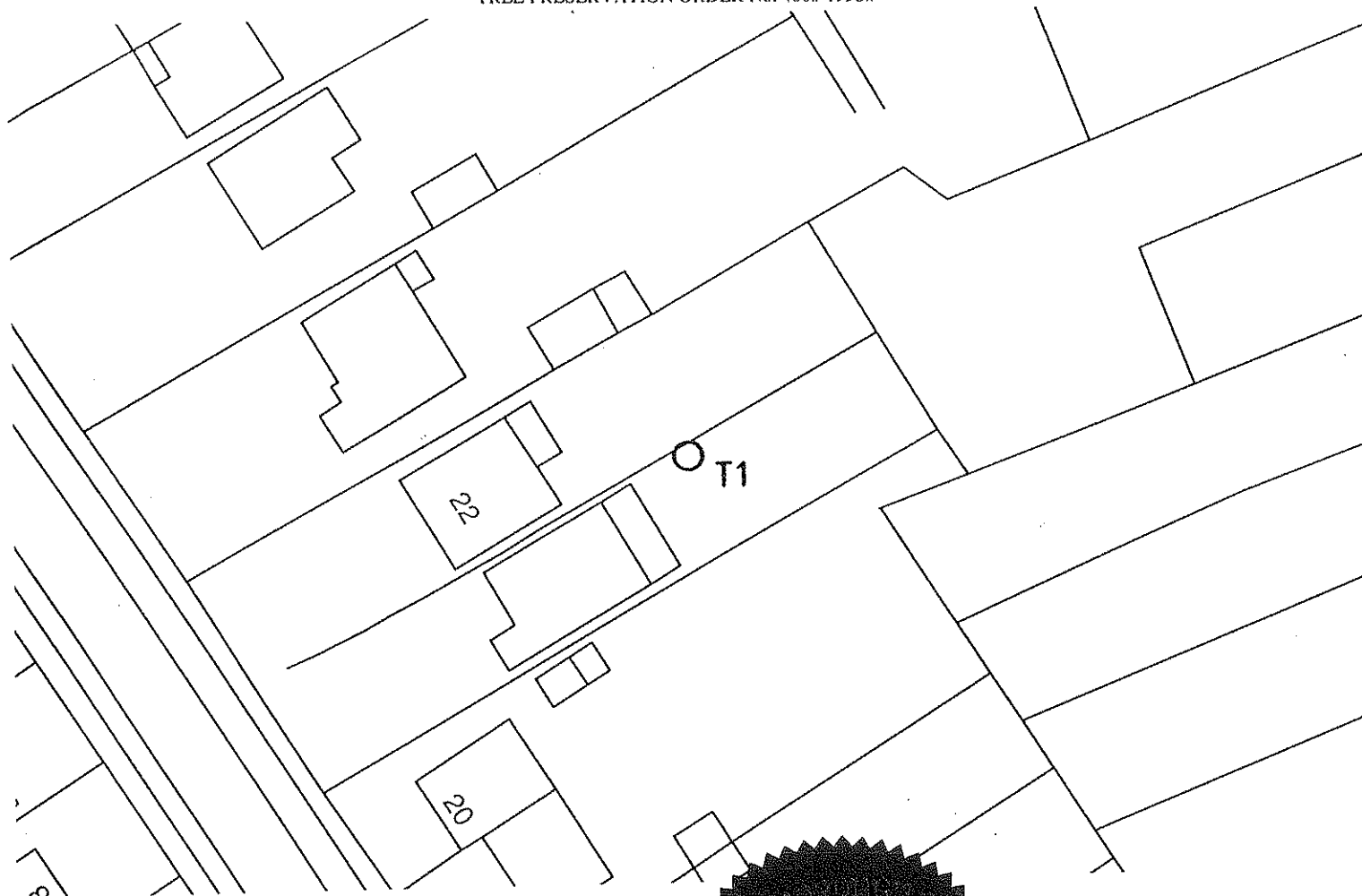

THE COMMON SEAL OF HERTSMERE BOROUGH COUNCIL
WAS HEREUNTO AFFIXED THIS.. TWENTY FIRST ..DAY OF
JANUARY...1998... IN THE PRESENCE OF :

X *P.H. Copland*
(Signed) P.H. COPLAND CHIEF EXECUTIVE

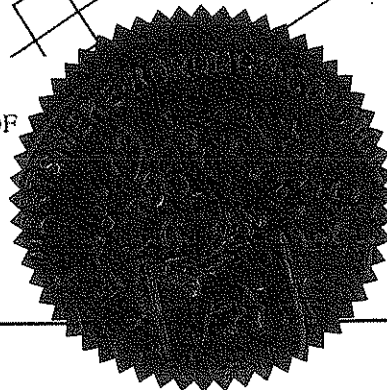

Reproduced from the Ordnance Survey map with the permission of the
Controller of Her Majesty's Stationary Office.
Crown Copyright reserved.

SCHEDULE OF TREES

No	TYPE
T1	Wellingtonia

Map Ref. TQ 2066 9791

HERTSMERE
BOROUGH COUNCIL
Civic Offices
Borehamwood
Herts WD6 1WA

SCALE 1: 500	DATE 21/1/98
DRAWN P.J.T	CHECKED
DRAWING No	TP 719