

TOWN AND COUNTRY PLANNING ACT 1990

Plan referred to in
 THE HERTSMERE BOROUGH COUNCIL
 (Land At Robeson Way, Milland Court and Novello Way, Borehamwood, Herts.)
 TREE PRESERVATION ORDER No. 325./1996.

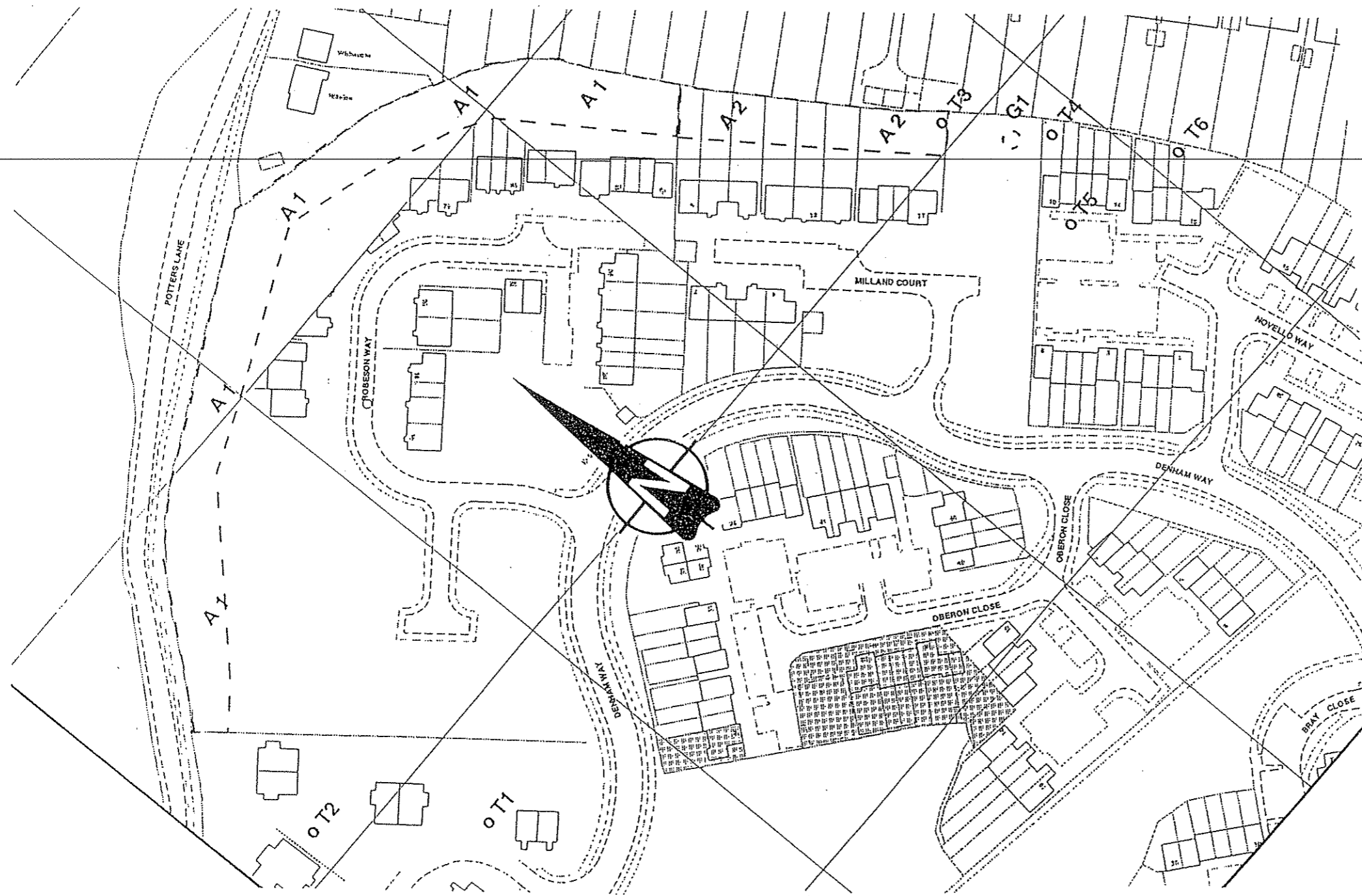

SCHEDULE OF TREES

| No | TYPE |
|----|--|
| T1 | Oak |
| T2 | Oak |
| T3 | Oak |
| T4 | Poplar |
| T5 | Oak |
| T6 | Oak |
| G1 | 2 x Poplar |
| A1 | Consists of 41 Poplar, 18 Willow 13 Silver Birch and 6 Oak |
| A2 | Consists of 11 Poplar, 13 Willow and 1 Oak |

Map Ref. TQ 204 979

HERTSMERE
 BOROUGH COUNCIL
 Civic Offices
 Borehamwood
 Herts WD6 1WA

THE COMMON SEAL OF HERTSMERE BOROUGH COUNCIL
 WAS HEREUNTO AFFIXED THIS TWELFTH ..DAY OF
 JANUARY....1996... IN THE PRESENCE OF :

(Signed)

MANAGING DIRECTOR

SCALE 1:1250 DATE 13/12/95

DRAWN P.J.B CHECKED

DRAWING No

TP 644