

TOWN AND COUNTRY PLANNING ACT 1990

Plan referred to in
THE HERTSMERE BOROUGH COUNCIL
(5 Sellers Close, Borehamwood, Herts.)
TREE PRESERVATION ORDER No. 320./1995..

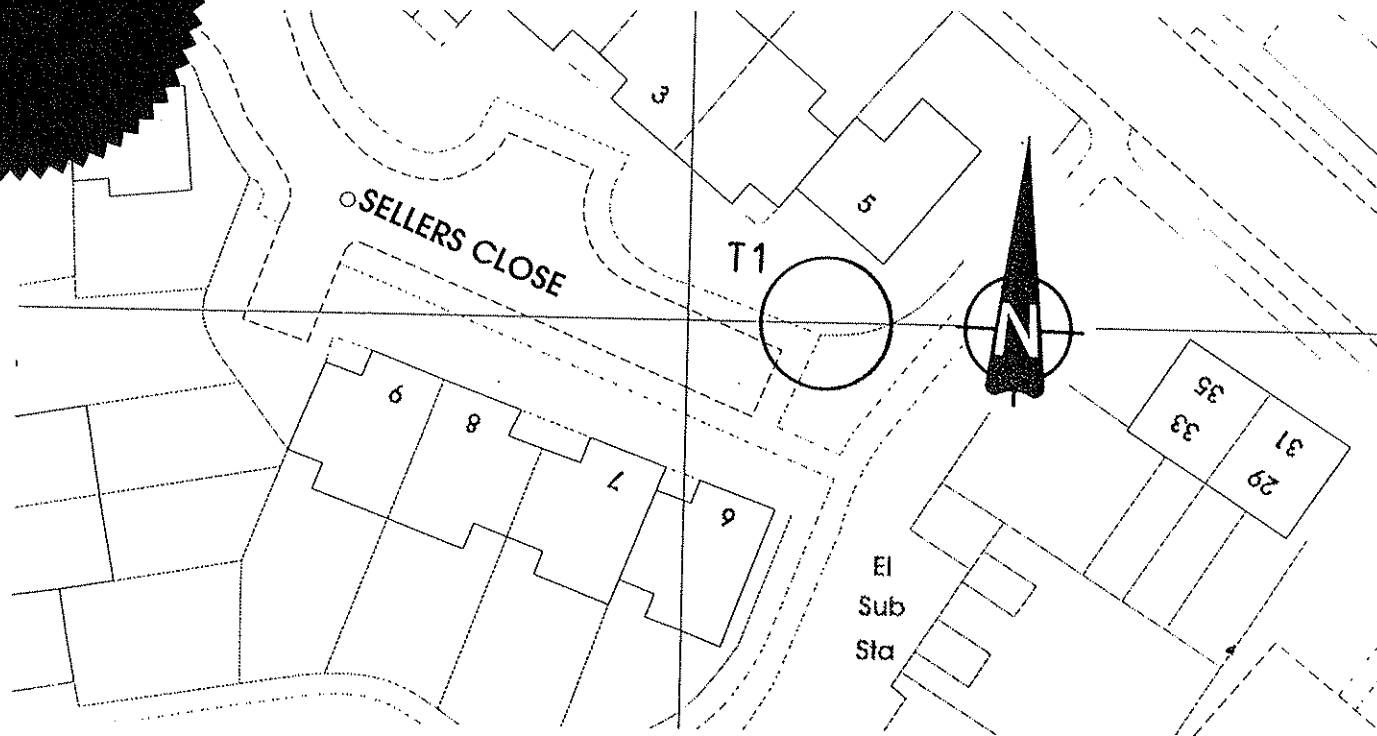

SCHEDULE OF TREES

No	TYPE
T1	Oak

Map Ref. TQ 204 975

HERTSMERE
BOROUGH COUNCIL
Civic Offices
Borehamwood
Herts WD6 1WA

THE COMMON SEAL OF HERTSMERE BOROUGH COUNCIL
WAS HEREUNTO AFFIXED THIS. THIRD DAY OF NOVEMBER
....1995.... IN THE PRESENCE OF :

[Signature]
MANAGING DIRECTOR

(Signed)

Reproduced from the Ordnance Survey map with the permission of the
Controller of Her Majesty's Stationary Office.
Crown Copyright reserved.

SCALE 1: 500	DATE 25/10/95.
DRAWN P.J.B	CHECKED
DRAWING No	TP 639