

**TOWN AND COUNTRY PLANNING ACT 1990**

Plan referred to in  
**THE HERTSMERE BOROUGH COUNCIL**  
 ( 39 Barham Avenue, Elstree )  
**TREE PRESERVATION ORDER No.../1995..**

**SCHEDULE OF TREES**

No	TYPE
T1	Silver Birch
T2	Hornbeam
T3	Cypress
T4	Norway Spruce

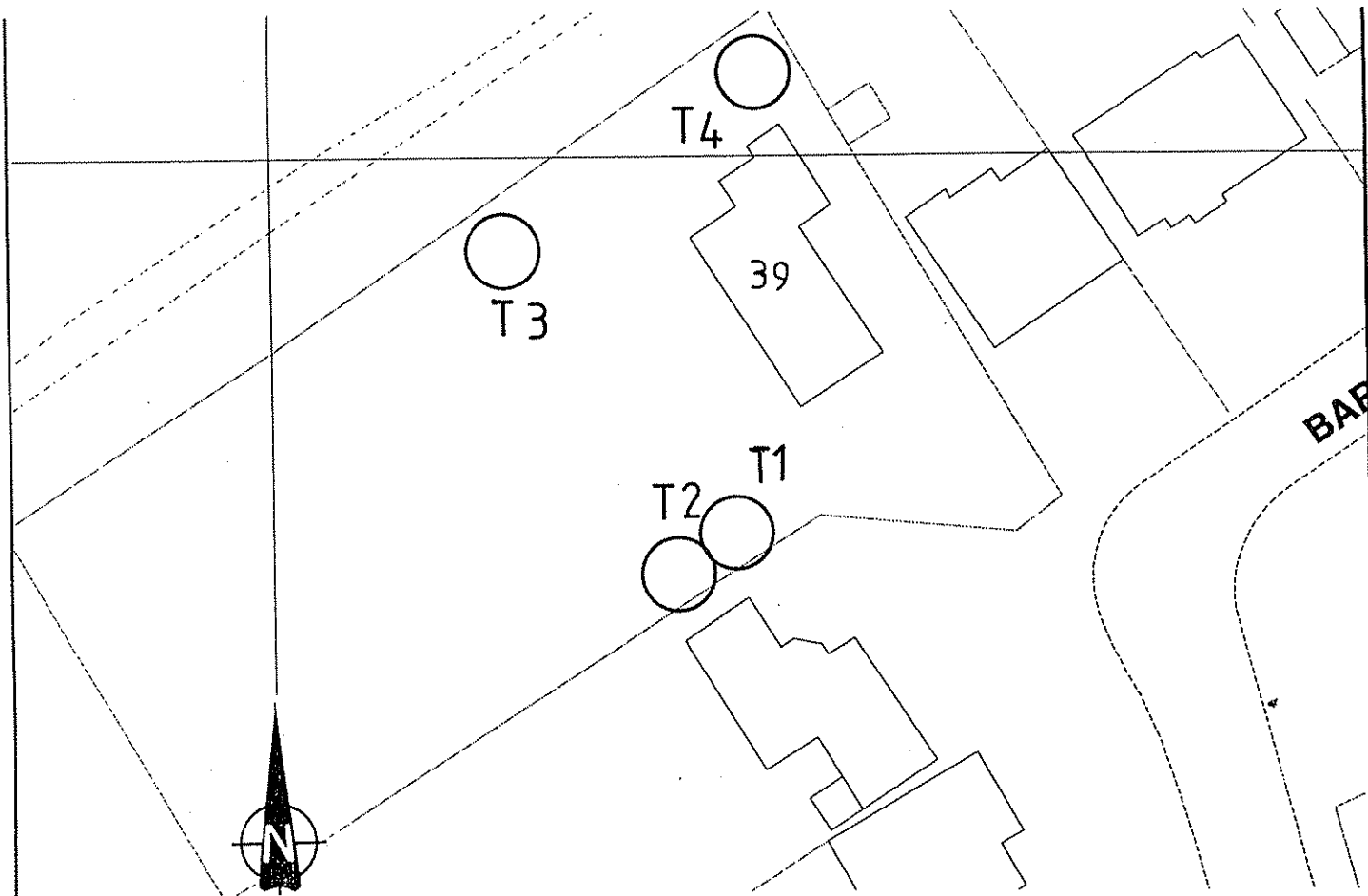

Map Ref. TQ 1852 9657

**HERTSMERE  
 BOROUGH COUNCIL**  
 Civic Offices  
 Borehamwood  
 Herts WD6 1WA

THE COMMON SEAL OF HERTSMERE BOROUGH COUNCIL  
 WAS HEREUNTO AFFIXED THIS..TENTH..DAY OF  
 MARCH...1995... IN THE PRESENCE OF :

*[Handwritten Signature]*

**MANAGING DIRECTOR**

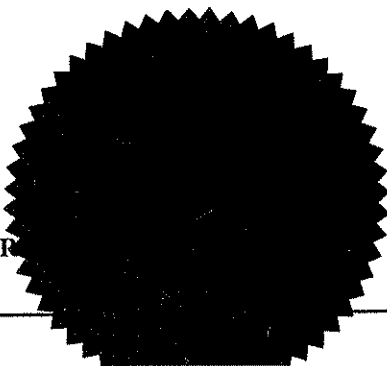

(Signed)

SCALE 1: 500	DATE 7/3/95
DRAWN P.J.B	CHECKED

DRAWING No  
 TP 626

Reproduced from the Ordnance Survey map with the permission of the  
 Controller of Her Majesty's Stationery Office.  
 Crown Copyright reserved.