

TOWN AND COUNTRY PLANNING ACT 1990

Plan referred to in
THE HERTSMERE BOROUGH COUNCIL
(29, Wellesley Crescent.)
TREE PRESERVATION ORDER No.304./1995.

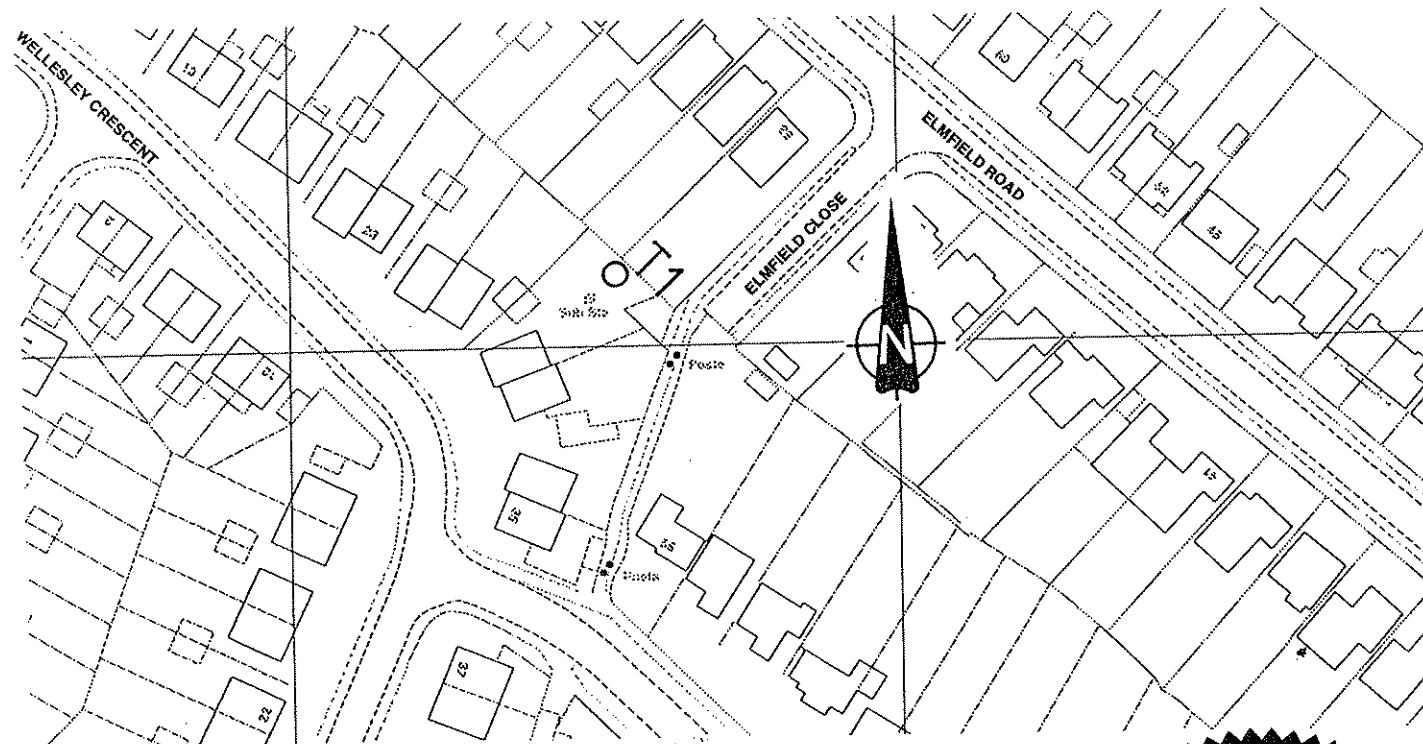

THE COMMON SEAL OF HERTSMERE BOROUGH COUNCIL
WAS HEREUNTO AFFIXED THIS..SEVENTEENTH .DAY OF FEBRUARY
....1995.... IN THE PRESENCE OF :

[Signature]
MANAGING DIRECTOR

(Signed)

SCHEDULE OF TREES

No	TYPE
T 1	Oak

Map Ref. TL 0094 2434

HERTSMERE
BOROUGH COUNCIL
Civic Offices
Borehamwood
Herts WD6 1WA

SCALE 1: 1250	DATE 10/2/95
DRAWN P,J,B.	CHECKED
DRAWING No	TP 624

Reproduced from the Ordnance Survey map with the permission of the
Controller of Her Majesty's Stationery Office.
Crown Copyright reserved.