

TOWN AND COUNTRY PLANNING ACTS 1971-1974

Plan referred to in
THE HERTSMERE BOROUGH COUNCIL
 (1 CARRINGTON AVENUE, BOREHAMWOOD.)
TREE PRESERVATION ORDER No. 201/1989

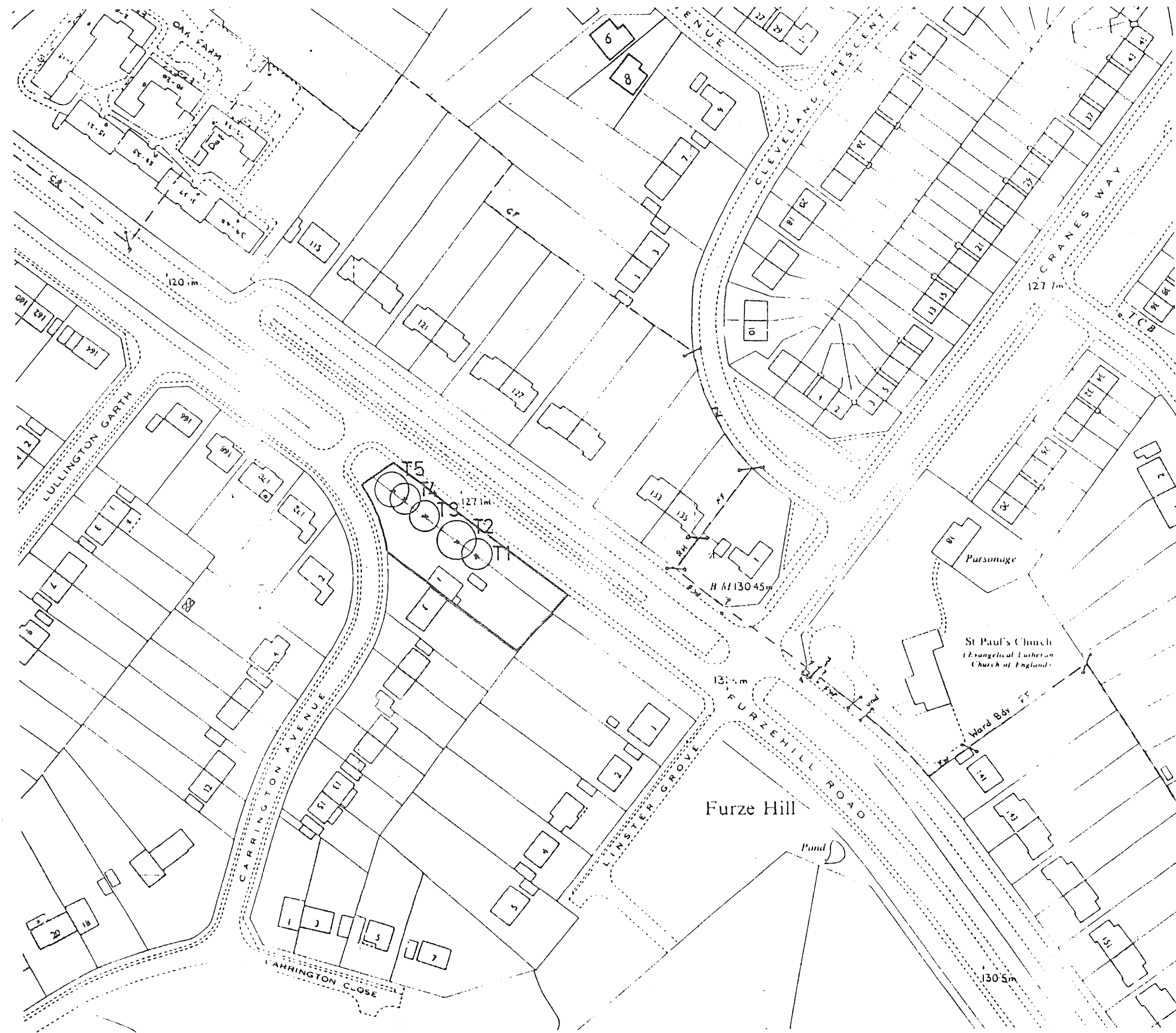

SCHEDULE OF TREES

No.	TYPE
T1	OAK
T2	"
T3	"
T4	"
T5	ASH

THE COMMON SEAL OF HERTSMERE BOROUGH COUNCIL
 WAS HEREUNTO AFFIXED THIS EIGHTEENTH DAY OF
 JULY 1989 IN THE PRESENCE OF:

MAYOR

SOLICITOR

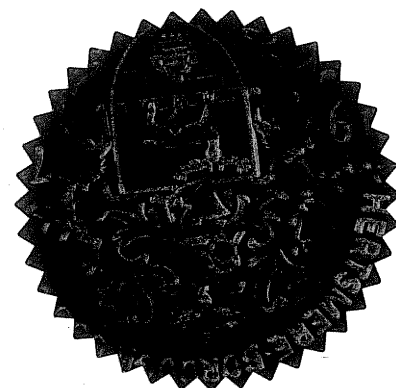

HERTSMERE
 BOROUGH COUNCIL
 Civic Offices
 Elstree Way
 Borehamwood
 Herts WD6 1WA

SCALE	1: 1250	DATE	17/7/89
DRAWN	S.D.M	CHECKED	G.J
DRAWING No.		TP 517	

Reproduced from the Ordnance Survey map with the permission of the Controller of Her Majesty's Stationery Office. Crown Copyright reserved.