

TOWN AND COUNTRY PLANNING ACTS 1971-1974

Plan referred to in

THE HERTSMERE BOROUGH COUNCIL

(THE SPINNEY, LETCHMORE HEATH.)

TREE PRESERVATION ORDER No. 196/1989

SCHEDULE OF TREES

No.	TYPE
T1	ASH
T2	MAPLE
T3	"
T4	HORSE CHESTNUT
T5	S. WHITEBEAM
T6	GREY POPLAR
T7	" "
T8	" "

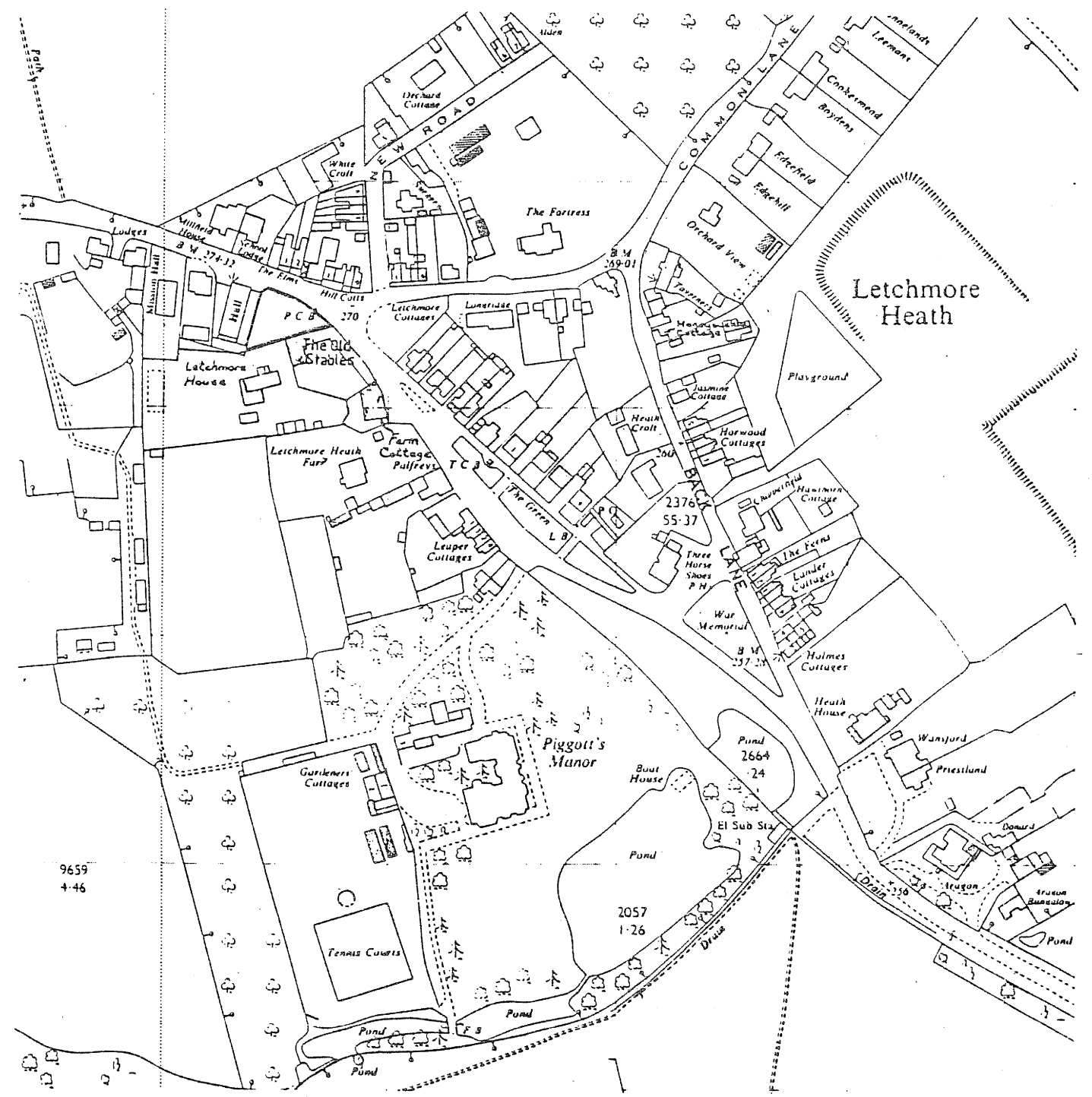

SCALE 1 : 2500

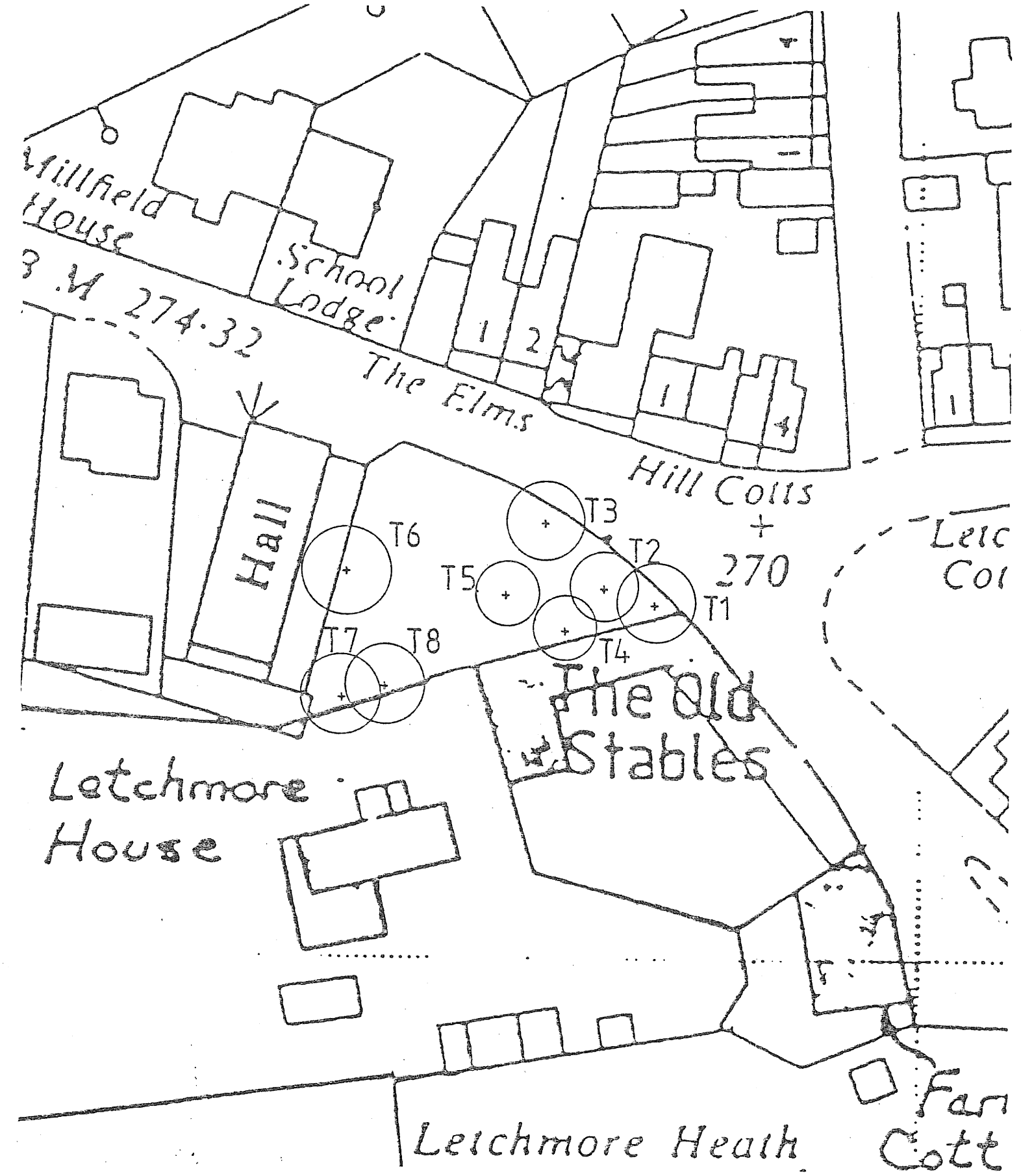

THE COMMON SEAL OF HERTSMERE BOROUGH COUNCIL
 WAS HEREUNTO AFFIXED THIS ELEVENTH DAY OF
 JULY 1989 IN THE PRESENCE OF:

MAYOR

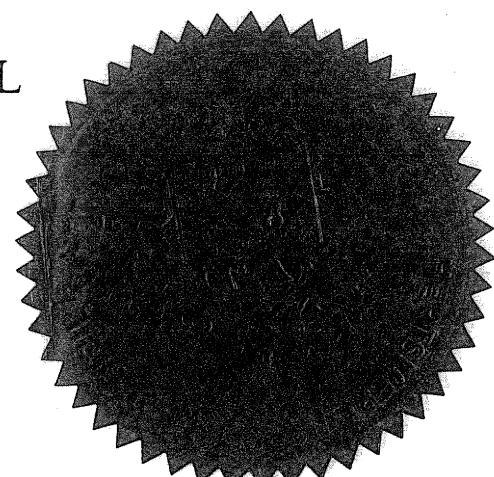

HERTSMERE
 BOROUGH COUNCIL
 Civic Offices
 Elstree Way
 Borehamwood
 Herts WD6 1WA

SCALE	1 : 500	DATE	10/7/89
DRAWN	S.D.M.	CHECKED	B.R.A.
DRAWING No.	TP514		

Reproduced from the Ordnance Survey map with the permission of the Controller of Her Majesty's Stationery Office. Crown Copyright reserved.