

TREE PRESERVATION ORDER No. 1

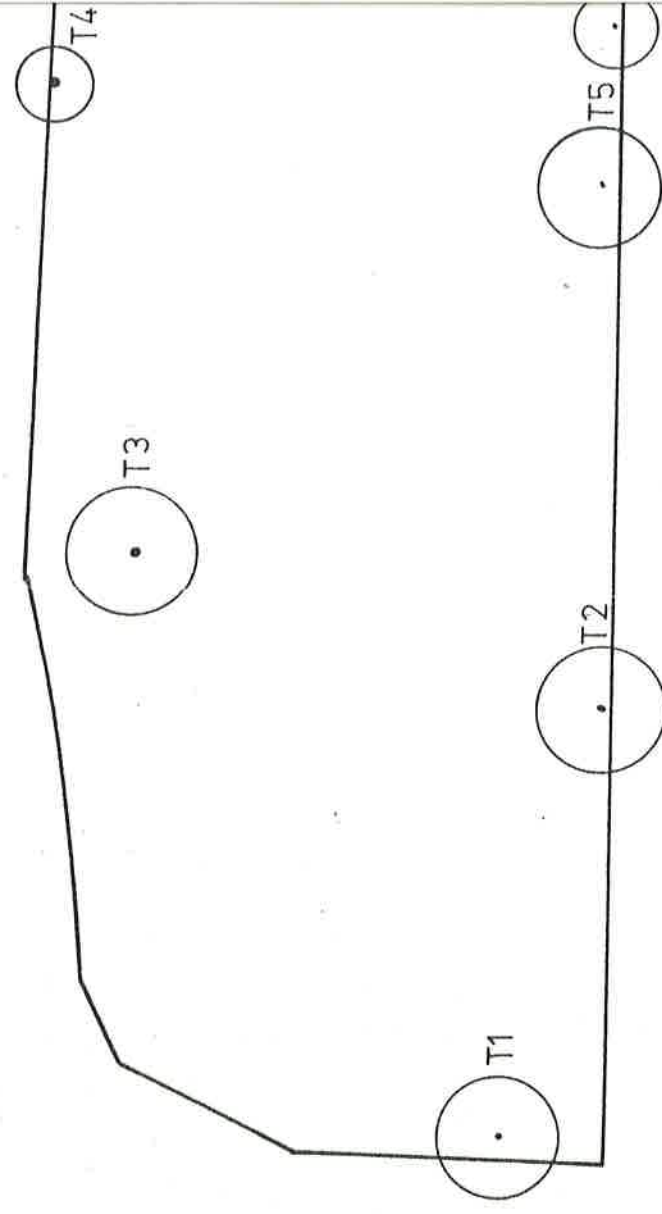

The HERTSMERE BOROUGH COUNCIL, in exercise of the within written powers conferred upon it in that behalf, hereby confirms the Order subject to the amendments shown in red.

In witness whereof the Common Seal of the Council was hereunto affixed this fifteenth day of JUNE 1988 in the presence of

(Mayor) *John Allcorn*
 (Solicitor) *P. Dennis*



COMMON SEAL OF HERTSMERE BOROUGH COUNCIL
 HEREUNTO AFFIXED THIS ELEVENTH DAY OF

CH 1988 IN THE PRESENCE OF:

John O. Lewis MAYOR
P. Dennis SOLICITOR



CTS 1971-1974

COUNCIL

(T.

/1988

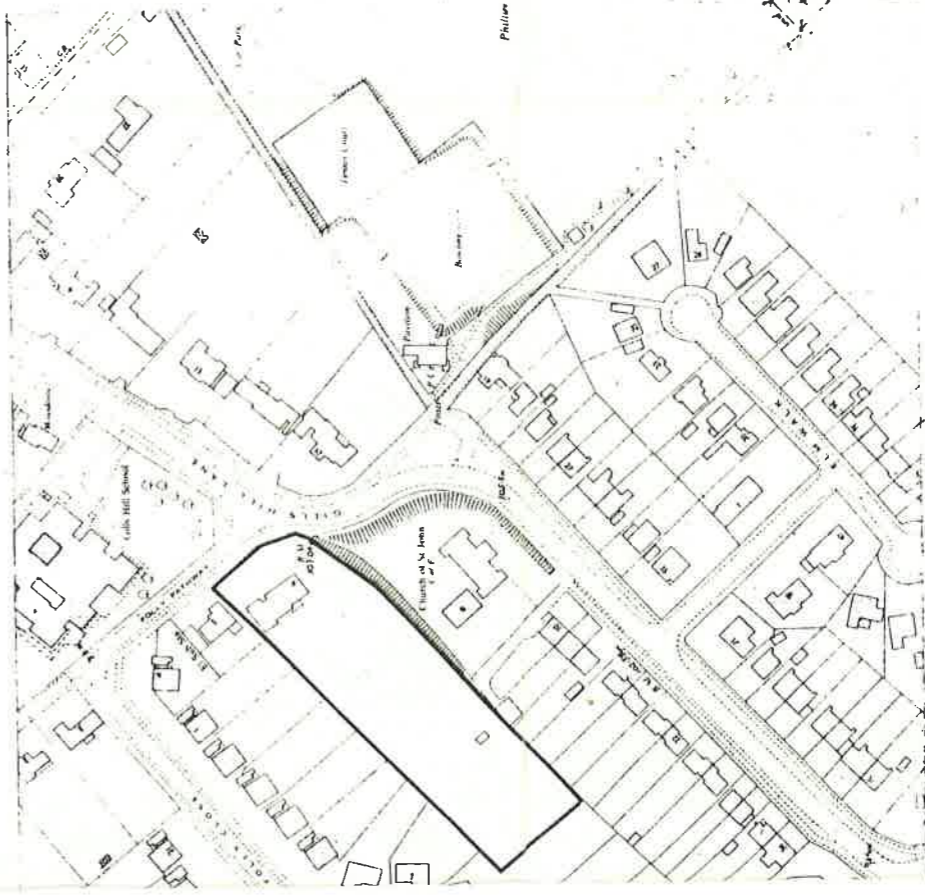
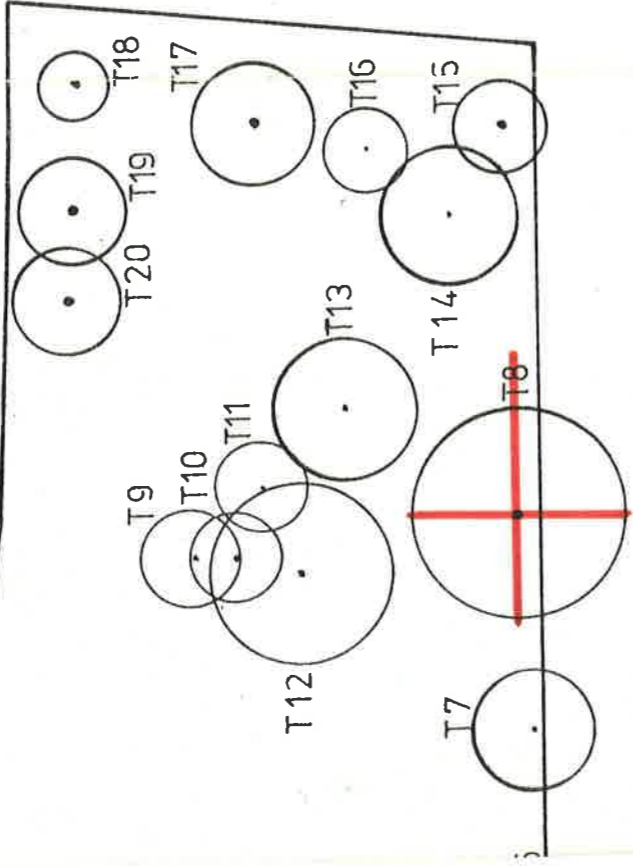

SCHEDULE OF TREES

No.	TYPE
T1	OAK
T2	LIME
T3	BEECH
T4	CEDAR
T5	WALNUT
T6	YEWE
T7	ASH
T8	BIRCH
T9	YEWE
T10	SPRUCE
T11	SPRUCE
T12	BIRCH
T13	OAK
T14	FIR
T15	SCOTS PINE
T16	SCOTS PINE
T17	SCOTS PINE
T18	CEDAR
T19	PINE
T20	PINE

HERTSMERE
BOROUGH COUNCIL
Civic Offices
Elstree Way
Borehamwood
Herts WD6 1WA

SCALE 1:500 DATE 9:3:88

DRAWN S.D.M CHECKED A.M.C.

DRAWING No. TP454