

TOWN AND COUNTRY PLANNING ACTS 1971-1974

Plan referred to in

THE HERTSMERE BOROUGH COUNCIL
(65/75 HATFIELD ROAD, POTTERS BAR.)

TREE PRESERVATION ORDER No. 149 /19 88

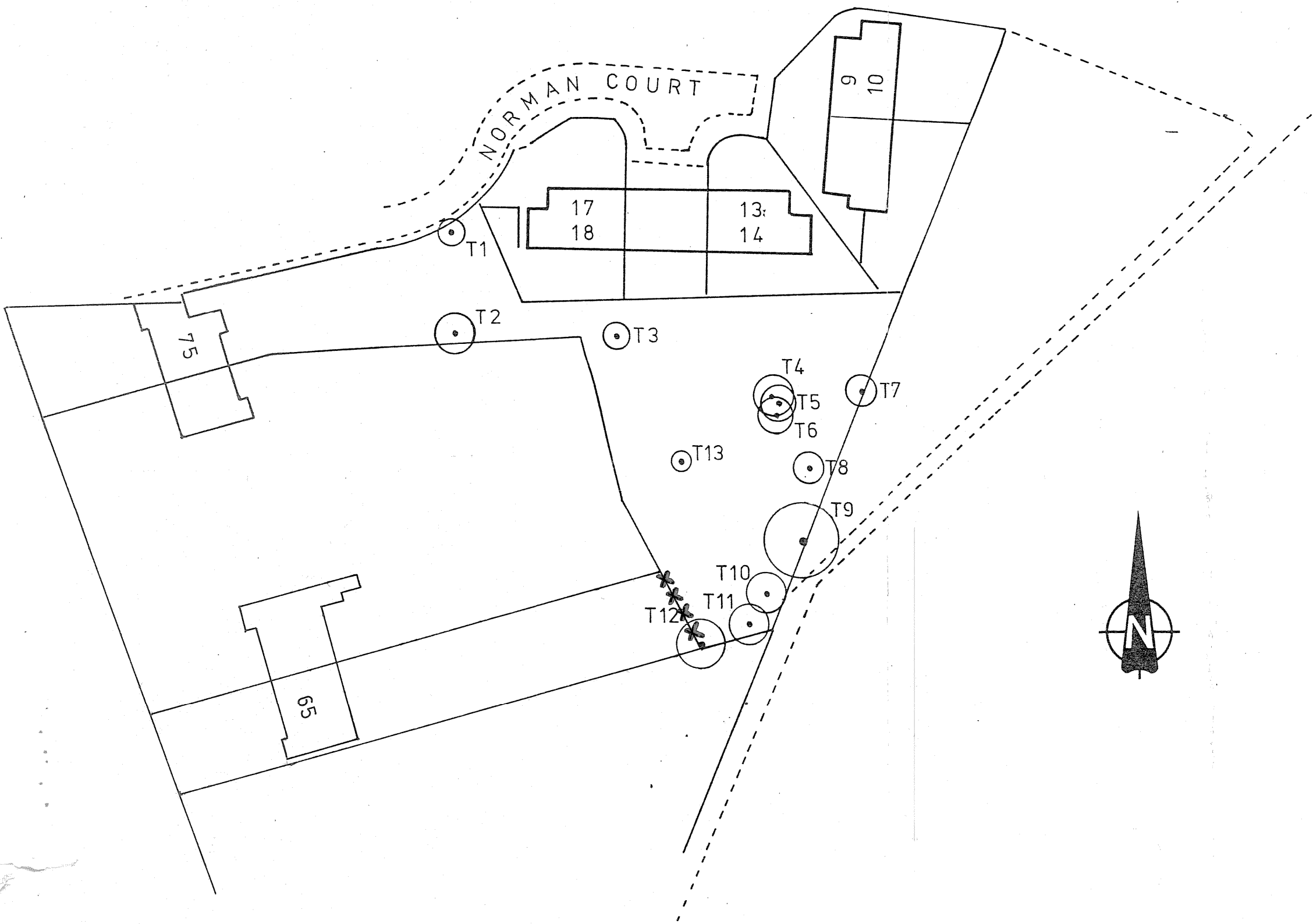

SCALE 1:1250

The HERTSMERE BOROUGH COUNCIL, in exercise of the within written powers conferred upon it in that behalf, hereby confirms the Order subject to the amendments to the Map shown in red.

In witness whereof the Common Seal of the Council was hereunto affixed this fifteenth day of JUNE 1988 in the presence of

(Mayor)

(Solicitor)

THE COMMON SEAL OF HERTSMERE BOROUGH COUNCIL
WAS HEREUNTO AFFIXED THIS NINETEENTH DAY OF
FEBRUARY 1988 IN THE PRESENCE OF:

John G. King MAYOR
John G. King SOLICITOR

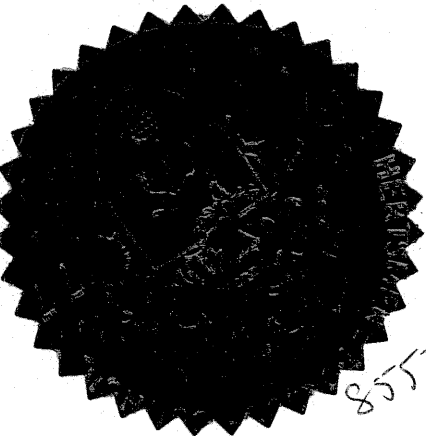
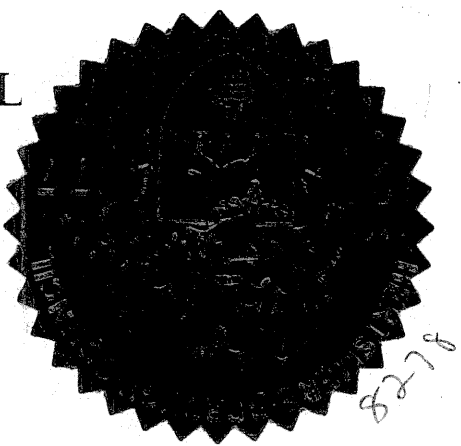

SCHEDULE OF TREES

No.	TYPE
T1	Birch
T2	Cherry
T3	Holly
T4	Sycamore
T5	Sycamore
T6	Sycamore
T7	Ash
T8	Birch
T9	Ash
T10	Lime
T11	Lime
T12	Oak
T13	Beech

HERTSMERE
BOROUGH COUNCIL
Civic Offices
Elstree Way
Borehamwood
Herts WD6 1WA

SCALE 1:500	DATE 17/2/88
DRAWN S.D.M	CHECKED D.J.B
DRAWING No.	TP453

Reproduced from the Ordnance Survey map with the permission of the Controller of Her Majesty's Stationery Office. Crown Copyright reserved.