

TOWN AND COUNTRY PLANNING ACTS 1971-1974

Plan referred to in

THE HERTSMERE BOROUGH COUNCIL
(45, COLDHARBOUR LANE, BUSHEY)

TREE PRESERVATION ORDER No. 136 /1987

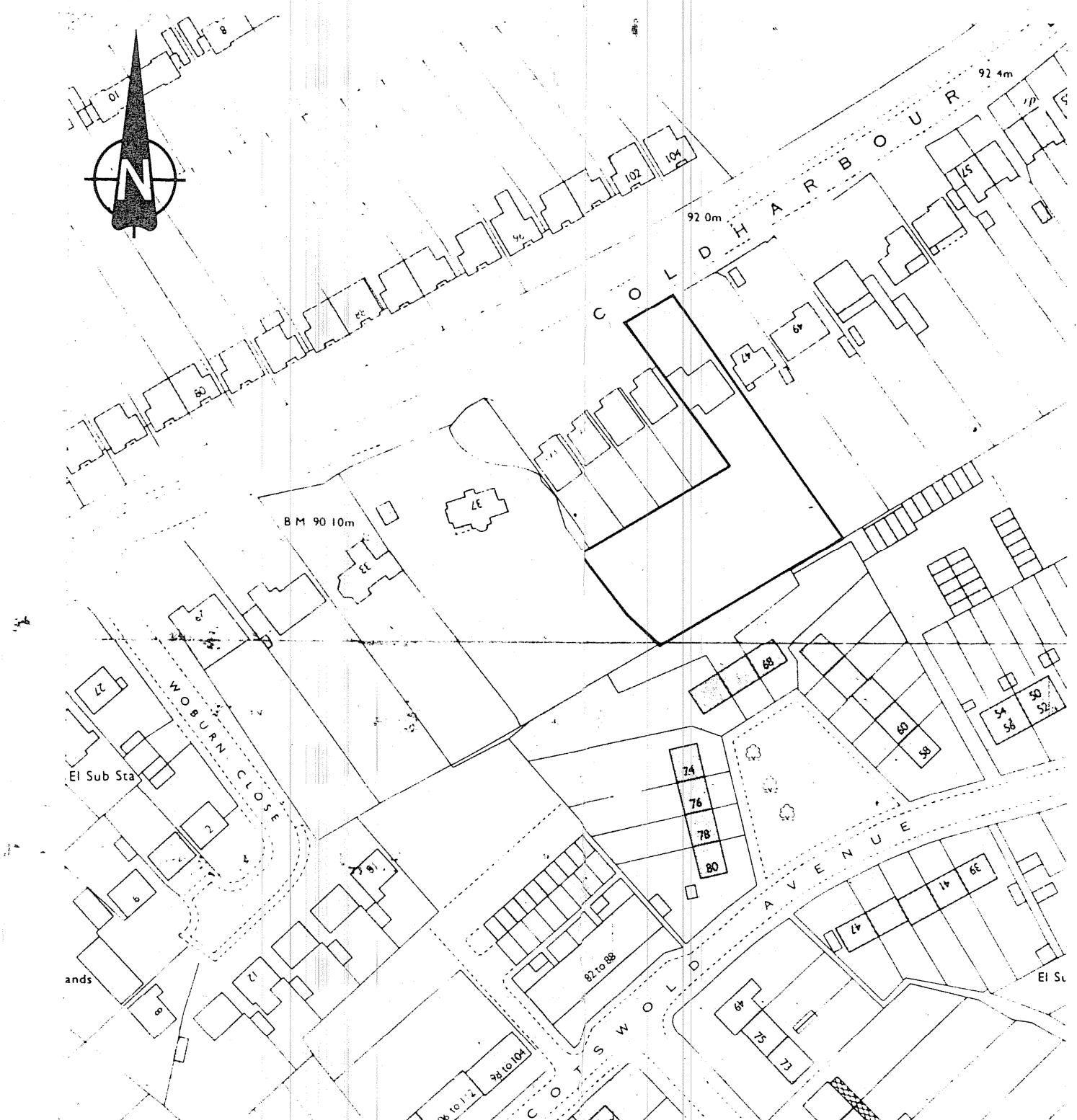
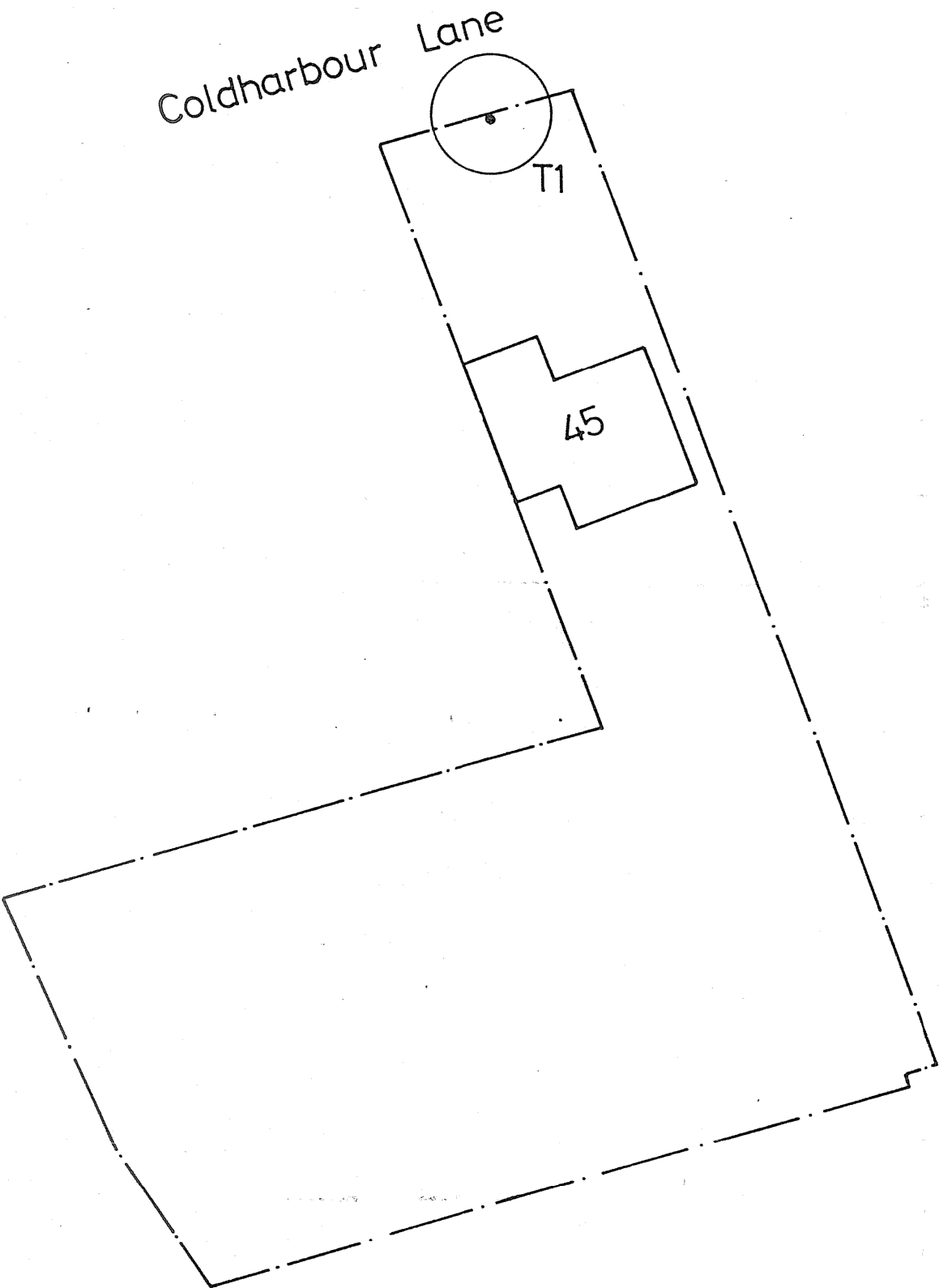

SCHEDULE OF TREES

No.	TYPE
T1	Horse Chestnut

THE COMMON SEAL OF HERTSMERE BOROUGH COUNCIL
IS HEREUNTO AFFIXED THIS FIRST DAY OF
SEPTEMBER 1987 IN THE PRESENCE OF:

DEPUTY MAYOR

BOROUGH SECRETARY

The HERTSMERE BOROUGH COUNCIL, in exercise of the within
written powers conferred upon it in that behalf, hereby
confirms the Order.

In witness whereof the Common Seal
of the Council was hereunto affixed
this FIFTH day of FEBRUARY 1988 in
the presence of

(Mayor)

(Solicitor)

Reproduced from the Ordnance Survey map with the permission of the
Controller of Her Majesty's Stationery Office. Crown Copyright
reserved.

HERTSMERE
BOROUGH COUNCIL
Civic Offices
Elstree Way
Borehamwood
Herts WD6 1WA

SCALE	1:400	DATE	26.8.87
DRAWN	P.A.C.	CHECKED	D.H.
DRAWING No.	TP/440		