

TOWN AND COUNTRY PLANNING ACTS 1971-1974

Plan referred to in

THE HERTSMERE BOROUGH COUNCIL

(THE LAURELS, WELL END ROAD, WELL END,  
BOREHAMWOOD)

TREE PRESERVATION ORDER No. 95 /1985

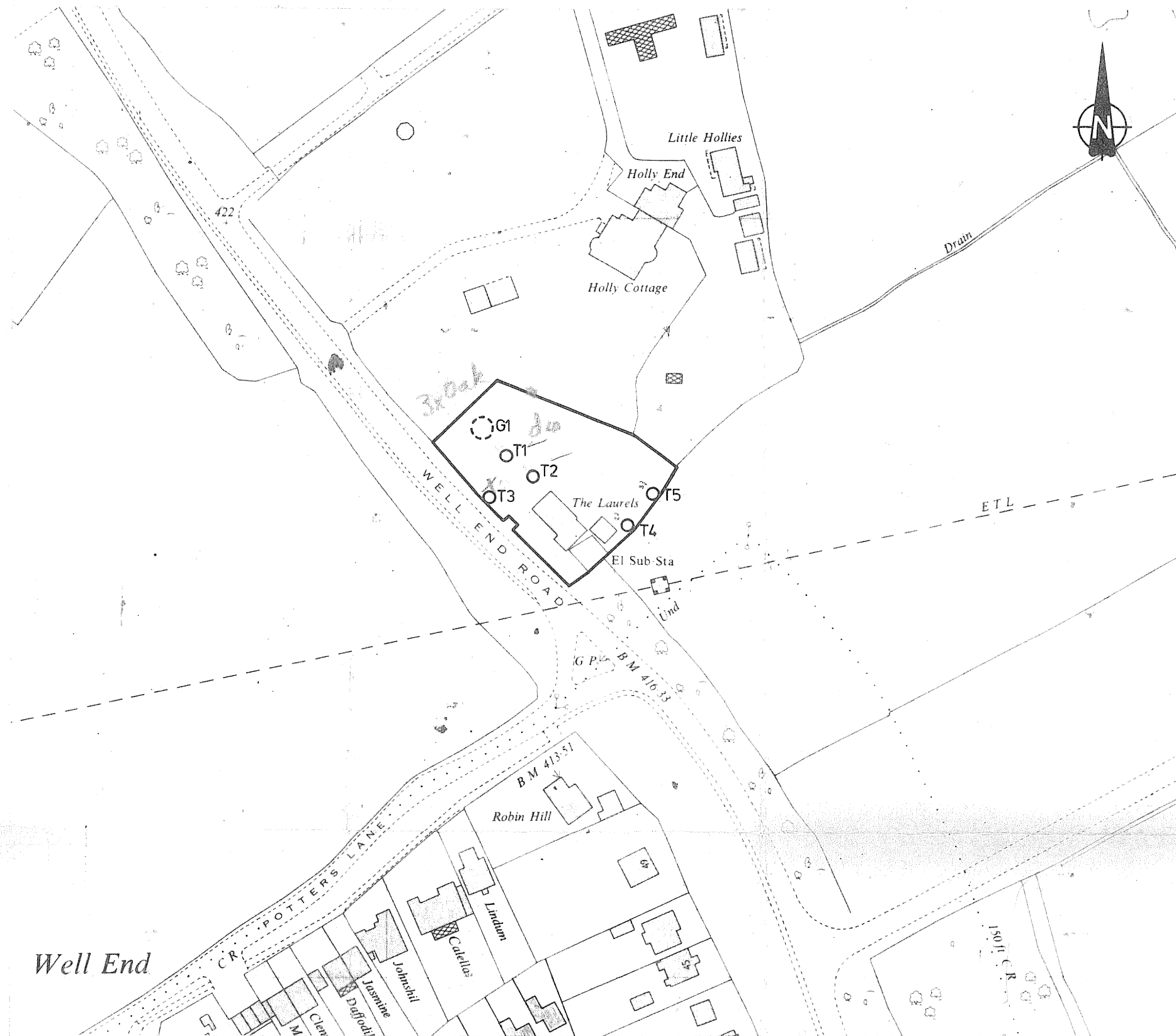

SCHEDULE OF TREES

No.	TYPE
T1	Oak
T2	Oak
T3	Ash
T4	Oak
T5	Oak
G1	Group consisting of 4 Oak

THE COMMON SEAL OF HERTSMERE BOROUGH COUNCIL  
WAS HEREUNTO AFFIXED THIS SEVENTEENTH DAY OF  
JULY 1985 IN THE PRESENCE OF

CHIEF EXECUTIVE SECRETARY

The HERTSMERE BOROUGH COUNCIL, in exercise of the within written  
powers conferred upon it in that behalf, hereby confirms the Order.

In witness whereof the Common Seal of the  
Council was hereunto affixed  
this Twenty-ninth day of October 1985  
in the presence of

Mayor

Administrator

TQ 2064, 9823

HERTSMERE  
BOROUGH COUNCIL  
Civic Offices  
Elstree Way  
Borehamwood  
Herts WD6 1WA

SCALE 1:1250	DATE 4.7.85
DRAWN P.A.C	CHECKED R.D.L
DRAWING No.	TP/378

Reproduced from the Ordnance Survey map with the permission of the  
Controller of Her Majesty's Stationery Office. Crown Copyright  
reserved.