

TOWN AND COUNTRY PLANNING ACTS 1971-1974

Plan referred to in  
 THE HERTSMERE BOROUGH COUNCIL  
 ( 14 & 16, THE RIDGEWAY, RADLETT, HERTS. )

TREE PRESERVATION ORDER No. 62 /1983

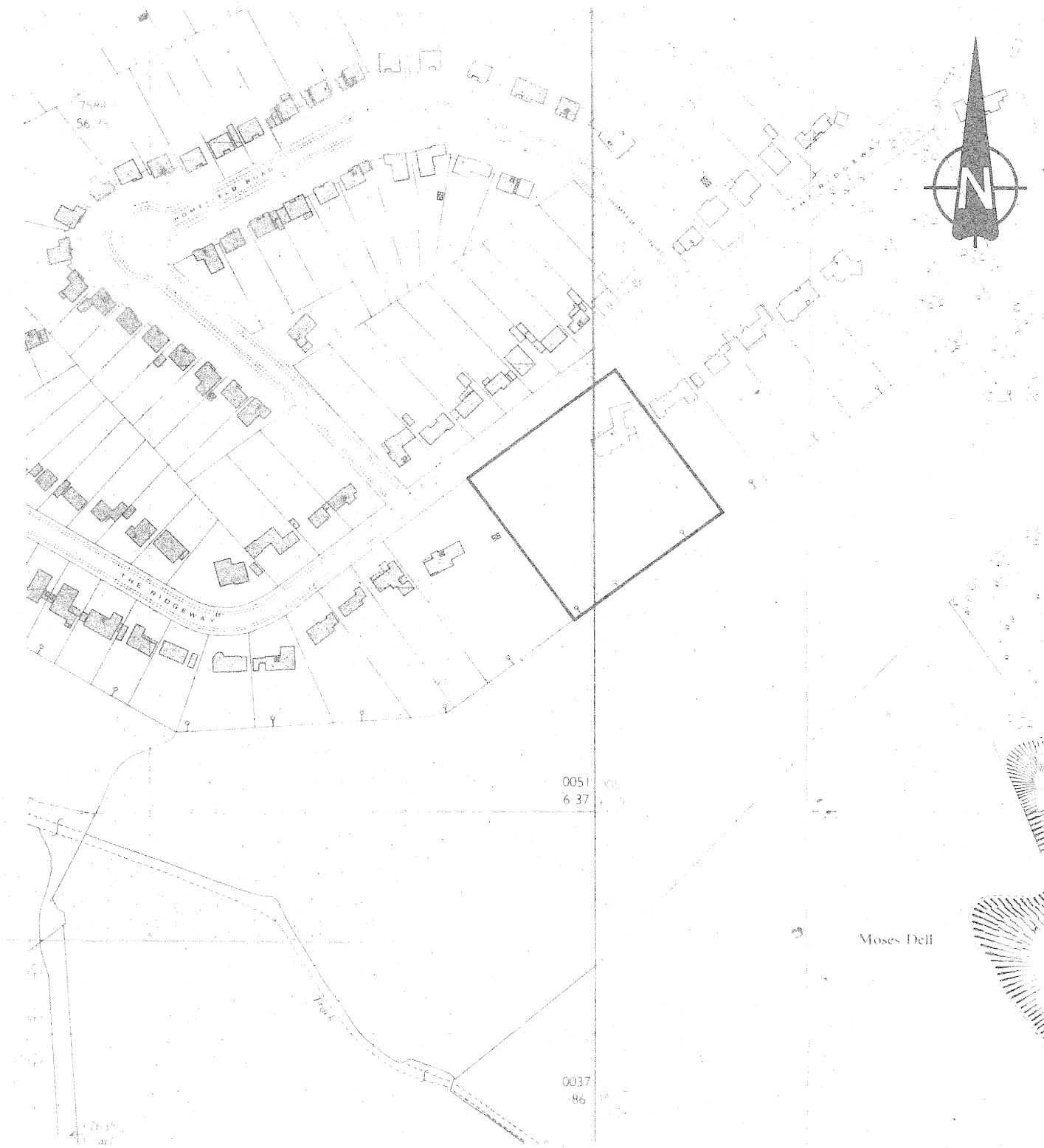

SCHEDULE OF TREES

No.	TYPE
T1	Willow
T2	Willow
T3	Beech
T4	Maple
T5	Maple
T6	Beech
T7	Beech
T8	Beech
T9	Beech
T10	Beech
T11	Ash
T12	Ash
T13	Rowan
T14	Oak
T15	Cherry
<del>T16</del>	<del>Ash</del>
<del>T17</del>	<del>Willow</del>
<del>T18</del>	<del>Mulberry</del>
<del>T19</del>	<del>Ash</del>
<del>T20</del>	<del>Cherry</del>
T21	Horsechestnut
T22	Beech
T23	Beech
G1.	Group consisting of
	1 Horsechestnut
	10 Hawthorn
	2 Sycamore
	4 Beech

The Hertsmere Borough Council, in exercise of the within written powers conferred upon them in that behalf, hereby confirm the order subject to the amendments shown in red.

In witness whereof the Common Seal of the Council was hereunto affixed this fifth day of March 1984 in the presence of:-

Mayor

Borough Secretary

THE COMMON SEAL OF HERTSMERE BOROUGH COUNCIL  
 WAS HEREUNTO AFFIXED THIS TWENTY-EIGHTH DAY OF  
 NOVEMBER 1983 IN THE PRESENCE OF:

MAYOR

BOROUGH SECRETARY

HERTSMERE  
 BOROUGH COUNCIL  
 Civic Offices  
 Elstree Way  
 Borehamwood  
 Herts WD6 1WA

SCALE	1:500	DATE	17.10.83
DRAWN	PAC	CHECKED	S.L.
DRAWING No.	TP/334		

Reproduced from the Ordnance Survey map with the permission of the Controller of Her Majesty's Stationery Office. Crown Copyright reserved.