

# TOWN AND COUNTRY PLANNING (TREES) REGULATIONS 1999

Plan referred to in THE HERTSMERE TREE PRESERVATION ORDER (65 and 67 Goodyers Avenue, Radlett, Herts) No 6/2008

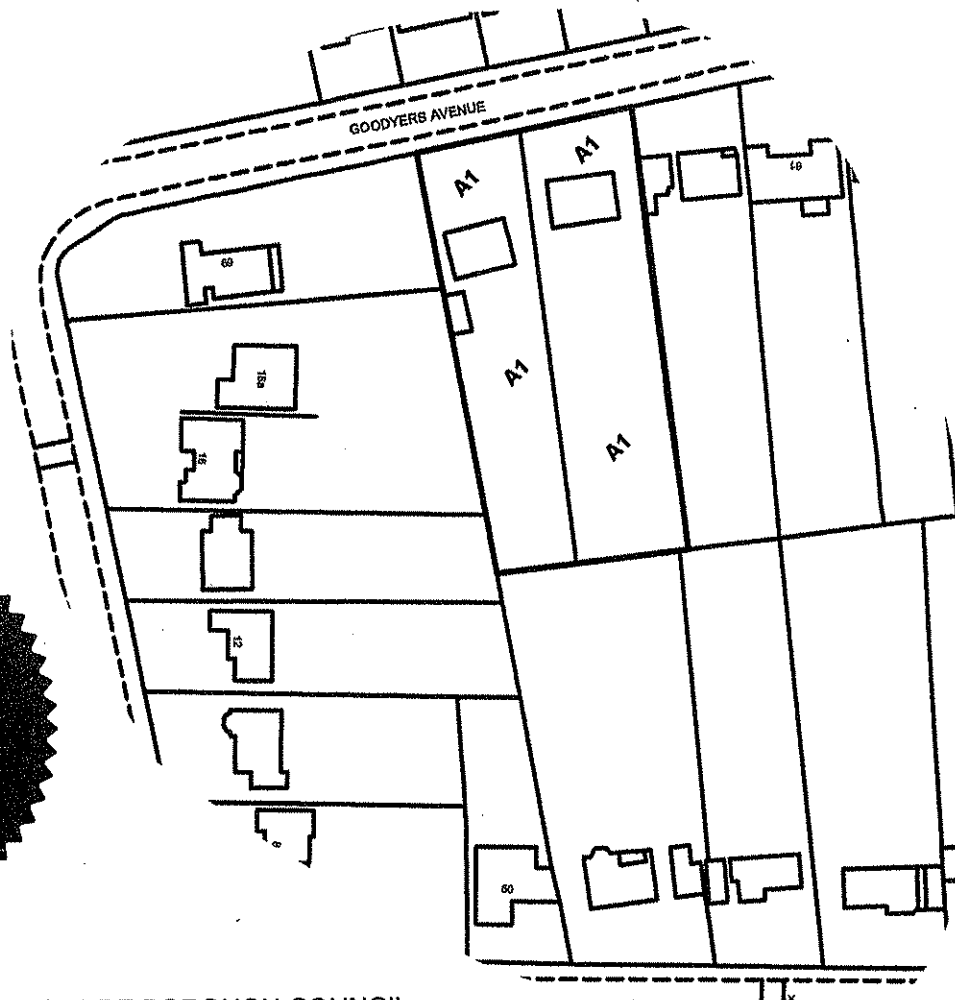

## SCHEDULE OF TREES

No	Type
A1	All trees of whatever species within the highlighted area on the attached plan

This Order was confirmed by the  
Hertsmere Borough Council  
without modification  
on the TWENTY FIRST day  
of MAY in the year 2008

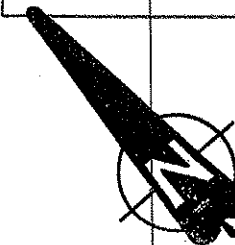

THE COMMON SEAL OF HERTSMERE BOROUGH COUNCIL  
WAS HEREUNTO AFFIXED THIS Twenty Fourth day of January  
2008

IN THE PRESENCE OF:

(Signed) Interim Head of Legal Services

Reproduced from the Ordnance Survey mapping with the permission of the Controller of Her Majesty's Stationery Office.  
© Crown Copyright reserved. Unauthorised reproduction infringes Crown copyright and may lead to prosecution or civil proceedings.  
Licence Number LA078239 Hertsmere. 2001.

Map Ref: TL 1575,0053

Hertsmere Borough Council  
Civic Offices  
Borehamwood  
Herts WD6 1WA

SCALE: 1:1250 DATE: 24/01/2008

DRAWN BY: SW CHECKED *MS*

DRAWING NUMBER: 6/2008