

# TOWN AND COUNTRY PLANNING (TREES) REGULATIONS 1999

Plan referred to in THE HERTSMERE TREE PRESERVATION ORDER (Curtilage of Eastern Electricity Board Substation, adjacent to Kitwell Way, Radlett, Herts)  
No 23/2008

## SCHEDULE OF TREES

No	Type
T1	Oak

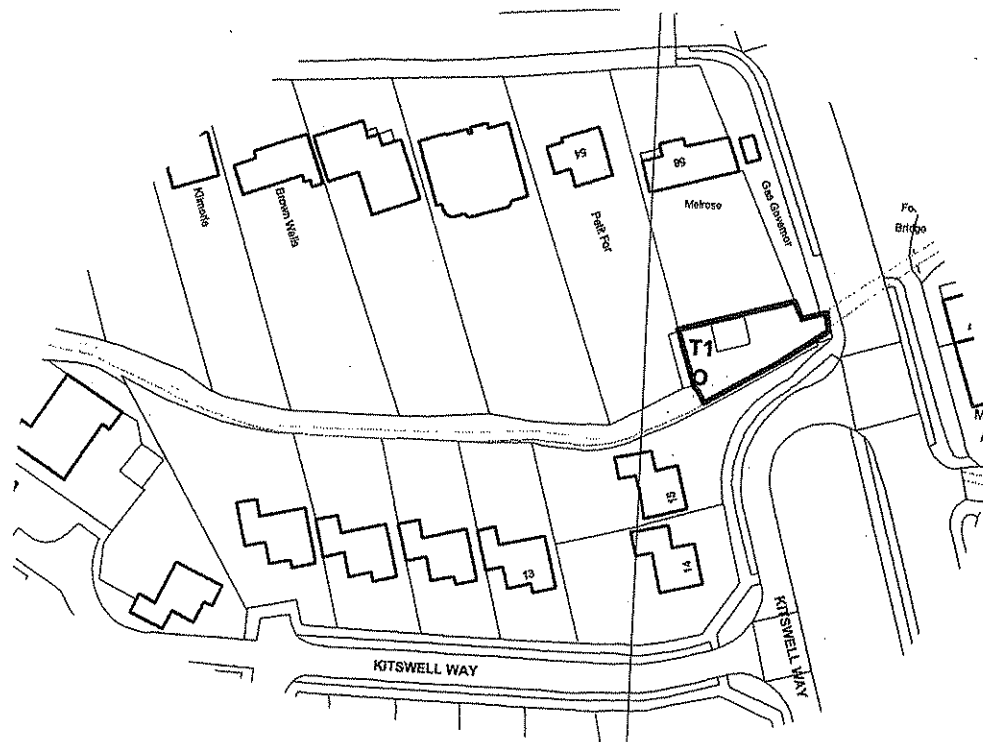

This Order was confirmed by the  
Hertsmere Borough Council  
without modification  
on the SEVENTEETH day  
of FEBRUARY in the year 2009

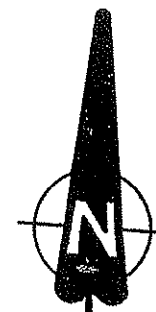

Signed on behalf of Hertsmere Borough Council Sixteenth day of  
December 2008

Authorised by the Council to sign in that behalf:

*Mark Silverman*

Print name and Position **MARK SILVERMAN (POLICY AND TENDS/ART MANAGER)**

Map Ref: TL 1601,0072

Hertsmere Borough Council  
Civic Offices  
Borehamwood  
Herts WD6 1WA

SCALE: 1:1250 DATE: 16/12/2008

DRAWN BY: SW CHECKED *MS*

DRAWING NUMBER: 23/2008

Reproduced from the Ordnance Survey mapping with the permission of the Controller of Her Majesty's Stationary Office.  
© Crown Copyright reserved. Unauthorised reproduction infringes Crown copyright and may lead to prosecution or civil proceedings.  
Licence Number LA078239 Hertsmere, 2001.