

TOWN AND COUNTRY PLANNING (TREES) REGULATIONS 1999

Plan referred to in THE HERTSMERE TREE PRESERVATION ORDER (20 Oakmere Lane, Potters Bar, Herts) No 20/2009

SCHEDULE OF T

No	Type
T1	Oak

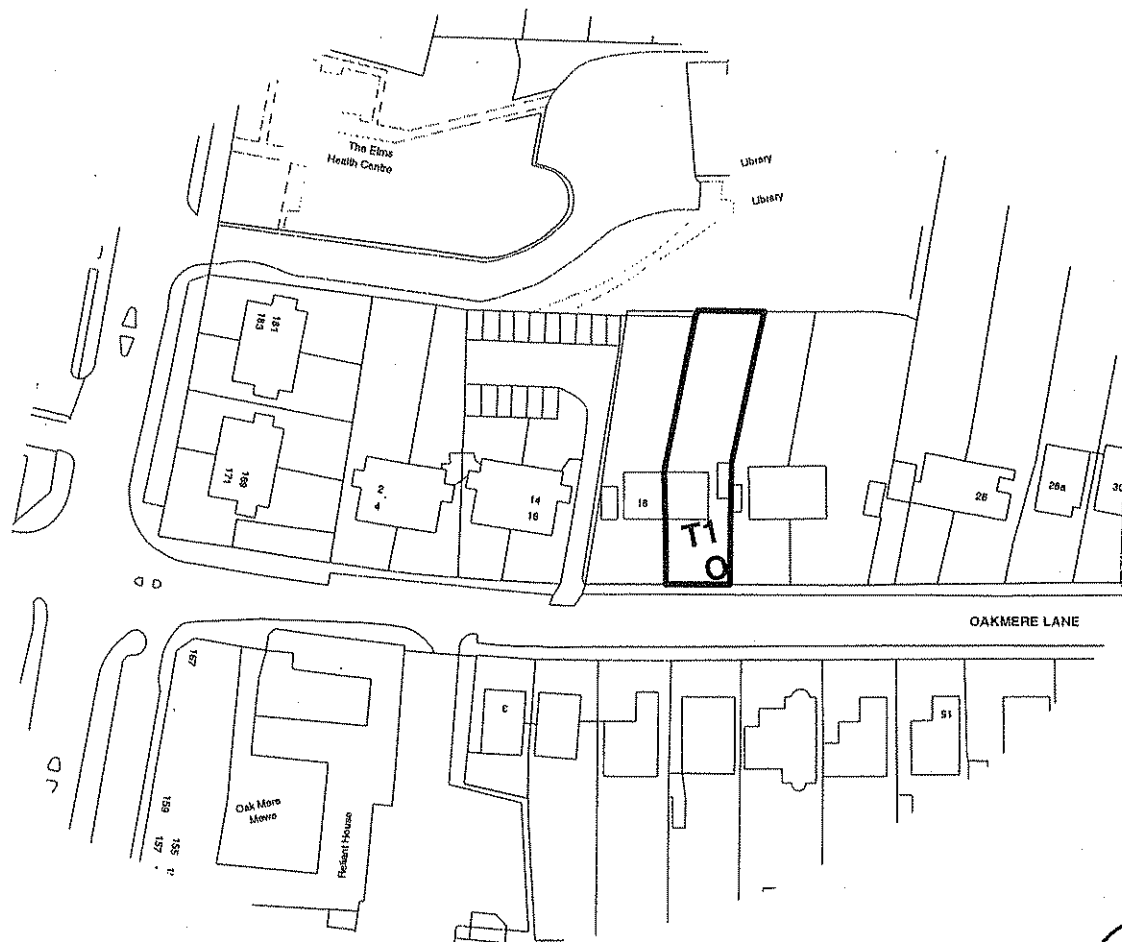

This Order was confirmed by the
Hertsmere Borough Council
without modification
on the TWENTY FIRST day
of OCTOBER in the year

[Signature]

Signed on behalf of Hertsmere Borough Council Twenty First day
of July 2009

Authorised by the Council to sign in that behalf:



Map Ref: TL 2631,014

Hertsmere Borough
Civic Office
Borehamwo
Herts WD6 1

SCALE: 1:1250