

TOWN AND COUNTRY PLANNING (TREES) REGULATIONS 1999

Plan referred to in THE HERTSMERE TREE PRESERVATION ORDER (Lochinver House School, 16, 22, 26, 44 & 48 Heath Road and 8 The Mount, Potters Bar, Herts) No 16/2008

This Order was confirmed by the
Hertsmere Borough Council subject to
the modifications indicated by The
removal of T20 & T7
on the TWELFTH day
of MARCH in the year 2009.

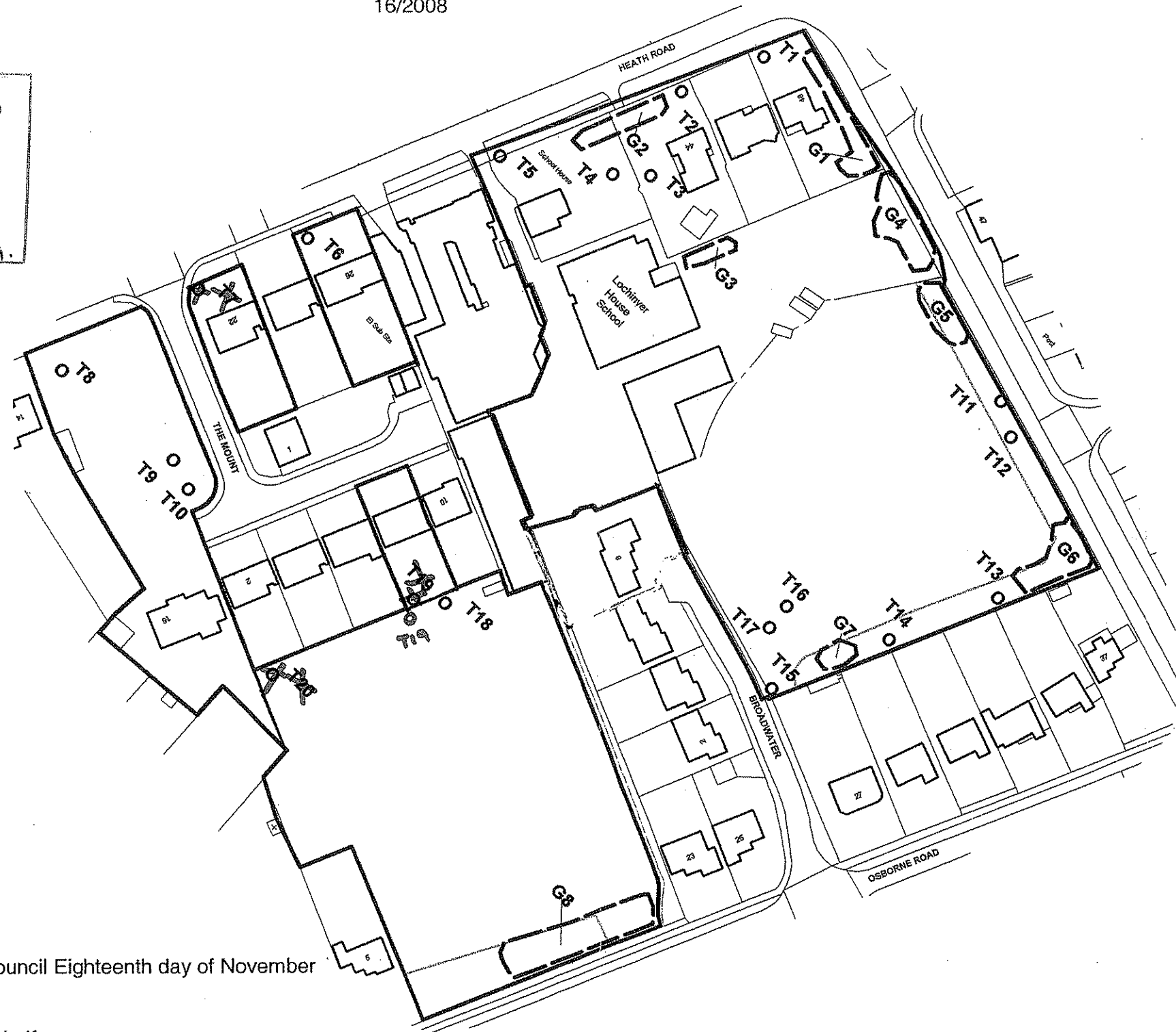

SCHEDULE OF TREES

No	Type
T1	Horse Chestnut
T2	Horse Chestnut
T3	Lawson Cypress
T4	Sequoia
T5	Deodar Cedar
T6	Pink Flowered Horse Chestnut
T7	Deodar Cedar
T8	Plane
T9	Corsican Pine
T10	Corsican Pine
T11	Ash
T12	Pine
T13	Oak
T14	Pine
T15	Austrian Pine
T16	Oak
T17	Oak
T18	Turkey Oak
T19	Oak
T20	Field Maple
G1	4 no. Sycamores
G2	2 no. Limes and 3 no. Pines
G3	1 no. Ash and 1 no. Sycamore
G4	5 no. Sycamores and 1 no. Pin
G5	4 no. Pines
G6	4 no. Pines
G7	2 no. Austrian Pines
G8	2 no. Field Maples, 2 no. Maples, 3 no. Cherries and 2 no. Pines

Map Ref: TL 2564,0232

Hertsmere Borough Council
Civic Offices
Borehamwood
Herts WD6 1WA

SCALE: 1:1250 DATE: 18/11/2008

DRAWN BY: SW CHECKED: MS

DRAWING NUMBER: 16/2008

Signed on behalf of Hertsmere Borough Council Eighteenth day of November 2008

Authorised by the Council to sign in that behalf:

Mark Silverman

Print name and Position MARK SILVERMAN
POLICY AND TRANSPORT MANAGER

Reproduced from the Ordnance Survey mapping with the permission of the Controller of Her Majesty's Stationery Office.
© Crown Copyright reserved. Unauthorised reproduction infringes Crown copyright and may lead to prosecution or civil proceedings.
Licence Number LA078239 Hertsmere. 2001.