

Studio Way Woodland Trail & Potterswood Park

Green Space Action Plan

2014 - 2019

Produced by the Countryside Management Service

On behalf of Hertsmere Borough Council



INTRODUCTION 3

SITE DESCRIPTION 5

COMMUNITY ENGAGEMENT 6

VISION..... 7

OBJECTIVES 7

ACTION PLAN 8

 YEAR 1 9

 YEAR 2 10

 YEAR 3 11

 YEAR 4 12

 YEAR 5 12

 ANNUAL ACTIONS 13

ACTION PLAN MAPS 14

POPLAR CLEARANCE MAPS..... 19

Introduction

Studio Way Woodland Trail & Potterswood Park is located in a residential area on the north eastern edge of Borehamwood. It consists of a green corridor linking Rowley Lane with Shenley Road and returns south east towards Studio Way, to which it links via an alleyway. It is split into three roughly equal sections by Balcon Way and Denham Way. In total it covers 5.8 hectares and is approximately 1 km in length.

The landscape of Studio Way Woodland Trail & Potterswood Park has developed over many years, yet some of the original field boundary hedges, woodland and veteran Oak trees still survive on the site.

The eastern section of Studio Way contains well established mature woodland and is part of a long strip of common land known as Waste at Rowley Lane, which has been incorporated into the open space. The wood is predominately of oak with occasional ash and poplar. The understorey consists of a mixture of hawthorn, blackthorn plus occasional Elder, Holly, Cherry Laurel and Hazel. Along the edge of the unsurfaced path the ground flora contains good numbers of bluebell and lesser stitchwort, while beyond this bramble dominates.

Along the surfaced path edges remnants of hedgerow and associated bank and ditch are evident and a small brook enters from a culvert at the southeastern end and runs north through the site.

In the 1950's, when the local area was used as a filming location large numbers of Poplar trees were planted and now dominate some of the woodland areas. Much of the central part of Studio Way Woodland contains poplars, many of which are approaching maturity. The eastern block has a mixed understorey containing, rowan, Norway maple, horse chestnut, wild service, hawthorn, cherry and hazel. The western block in contrast has a dense understorey of hawthorn and blackthorn. The ground flora is predominantly bramble cow parsley and cleavers.

With the subsequent construction of neighbouring housing, work has had to be carried out in recent years to remove some of the large Poplars, particularly those close to people's houses. The work is essential to prevent damage to neighbouring properties from subsidence and to reduce the risk from falling trees and branches.

As a result work has been carried out to revert much of the site to native broadleaved woodland, an area of trees which links the two blocks of poplars was planted approximately ten years ago and is now establishing well.

The final area of woodland occupies the south western section of the open space and continues the green corridor from Shenley Road to the south east. This consists of occasional mature oak and ash and a mixture of birch, poplar, horse chestnut, field maple, hazel, hawthorn and blackthorn. The canopy is relatively open and the ground flora consists of cow parsley, bramble and nettles. Beyond this woodland near the southern limit of the open space a small area of rough grassland remains.

Potterswood Park on the northern edge of Studio Way Woodland trail is more open with areas of amenity grass, parkland and wooded copses. The park has recently had a facelift, with two football goal units, a challenging multi-play area and basket swing being installed.

There is a network of footpaths through the site; some are tarmaced and maintained by Hertfordshire County Council, and others are less formal, with a grassed surface and are

maintained by Hertsmere Borough Council. A woodland trail has previously been established through the site.

Studio Way - Site Description



Key	
	Shrubs
	Grassland
	Surfaced path
	Woodland
	Unsurfaced path
	Meadow
	Recent tree planting
	Car park
	Hedgerow
	Play area
	Hedge restoration
	Scrub coppicing
	Poplar clearance
	Drain
	Trees



Community Engagement

Effective community engagement is at the centre of a successful Management Plan. Their particular value as documents comes from balancing the thoughts and aspirations of users and interested groups throughout the writing process.

During the production of the Studio Way Woodland Trail & Potterswood Park Management Plan stakeholders and interested groups had two opportunities to feed into the production of the new plan.

During the first stage, people were invited to make comment on the key objectives and outline actions put forward in a briefing document and further objectives and/or issues were addressed through this information gathering process. To support this stage, a guided walk was held on site on Saturday 11th January 2014. The walk was widely publicized with posters on site, information forwarded to local community organisations and a press release to local media. Eight members of the local community attended and had the opportunity to find out about the wildlife and heritage of the site and the future plans for management.

For the second stage, people will be invited to read through and make comment on the draft Management Plan. Following this exercise, the final document will be produced and published. The following diagram shows the Management Plan production process which was issued to consultees.

Studio Way Management Plan - 2014-2019
Plan Production Process

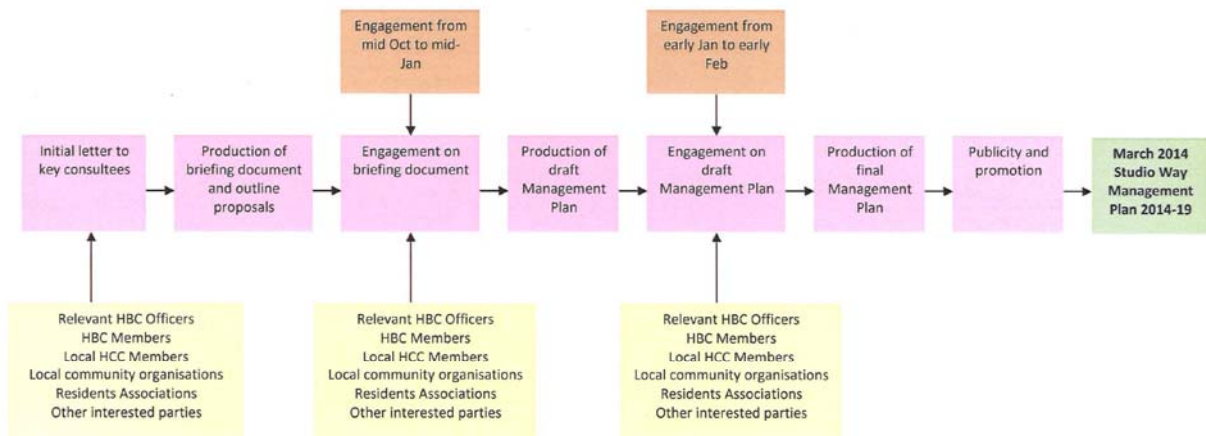

Vision

To maintain Studio Way Woodland Trail as a inviting and safe green corridor for recreation, wildlife and the appreciation of local history.

Objectives

1. Make Studio Way Woodland Trail & Potterswood Park a welcoming place for visitors
2. Conserve the biodiversity and heritage sustainably and over the long term
3. Involve the community in the development of Studio Way Woodland Trail & Potterswood Park
4. Promote Studio Way to new users through a variety of means
5. Maintain Studio Way as a clean, well maintained, safe and secure open space
6. Secure funding to support site improvement works

Action Plan

The following action plan has been established to achieve the objectives set out the Management Plan. The plans are comprised of annual work programmes, which address management activity that falls outside of the contracted grounds maintenance operations. They cover the period from April 2014 to March 2019 inclusive. In some cases, tasks are ongoing and so appear on more than one action plan.

Column 1 and 2 of the action plan lists the management objective for each particular task. In some instances, an objective will be fulfilled by a number of actions. Column 3 briefly describes the action with further information provided in an external document of specifications, referenced in Column 4.

Column 5 sets out the organisation/s responsible for delivery of the stated action (see list of abbreviations below), and Column 6 gives an estimated cost for carrying out the works.

ABBREVIATIONS

CMS	Countryside Management Service
HBC	Hertsmere Borough Council
Vols	Volunteers
Con	Contractor
GM	Grounds Maintenance Contractor

At the end of each annual period, the action plan will be updated to show the progress of the activities for that year. In theory, all should be marked as complete but if for any reason actions haven't been achieved, details are to be recorded here. If appropriate, remnant activities can then be moved in to one of the future actions plans.

Year 1

Obj ref	Objective	Action	Spec ref	Cost estimate	Who
1.	Make Studio Way Woodland a welcoming place for visitors	Coppice scrub along side paths	2d		CMS Vols
		Cut back overhanging vegetation to fence line	2g		GM
		Coppice blackthorn along the path on Rowley Lane	2c	£1,500	CMS / Con
		Re-open car park on a trial basis	(2a.) SP1		HBC
2.	Conserve the biodiversity and heritage sustainably and over the long term	Clear groups of Poplar trees	4f	£10,000	CMS / Con
		Restore section of old hedgerow	3a	£560	CMS Vols
		Selectively thin recently planted trees	4e		CMS Vols
		Clear invasive laurel and grub up / treat stumps	4c		GM
		Plant replacement standard trees in open areas	3d	£2,000	CMS Vols
3.	Promote Studio Way to new users through a variety of means	Hold a community engagement event	1d	£2,000	CMS
4.	Maintain Studio Way as a clean, well maintained, safe and secure Open Space	Remove old rabbit fencing from around recent planting	4a		CMS Vols
		Remove old wooden fencing	2h		CMS Vols
		Coppice vegetation and clear rubbish from ditch	3e		GM

6.	Secure funding to support site improvements works	Apply for the Forestry Commission's woodland planning and woodland improvement grants	1b		CMS
		Apply for Watling Chase Community Forest funding	1c		CMS
		Develop a funding bid to Heritage Lottery Fund to create a new circular trail through the site with interpretation and leaflets	1a		CMS
Sub total				£16,070	

Year 2

Obj ref	Objectives	Action	Spec ref	Cost estimate	Who
1.	Make Studio Way Woodland a welcoming place for visitors	Implement access audit and entrance improvements	2a	£8,000	CMS / Con
		Coppice scrub along side paths	2d		CMS Vols
2.	Conserve the biodiversity and heritage sustainably and over the long term	Clear groups of Poplar trees	4f	£10,000	CMS / Con
		Coppice scrub alongside the stream	3f		CMS Vols
		Restore section of old hedgerow	3a	£650	CMS Vols
		Thin out trees in Potterswood Park	4b	£1,800	CMS / Contractor
		Underplant thinned trees with shrub species	3b	£500	CMS / Con
3. & 4.	Promote Studio Way to new users through a variety of means Involve the community in the development of Studio Way Woodland Trail &	Special Project 1 - Car park improvements	2a (SP1)	£10,000	CMS / Con

	Potterswood Park	Special Project 2 - Play / Interpretation improvements	2a (SP2)	£50,000	CMS / Con
5.	Maintain Studio Way as a clean, well maintained, safe and secure Open Space	Repair and resurface marked sections of paths	2e	£20,000	CMS / Con
		Remove old chain link fence along footpath	2f	£600	CMS / Con
		Remove old Chicane	2i	£150	CMS / Con
Sub total				£101,700	

Year 3

Obj ref	Objectives	Actions	Spec ref	Cost Estimate	Who
1.	Make Studio Way Woodland trail a welcoming place for visitors	Coppice scrub along side paths	2d		CMS Vols
2.	Conserve the biodiversity and heritage sustainably and over the long term	Clear groups of Poplar trees	4f	£10,000	CMS / Con
		Selectively thin established eastern woodland	4f	£4,000	CMS / Vols
		Maintain shrub planting in Potterswood Park	3c		GM
Sub total				£14,000	

Year 4

Obj ref	Objectives	Actions	Spec ref	Cost Estimate	Who
2.	Conserve the biodiversity and heritage sustainably and over the long term	Maintain shrub planting in Potterswood Park	3c		GM
		Clear groups of Poplar trees	4f	£10,000	CMS / Con
Sub total				£10,000	

Year 5

Obj ref	Objectives	Actions	Spec ref	Cost Estimate	Who
2.	Conserve the biodiversity and heritage sustainably and over the long term	Maintain shrub planting in Potterswood Park	3c		GM
		Clear groups of Poplar trees	4f	£10,000	CMS / Con
Subtotal				£10,000	

Annual Actions

Obj ref	Objectives	Actions	Spec ref	Cost Estimate	Who
		Replant glades with native tree species	5a	£750	CMS Vols
2.	Conserve the biodiversity and heritage sustainably and over the long term	Cut and lift meadow areas once a year in September	5b		GM
5.	Maintain Studio Way as a clean, well maintained, safe and secure Open Space	Cut back overhanging vegetation from paths	5c		GM
		Empty litter and dog bins as per ground maintenance specification	5d		GM
		Cut amenity grass areas as per grounds maintenance	5e		GM
		Inspect play areas as pre ground maintenance specification	5f		GM
Sub total				£750	
Grand total				£1512,520	

Studio Way - Year 1 2014/15

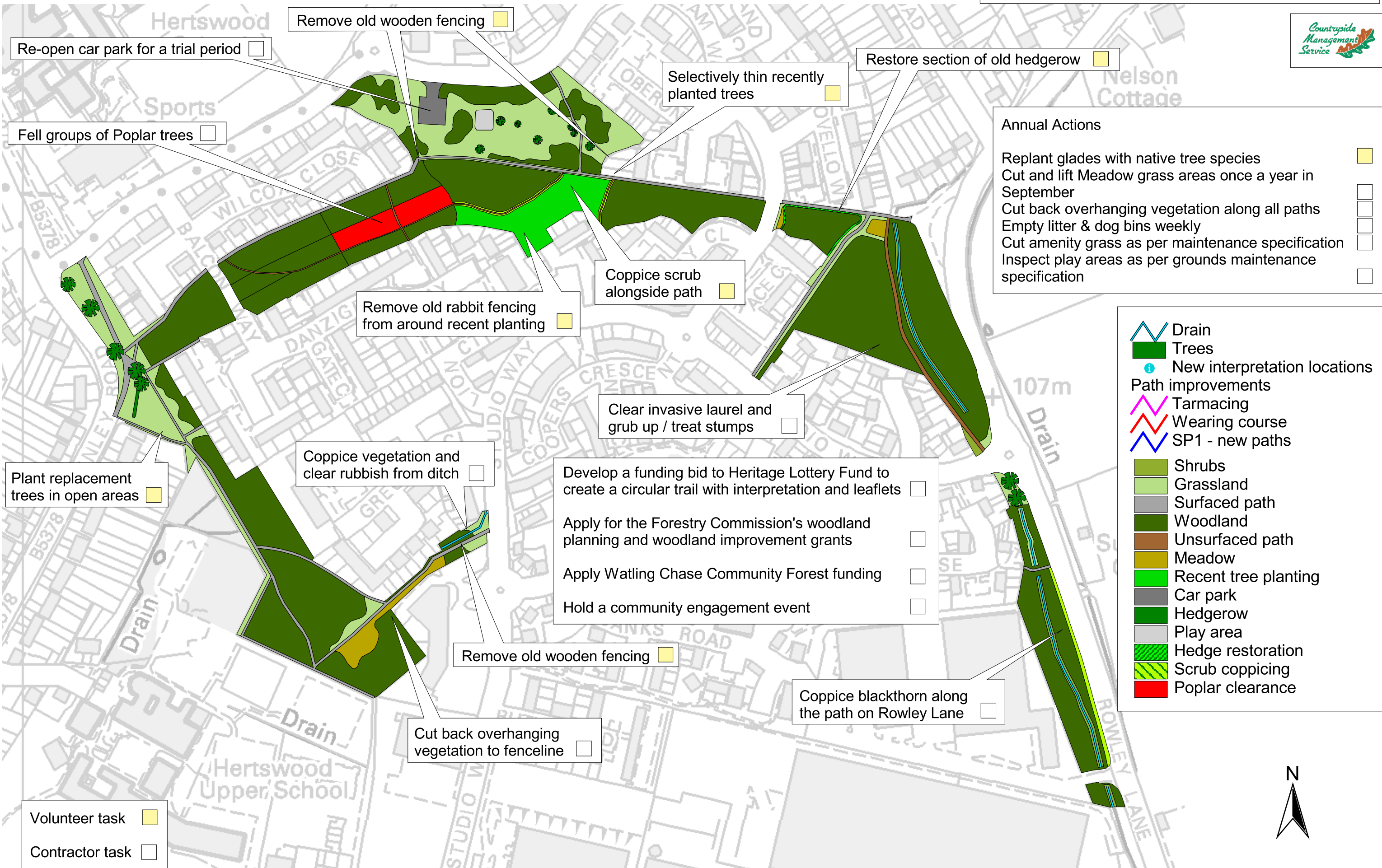

Re-open car park for a trial period

Remove old wooden fencing

Fell groups of Poplar trees

Selectively thin recently planted trees

Restore section of old hedgerow

Annual Actions

- Replant glades with native tree species
- Cut and lift Meadow grass areas once a year in September
- Cut back overhanging vegetation along all paths
- Empty litter & dog bins weekly
- Cut amenity grass as per maintenance specification
- Inspect play areas as per grounds maintenance specification

Remove old rabbit fencing from around recent planting

Coppice scrub alongside path

Clear invasive laurel and grub up / treat stumps

Plant replacement trees in open areas

Coppice vegetation and clear rubbish from ditch

- Develop a funding bid to Heritage Lottery Fund to create a circular trail with interpretation and leaflets
- Apply for the Forestry Commission's woodland planning and woodland improvement grants
- Apply Watling Chase Community Forest funding
- Hold a community engagement event

Remove old wooden fencing

Coppice blackthorn along the path on Rowley Lane

Cut back overhanging vegetation to fenceline

Volunteer task

Contractor task

- Drain
- Trees
- New interpretation locations
- Path improvements**
- Tarmacing
- Wearing course
- SP1 - new paths
- Shrubs
- Grassland
- Surfaced path
- Woodland
- Unsurfaced path
- Meadow
- Recent tree planting
- Car park
- Hedgerow
- Play area
- Hedge restoration
- Scrub coppicing
- Poplar clearance



Studio Way - Year 2 2015/16



Underplant trees with shrubs species

Thin out trees in Potterswood Park

Coppice vegetation alongside paths

- Annual Actions**
- Replant glades with native tree species
 - Cut and lift Meadow grass areas once a year in September
 - Cut back overhanging vegetation along all paths
 - Empty litter & dog bins weekly
 - Cut amenity grass as per maintenance specification
 - Inspect play areas as per grounds maintenance specification

Restore section of old hedgerow

Fell groups of Poplar trees

Restore section of old hedgerow

Coppice scrub alongside the stream

Special Project 2
Play / interpretation improvements

Volunteer task

Contractor task

Remove old chainlink fence along footpath

- Implement access audit and entrance improvements
- Involve the community in the development of a circular heritage trail
- Produce and install five interpretation panels / notice boards
- Repair and resurface marked sections of paths
- Produce a new visitor leaflet for the site

Legend

- Drain
- Trees
- New interpretation locations
- Path improvements**
- Tarmacing
- Wearing course
- SP1 - new paths
- Shrubs
- Grassland
- Surfaced path
- Woodland
- Unsurfaced path
- Meadow
- Recent tree planting
- Car park
- Hedgerow
- Play area
- Hedge restoration
- Scrub coppicing
- Poplar clearance



Studio Way - Year 3 2016/17



Special Project 1
Car park improvements

Fell groups of Poplar trees

Selectively thin the established eastern woodland

Coppice vegetation alongside paths

Volunteer task

Contractor task

- Annual Actions**
- Replant glades with native tree species
 - Cut and lift Meadow grass areas once a year in September
 - Cut back overhanging vegetation along all paths
 - Empty litter & dog bins weekly
 - Cut amenity grass as per maintenance specification
 - Inspect play areas as per grounds maintenance specification

- Drain
- Trees
- New interpretation locations
- Shrubs
- Grassland
- Surfaced path
- Woodland
- Unsurfaced path
- Meadow
- Recent tree planting
- Car park
- Hedgerow
- Play area
- Hedge restoration
- Scrub coppicing
- Poplar clearance



Studio Way - Year 4 2017/18



Maintain shrub planting

Fell groups of Poplar trees

Annual Actions

- Replant glades with native tree species
- Cut and lift Meadow grass areas once a year in September
- Cut back overhanging vegetation along all paths
- Empty litter & dog bins weekly
- Cut amenity grass as per maintenance specification
- Inspect play areas as per grounds maintenance specification

	Drain
	Trees
	New interpretation locations
	Shrubs
	Grassland
	Surfaced path
	Woodland
	Unsurfaced path
	Meadow
	Recent tree planting
	Car park
	Hedgerow
	Play area
	Hedge restoration
	Scrub coppicing
	Poplar clearance

Volunteer task

Contractor task



Studio Way - Year 5 2018/19



- Annual Actions**
- Replant glades with native tree species □
 - Cut and lift Meadow grass areas once a year in September □
 - Cut back overhanging vegetation along all paths □
 - Empty litter & dog bins weekly □
 - Cut amenity grass as per maintenance specification □
 - Inspect play areas as per grounds maintenance specification □

Fell groups of Poplar trees □

- Drain
- Trees
- New interpretation locations
- Shrubs
- Grassland
- Surfaced path
- Woodland
- Unsurfaced path
- Meadow
- Recent tree planting
- Car park
- Hedgerow
- Play area
- Hedge restoration
- Scrub coppicing
- Poplar clearance

- Volunteer task □
- Contractor task □



Studio Way Poplar clearance Year 1 to 10



Year 1 2014/15

Poplar clearance year & location

Poplar clearance

